

CONCRETE NZ – MASONRY  
PROJECT PROFILE #2

## Cranko House

WELLINGTON

### PROJECT PRINCIPALS

*Architect:* Cranko Architects

*Consultant:* Don Thomson Consulting Engineers Limited (DTCE)

*Contractor:* PCB (Peter Camp Builders Limited)

*Masonry Supplier:* Firth Industries (Concrete NZ – Masonry Member)

*Structural Mason:* Valley Blocklaying

Concrete masonry products are used extensively in this new Wellington house to create a comfortable and functional family home in an established city-fringe neighbourhood.

The layout optimises its northern orientation with polished concrete floors on north and west sides that act as heat sinks. The north-facing, double-height glazed entry gallery acts as a conservatory/trombe wall.

The incorporation of passive solar design principles is key to achieving a reduction in the home's energy requirements. The mass of heavy building materials, in this case exposed concrete and concrete masonry, is utilised in conjunction with the sun's changing elevation angle during the year to sustainable effect.

In conjunction with appropriate thermal insulation, window placement for good solar gains and natural ventilation, the exposed concrete elements in the house absorb, store and later radiate the sun's heat, off-setting temperature troughs and peaks, to create a moderate living environment.

This house demonstrates how concrete masonry construction can enable an elegant, joyful, hard wearing, low-energy solution for everyday family life.



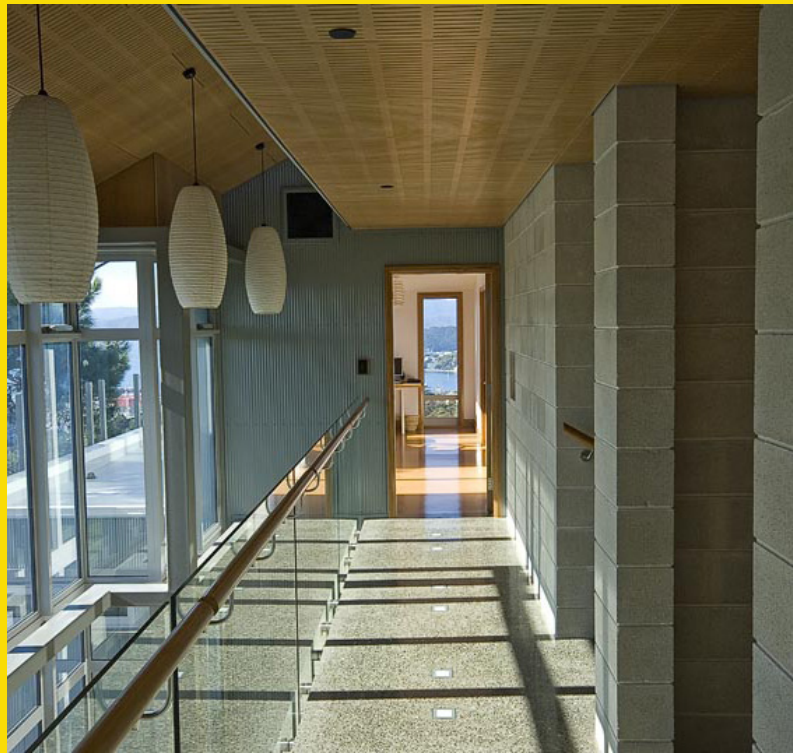

Images: Kevin Hawkins and Deborah Cranko

## CONCRETE MASONRY - RECOMMENDED USE

Concrete masonry construction (or blockwork) is a permanent hollow formwork which is filled with concrete (blockfill) and allows for the integration of reinforcing steel, a feature essential for earthquake resistant structures for industrial, commercial, and residential buildings.

### REQUIREMENTS OF CONCRETE NZ - MASONRY SECTOR GROUP

The Concrete NZ Masonry Sector Group requires its masonry manufacturer members to produce concrete masonry blocks, including veneer types, to meet the Australian/New Zealand manufacturing Standard AS/NZS 4455.1.2008, Part 1 Masonry Units.

### ADVANTAGES OF CONCRETE MASONRY

Concrete masonry is a solid, predictable, and reliable material that provides permanence, and high fire and acoustic resistance. Masonry walls can also be positioned and designed to achieve great weather protection and thermal efficiencies.



Image: Patrick Reynolds

### THE NEW ZEALAND CONCRETE MASONRY MANUAL

The New Zealand Concrete Masonry Manual, which was created in the late 1970s as a guide to the design and construction of concrete masonry, has been updated and is available in sections for free download as required from the Concrete NZ website – [www.concretenz.org.nz](http://www.concretenz.org.nz)

### CONCRETE NZ - MASONRY MEMBERS

For advice and concrete block availability, Concrete NZ – Masonry Sector Group members can be contacted at the following links:

| COMPANY                       | LOCATION   | CONTACT                        |
|-------------------------------|------------|--------------------------------|
| Aitkens Concrete Limited      | Gisborne   | aitcon@xtra.co.nz              |
| Firth Industries              | Various    | www.firth.co.nz                |
| Holcim (New Zealand) Limited  | Various    | blocks-nz@holcim.com           |
| Horizon International Limited | Various    | www.horizoninternational.co.nz |
| Mitchell Concrete Limited     | Taranaki   | mitchellconcrete@xtra.co.nz    |
| Oamaru Shingle Supplies       | Oamaru     | www.oamarushingle.co.nz        |
| Upper Hutt Masonry            | Upper Hutt | blocks@567.co.nz               |



Concrete NZ – Masonry  
 Project Profile #2 April 2017  
 P. (04) 499 8820  
 F. (04) 499 7760  
 E. [masonry@concretenz.org.nz](mailto:masonry@concretenz.org.nz)  
 W. [www.concretenz.org.nz](http://www.concretenz.org.nz)

© Copyright 2017 Concrete NZ – Masonry Sector Group.  
 Disclaimer: The information provided in this publication is intended for general guidance only and in no way replaces the services of professional consultants on particular projects. No liability can therefore be accepted by the Concrete NZ for its use.