

Williamsburg Lodge

Marriott Autograph Collection



WILLIAMSBURG
LODGE



GOLF • RESORT • SPA
AUTOGRAPH COLLECTION®
HOTELS



Guestrooms



Unique Outdoor Event Space



Fountain Garden



Virginia Lawn



Oval Garden



Golden Horseshoe Clubhouse

Meeting Space



45,000 sq. ft. of meeting space

WILLIAMSBURG LODGE CONFERENCE CENTER LOWER LEVEL



45,000 sq ft of Meeting Space

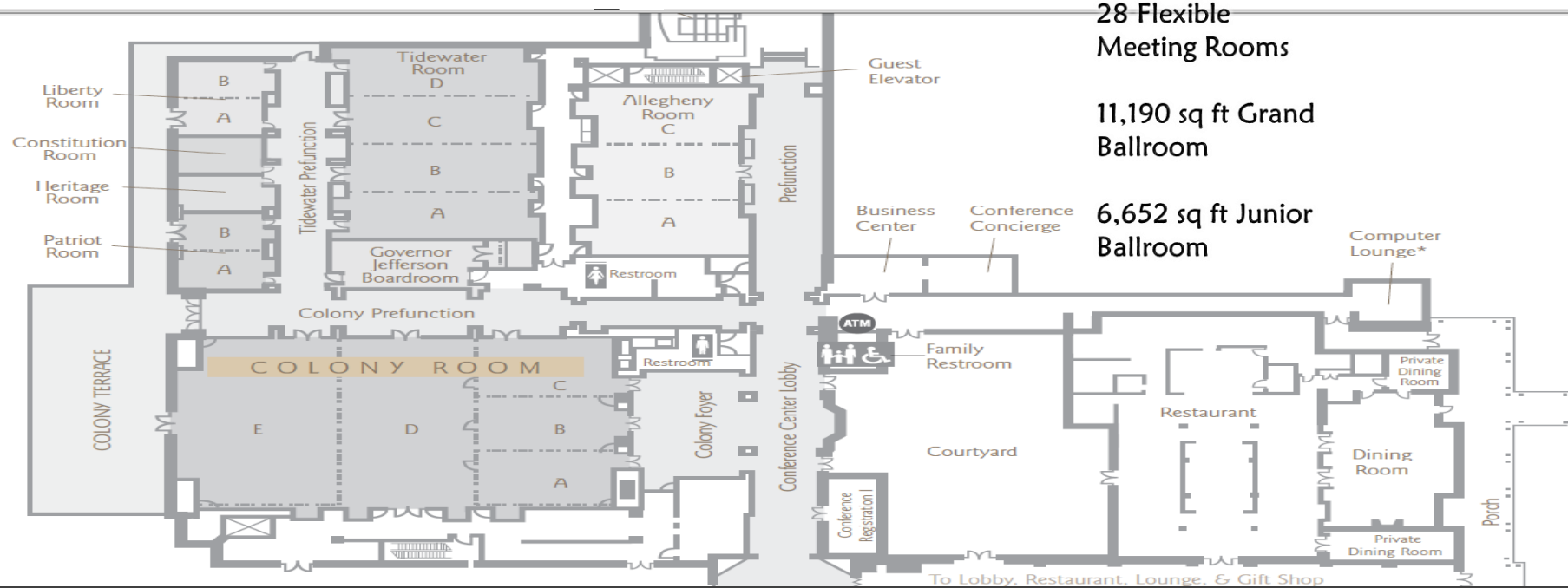

28 Flexible Meeting Rooms

11,190 sq ft Grand Ballroom

6,652 sq ft Junior Ballroom

To Lobby, Restaurant, Lounge, & Gift Shop

Golden Horseshoe Golf Club



The Spa of Colonial Williamsburg 20,000 sq. ft. spa



Shields Tavern – King's Arms Tavern – Christiana Campbell's Tavern – Chowning's Tavern



Sweet Tea and Barley Restaurant – Traditions Restaurant



State of Virginia Map



- **Location**

- 50 minutes away from (RIC) Richmond International Airport
- 50 minutes away from (ORF) Norfolk International Airport
- 22 minutes away from (PHF) Newport News Airport

Aerial Map of Colonial Williamsburg

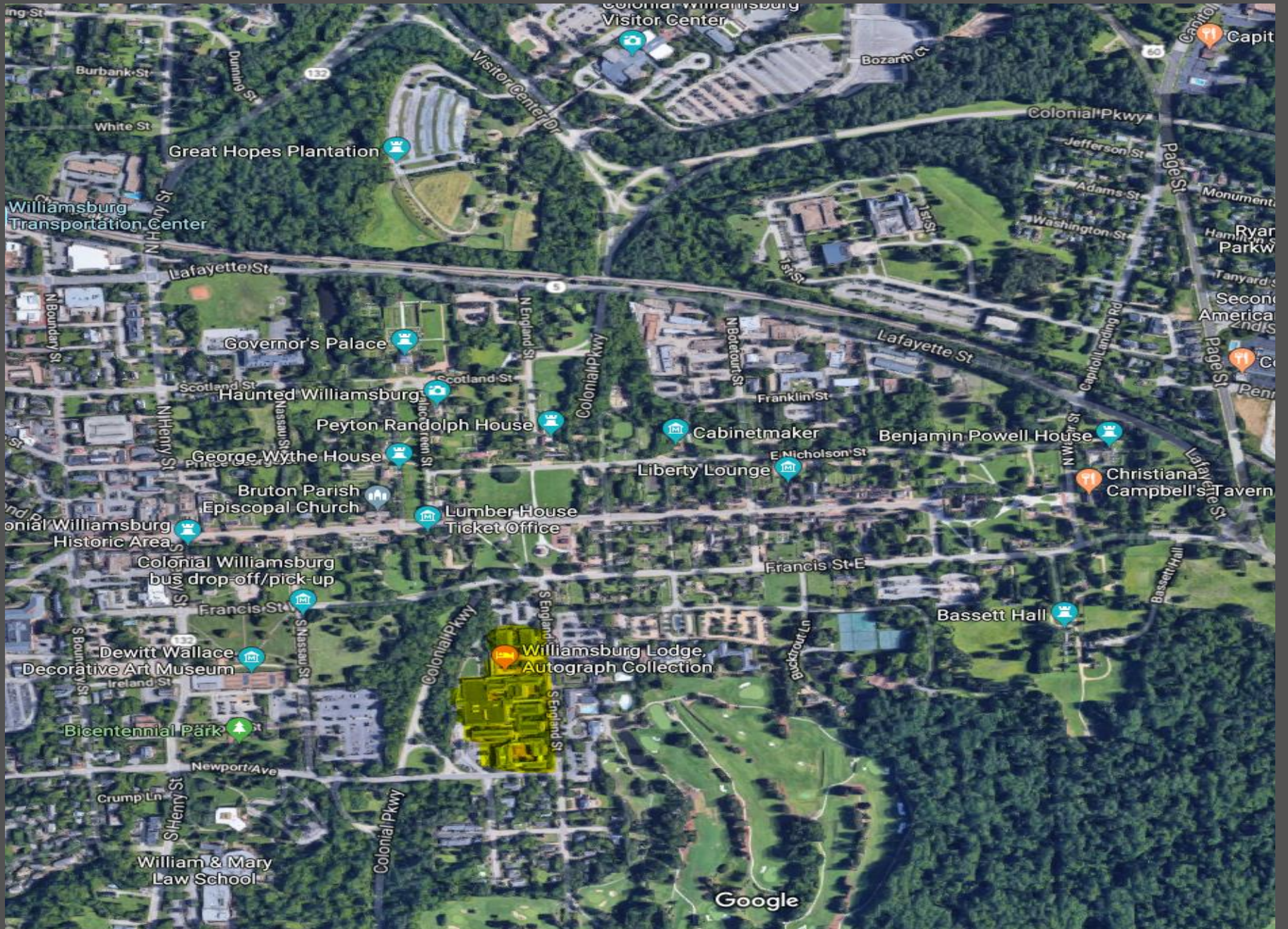

Fun & Exciting Team Activities At Your Finger Tips



Colonial Olympics

Roll a barrel, hoop & stick, quoits (horse shoes), trap ball.

Axe Throwing

18th century education and fun at your interpretive Axe Range. You'll learn the history of axe throwing during the Revolutionary War, the uses of belt axes and proper technique.



Fire a Flintlock Musket

Session includes range instructions, ammunition for weapons, targets, safety equipment and transportation to and from the range.

Tennis

We can host contests such as fastest serve, aiming at targets and round robin tournaments.



Game Show Trivia Night

Play rounds of trivia to include history, movies, music and more! Each team member receives a remote to answer the questions – not only does the system track who answers correctly, but who answered the fastest!

Taste Studio

Bourbon Tasting
Wine Tasting
Craft Beer Tasting
Experience new beers, wine, and spirits through samplings and food pairings. From sweet to savory, our chefs will deliver a unique and delicious culinary experience.

Stay Fit, Get Fit and Enjoy the Bassett Hall Nature Trail

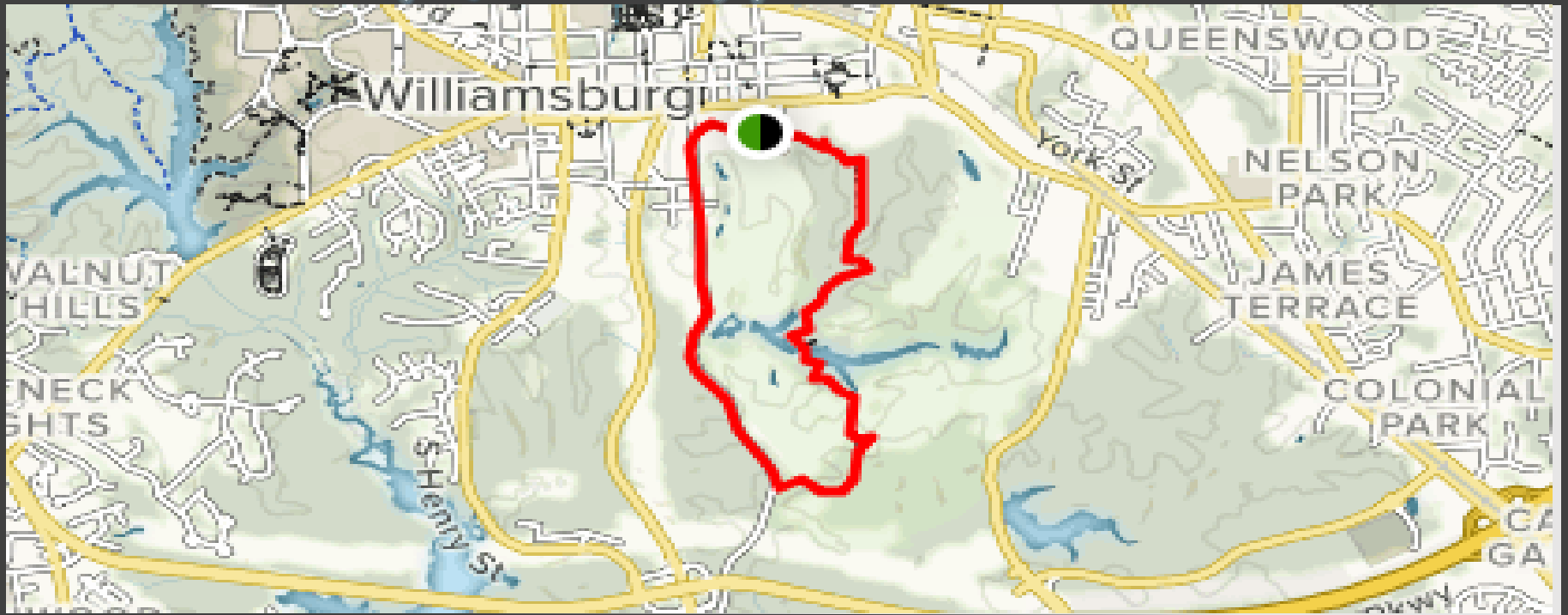

4.2 miles, surrounded by towering hardwood trees with occasional bodies of water to traverse and branch filtered views of the golf course.





WILLIAMSBURG
LODGE

— — — — —
GOLF • RESORT • SPA
AUTOGRAPH COLLECTION[®]
HOTELS

Greetings!

*Thank you so much for considering
the Williamsburg Lodge ! We would
love the opportunity to earn your
business!*

*Please feel free to contact me if you
have any questions as it will be my
pleasure to assist you!*

Juan Ayala

Director, National Accounts

Williamsburg Lodge

310 S. England Street

Williamsburg, VA 23185

P: 757.220.7457

Jayala@cwf.org

www.colonialwilliamsburghotels.com