

**SOCIETY FOR
PSYCHOPHYSIOLOGICAL
RESEARCH**
Forty-Seventh Annual Meeting

Hyatt Regency Hotel
Savannah, Georgia
October 17–21, 2007

Table of Contents

Author Index.....	121
Announcements	13
Board of Directors.....	4
Child Care	18
Committees.....	14
Early Careers Conversation Hour.....	16
Education and Training Committee Roundtable Discussion.....	16
Exhibitors.....	18
Future Annual Meetings.....	18
Historical Roster	6
Internet Station	17
Meeting Rooms.....	19
Poster Sessions.....	52
Pre-Conference Workshop	21
Program	21
Program Committee.....	3
Publication of Abstracts.....	13
Registration.....	12
Speaker Ready Room	18
Special Interest Luncheons and Dinners.....	15
SPR Fund Contributors	9
Women in Science Lunch Box Discussion.....	17

**SOCIETY FOR
PSYCHOPHYSIOLOGICAL
RESEARCH**

The purpose of the Society for Psychophysiological Research is to foster research on the interrelationships between the physiological and psychological aspects of behavior. Allied disciplines include psychology, physiology, neuroscience, medicine and engineering. To promote this purpose, the Society publishes scientific literature and holds annual meetings for presentation and discussion of topics, including instrumentation, methodology, experimental results, and theoretical interpretations.

Program Committee

- Chair: Ursula Hess, University of Quebec–Montreal
 Kimmo Alho, University of Helsinki
 Bruce Bartholomew (2008 Program Chair),
 University of Missouri–Columbia
 John Curtin (2006 Program Chair),
 University of Wisconsin–Madison
 Ulf Dimberg, Uppsala University
 Diane Filion, University of Missouri–Kansas City
 Greg Hajcak, Stony Brook University
 Alfons Hamm, University of Greifswald
 Larry Hawk, University of Buffalo
 Kenneth Hugdahl, University of Bergen
 Andreas Keil, University of Konstanz
 Michael W. Kiang, University of California,
 San Diego
 Becky Levin, University of Illinois,
 Urbana–Champaign
 Sheree N. Light, University of Wisconsin–Madison
 Ottmar V. Lipp, University of Queensland
 Sylvain Moreno, CNRS
 Femke Nijboer, Institute of Medical Psychology and
 Behavior, University of Tübingen
 Catherine J. Norris, University of Wisconsin
 John Polich, The Scripps Institute
 Thomas Ritz, Southern Methodist University
 Kevin Spencer, VA Boston/Harvard Medical School
 Anton van Boxtel, Tilberg University
 Frank H. Wilhelm, University of Basel
 Rex Wright, University of Alabama–Birmingham

OFFICERS

President, 2006–2007

Robert F. Simons

University of Delaware

President-Elect, 2006–2007

Monica Fabiani

University of Illinois, Urbana–Champaign

Past President, 2006–2007

Steven A. Hackley

University of Missouri–Columbia

Secretary, 2005–2008

Gary G. Berntson

Ohio State University

Treasurer, 2006–2009

Karen Quigley

New Jersey Medical School

Board of Directors

John J. B. Allen

University of Arizona (2005–2008)

John Connolly

Dalhousie University (2004–2007)

Edwin W. Cook III

University of Alabama–Birmingham (2007–2010)

Diane Filion

University of Missouri–Kansas City (2006–2009)

Herta Flor

University of Heidelberg (2006–2009)

Frances Gabbay

Uniformed Services University of Health Sciences
(2005–2008)

Erich Schröger

University of Leipzig (2005–2008)

Scott Vrana

Virginia Commonwealth University (2004–2007)

Editor, *Psychophysiology*

Robert F. Simons

University of Delaware (1/2006–12/2008)

SPR Office

Susan Rees, Executive Director
Amy Bayer, Membership Manager
Jane C. Shepard, Director of Meetings
Maria Davis, Exhibits Manager

Committee Chairs**Archives Committee**

Louis G. Tassinary
Texas A&M University (1994+)

Bylaws Committee

Magne Flaten
University of Tromsø (2005–2008)

Convention Sites Committee

Alfons Hamm
University of Greifswald (2005–2009)

Early Career Award Committee

Erin Hazlett
Mt. Sinai School of Medicine (2006–2009)

Education and Training Committee

John Curtin
University of Wisconsin–Madison (2004–2007)

Ethical Principles Committee

Lois E. Putnam
Columbia University (2006–2009)

Membership Committee

Denise M. Sloan
Temple University (2004–2007)
Dean Salisbury
Harvard Medical School (2005–2008)

Nominating Committee

Niels Birbaumer
University of Tübingen (2006–2007)

Committee to Promote Student Interests

John J. B. Allen (Chair, nonstudent)
University of Arizona (2005–2008)

Publications Committee

Edwin W. Cook III

University of Alabama–Birmingham (2006–2008)

Senior Award Committee

Monica Fabiani

University of Illinois, Urbana–Champaign
(2006–2007)**Tursky Award Committee**

Steven A. Hackley

University of Missouri–Columbia (2006–2007)

Web Site Committee

Richard Backs

Central Michigan University (2005–2009)

Ad Hoc Committees**Ad Hoc International Outreach Committee**

Eliane Volchan

Federal University of Rio De Janeiro

Yasunori Kotani

Tokyo Institute of Technology

PAST OFFICERS***Chair of the Organizing Board***

R. C. Davis 1958–60

Past Presidents

Chester W. Darrow 1960–61

John I. Lacey 1961–62

Albert F. Ax 1962–63

Marion A. Wenger 1963–64

Clinton C. Brown 1964–65

Robert Edelberg 1965–66

John A. Stern 1966–67

William W. Grings 1967–68

Laverne C. Johnson 1968–69

David T. Graham 1969–70

Bernard T. Engel 1970–71

Robert Roessler	1971–72
Bernard Tursky	1972–73
Frances K. Graham	1973–74
Paul A. Obrist	1974–75
David Shapiro	1975–76
Peter H. Venables	1976–77
Peter J. Lang	1977–78
Beatrice C. Lacey	1978–79
Emanuel Donchin	1979–80
David T. Lykken	1980–81
Enoch Callaway	1981–82
William F. Prokasy	1982–83
Edward S. Katkin	1983–84
Arne Ohman	1984–85
Jasper Brener	1985–86
Don C. Fowles	1986–87
Michael G. H. Coles	1987–88
Michael E. Dawson	1988–89
David A. T. Siddle	1989–90
J. Richard Jennings	1990–91
Cornelis H. M. Brunia	1991–92
John T. Cacioppo	1992–93
Stephen W. Porges	1993–94
Gregory A. Miller	1994–95
Marta Kutas	1995–96
William G. Iacono	1996–97
Judith M. Ford	1997–98
Risto Naatanen	1998–99
Richard J. Davidson	1999–2000
Robert W. Levenson	2000–01
Margaret M. Bradley	2001–02
Connie C. Duncan	2002–03
Bruce N. Cuthbert	2003–04
Niels Birbaumer	2004–05
Steven A. Hackley	2005–06

Past Secretary-Treasurer

Albert F. Ax	1960–62
Martin Orne	1962–63
Lawrence A. Gustafson	1963–64
Betty A. Wieland	1965–68
David G. McDonald	1968–72
Kenneth M. Kleinman	1972–75

Stephen W. Porges	1975–78
Rafael Klorman	1978–81
Don C. Fowles	1981–84
Robert W. Levenson	1984–87
Robert J. Gatchel	1987–90
Gregory A. Miller	1990–93
Steven A. Hackley	1993–96
Connie C. Duncan	1996–99
Edwin W. Cook, III	1999–02
Robert F. Simons	2002–05

***AWARDS FOR DISTINGUISHED
CONTRIBUTIONS TO
PSYCHOPHYSIOLOGY***

Chester W. Darrow	1969
R. C. Davis	1969
Marion A. Wenger	1970
John I. Lacey	1970
Albert F. Ax	1973
Robert Edelberg	1974
William W. Grings	1978
Frances K. Graham	1981
Donald B. Lindsley	1984
Paul A. Obrist	1985
Peter H. Venables	1987
David Shapiro	1988
E. N. Sokolow	1988
Peter J. Lang	1990
John Stern	1993
Emanuel Donchin	1994
Risto Naatanen	1995
David T. Lykken	1998
Steven A. Hillyard	1999
John T. Cacioppo	2000
Arne Ohman	2001
Michael G. H. Coles	2002
Robert M. Stern	2004
Kees Brunia	2005

***AWARDS FOR DISTINGUISHED
EARLY CAREER CONTRIBUTIONS
TO PSYCHOPHYSIOLOGY***

Connie C. Duncan	1980
Kathleen C. Light	1980
John T. Cacioppo	1981
William G. Iacono	1982
Graham Turpin	1984
Ray Johnson, Jr.	1985
Alan J. Fridlund	1986
J. Rick Turner	1988
Ulf Dimberg	1988
Kimmo Alho	1990
Thomas W. Kamarck	1991
Steven A. Hackley	1992
George R. Mangun	1993
Christopher J. Patrick	1993
Cyma Van Petten	1994
Friedemann Pulvermuller	1995
Erich Schroger	1996
Brett A. Clementz	1997
Gabriele Gratton	1997
Christopher R. France	1998
Axel Mecklinger	1999
John J. B. Allen	2000
James J. Gross	2000
Martin Heil	2001
Eddie Harmon-Jones	2002
Thomas Ritz	2003
Frank Wilhelm	2004
Kent A. Kiehl	2005
Kara Federmeier	2006
Diego Pizzagalli	2006

2006–2007 FUND CONTRIBUTORS

John J. B. Allen
 Andrey Anokhin
 Theodore Beauchaine
 Gary G. Berntson
 Florian Bublitzky
 Scott Carlson
 Quetzal Class

Ruth Condray
Bruce Cuthbert
Bernhard Dahme
Sonja Damnjanovic
Eco De Geus
Jakob de Lemos
Vilfredo De Pascalis
Roberto Dell Acqua
Heath Demaree
Shenandoah DeVore
Jane Doussard-Roosevelt
Stefan Duschek
Jane Dyonzak
Jane Dywan
Ulrich Ebner-Priemer
Francisco Esteves
Ulrich Ettinger
Monica Fabiani
Diane Filion
Ira Fischler
Kyosuke Fukuda
Hilary Gomes
Jennifer Gordon
Gabriele Gratton
Steven A. Hackley
Alfons Hamm
Eddie Harmon-Jones
Louise Hawkley
Erin Hazlett
Richard Hazlett
Sabine Heim
Shinji Hira
Volker Hodapp
James Hopper
Rebecca Houston
J. Jennings
Danny Kaloupek
Thomas Kamarck
Norbert Kathmann
Jurgen Kayser
Andreas Keil
John Kircher
Yasunori Kotani
E. Evan Krauter

Nina Kupper
Glenn Leshner
Ottmar Lipp
Andreas Loew
Christopher Lovelace
Hiroaki Masaki
John McDonald
Michael McKay
Terence McMorris
Axel Mecklinger
Wendy Mendes
Mitsuyoshi Mizutani
Pedro Montoya
James Morrison
Andreas Muhlberger
Gillian Munro
Tamara Newton
Keith Nuechterlein
Brian O'Donnell
Hideki Ohira
Atsushi Ohsaga
Elena Orekhova
Diego Pizzagalli
John Polich
Dean Pollina
Polina Potanina
Karen Quigley
Ruth Reinsel
Thomas Ritz
Michela Sarlo
Anne Schell
Kathrin Schlemmer
Astrid Schloerscheidt
Harald Schupp
Andreas Schwerdtfeger
David Shapiro
David Siddle
Robert F. Simons
Denise M. Sloan
Tytus Sosnowski
Yu Tanaka
Mattie Tops
Aurora Torres
Heather Urry

Johanna Van Hooff
Eric Vanman
Jaime Vila
Sara Webb
Peter Weyers
Jan Wiersema
Frank Wilhelm
Katuo Yamazaki
Cindy Yee-Bradbury

GENERAL INFORMATION

Registration

Registration will be held in the Regency Ballroom Foyer at the Hyatt Regency Hotel during the following hours:

Wednesday, October 17	5:30 P.M.—8:00 P.M.
Thursday, October 18	7:30 A.M.—4:00 P.M.
Friday, October 19	8:00 A.M.—4:00 P.M.
Saturday, October 20	8:30 A.M.—3:00 P.M.

Audible signals from pagers and cellular phones may be a distraction to the speaker as well as the audience. Please program these accordingly, and take phone calls outside of the meeting rooms. Thank you!

Poster Sessions

Poster sessions will be held in the Harborside Center at the Hyatt Regency Hotel.

The schedule for poster presentation setup and dismantle is as follows:

Thursday, October 18, 2007

Poster Session I

8:00 A.M.—9:30 A.M.	Posters Assembled
9:30 A.M.—6:15 P.M.	Posters Available for Viewing
6:15 P.M.—8:15 P.M.	Authors Present for Discussion and Questions
8:15 P.M.—9:15 P.M.	Dismantle Posters

Friday, October 19, 2007

Poster Session II

8:00 A.M.–9:30 A.M.	Posters Assembled
9:30 A.M.–6:00 P.M.	Posters Available for Viewing
6:00 P.M.–8:00 P.M.	Authors Present for Discussion and Questions
8:00 P.M.–9:00 P.M.	Dismantle Posters

Saturday, October 20, 2007

Poster Session III

8:00 A.M.–9:30 A.M.	Posters Assembled
9:30 A.M.–7:00 P.M.	Posters Available for Viewing
7:00 P.M.–9:00 P.M.	Authors Present for Discussion and Questions
9:00 P.M.–10:00 P.M.	Dismantle Posters

All posters must be removed during the designated dismantle time for each session. Thank you!

Announcements

You are invited to use the bulletin board near the SPR Registration Desk to post the following information:

- Employment Opportunities
- Announcement of Social Activities
- Special Interest Lunches or Dinners
- Messages to Attendees

Publication of Abstracts

Abstracts of papers presented in the symposia and the poster sessions are published in the September 2007 supplement volume of *Psychophysiology*. If you do not receive a copy in the mail, a limited number of copies will be available at the SPR Registration Desk.

COMMITTEE MEETINGS

Please confirm the time and place of each meeting with the chair of the committee.

Board of Directors

Chair: Robert F. Simons (rsimons@psych.udel.edu)

Wednesday, 12:00 noon–5:30 P.M. (Westbrook)

Sunday, 8:30 A.M.–12:00 noon (Westbrook)

Committee to Promote Student Interests

Chair: John J. B. Allen (jallen@u.arizona.edu)

Friday, 8:00 P.M.–10:00 P.M.

(Location to be announced)

All students are welcome!

General Business Meeting and Luncheon

Saturday, 12:15 P.M.–2:15 P.M.

(Scarborough Ballroom)

Past Presidents' Dinner

Saturday, 6:00 P.M.–8:00 P.M. (Dinner)

2007 Program Committee

Chair: Ursula Hess (hess.ursula@uqam.ca)

Thursday, 11:30 A.M.–1:00 P.M. (Lunch)

2008 Program Committee

Chair: Bruce D. Bartholow

Friday, 11:30 A.M.–1:00 P.M. (Lunch)

Education and Training Committee

Chair: John Curtin (jjcurtin@wisc.edu)

Thursday, 11:30 A.M.–1:00 P.M. (Lunch)

The Psychophysiology Board of Associate Editors

Robert F. Simons (rsimons@psych.udel.edu)

Thursday, 5:00 P.M.–6:00 P.M. (Plimsoll Room)

Publications Committee

Chair: Edwin W. Cook III (ecook@uab.edu)

Thursday, 11:30 A.M.–1:00 P.M. (Lunch)

Web Site Committee

Chair: Richard W. Backs (backs1rw@cmich.edu)
Friday, 11:30 A.M.–1:00 P.M. (Lunch)

***SPECIAL INTEREST LUNCHEONS
AND DINNERS***

As in previous years, small group lunches and dinners will be held to provide an informal setting for people to meet and share common interests. If space remains available following advance registration, sign-up sheets will be posted in the SPR Registration Area on the announcements board.

***Psychophysiological Research with
Military and Veteran Populations***

Contact: Karen Quigley (karen.quigley@va.gov)
Thursday, October 18, 2007, 11:30 A.M.–1:00 P.M.

Social Neuroscience

Contact: David Amodio (dma7@nyu.edu)
Friday, October 19, 2007, 11:30 A.M.–1:00 P.M.

NEW TO SPR??

If you are a student and this is your first time at an SPR conference, please feel free to approach anyone with a dot on their name tag. Those of us with dots are “Meet and Greet” members of the Committee to Promote Student Interests. We are here as a resource for you and are happy to answer questions, chat, introduce you to others, and/or provide more information about SPR and student opportunities (e.g., student travel awards and the student social). We hope you enjoy the conference!

**EDUCATION AND TRAINING
COMMITTEE
ROUNDTABLE DISCUSSIONS**

11:30 A.M.–1:00 P.M.

Thursday, October 18, 2007

Verelst Room

This year, there will once again be the opportunity to participate in the Roundtable Discussions during the lunch break on Thursday (lunch included!) at the Hyatt Regency Hotel. Each topic will be led by one or more leaders in their respective fields.

*Perspectives on EEG Asymmetry: Different
Measurement and Conceptualization Issues*

Wendy Heller and Jim Coan

EMG Methodology: Startle and Post-Auricular Reflex

Terry Blumenthal and Steven A. Hackley

High Density EEG

Don Tucker

Setting Up a Psychophysiology Laboratory

John Curtin

Ambulatory Psychophysiology:

Bringing the Lab to Real Life

Frank Wilhelm

To participate in one of these discussions, please contact Edelyn Verona (everona@uiuc.edu) to RSVP by September 28, 2007. Each roundtable is limited to 10 people.

**EARLY CAREERS
CONVERSATION HOUR**

8:15 P.M.–10:15 P.M.

Scarborough Ballroom 1

Thursday, October 18, 2007

Don't miss this opportunity to discuss early career issues with some of SPRs leading scientists! Please RSVP to Catherine Norris

(catherine.j.norris@dartmouth.edu) by September 28, 2007 if you plan to attend. You may also contact Catherine if you have suggestions or questions regarding this event.

WOMEN IN SCIENCE LUNCH BOX DISCUSSION

11:30 A.M.–1:30 P.M.

Verelst Room

Friday, October 19, 2007

Please join us for the Second Annual Women in Science Lunch Box Discussion. All SPR members, including men, are invited to attend. The discussion topic will be focused on negotiation skills involved in obtaining a competitive salary, sufficient start-up costs, and lab space for new faculty and continuing negotiations relevant to later career stages. Women tend to struggle with negotiation and are more than two times as likely than men to self-report that they feel apprehension and pessimism about the negotiation process. Compared to men, women typically negotiate for less and receive less when they do negotiate (<http://www.womendontask.com/stats/html>). The discussion will be facilitated by a panel of invited speakers composed of academic leaders from different workplace environments (e.g., medical setting, research university, small college). Registration for this event is required and lunch will only be provided to registered participants. To register, please contact Becky Levin (rllevin@cyrus.psych.uiuc.edu) prior to September 28, 2007.

INTERNET STATION

An internet station will be available for all attendees at the following times in the Regency Ballroom Foyer:

Thursday, October 18	8:00 A.M.–9:00 P.M.
Friday, October 19	8:00 A.M.–9:00 P.M.
Saturday, October 20	8:00 A.M.–5:00 P.M.

SPEAKER READY ROOM

If you are speaking at the meeting, plan time to visit the Speaker Ready Room to review your presentation. It will be located in the Portside Room and open during the following hours:

Thursday, October 18	7:00 A.M.–5:00 P.M.
Friday, October 19	7:00 A.M.–5:00 P.M.
Saturday, October 20	7:00 A.M.–1:00 P.M.

CHILD CARE

In need of child care while you are at the SPR meeting? Superwomen Services provides child care based on individual requests. For more information on child care, associated costs and availability, please contact Superwomen Services directly at 1-912-303-9288. (*This service is not sponsored nor endorsed by the SPR; it is provided for information purposes only.*)

FUTURE ANNUAL MEETINGS

2008 Annual Meeting

Hilton Hotel
Austin, Texas, USA
October 1–5, 2008

EXHIBITORS

Please take time while you are at the SPR meeting to visit the exhibit area located on the Mezzanine Level at the Hyatt Regency Savannah. Exhibitors contribute financial support to the SPR meeting and we ask that you take a few minutes to spend time in the exhibit area looking at the products, services and equipment offered by the companies represented. Thank you!

Open Hours

Thursday, October 18	8:00 A.M.–3:00 P.M.
Friday, October 19	8:00 A.M.–3:00 P.M.
Saturday, October 20	8:00 A.M.–10:30 A.M.

Hyatt Regency Hotel Savannah

Lobby Level

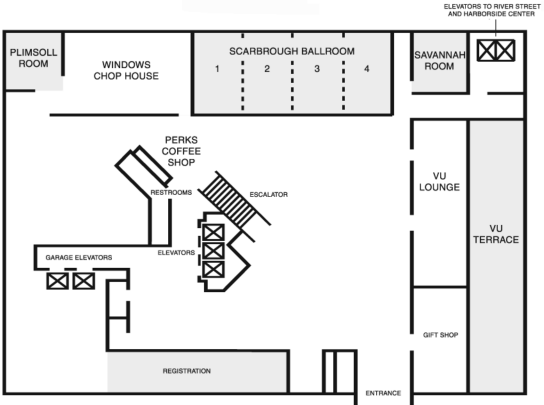

Second Floor

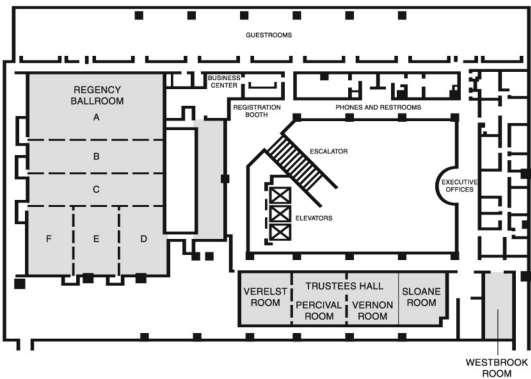

Hyatt Regency Hotel Savannah

Harborside Center

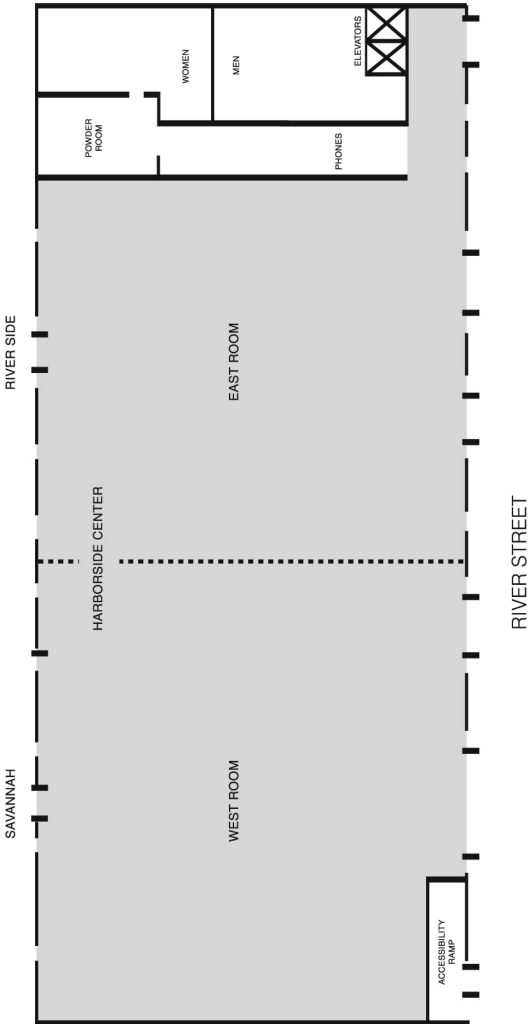

PROGRAM**Tuesday, October 16, 2007**

8:30 A.M.—5:00 P.M.

*Verelst Room****Pre-Conference Workshop I***

(available for an additional fee)

The ERP Mini Boot Camp

Steve J. Luck, PhD, Professor, Center for Mind and Brain, University of California, Davis, Davis, CA

The *ERP Mini Boot Camp* is a two-day condensed workshop version of Steve Luck's 10-day *ERP Boot Camp*. Back by popular demand, the workshop will provide an intensive introduction to the ERP technique, designed for beginning and intermediate ERP researchers at the graduate, postdoctoral, and faculty levels. The goal of the *Boot Camp* is to provide an in-depth introduction to the everyday procedures that are used in ERP research, with an emphasis on how various procedures are actually performed and why they are performed that way.

The *Boot Camp* will consist of a set of lectures and demonstrations by Steve Luck that are tightly linked with his book, *An Introduction to the Event-Related Potential Technique* (MIT Press). Topics will include the following:

ERP Components

Design and Interpretation of ERP Experiments

Electrodes, Amplifiers, Filters, and Noise

Averaging, Artifact Rejection, and Artifact Correction

Measurement and Analysis of ERP Components

ERP Localization

Setting Up and Running an ERP Lab

Tuesday, October 16, 2007

8:30 A.M.—10:00 A.M.

Lecture 1:
Introduction to ERPS and Common
ERP Components
Reading: Luck (2005, Ch. 1)

10:00 A.M.—10:15 A.M.

Refreshment Break

10:15 A.M.—11:45 A.M.

Lecture 2: Understanding the Nature of
ERP Components
Reading: Luck (2005, Ch. 2)

11:45 A.M.—1:00 P.M.

Lunch Break (on your own)

1:00 P.M.—2:00 P.M.

Lecture 3: Design and Interpretation of
ERP Experiments
Reading: Luck (2005, Ch. 2)

2:00 P.M.—3:00 P.M.

Lecture 4: An Example of Experimental Design
Reading: Vogel, Luck, and Shapiro (1998)

3:00 P.M.—3:15 P.M.

Refreshment Break

3:15 P.M.—5:00 P.M.

Lecture 5: Recording ERPS

Reading: Luck (2005, Ch. 3)

Wednesday, October 17, 2007

8:30 A.M.—5:00 P.M.

*Regency Ballroom A****Pre-Conference Workshop***The ERP Mini Boot Camp (continued)

8:30 A.M.—10:00 A.M.

Lecture 6: Averaging and Artifacts*Reading: Luck (2005, Ch. 4)*

10:00 A.M.—10:15 A.M.

Refreshment Break

10:15 A.M.—11:45 A.M.

Lecture 7: Filtering*Reading: Luck (2005, Ch. 5)*

11:45 A.M.—1:00 P.M.

Lunch Break (on your own)

1:00 P.M.—2:00 P.M.

***Lecture 8: Plotting, Measurement,
and Statistics****Reading: Luck (2005, Ch. 6)*

2:00 P.M.—3:00 P.M.

Lecture 9: Setting Up and Running an ERP Lab*Reading: Luck (2005, Ch. 8)*

3:00 P.M.—3:15 P.M.

Refreshment Break

3:15 P.M.—5:00 P.M.

Lecture 10: ERP Localization

Reading: Luck (2005, Ch. 7)

Readings

Luck, S. J. (2005). *An Introduction to the Event-Related Potential Technique*. Cambridge, MA: MIT Press.

Vogel, E. K., Luck, S. J., and Shapiro, K. L. (1998). Electrophysiological evidence for a postperceptual locus of suppression during the attentional blink. *Journal of Experimental Psychology: Human Perception and Performance*, 24, 1656–1674.

12:00 noon—5:30 P.M.

Westbrook

SPR Board of Directors Meeting

5:30 P.M.—8:00 P.M.

Regency Ballroom Foyer

Registration Opens

5:30 P.M.—8:00 P.M.

Scarborough Ballroom

Opening Reception

(cash bar and hors d'oeuvres)

All attendees are welcome!

Thursday, October 18, 2007

7:30 A.M.—4:00 P.M.

*Regency Ballroom Foyer****Registration***

8:30 A.M.—10:00 A.M.

Symposia Sessions

8:30 A.M.—10:00 A.M.

*Regency Ballroom A****Symposium 1*****The Role of the Amygdala in Social/Emotional Cognition Across Development**

Chair: Erin B. McClure

*Georgia State University***Neural Processing of Threat-Related Facial Expressions in Young People with Depression, Anxiety, or No History of Psychiatric Disorder**

Erika E. Forbes, Sarah M. Brown, Patrick M. Fisher, Samantha L. Martin, Boris Birmaher, David Axelson, Ronald E. Dahl, Neal D. Ryan, & Ahmad R. Hariri

*University of Pittsburgh***Facial Emotion Processing in Borderline Personality Disorder: An fMRI Study of Amygdala Response to Overt and Masked Facial Expressions**

Nathalie Vizueta, S. C. Schultz, & Kathleen M. Thomas

University of Minnesota

How Young and Older Adults Process and Remember Emotional Information

Elizabeth A. Kensinger
Boston College

Dissociable Medial Temporal Lobe Contributions to Social Memory

Leah H. Somerville, Gagan S. Wig, Paul S. Whalen, & William M. Kelley
Dartmouth College

Responses to Social Conflict in Youth with Mood and Anxiety Disorders

Erin B. McClure¹, Norberto E. Nawa², Eric E. Nelson³, Jessica M. Parrish⁴, Daniel S. Pine³, & Monique Ernst³
¹*Georgia State University*, ²*ATR Cognitive Information Laboratories*, ³*National Institute of Mental Health*, ⁴*Catholic University*

8:30 A.M.—10:00 A.M.
Scarborough Ballroom 1

Symposium 2

Cortical Dynamics for Visual Knowledge about Objects: Where Vision Meets Memory

Chair: Haline E. Schendan
Tufts University

ERP and fMRI Studies Reveal the Cortical Dynamics of Visual Object Knowledge

Haline E. Schendan
Tufts University

ERP Evidence for Access to Object Memories During Figure-Ground Perception

Logan T. Trujillo¹, Mary A. Peterson², & John J. B. Allen²
¹*University of Texas at Austin*, ²*University of Arizona*

Encoding-Related Neural Activity of Perceptual Priming: Effects of Object Structure

Anja Soldan, Yaakov Stern, Jennifer Mangels,
John Hilton, Eric Zarahn, & Lynn Cooper
Columbia University

Distinguishing Explicit Memory and Conceptual Implicit Memory Electrophysiologically

Joel L. Voss & Ken A. Paller
Northwestern University

8:30 A.M.—10:00 A.M.
Scarborough Ballroom 3

Symposium 3**Deception Detection: New Procedures and Techniques for the 21st Century**

Chairs: Bruno Verschuere¹ & Peter Rosenfeld²
¹*Ghent University*, ²*Northwestern University*
Discussant: Gershon Ben-Shakhar
The Hebrew University of Jerusalem

Combining Psychophysiology and Forced Choice in the Detection of Concealed Information

Ewout H. Meijer, Fren Ty Smulders, & Harald
L. G. J. Merckelbach
Maastricht University

Slow Down and Start Sweating: Reaction-Times and Skin Conductance for the Detection of Concealed Information

Bruno Verschuere
Ghent University

The Complex Trial Protocol (CTP): A New, Countermeasure-Resistant, Accurate P300-Based Method for Detection of Concealed Information

Peter Rosenfeld
Northwestern University

fMRI Studies of Different Types of Deception

Giorgio Ganis¹ & Stephen M. Kosslyn²
¹*Harvard University*, ²*Harvard Medical School*

Clinical and Theoretical Implications of the Functional Magnetic Resonance Imaging (fMRI) Studies of Deception

Daniel Langleben
University of Pennsylvania School of Medicine

10:00 A.M.—10:30 A.M.
Mezzanine Level

Refreshment Break

10:30 A.M.—11:30 A.M.
Regency Ballroom D

Invited Address

Neural Systems Involved in Fear Extinction: Relevance to Psychotherapy

Michael Davis, PhD
Robert W. Woodruff Professor of Psychiatry, Behavioral Sciences and Psychology, Emory University Department of Psychiatry, Yerkes National Primate Center, Atlanta, GA

11:30 A.M.—1:00 P.M.

Break for Lunch (on your own)

11:30 A.M.—1:00 P.M.

Verelst Room

***Education and Training Committee
Roundtable Discussions***

This year, there will once again be the opportunity to participate in the roundtable discussions. Each topic will be led by one or more leaders in their respective fields. To participate in one of these discussions, please contact Edelyn Verona (everona@uiuc.edu) to RSVP by September 28, 2007. Each roundtable is limited to 10 people.

Perspectives on EEG Asymmetry: Different Measurement and Conceptualization Issues

Wendy Heller & Jim Coan

EMG Methodology: Startle and Post-Auricular Reflex

Terry Blumenthal & Steven A. Hackley

High Density EEG

Don Tucker

Setting Up a Psychophysiology Laboratory

John Curtin

Ambulatory Psychophysiology: Bringing the Lab to Real Life

Frank Wilhelm

1:00 P.M.—2:30 P.M.

Regency Ballroom D

Presidential Symposium

Twenty-Seven Years of the Psychophysiology of Language Processing

Chair: Phillip J. Holcomb

Tufts University

Discussant: Marta Kutas

University of California, San Diego

**Access to Embedded Words in
Speech Perception**

Cyma Van Petten¹, Pedro Macizo², & Polly
O'Rourke¹

¹University of Arizona, ²University of Granada

**Does the Brain See Language the Way
Linguists Do? Processing Parallels Across
Syntactic and Discourse
Referential Dependencies**

Robert Kluender

University of California, San Diego

**Dynamic Adjustments to Lies Reflected in P2
and N400**

Bernadette M. Jansma

University of Maastricht

**Deriving Meaning from ERPS ... and
Other Acronyms**

Kara D. Federmeier & Sarah Laszlo

University of Illinois, Urbana—Champaign

2:30 P.M.—3:00 P.M.

Mezzanine Level

Refreshment Break

3:00 P.M.—4:30 P.M.

Symposia Sessions

3:00 P.M.—4:30 P.M.

Regency Ballroom A

Symposium 4

**Spotting Danger: Stimulus Properties and
Individual Differences Underlying
Threat Detection**

Chair: Christine L. Larson

University of Wisconsin—Milwaukee

**Attentional Capture by Dynamic
Threatening Stimuli**

Luis Carretié¹, José A. Hinojosa², Sara López-
Martín¹, & Jacobo Albert¹

¹*Universidad Autónoma de Madrid*, ²*Universidad
Complutense de Madrid*

**Brain, Body, and Cognition: Neural,
Physiological and Self-Report Correlates of
Phobic and Normative Fear**

Hillary S. Schaefer¹, Christine L. Larson², &
Richard J. Davidson³

¹*University of Virginia*, ²*University of Wisconsin-
Milwaukee*, ³*University of Wisconsin-Madison*

Visual Consciousness and Threat Detection

Stefan Wiens

Stockholm University

**The Shape of Threat: Simple Geometric Shapes
Activate Attentional Bias and Neural Circuitry
Instantiating the Detection of Threat**

Christine L. Larson¹, Joel Aronoff², & David C.
Zhu²

¹*University of Wisconsin-Milwaukee*, ²*Michigan
State University*

3:00 P.M.—4:30 P.M.

Scarborough Ballroom 1

Symposium 5**Issues in Frontal EEG Asymmetry as a Marker
of Risk for Psychopathology**

Chair: Robin Nusslock

University of Wisconsin-Madison

Discussant: John J. B. Allen

University of Arizona

**Frontal EEG Alpha Asymmetry in Depression:
The Role of Clinical State and
Emotion Regulation**

Robin Nusslock¹, Alexander J. Shackman¹,
Brenton W. McMenamin¹, Larry L. Greischar¹,
Marika Kovacs², & Richard J. Davidson¹
¹*University of Wisconsin—Madison*, ²*University of
Pittsburgh*

**Frontal EEG Asymmetry, Psychopathology
Risk, and Emotion Regulation Capabilities**

James A. Coan
University of Virginia

**Effect of Bipolar Disorder on Relative Left
Frontal Cortical Responses to Goals Differing
in Valence and Task Difficulty**

Eddie Harmon-Jones¹, Lyn Y. Abramson²,
Robin Nusslock², Jonathan D. Sigelman²,
Snezana Urosevic², Lee Turonie², & Meghan
Fearn²
¹*Texas A&M University*, ²*University of
Wisconsin—Madison*

**Internal Consistency Reliability of Frontal
EEG Asymmetry**

David N. Towers & John J. B. Allen
University of Arizona

4:30 P.M.—4:45 P.M.

Break

4:45 P.M.—6:15 P.M.

Symposia Sessions

4:45 P.M.—6:15 P.M.

Regency Ballroom A

Symposium 6

Stress Sensitization and Fear Learning in Posttraumatic Stress Disorder

Chairs: Michele Wessa¹ & Anke Karl²

¹*University of Heidelberg*, ²*University of Southampton*

Endocrine and Inflammatory Dysregulations in Posttraumatic Stress Disorder

Nicolas Rohleder¹, Jutta M. Wolf¹, Ljiljana Joksimovic², & Clemens Kirschbaum³

¹*University of British Columbia*, ²*University of Düsseldorf*, ³*Dresden University of Technology*

Stress-Induced Analgesia in Posttraumatic Stress Disorder: An fMRI Study

Michele Wessa, Slawomira Lipinski, Christoph Christmann, Stephanie Ridder, Simone Lang, & Herta Flor

University of Heidelberg

Generalization of Conditioned Fear as a Pathogenic Marker of PTSD

Shmuel Lissek, Stephanie Rabin, Arter Biggs, Ruben Alvarez, Brian Cornwell, Meena Vythilingam, & Christian Grillon

National Institute of Mental Health

Biopsychological Risk Factors and Correlates of PTSD and its Successful CBT Treatment

Anke Karl¹, Sirko Rabe², Katja Pohnitzsch², Tanja Zollner², Andreas Maercker³, Klaus-Peter Lesch⁴, & Alexander Strobel²

¹*University of Southampton*, ²*Dresden University of Technology*, ³*University of Zurich*, ⁴*University of Würzburg*

4:45 P.M.—6:15 P.M.

Scarborough Ballroom 1

Symposium 7

The Psychophysiology of Adult Attachment

Chair: James A. Coan

University of Virginia

Discussant: John T. Cacioppo

University of Chicago

Co-Regulation: The Psychophysiology of Normative Adult Attachment

David A. Sbarra¹, Emilio Ferrer², & Cindy Hazan³

¹*University of Arizona*, ²*University of California, Davis*, ³*Cornell University*

Adult Attachment Styles Moderate the Social Regulation of Neural Threat Responding

James A. Coan¹, Hillary S. Schaefer¹, David A. Sbarra², & Richard J. Davidson³

¹*University of Virginia*, ²*University of Arizona*, ³*University of Wisconsin—Madison*

Sympathetic and Parasympathetic Nervous System Reactivity and Regulation Among Anxiously and Avoidantly Attached Adults

Lisa M. Diamond, Angela Hicks, & Kimberly Otter-Henderson

University of Utah

Attachment Behaviors as a Combination of Sensitivity and the Ability to Control

Omri Gillath

University of Kansas

6:15 P.M.—8:15 P.M.

Harborside Center

Poster Session I

8:15 P.M.—10:15 P.M.

Scarborough Ballroom 2

Early Careers Conversation Hour

Don't miss this opportunity to discuss early career issues with some of SPR's leading scientists! Please

RSVP to Catherine Norris

(catherine.j.norris@dartmouth.edu)

by September 28, 2007 if you plan to attend.

Friday, October 19, 2007

8:00 A.M.—4:00 P.M.
Regency Ballroom Foyer

Registration

8:30 A.M.—10:00 A.M.

Symposia Sessions

8:30 A.M.—10:00 A.M.
Regency Ballroom A

Symposium 8

**Neurophysiological Correlates of Emotion
Regulation in Adults and Children**

Chair: Tracy A. Dennis
Hunter College, The City University of New York

**Dismantling Reappraisal: Emotion, Cognition,
and the Late Positive Potential**

Greg Hajcak, Jonathan P. Dunning, & Dan
Foti
Stony Brook University

**ERP Markers for the Cognitive Control of
Emotion: Implications for Emotion Regulation**

Tracy A. Dennis
Hunter College, The City University of New York

**Neurophysiological Correlates of Maternal
Empathy and Emotion Regulation**

Jim Stieben
York University

**Neural Correlates of Attentional Control:
Implications for Individual Differences in
Emotion Regulation**

Heather A. Henderson
University of Miami

8:30 A.M.—10:00 A.M.
Scarborough Ballroom 1

Symposium 9

Emerging Perspectives in Cardiovascular Psychophysiology: RSA, Vagal Tone and Beyond

Chair: Frank H. Wilhelm
University of Basel

Discussant: Gary G. Berntson
The Ohio State University

Sympathetic and Parasympathetic Cardiovascular Responses to Monetary Incentives Among Children and Adolescents at Risk for Delinquency

Ted P. Beauchaine
University of Washington

Facts about Respiratory Sinus Arrhythmia (RSA) and Cardiac Vagal Control

Paul Grossman
University Hospital of Basel

Interpretation of RSA in Psychophysiology: Correction for Respiration Can Make a Difference

Thomas Ritz
Southern Methodist University

Attenuated Metabolic-Cardiorespiratory Coupling During Daily Life in Patients with Anxiety Disorders: Exploration of a New Phenomenon

Frank H. Wilhelm¹, Monique C. Pfaltz¹, Tanja Michael¹, Jens Blechert¹, Vitaliy Kolodyazhnyi¹, Jürgen Margraf¹, & Paul Grossman²
¹*University of Basel*, ²*University Hospital of Basel*

8:30 A.M.—10:00 A.M.

Scarborough Ballroom 3

Symposium 10

Personality, Affect, and Cardiovascular Response: Evidence for Motivational Gains and Deficits

Chair: Guido H. E. Gendolla
University of Geneva

Feeling Worn Out: Studies of Fatigue Influence on Cardiovascular Response

Rex A. Wright
University of Alabama—Birmingham

The Joint Effect of Depression and Task Difficulty on Performance-Related Cardiovascular Reactivity

Guido H. E. Gendolla & Kerstin Brinkmann
University of Geneva

Dysphoric Individuals Do Not Respond to Reward: Research on Cardiovascular Reactivity

Kerstin Brinkmann, Guido H. E. Gendolla, & Isabelle Ancel Joye
University of Geneva

Agentic Extraversion and Mobilization of Effort: Effects on Autonomic Activation Components

Mira-Lynn Chavanon¹, Anja Leue¹, Christoph Kemper², & Gerhard Stemmler¹
¹*Philipps-Universität Marburg*, ²*Gutenberg University of Mainz*

10:00 a.m.—10:30 a.m.

Mezzanine Level

Refreshment Break

10:30 A.M.—11:30 A.M.

Regency Ballroom D

Invited Address

Functional Specificity in the Cortex: Selectivity, Experience, and Generality

Dr. Nancy Kanwisher

Ellen Swallow Richards Professor of Cognitive Neuroscience, Department of Brain and Cognitive Sciences, and McGovern Institute for Brain Research, MIT, Cambridge, MA

11:30 A.M.—1:00 P.M.

Break for Lunch (on your own)

11:30 A.M.—1:00 P.M.

Verelst

Women in Science Lunch Box Discussion

Please join us for the Second Annual Women in Science Lunch Box Discussion. The discussion topic will be focused on negotiation skills involved in obtaining a competitive salary, sufficient start-up costs, and lab space for new faculty and continuing negotiations relevant to later career stages. All SPR members, including men, are invited to attend. To register, please contact Becky Levin (rllevin@cyrus.psych.uiuc.edu) no later than September 28, 2007.

1:00 P.M.—2:30 P.M.

Symposia Sessions

1:00 P.M.—2:30 P.M.

Regency Ballroom A

Symposium 11

An Integrative Approach to Understanding How Cultural Stereotypes Affect Performance, Learning, and Retention

Chairs: Michael Inzlicht¹ & Jennifer A. Mangels²

¹*University of Toronto*, ²*Baruch College, City University of New York*

Discussant: Bruce D. Bartholow
University of Missouri—Columbia

Signaling Threat: How Situational Cues Affect the Objective and Subjective Experiences of Women in Math, Science, and Engineering Settings

Mary C. Murphy, Claude M. Steele, & James J. Gross
Stanford University

Neural Basis of Stereotype Susceptibility Effects in Women's Spatial Reasoning Performance

Maryjane Wraga¹, Molly Helt¹, Emily C. Jacobs², & Kerry Sullivan¹

¹*Smith College*, ²*University of California, Berkeley*

Devaluing and Discounting as Predictors of How Minority Students Monitor Errors in an Intellectually Threatening Environment

Toni Schmader, Chad Forbes, & John J. B. Allen
University of Arizona

Learning Math Under the Influence of Stereotype Threat: The Relationship Between Affective and Cognitive Engagement

Jennifer A. Mangels¹, Catherine D. Good¹, Brian Maniscalco², & Carol S. Dweck³

¹*Baruch College, City University of New York*,
²*Columbia University*, ³*Stanford University*

**Why Women Leave Science: Using a
Neurophysiological Approach to Understand
and Plug the Leaky Pipeline**

Michael Inzlicht & Sonia Kang
University of Toronto

1:00 P.M.—2:30 P.M.

Scarborough Ballroom 1

Symposium 12

**When Structure Meets Function: New Frontiers
in Neuroimaging**

Chairs: Gabriele Gratton & Monica Fabiani
University of Illinois, Urbana—Champaign

**The Relationship Between Brain Structure and
Brain Function in Older Adults: The Influence
of Lifestyle Factors and Genetics**

Kirk I. Erickson
University of Illinois, Urbana—Champaign

**Magnetic Resonance Imaging Correlates of
Cognitive and Affective Symptoms of
Geriatric Depression**

Faith Gunning-Dixon¹, Matthew J. Hoptman²,
Christopher F. Murphy¹, Kelvin O. Lim², &
George S. Alexopoulos¹

¹*Cornell University*, ²*New York University*

**Diffusion Tensor Imaging (DTI) Tractography
as a Tool for Cognitive Neuroscience:
Combination with fMRI**

Paul M. Corballis & Orion P. Keifer, Jr.
Georgia Institute of Technology

**When Structure Meets Function: New Insight
from Brain Imaging**

Gabriele Gratton & Monica Fabiani
University of Illinois, Urbana—Champaign

2:30 P.M.—3:00 P.M.

Mezzanine Level

Refreshment Break

3:00 P.M.—4:30 P.M.

Symposia Sessions

3:00 P.M.—4:30 P.M.

Regency Ballroom A

Symposium 13

The Defense Cascade: The Dynamics of Fear Reaction

Chairs: Eliane Volchan¹ & Jaime Vila²

¹*Federal University of Rio de Janeiro*, ²*University of Granada*

Discussant: Peter J. Lang
University of Florida

Startle and Defense

Margaret M. Bradley
University of Florida

Human Freezing Behavior

Eliane Volchan
Federal University of Rio de Janeiro

Cardiac Defense: From Attention to Action

Jaime Vila
University of Granada

Anticipation and Exposure to Threat

Alfons Hamm
University of Greifswald

3:00 P.M.—4:30 P.M.

Scarborough Ballroom 1

Symposium 14

How Early is Semantics? Electrophysiological Correlates of Semantic Processing Peaking Earlier than the N400

Chair: Joseph Dien

University of Kansas

Developmental Changes in Word Learning Effects to Auditorally Named Visual Stimuli

Dennis L. Molfese

University of Louisville

N170 Indexes Lexical Access Processes in Simultaneous Interpreters

Alice M. Proverbio¹, Roberta Adorni¹, & Alberto Zani²

¹*University of Milano–Bicocca*, ²*Consiglio Nazionale delle Ricerche*

What Do Pre-N400 ERP Components Tell Us about the Timing of Semantic Processing?

John F. Connolly¹, Randy L. Newman², & Elisabet Service¹

¹*University of Montreal*, ²*Acadia University*

Partial Word Knowledge and Measures of Incremental Learning: ERP Evidence for Stages of Meaning Acquisition

Gwen A. Frishkoff

University of Pittsburgh

Responsiveness of the Recognition Potential to Sentence Context: Convergent ERP and fMRI Findings

Joseph Dien¹, Aminda J. O'Hare¹, & Cary R. Savage²

¹*University of Kansas*, ²*University of Kansas Medical Center*

4:30 P.M.—4:45 P.M.

Break

4:45 P.M.—5:45 P.M.

Regency Ballroom D

Invited Address

Neural Correlates of Recollection and Familiarity in Young and Older Adults

Roberto Cabeza, PhD

Associate Professor, Center for Cognitive

Neuroscience, Duke University, Durham, NC

5:45 P.M.—6:00 P.M.

Break

6:00 P.M.—8:00 P.M.

Harborside Center

Poster Session II

10:00 P.M.

Student Social

(location to be announced)

Saturday, October 20, 2007

8:30 A.M.—3:00 P.M.

*Regency Ballroom Foyer****Registration***

8:30 A.M.—10:00 A.M.

Symposia Sessions

8:30 A.M.—10:00 A.M.

*Regency Ballroom A****Symposium 15*****Implicit Processes of Motivation: Evidence from Neuroimaging, Neuroendocrinology, and ERP Research**

Chair: Julie L. Hall

*University of Michigan***Implicit Motivation in the Brain: The Role of Implicit Power and Affiliation Motivation on Neural Responses to Angry Facial Expressions**Julie L. Hall¹, Christian E. Waugh², Steven J. Stanton¹, Michelle M. Wirth³, Patricia A. Reuter-Lorenz¹, & Oliver C. Schultheiss¹¹*University of Michigan*, ²*Stanford University*,³*University of Wisconsin***Relationships Between Progesterone and Implicit Affiliation Motivation**Michelle M. Wirth¹ & Oliver C. Schultheiss²¹*University of Wisconsin*, ²*University of Michigan*

**Implicit Racial Prejudice Motivates Attention
Toward Out-Group Cues**

Catherine J. Norris¹, Matthew R. Longo²,
Bennett I. Bertenthal³, & John T. Cacioppo⁴
¹*Dartmouth College*, ²*University College, London*,
³*Indiana University*, ⁴*University of Chicago*

8:30 A.M.—10:00 A.M.

Scarborough Ballroom 1

Symposium 16

**Attention and Memory in Audition:
Measurements of Brain Activity and Behavior**

Chair: Kimmo Alho
University of Helsinki

**The Contribution of the Parietal Cortex to
Auditory Spatial Working Memory**

Claude Alain
Rotman Research Institute at Baycrest Hospital

**Non-Intentional Encoding of Abstract
Auditory Rules and its Consequences for
Deviance Detection and Distraction**

Erich Schröger¹, Alexandra Bendixen¹, Nelson
J. Trujillo-Barreto², & Urte Roeber¹
¹*University of Leipzig*, ²*Cuban Neuroscience
Center*

Dichotic Listening, Attention, and Age

Heikki Hämäläinen & Fiia Takio
University of Turku

**Dichotic Listening and Attention:
Magnetoencephalographic Measurements of
Auditory-Cortex Activity**

Kimmo Alho¹, Johanna Salonen², Teemu
Rinne¹, Svyatoslav V. Medvedev³, Kenneth
Hugdahl⁴, & Heikki Hämäläinen⁵
¹*University of Helsinki*, ²*Helsinki University
Central Hospital*, ³*Institute of the Human Brain,
Russian Academy of Sciences*, ⁴*University of
Bergen*, ⁵*University of Turku*

8:30 A.M.—10:00 A.M.

Scarborough Ballroom 3

Symposium 17

William James' Legacy: The Present State of Autonomic Response Specificity of Emotion

Chair: Sylvia D. Kreibig

University of Geneva

Discussant: Julian F. Thayer

The Ohio State University

Feelings and the Body: William James and Autonomic Specificity of Emotion

Bruce H. Friedman

Virginia Polytechnic Institute and State University

The Psychophysiology of Fear and Sadness: Cardiovascular, Electrodermal, and Respiratory Responses During Film Viewing

Sylvia D. Kreibig¹, Frank H. Wilhelm², James J. Gross³, & Walton T. Roth^{3,4}

¹*University of Geneva*, ²*University of Basel*,

³*Stanford University*, ⁴*VA Palo Alto Health Care System*

Somatovisceral Profiles During Anger and Fear Imagination: Separable Effects of Emotion And Motivational Direction

Jan Wacker & Gerhard Stemmler

Philipps-Universität Marburg

Shrinking the Elephant: The Utility of Multivariate Statistical Tools and the Impact of Methodology on the Generation of an Integrated Affect Model

Israel C. Christie¹, Chad L. Stephens², & Bruce H. Friedman²

¹*University of Pittsburgh*, ²*Virginia Polytechnic Institute and State University*

10:00 A.M.—10:30 A.M.

Mezzanine Level

Refreshment Break

10:30 A.M.—11:00 A.M.

Regency Ballroom D

***Award for Distinguished Early Career
Contribution to Psychophysiology***

**Investigating Mechanisms of Social Cognition
with Event-Related Brain Potentials**

Bruce D. Bartholow, PhD

*Assistant Professor, Department of Psychological
Sciences, University of Missouri, Columbia, MO*

11:00 A.M.—12:00 noon

Regency Ballroom D

Presidential Address

The Way of Our Errors: Theme and Variations

Robert F. Simons, PhD

*SPR President and Professor, Department of
Psychology, University of Delaware, Newark, DE*

12:15 P.M.—2:15 P.M.

Scarborough Ballroom

Business Meeting and Luncheon

2:15 P.M.

Free Afternoon to Explore Savannah!

7:00 P.M.—9:00 P.M.

Harborside Center

Poster Session III

9:00 P.M.—12:00 midnight

Regency Ballroom D

Saturday Night Social

All attendees are welcome!

(cash bar and snacks)

Sunday, October 21, 2007

8:00 A.M.—10:00 A.M.

Regency Ballroom A

Farewell Breakfast

(Come at your leisure prior to leaving the conference! A continental breakfast will be offered to all!)

8:30 A.M.—12:00 noon

Westbrook

SPR Board of Directors Meeting

Poster Session I
Thursday, October 18, 2007

6:15 P.M.—8:15 P.M.

Harborside Center

Poster Presenter Schedule

8:00 A.M.—9:30 A.M. Posters Assembled

9:30 A.M.—6:15 P.M. Posters Available for Viewing

6:15 P.M.—8:15 P.M. Authors Present for
 Discussion and Questions

8:15 P.M.—9:15 P.M. Dismantle Posters

1. Do High Impedance ERP Recording Systems Really Save Time?

Emily S. Kappenman & Steven J. Luck
University of California, Davis

2. The Genetics of Fear Learning: Fear Conditioned Startle Potentiation and a Polymorphism in the Serotonin Transporter Gene

Tina B. Lonsdorf¹, Almut I. Weike², Martin Schalling¹, Alfons O. Hamm², & Arne Öhman¹
¹*Karolinska Institutet*, ²*University of Greifswald*

3. Psychophysiological Reactions to Caffeine and Caffeine-Associated Stimuli in Habitual Coffee Drinkers and Abstainers

Christiane A. Melzig¹, Jan P. Stender¹, Varinia Popek¹, Thomas Giessmann¹, Werner Siegmund¹, Terry D. Blumenthal², & Alfons O. Hamm¹
¹*University of Greifswald*, ²*Wake Forest University*

4. Memory Encoding of Emotional and Neutral Pictures: Autonomic, Behavioral and Electrocardiac Responses

Mathias Weymar¹, Christiane A. Melzig¹, Jarek M. Michalowski¹, Harald T. Schupp², & Alfons O. Hamm¹
¹*University of Greifswald*, ²*University of Konstanz*

- 5. The Temporal Specificity of Fear-Potentiated Startle in Aversive Single-Cue Conditioning**
Almut I. Weike¹, Thomas Schaer¹, Arne Öhman², & Alfons O. Hamm¹
¹*University of Greifswald*, ²*Karolinska Institute*
- 6. Neural Mechanisms Underlying Implementation Intentions to Respond Without Prejudice**
Saaïd A. Mendoza & David M. Amodio
New York University
- 7. The Role of Medial Prefrontal Cortex in Regulating Self-Related Social Judgments**
Polina V. Potanina & David M. Amodio
New York University
- 8. Cortisol Effects on Self-Regulation in an Interracial Interaction**
David M. Amodio
New York University
- 9. The Onset of Puberty: Effects on the Psychophysiology of Emotional Processing and Motivation**
Karina M. Quevedo¹, Stephen D. Benning², Ronald E. Dahl³, & Megan R. Gunnar¹
¹*University of Minnesota*, ²*Vanderbilt University*,
³*University of Pittsburgh*
- 10. Effects of Personality Traits on Startle Blink and Postauricular Reflex Modulation in Adolescents**
Stephen D. Benning¹, Karina M. Quevedo², Ronald E. Dahl³, & Megan R. Gunnar²
¹*Vanderbilt University*, ²*University of Minnesota*,
³*University of Pittsburgh*
- 11. Evidence for Diminished Emotional Reactivity to Disgust in Frontotemporal Dementia**
Janet A. Eckart¹, Virginia E. Sturm¹, Bruce L. Miller², & Robert W. Levenson¹
¹*University of California, Berkeley*, ²*University of California, San Francisco*

- 12. Positive Emotions and Physiological Downregulation During Conflict in Close Relationships**
Sarah R. Holley, Joyce W. Yuan, Megan E. McCarthy, & Robert W. Levenson
University of California, Berkeley
- 13. Coherence Between Subjective Experience and Physiology in Emotion: Does Body-Awareness Training Matter?**
Jocelyn A. Sze, Joyce W. Yuan, Anett Gyurak, & Robert W. Levenson
University of California, Berkeley
- 14. Task-Switching, Inhibitory Control and the Role of Trait Anxiety: Evidence from Eye-Movements During an Antisaccade Task**
Tahereh L. Ansari & Nazanin Derakshan
Birkbeck University of London
- 15. Anxiety Reduces Top Down Attentional Control: Evidence from the Antisaccade Task**
Nazanin Derakshan & Tahereh Ansari
Birkbeck University of London
- 16. High-Anxious Individuals Show Enhanced P1 Amplitudes upon Disengagement from Angry Faces**
Elaine Fox¹, Nazanin Derakshan², & Leor Shoker²
¹*University of Essex*, ²*Birkbeck University of London*
- 17. Anxiety Interferes with Effective Inhibition of Distracting Stimuli: Evidence from Eye-Movements During a Reading Task**
Leor Shoker & Nazanin Derakshan
Birkbeck University of London
- 18. Deficits in Prepulse Inhibition of Startle with Increased Bulimic Symptomology in a Normative Sample**
Kelly Beth Bowker, Joseph C. Franklin, & Terry D. Blumenthal
Wake Forest University

- 19. The Association Between Schizoid and Histrionic Personality Disorder Traits and Prepulse Inhibition of Acoustic Startle in a Nonclinical Sample**
Joseph C. Franklin, Kelley Beth Bowker, & Terry D. Blumenthal
Wake Forest University
- 20. Apathy and Emotional Symptoms in Relation to P3 Response in Parkinson's Disease**
David A. S. Kaufman, William M. Perlstein, Michelle J. Blanco, Michael J. Larson, Michael S. Okun, Hubert H. Fernandez, & Dawn Bowers
University of Florida
- 21. The Impact of Motivational Influences on Error-Related Brain Activity in Young Children**
Dana C. Torpey, Greg Hajcak, & Daniel N. Klein
Stony Brook University
- 22. Reconsidering Reappraisal: Descriptions Preceding Unpleasant Pictures Modulate the Amplitude of the Late Positive Potential**
Dan Foti, Greg Hajcak, & Jonathan Dunning
Stony Brook University
- 23. Psychopathy, Trait Fear, and Affective Modulation of the Startle Blink Reflex**
Jason R. Hall, Edward M. Bernat, Noah Venables, Meredith Cadwallader, & Christopher J. Patrick
University of Minnesota
- 24. Trait Fear and Fearlessness: Utilizing ERP to Investigate Individual Differences in Affective Processing**
An T. Dao¹, Nathalie Vizueta¹, Edward M. Bernat¹, Cho Kim Cheng², Siri A. Scott¹, Jana C. Christensen¹, Bethany A. Dicks¹, Michael L. Meldahl¹, Brandon W. Thorne¹, & Christopher J. Patrick¹
¹*University of Minnesota*, ²*University of Toronto*

- 25. Improved Source Localization of Error-Related Negativity (ERN) Using Principal Components Analysis (PCA) of Time-Frequency Activity**
Edward M. Bernat¹, Selin Aviyente², & Christopher J. Patrick¹
¹University of Minnesota, ²Michigan State University
- 26. Startle Reflex Potentiation During Aversive Picture Viewing as an Indicator of Trait Fear in an Undergraduate Sample**
Uma Vaidyanathan, Edward M. Bernat, Meredith Cadwallader, An T. Dao, Alma Dzafic, Nathalie Vizueta, Noah C. Venables, & Christopher J. Patrick
University of Minnesota
- 27. Processing Invisible Faces: Brain Response Differentiation Between Fearful and Neutral Expressions in an Interocular Suppression Paradigm**
Nathalie Vizueta, Yi Jiang, Robert W. Shannon, Edward M. Bernat, Christopher J. Patrick, & Sheng He
University of Minnesota
- 28. Approach Emotionality Predicts EEG Coherence Between Left Motor Cortex and Left Prefrontal Cortex**
Carly K. Peterson & Eddie Harmon-Jones
Texas A&M University
- 29. Take Your Mind Off It: Affective Perception and Distraction**
Bethany C. Wangelin, Andreas Löw, Lisa M. McTeague, Robert Sivinski, Margaret M. Bradley, & Peter J. Lang
University of Florida
- 30. Dissociating Stimulus Novelty and Information Value**
Vera Ferrari¹, Margaret M. Bradley¹, Maurizio Codispoti², & Peter J. Lang¹
¹University of Florida, ²University of Bologna

31. Electrocortical Dynamics of the Lag-1-Sparing Phenomenon During Rapid Serial Visual Presentation

Andreas Keil¹, Niklas Ihssen², & Sabine Heim²
¹*University of Florida*, ²*University of Konstanz*

32. Pliant Fear: Instructed Reversal of Anticipatory Fear

Vincent D. Costa, Margaret M. Bradley, & Peter J. Lang
University of Florida

33. Reliable Sources: Dense EEG and Fast fMRI in Affective Perception

Dean Sabatinelli, Robert G. Sivinski, Francesco Versace, Margaret M. Bradley, & Peter J. Lang
University of Florida

34. The Effect of the Sharpness of a Knife on Weapon Focus: A P300 Study

Yuki Hamamoto & Shinji Hira
Fukuyama University

35. Effects of Refreshing Memory on P300-Based GKT After One Month: Central Memory vs. Peripheral Memory

Shinji Hira¹, Hamamoto Yuki¹, & Furumitsu Isato²
¹*Fukuyama University*, ²*University of East Asia*

36. Event-Related Potentials Validate Attentional Changes After Mindfulness Training in Chronic Depression

Vladimir Bostanov, Martin Hautzinger, & Boris Kotchoubey
University of Tübingen

37. Pre-Ejection Period and T-Wave Amplitude as Indices of Sympathetic Nervous System Activity

Steffen Richter¹, Christine Philippsen¹, Johannes Port², & Hartmut Schächinger¹
¹*University of Trier*, ²*University of Stuttgart*

-
- 38. The Influence of Central Alpha2-Adrenoreceptor Agonism and Antagonism on the Cardiac Modulation of Acoustic Startle**
Andre Schulz, Christine Philippsen, & Hartmut Schächinger
University of Trier
- 39. Social Support and Social Anxiety Effects on Physiological Reactivity**
Amy R. Borchardt & Kathi L. Heffner
Ohio University
- 40. Autonomic Influences on Heart Rate Reactivity to Acute Stress Following Emotional Disclosure**
Kathi L. Heffner & Lynne M. Rochette
Ohio University
- 41. The Role of Reward Expectancy on the Generation of Feedback Related Negativity (FRN)**
Andrew Bismark, Loran Kelley, & John J. B. Allen
University of Arizona
- 42. Respiratory Sinus Arrhythmia Predicts Mood in Third Trimester in Anxious Pregnant Women**
Andrea S. Chambers & John J. B. Allen
University of Arizona
- 43. Measuring Stigma's Effects on Neuronal Indices of Error Perception and Error Evaluation in Psychologically Disengaged Minorities**
Chad E. Forbes, Toni Schmader, & John J. B. Allen
University of Arizona
- 44. Do You Feel Like We Do: Development and Testing of an Objective Measure of Empathic Emotional Responding**
Laura G. Kirsch, Judith V. Becker, & John J. B. Allen
University of Arizona

- 45. Brief Slow-Breathing Training and Stability of Resting and Stressor Task Changes in RSA Over One Week**
Lauren M. Bylsma, Mardis Karlsdottir, Jonathan Rottenberg, & Kristen Salomon
University of South Florida
- 46. Cardiovascularly Healthy Depressed Persons Exhibit Attenuated Cardiovascular Reactivity to Laboratory Stressors**
Mardis Karlsdottir, April Clift, Jonathan Rottenberg, & Kristen Salomon
University of South Florida
- 47. Race and Adiposity Are Related to Cardiovascular Reactivity and Impaired Recovery from Laboratory Stress**
Kristi E. White, Cathy A. Bykowski, Thomas S. King, & Kristen Salomon
University of South Florida
- 48. Internalized Racism as a Moderator for Stereotype Threat: Effects on Cardiovascular Responses in Black Individuals**
Nicole E. Jaguszyn & Kristen Salomon
University of South Florida
- 49. Language Lateralization of Theta and Beta EEG Bands in Developmental Dyslexia**
Chiara Spironelli, Barbara Penolazzi, & Alessandro Angrilli
University of Padova
- 50. Emotional Anticipation in Subjects with Vasovagal Syncope**
Giulia Buodo¹, Silvia Poli¹, Franco Giada², Michela Madalosso², Cesare Rossi², & Daniela Palomba¹
¹*University of Padova*, ²*Umberto I Hospital—Mestre*
- 51. Time Course of Emotional Face Processing During Passive Viewing**
Michela Sarlo, Marianna Munafò, & Daniela Palomba
University of Padova

- 52. Defense Reactions to Interoceptive Threats: A Comparison Between Loaded Breathing and Aversive Picture Viewing**
Meike Pappens, Steven De Peuter, Ilse Van Diest, Deb Vansteenwegen, & Omer Van Den Bergh
University of Leuven
- 53. Pavlovian Conditioning of Breathing Behavior in a Picture-Noise Fear Conditioning Paradigm**
Ilse Van Diest¹, Margaret M. Bradley², Omer Van Den Bergh¹, Pedro Guerra³, & Peter J. Lang²
¹*University of Leuven*, ²*University of Florida*,
³*University of Granada*
- 54. The Influence of Emotional Context on Response Inhibition: Neural Correlates**
Jacobo Albert, Sara López-Martín, Manuel Tapia, Dominique Kessel, & Luis Carretié
Universidad Autónoma De Madrid
- 55. Interaction Between Emotional Context and Attention to Color Studied Through Event-Related Potentials**
Sara López-Martín, Jacobo Albert, Manuel Tapia, & Luis Carretié
Universidad Autónoma De Madrid
- 56. The Role of Attentional Deployment in Emotion Regulation**
Sarah R. Cavanagh & Lisa M. Shin
Tufts University
- 57. Emotion Discrimination: Untangling the Extent of Emotion Understanding of 6-Month-Old Infants**
Jennifer A. Dicorcia, Sarah K. Ballou, & Heather L. Urry
Tufts University

-
- 58. Testing for Differential Effects of Experimentally-Manipulated Antecedent-and Response-Focused Emotion Regulation**
Heather L. Urry
Tufts University
- 59. Modality Non Specific Attentional Startle is Modulated by Task Demands**
Sakinah Alhadad, Helena M. Purkis, & Ottmar V. Lipp
University of Queensland
- 60. No Evidence for a Role of Startle in the StartReac Effect or for an Effect of Attention on Blink Facilitation at Very Short Lead Intervals**
Ottmar V. Lipp¹, Sakinah Alhadad¹, Daniel M. Kaplan², & Helena M. Purkis¹
¹*University of Queensland*, ²*Washington University*
- 61. The Effects of Arousal and Valence on Global and Local Processing**
Frances Martin, Tao Yin Ting, & Andrea Adam
University of Tasmania
- 62. Emotional Stimuli Modulate Sensory Gain: An ERP Study**
Jordan E. Devylder, Paul M. Corballis, & Matt R. Hilimire
Georgia Institute of Technology
- 63. Establishing Functional Connectivity Between the Superior Colliculus and the Parietal Eye Field: A Combined fMRI and DTI Study**
Orion P. Keifer, Paul M. Corballis, & Jordan E. Devylder
Georgia Institute of Technology
- 64. Age Differences in Early Frontocentral Enhanced Event-Related Positivity Elicited by Emotional Faces**
Andrew Mienaltowski, Matthew R. Hilimire, Nathan A. Parks, Fredda Blanchard-Fields, & Paul M. Corballis
Georgia Institute of Technology

- 65. Attentional Modulation of Prepulse Inhibition and Facilitation in ADHD and Healthy Adults: Relationship to Genetic and Diagnostic Factors**
Annette Conzelmann, Peter Weyers, Ronald F. Mucha, Antje B. M. Gerdes, Christian Jacob, Christina G. Bähne, Klaus-Peter Lesch, Georg W. Alpers, & Paul Pauli
University of Würzburg
- 66. Toward and Away from Spiders: Attentional Engagement and Disengagement in Spider Phobic Patients**
Antje B. M. Gerdes, Georg W. Alpers, & Paul Pauli
University of Würzburg
- 67. Eye to Eye Contact in Social Anxiety: New Insights from Eye-Tracking and Psychophysiological Data in a Mutual Gaze Design**
Matthias J. Wieser, Andreas Mühlberger, & Paul Pauli
University of Würzburg
- 68. A Direct Comparison of the Central Nervous Processing of Social and Non-Social Emotional Stimuli**
Andreas Mühlberger, Monika C. M. Frey, Katja Likowsky, Matthias J. Wieser, Paul Pauli, & Peter Weyers
University of Würzburg
- 69. A Direct Comparison of Facial Reactions to Social and Non-Social Emotional Stimuli**
Peter Weyers, Monika Frey, Katja Likowski, Matthias J. Wieser, Paul Pauli, & Andreas Mühlberger
University of Würzburg
- 70. Assessing Multisensory Interactions During Audio-Visual Speech Perception Using ERP**
Axel H. Winneke & Natalie A. Phillips
Concordia University

- 71. Increased Activation of Left Hemisphere After Right Hand Transplantation Using Event Related Potentials: A Case Study**
Jia Wu¹, Nikki Pratt¹, Alysia R. Rue¹, Sasha Key², Warren C. Briedenbach³, & Dennis L. Molfese¹
¹University of Louisville, ²Vanderbilt University, ³Jewish Hospital, Louisville
- 72. Threat of Shock Modulates Emotional Picture Processing: An ERP Study**
Florian Bublitzky, Beate Hofer, Jessica Stockburger, Tobias Flaisch, Ralf Schmäzle, & Harald T. Schupp
University of Konstanz
- 73. Childhood Stress Load Affects Brain Responses to Affective Pictures in Psychiatric Patients**
Jens Borgelt, Katja Weber, Barbara Awiszus, Tzvetan Popov, & Brigitte Rockstroh
University of Konstanz
- 74. Emotion and Attention in Visual Word Processing: An ERP Study**
Johanna Kissler¹, Cornelia Herbert¹, & Markus Junghöfer²
¹University of Konstanz, ²University of Münster
- 75. Age Differences in the Relationship Between Emotional Experience and Physiological Arousal**
Samantha L. Neufeld¹, Michelle N. Shiota, & Robert W. Levenson²
¹Arizona State University, ²University of California, Berkeley
- 76. What is Reappraisal: A Psychophysiological Look at Sex Differences in Cognition-Based Emotion Regulation**
Maren M. True¹, Michelle N. Shiota¹, & Robert W. Levenson²
¹Arizona State University, ²University of California, Berkeley

- 77. Investigating the Negativity Bias Using the Affective Go/No Go Task with Event-Related Potentials**
Jason W. Krompinger, Jason M. Moser, & Robert F. Simons
University of Delaware
- 78. Alcohol is Nearly as Good as Sex: Social Drinkers' P3 Reactivity to Alcohol and Arousing Cues**
Sarah A. Lust & Bruce D. Bartholow
University of Missouri—Columbia
- 79. Response Conflict in Affective Priming Revealed by Event-Related Brain Potentials (ERPs)**
Bruce D. Bartholow & Monica Schepers
University of Missouri—Columbia
- 80. Sitting, Listening, Viewing, or Performing: Effects of Baseline Task on Quantification of Autonomic Reactivity in Emotion**
Sylvia D. Kreibig, Guido H. E. Gendolla, & Klaus R. Scherer
University of Geneva
- 81. Musical Complexity is Associated with Greater Relative Sympathetic Nervous System Activation**
Benjamin O. Turner, Robert J. Ellis, John J. Sollers III, & Julian F. Thayer
The Ohio State University
- 82. Heart Rate and Heart Rate Variability During Experimental Worry and Problem Solving**
Jos F. Brosschot¹, Bart VerkuilBart , & Julian F. Thayer²
¹*Leiden University*, ²*The Ohio State University*
- 83. Resting Heart Rate Variability and the Startle Reflex to Pictures Presented Outside of Conscious Awareness**
Elisabeth Ruiz-Padial¹, & Julian F. Thayer²
¹*University of Jaen*, ²*The Ohio State University*

- 84. Friend or Foe: Heart Rate Variability and the Negativity Bias in Learning about Novel Objects**
Natalie Shook, Paloma Peña, Russell H. Fazio,
John J. Sollers, III, & Julian F. Thayer
The Ohio State University
- 85. The Effects of Avatar Presence and Emotional Valence on Facial Muscle Activity in an Immersive Virtual Environment**
Michael C. Philipp, H. Ted Denney, Ashley Moncrieft, Ritu Sharma, & Eric J. Vanman
Georgia State University
- 86. Effects of Trait Aggression on Emotional Responding and Aggressive Behavior Under Interpersonal Stress**
Ashley Kilmer¹, Naomi Sadeh², & Edelyn Verona¹
¹*University of Illinois, Urbana–Champaign,*
²*University of Illinois, Chicago*
- 87. Psychophysiological Correlates of Excessive Worry: Hyperventilation and Lower Vagal Control**
Luis Carlos Delgado, Maria Isabel Viedma Del Jesus, Pandelis Perakakis, Jose Luis Mata, Pedro Guerra, Agnese Ferrara, & Jaime Vila
University of Granada
- 88. The Effects of Trait Worry, State Anxiety, and Task Difficulty on Heart Rate**
Michael M. Knepp, Megan E. Moore, Jenna G. Carpenter, & Bruce H. Friedman
Virginia Tech
- 89. P300 Latency is Related to the Temporal Lag Between Two Targets During Attentional Blink**
Fumihito Morimoto & Akihiro Yagi
Kwansei Gakuin University

90. Psychosocial Influences on Adrenocortical and Autonomic Reactivity in Schizophrenia Patients

Gretchen L. Sholty, Jane C. Sun, Kristopher I. Mathis, Peter Bachman, Terrance J. Williams, Shelley E. Taylor, Keith H. Nuechterlein, Michael F. Green, Kenneth L. Subotnik, & Cindy M. Yee

University of California, Los Angeles

91. Gender, Stress and P50 Suppression in Schizophrenia

Jane C. Sun, Terrance J. Williams, Keith H. Nuechterlein, Kenneth Subotnik, & Cindy M. Yee

University of California, Los Angeles

92. The Influence of Stress on P50 Suppression During the Prodromal, First-Episode and Chronic Phases of Schizophrenia

Terrance J. Williams, Peter Bachman, Jane Sun, Kristopher I. Mathis, Gretchen L. Sholty, Shanon Chen, Kristen Hammel, Keith H. Nuechterlein, Tyrone D. Cannon, & Cindy M. Yee

University of California, Los Angeles

93. Reduced Short-Latency Prepulse Inhibition Among Individuals at Ultra High Risk of Developing Psychosis

Peter Bachman, Terrance J. Williams, Tyrone D. Cannon, Carrie E. Bearden, & Cindy M. Yee

University of California, Los Angeles

94. The Influence of Social Support on the Affective Modulation of Startle in Schizophrenia

Janet Y. Bang, Kristopher I. Mathis, Gretchen L. Sholty, Terrance J. Williams, Jane C. Sun, Peter Bachman, Keith H. Nuechterlein, Michael F. Green, Kenneth L. Subotnik, & Cindy M. Yee

University of California, Los Angeles

95. Gender Differences in Affective Modulation of Event-Related Potentials Elicited by Startle Probes

Margarita Adrover¹, Catalina Alorda¹, Carolina Sitges¹, Jose Javier Campos-Bueno², & Pedro Montoya¹

¹University of Balearic Islands, ²Universidad Complutense De Madrid

96. Affective Vulnerability Coupled with Negative Mood Leads to Greater Artistic Creativity

Modupe N. Akinola & Wendy B. Mendes
Harvard University

97. Race, Ethnicity, and the TV News: Facial EMG Activity Can Index Audience Responses

Anita Atwell, Ashley Moncrieft, Asia Williams, Yuki Fujioka, & Eric J. Vanman
Georgia State University

98. Neurophysiological Mechanisms of Voluntary Attention in Conditions of Sensorimotor Integration

Ekaterina Aydarkina
Southern Federal University

99. Neural Correlates of Conflict with Emotional Stimuli in a Flanker Task

Shruti Bajjal, Neha Khetrapal, & Narayanan Srinivasan
University of Allahabad

100. Psychophysiological Gender Differences in Emotional Stimuli Processing

Marta Bianchin & Alessandro Angrilli
University of Padova

101. Quantitative and Convectional EEG in Homicides

Ana Agustina Calzada Reyes¹ & Alfredo Alvarez Amador²
¹Legal Medicine Institute, ²Cuban Neuroscience Center

102. The Autonomic Nervous System: Middleman Between Stress and EmotionJames Cavanagh¹ & Margaret E. Kemeny²¹*University of Arizona*, ²*University of California, San Francisco***103. Effects of Secondary Categorization Processes on Explicit Categorization Using Event-Related Potentials**

Guadalupe Corral, Stephen L. Crites, Jennifer H. Taylor, & Andrew J. Mojica

*University of Texas—El Paso***104. Correct-Response Negativity and 1/F Noise as Indices of Strategic Control in Social Categorization**Heather M. Coulter¹, Tiffany A. Ito¹, & Joshua Correll²¹*University of Colorado—Boulder*, ²*University of Chicago***105. Neural Response to Emotional Pictures is Unaffected by Concurrent Task Difficulty: An Event-Related Potential Study**

Jonathan P. Dunning, Dan Foti, & Greg Hajcak

*Stony Brook University***106. Emotional Perception and Imagery: A Translational Approach to Internalizing Disorders**Daniel J. Goldman¹, Bruce N. Cuthbert¹, Margaret M. Bradley², Christopher J. Patrick¹, & Peter J. Lang²¹*University of Minnesota*, ²*University of Florida***107. Associations Among Introversions, Neuroticism, and Attentional Processing as Measured by Heart Rate and Skin Conductance Responses to High Intensity Auditory Stimuli**

Justin E. Greenstein, Jon D. Kassel, & Daniel P. Evatt

University of Illinois, Chicago

108. A Regression-Based Meta-Analysis of Cardiovascular Baselines in Participants With and Without a Family History of Hypertension

Barron M. Griffith, Thomas W. Pierce, Rodney D. Grim, & Joseph S. King
Radford University

109. Cardiovascular Variability in Unmedicated Patients with Recent-Onset Schizophrenia

Roelie J. Hempel, Joke H. M. Tulen, Nico J. M. Van Beveren, Christian H. Röder, & Michiel W. Hengeveld
Erasmus MC

110. Examining the Nature and Time Course of Attention to Emotional Facial Expressions

Matthew R. Hilimire, Paul M. Corballis, Jordan E. Devylder, & Derek Forth
Georgia Institute of Technology

111. Implicit Motivation in the Brain: The Role of Implicit Power and Affiliation Motivation on Neural Responses to Angry Facial Expressions of Emotion

Julie L. Hall¹, Christian E. Waugh², Steven J. Stanton¹, Michelle M. Wirth³, Patricia A. Reuter-Lorenz¹, & Oliver C. Schultheiss¹
¹*University of Michigan*, ²*Stanford University*,
³*University of Wisconsin*

112. The Impact of Rock Climbing on Anxiety and Cortisol

Christopher I. Hodgson, Nick Draper, Glenys A. Jones, Simon Fryer, Ian Coleman, & Terry McMorris
University of Chichester

113. Comparing Effects of Physiological Stress and Psychological Stress on Wound Healing in Rats

Mir Ali Khatibi Tabatabaei¹, Elham Dianati Ajibishe², & Abbas Haghparast²

¹*Tehran-Oxford Neurodevelopmental Center,*

²*Arkansas Children's Nutrition Center, ³Iran Neuroscience Research Center*

114. Retrieval-Induced Forgetting Under Stress—Memory Performance and Cortisol Level

Susanne Kössler & Johanna Kissler

University of Konstanz

115. Implicit Sociality Overrides Explicit Relationship Goals in a Task Involving Conscious Control of Corrugator Supercilii: Diverging Paths of Automaticity and Control Towards Friends vs. Strangers

Dennis Kuester & Arvid Kappas

Jacobs University Bremen

116. The Effects of Age and Motivational Activation on the Processing of Risky Products

Sungkyoung Lee, Gayle Nadorff, & Annie Lang

Indiana University

117. Attentional Networks Reveal Executive Control Deficits in Posttraumatic Stress Disorder: An fMRI Study

Lorraine P. Leskin, Patricia M. White, & Yalchin Abdullaev

University of Oregon

118. Effects of Opioid Blockade on the Modulation of Pain and Mood by Sweet Taste and Blood Pressure

Maxim D. Lewkowski, Simon N. Young, Shuvo Ghosh, & Blaine Ditto

McGill University

119. Attentional Blink Startle Modulation During Pleasant and Unpleasant Cues in Human Affective Conditioning

Kimberley M. Mallan & Ottmar V. Lipp
University of Queensland

120. Respiratory Pacing and Experimental Context: Interactive Influences on the Quantification of Heart Rate Variability

Martha F. McCool¹, Senta Furman¹, Keri Heilman¹, Jocelyn Leobow², Emily Harden¹, Mika Handelman¹, Alexis Kramer², & Stephen W Porges¹
¹*University of Illinois, Chicago, ²Illinois Institute of Technology*

121. ERP Endophenotypes of Adult ADHD

Gráinne McLoughlin¹, Björn Albrecht², Daniel Brandeis³, Tobias Banaschewski⁴, Philip Asherson¹, & Jonna Kuntsi¹
¹*King's College, London, ²Georg August Universitaat, Göttingen, ³University of Zurich, ⁴University of Mannheim*

122. Chronic Worry, Somatic Arousal, and the Psychophysiology of Generalized Anxiety Disorder

Lisa M. McTeague¹, Joshua R. Shumen¹, Marie-Claude Laplante¹, Margaret M. Bradley¹, Bruce N. Cuthbert², & Peter J. Lang¹
¹*University of Florida, ²University of Minnesota*

123. Differences Between the Detection of Shape Deviance and Color Deviance: An ERP Study

Eli J. Mikkelsen, James K. Kroger, Doerte K. Spring, & Carly J. Chapa
New Mexico State University

124. Current Mood State and Affective Startle Modulation

Chantal P. Mörsen¹, Klaus Wölfling¹, Herta Flor², & Sabine M. Grüsser¹
¹*Charité Berlin, ²University of Heidelberg*

- 125. The Neural Consequences of Flip Flopping: the Feedback Related Negativity and Commitment to Reward Prediction**
Jason S. Moser & Robert F. Simons
University of Delaware
- 126. Action-Monitoring Processing is More Sensitive to Gain than to Avoidance of the Loss**
Asuka Murata & Jun'ichi Katayama
Hokkaido University
- 127. The Fear Survey Schedule as a Sensitive Measure of Stress: Evidence from ERPs**
Aminda J. O'Hare & Joseph Dien
University of Kansas
- 128. Relationship Between Emotional Arousal and Retention Intervals in the Concealed Information Test (CIT)**
Akemi Osugi¹ & Hideki Ohira²
¹*Nagoya University, Japan Society for the Promotion of Science,* ²*Nagoya University*
- 129. Psychopathy Prompts Irrational Decision-Making: Evidence from Autonomic Responses to Disadvantageous Offers in the Ultimatum Game**
Takahiro Osumi & Hideki Ohira
Nagoya University
- 130. Evidence of Respiratory Sinus Arrhythmia-Heart Rate Dissociation During Sleep in Healthy Volunteers**
Kirill Ovchinnikov
Southern Federal University
- 131. The Influence of Motivation and Reward on Selective Visual Attention**
Nikki L. Pratt & Dennis L. Molfese
University of Louisville

- 132. Psychophysiological Validation of an Aversive Conditioning Paradigm Designed to Assess Continuous Gradients of Fear Generalization**
Stephanie Rabin, Shmuel Lissek, Arter Biggs, Ruben Alvarez, Brian Cornwell, & Christian Grillon
National Institute of Mental Health
- 134. Ringtones in Our Modern World: Personal Significance is Encoded Automatically by the Human Brain**
Anja Roye, Thomas Jacobsen, & Erich Schröger
University of Leipzig
- 135. Alpha-Asymmetry and Differential Approach Processes in Psychopathic Prison Inmates**
Naomi Sadeh¹, Edelyn Verona¹, Edward M. Bernat², & Christopher J. Patrick²
¹*University of Illinois, Urbana–Champaign*,
²*University of Minnesota*
- 136. Neural Correlates of Human Helplessness: An fMRI Investigation**
Tim V. Salomons¹, Robin Nusslock², Allison Detloff², Tom Johnstone², Misha M. Backonja², Lyn Y. Abramson², & Richard J. Davidson²
¹*University of Wisconsin–Milwaukee*, ²*University of Wisconsin–Madison*
- 137. Sex, Food, Threat and the Post-Auricular Reflex**
Arthur R. Sandt¹, Denise M. Sloan², & Kareem J. Johnson¹
¹*Temple University*, ²*National Center for PTSD*
- 138. Time Course of Attentional Bias in Anxiety**
Sarah M. Sass, Wendy Heller, Jennifer L. Stewart, Rebecca L. Levin, Christopher J. Edgar, Joscelyn E. Fisher, & Gregory A. Miller
University of Illinois, Urbana–Champaign

139. The Influence of Attention on the Auditory Steady-State Response in Artificial and Natural Sounds

Katja Saupe, Andreas Widmann, Alexandra Bendixen, Matthias Müller, & Erich Schröger
University of Leipzig

140. Difficulty of Discrimination Modulates Attentional Capture by Regulating Attentional Focus

Risa Sawaki & Jun'ichi Katayama
Hokkaido University

Poster Session II
Friday, October 19, 2007

6:00 P.M.—8:00 P.M.

Harborside Center

Poster Presenter Schedule

8:00 A.M.—9:30 A.M. Posters Assembled

9:30 A.M.—6:00 P.M. Posters Available for Viewing

6:00 P.M.—8:00 P.M. Authors Present for
Discussion and Questions

8:00 P.M.—9:00 P.M. Dismantle Posters

1. **Borderline Personality Disorder Traits are Associated with Prepulse Inhibition Abnormalities that Vary According to Gender**
Joseph C. Franklin, Kelly Beth Bowker, & Terry D. Blumenthal
Wake Forest University
2. **Respiratory Sinus Arrhythmia (RSA) and the N450 in Younger and Older Adults**
Leslie Capuana, William J. Tays, Karen Mathewson, Sidney J. Segalowitz, & Jane Dywan
Brock University
3. **Evaluating Bandpass Filter Settings for Measuring the P50 in Adults and Children**
Wen-Pin Chang, William J. Gavin, & Patricia L. Davies
Colorado State University
4. **Heart Rate Variability and Maze-Learning Performance in Older and Younger Adults**
Karen J. Mathewson¹, Jane Dywan¹, William J. Tays¹, Peter J. Snyder², & Sidney J. Segalowitz¹
¹*Brock University*, ²*University of Connecticut*
5. **Subclinical Psychopathy (SRP-III) and ERP Responses to a Visual Oddball Task**
Gillian E. S. Munro¹, Jane Dywan², & Sidney J. Segalowitz²
¹*University of Waterloo*, ²*Brock University*

- 6. General Proactive Interference and the N450 Response**
William J. Tays, Jane Dywan, Leslie Capuana,
& Sidney J. Segalowitz
Brock University
- 7. A High-Density ERP Study on Word Frequency and Neighborhood: Lexical Status Effects in the P100**
Xin Zheng & Sidney J. Segalowitz
Brock University
- 8. ERP Measures of Efficiency During Error Processing in Children**
William J. Gavin¹, Sidney J. Segalowitz², &
Patricia L. Davies¹
¹*Colorado State University*, ²*Brock University*
- 9. Eliciting Early VEP Components: A Comparison of Paradigms**
Sidney J. Segalowitz & Matthew Dipoce
Brock University
- 10. Endogenous Cortisol Suppression Enhances Startle Eye Blink**
Sonja Roemer & Hartmut Schächinger
University of Trier
- 11. The Neural Substrates of Delayed Match and Non-Match Saccades: An fMRI Investigation**
Benjamin P. Austin, Kara A. Dyckman, Jazmin Camchong, & Jennifer E. McDowell
University of Georgia
- 12. ERP Source Analysis of Genetic Influences on Early and Late Processing in a Visual Oddball Task**
Lauren E. Ethridge¹, Steven Malone², William G. Iacono², & Brett A. Clementz¹
¹*University of Georgia*, ²*University of Minnesota*

- 13. Neural Correlates of Wins and Losses During a Gambling Task in Pathological and Non-Pathological Gamblers**
Elizabeth Krusemark, Jazmin Camchong, Jennifer McDowell, Adam Goodie, & Brett Clementz
University of Georgia
- 14. A Specific Relationship Between Motion Processing and Neural Activity Deficits in Schizophrenia**
Jun Wang¹, Jennifer Wilson¹, Karen R. Dobkins², Jennifer E. McDowell¹, & Brett A. Clementz¹
¹*University of Georgia*, ²*University of California, San Diego*
- 15. The Effects of Education and Physical Fitness on Brain Anatomy**
Brian A. Gordon, Elena I. Rykhlevskaia, Carrie R. Brumback, Edward McAuley, Art F. Kramer, Stan Colcombe, Gabriele Gratton, & Monica Fabiani
University of Illinois, Urbana–Champaign
- 16. Effects of Parametric Changes in Working Memory Load on the Bold and ERP Response in Young and Old Adults**
Nils J. Schneider, Shin Eunsam, Brian A. Gordon, Carrie R. Brumback, Yukyung Lee, Ed L. Maclin, Gabriele Gratton, & Monica Fabiani
University of Illinois, Urbana–Champaign
- 17. Electrophysiological Evidence of Inter-Trial Inhibition of Focused Attention**
Eunsam Shin, Xiaoang I. Wan, Monica Fabiani, Gabriele Gratton, & Alejandro Lleras
University of Illinois, Urbana–Champaign
- 18. Dissociating Brain Responses to Implicit Rules of Varying Complexity**
Chun-Yu Tse, Kathy A. Low, Jason Agran, Guadalupe Arroyo, Colleen Jackson, Monica Fabiani, & Gabriele Gratton
University of Illinois, Urbana–Champaign

- 19. When the Modality Keeps Changing: Event-Related Potentials (ERPs) Show General and Modality-Specific Preparation in a Cross-Modal Stroop Task**
Kathy A. Low, Colleen Jackson, Monica Fabiani, & Gabriele Gratton
University of Illinois, Urbana–Champaign
- 20. Early Gamma Band Response in a Word Relatedness Task**
Grantley W. Taylor & Dean F. Salisbury
McLean Hospital
- 21. Alcohol Selectively Affects Anxiety But Not Fear**
Christine A. Moberg & John J. Curtin
University of Wisconsin–Madison
- 22. Assessing the Effects of Background Noise and Prepulse Format on Auditory Sensorimotor Gating**
Wade R. Elmore, Elizabeth R. Duval, & Diane L. Filion
University of Missouri–Kansas City
- 23. Emotional Reactions to Body Image Cues: Implications for Eating Disorders**
Kristen M. Keune, Carrie D. Spreser, Diane L. Filion, & Jennifer D. Lundgren
University of Missouri–Kansas City
- 24. Does Respiratory Sinus Arrhythmia Predict PTSD Symptom Severity?**
Kristin E. Pontoski¹, Michelle J. Bovin¹, Denise M. Sloan², & Brian P. Marx²
¹*Temple University*, ²*National Center for PTSD, VA Boston Healthcare System*
- 25. Grasping Disgusting Stimuli Enhances Motor Readiness Potential**
Laura A. S. Oliveira, Eduardo Furtado-Martins, Lu's Aureliano Imbiriba, Erika C. Rodrigues, Eliane Volchan, & Cláudia D. Vargas
Federal University of Rio de Janeiro

26. Emotional Engagement and Desengagement Verified by Saccadic Reaction Times

Aydamari J. P. Faria, Jr.¹, Walter Machado-Pinheiro², Isabel P. A. David¹, Pedro Guerra³, Pandelis Perakakis³, Leticia Oliveira², Mirtes G. Pereira², Jaime Vila³, & Eliane Volchan¹

¹*Federal University of Rio de Janeiro*, ²*Federal Fluminense University*, ³*University of Granada*

27. Fiction or Truth? Differential Processing of Aversive Scenes: An ERP Study

Letícia Oliveira¹, Izabela Mocaiber², Fatima Erthal², Mauricio Cagy¹, Ivan Figueira², Walter Machado-Pinheiro¹, Mirtes G. Pereira¹, & Eliane Volchan²

¹*Federal Fluminense University*, ²*Federal University of Rio de Janeiro*

28. Individual Differences in Brain Activations During Negative-Picture Behavioral Interference

Mirtes G. Pereira¹, Fatima Erthal², Leticia Oliveira¹, Mateus Joffily², Walter Machado-Pinheiro¹, Ivan Figueira², Eliane Volchan², & Luiz Pessoa³

¹*Federal Fluminense University*, ²*Federal University of Rio de Janeiro*, ³*Indiana University—Bloomington*

29. Decision-Making and Emotion: Cardiac Reaction in the Ultimatum Game

Billy E. M. Nascimento¹, Carlos E. Norte¹, Ana C. Lages¹, Jorge Moll², & Eliane Volchan¹

¹*Federal University of Rio de Janeiro*, ²*Labs D'Or Hospitals*

- 30. Resilience, Vagal Tone and Pleasant Priming Improve Cardiac Recovery from Acute Stress**
Gabriela G. L. Souza¹, Ana C. F. Mendonza-de-Souza¹, Eduardo M. Barros¹, Nastassja L. Fischer¹, Evandro F. S. Coutinho², Letícia Oliveira³, Mauro V. Mendlowicz³, Ivan Figueira¹, Jaime Vila⁴, & Eliane Volchan¹
¹Federal University of Rio de Janeiro, ²Oswaldo Cruz Foundation, ³Federal Fluminense University, ⁴University of Granada
- 31. Startle Responses of Schizophrenic Patients During the Viewing of Erotic, Nature and Threat Pictures**
Roelie J. Hempel, Joke H. M. Tulen, Hugo G. van Steenis, Nico J. M. van Beveren, Christian H. Röder, & Michiel W. Hengeveld
Erasmus MC
- 32. Patterns of P300 Laterality Observed During the Presentation of Emotional Prosodic Utterances and Emotional Prosodic Words**
Alan L. Gerding, Daniel E. Everhart, & Claude E. Davis
East Carolina University
- 33. Latency of Conditioned Fear in Humans After Delay and Trace Aversive Conditioning**
Ole Asli & Magne A. Flaten
University of Tromsø
- 34. Brain Activation During Fear Conditioning Depends on Genetic Variations Related to Functioning of the Hypothalamic-Pituitary-Adrenal Axis**
Herta Flor¹, Stephanie Ridder¹, Simone Lang¹, Slawomira Lipinski¹, Michele Wessa¹, Markus Skowronek¹, Marcella Rietschel¹, & Gunter Schumann²
¹University of Tübingen, ²King's College, London

-
- 35. Risk Factors for the Development of Posttraumatic Stress Disorder: Results from a High Risk Population Sample**
Slawomira Lipinski, Stephanie Ridder, Simone Lang, Michèle Wessa, Christoph Christmann, & Herta Flor
University of Heidelberg
- 36. Skin Potential Level Changes Under Arousal Stimulation and Individual Differences in Empathy**
Dmytro Gorlov, Volodymyr Bogdanov, & Yuriy Gorgo
Taras Shevchenko National University of Kyiv
- 37. Emotional Stress, Gender, and Age Effects on Facial Skin Potential Distribution**
Volodymyr Bogdanov, Dmytro Gorlov, Svitlana Fedorchuk, Anatoliy Ena, & Yuriy Gorgo
Taras Shevchenko National University of Kyiv
- 38. Increase of Local Skin Potential Response in Forehead Skin During a Cognitive Task**
Yuriy Gorgo, Volodymyr Bogdanov, & Dmytro Gorlov
Taras Shevchenko National University of Kyiv
- 39. Interactions of Emotion and Cognitive Control: An ERP Study about Task-Switching**
Doerte K. Spring, James Kroger, & Eli Mikkelsen
New Mexico State University
- 40. The Effect of Individual Differences in Motivated Processing on Responses to Sex Appeal in TV Ads**
Rachel Bailey, Paul D. Bolls, Kevin Wise, & Glenn Leshner
University of Missouri—Columbia

- 41. An Examination of Heart Rate Variability During Positive and Negative Radio Messages**
Jacob Koruth¹, Robert F. Potter¹, Paul D. Bolls², & Annie Lang¹
¹*Indiana University*, ²*Missouri School of Journalism*
- 42. Yo-Mam! Validating a Measure for Assessing Individual Differences in Motivational Activation in Children**
Annie Lang, Satoko Kurita, Sungkyoung Lee, & Pamela Gayle Nadorff
Indiana University
- 43. The Interplay Between Income and Midfrontal EEG Asymmetry in Children from Low-Income Households**
Cory A. B. Jackson¹, Eric Dearing², Daren C. Jackson¹, & Walter D. Scott¹
¹*University of Wyoming*, ²*Boston College*
- 44. Demand Characteristics in Emotion Regulation Paradigms**
Nicholas G. Schwab, David L. Jost, & Daren C. Jackson
University of Wyoming
- 45. Generalizing Knowledge: ERPs Reveal the Time-Course of Retrieval of Novel Categories**
Caterina Gratton, Karen M. Evans, & Kara D. Federmeier
University of Illinois, Urbana—Champaign
- 46. Hemispheric Differences in Syntactic Modulation on the Lexical Ambiguity Resolution—An Event Related Potential Study**
Chia-lin Lee & Kara D. Federmeier
University of Illinois, Urbana—Champaign
- 47. How I Learned to Stop Worrying and Love the VCR: N400 Processing of Illegal Strings in Sentence Context**
Sarah Laszlo & Kara D. Federmeier
University of Illinois, Urbana—Champaign

- 48. Two Sides of Meaning: The Scalp-Recorded N400 Reflects Distinct Contributions from the Cerebral Hemispheres**
Edward W. Wlotko & Kara D. Federmeier
University of Illinois, Urbana–Champaign
- 49. Combined Effects of Alcohol and Nicotine on Acoustic Startle Reflex in Response to a Social Stressor**
Jennifer C. Veilleux¹, Jon D. Kassel¹, Margaret C. Wardle¹, Marisa C. Yates¹, Linda Roesch¹, & David J. Drobes²
¹*University of Illinois, Chicago*, ²*University of South Florida*
- 50. Reduced Lateralized Readiness Potential (LRP) Amplitude in Schizophrenia Patients**
Emily S. Kappenman¹, Rebecca L. Fuller², Steven J. Luck¹, Benjamin Robinson², Elsie L. Braun³, & James M. Gold²
¹*University of California, Davis*, ²*Maryland Psychiatric Research Center*, ³*University of Iowa*
- 51. P3 Amplitude Predicts Treatment Compliance in Substance Dependent Individuals**
Robyn M. Baldridge & Matthew S. Stanford
Baylor University
- 52. Working Memory and Impulsive Aggression**
Amanda Colby & Matthew S. Stanford
Baylor University
- 53. Brain Potentials to Structural Reanalysis of Arithmetic Expressions**
Naiyi Wang¹, Burkhard Maess¹, Yuejia Luo², & Angela D. Friederici¹
¹*Max Planck Institute for Human Cognitive and Brain Sciences*, ²*Beijing Normal University*
- 54. Cortisol Increases During Interracial Encounters Predict (Over-) Correction of Bias**
Katrina R. Koslov & Wendy Mendes
Harvard University

55. Genetic and Environmental Contributions to P300 Amplitude as a Function of Adolescent Alcohol Use

Greg Perlman, Wendy Johnson, Steve M. Malone, & William G. Iacono
University of Minnesota

56. Physiological Compliance and Team Performance During the Highly Dynamic Task of Building Clearing

Amanda N. Elkins, Alexander D. Walker, Thomas L. Carpenter, Jason D. Moss, Karsten L. Lowe, Thomas W. Epton, Adam W. Hoover, & Eric R. Muth
Clemson University

57. The Effects of Parental Divorce on Females' Cardiac Reactivity and Hesitancy Towards Public Displays of Affection

Lauren M. Haack, Amanda N. Elkins, Stephanie R. Fishel, & Eric R. Muth
Clemson University

58. The Relationship Between Aerobic Fitness and the Attentional Networks in Preadolescent Children

Sarah M. Buck, Nicole M. Surico, Kristopher J. Wnek, Darla M. Castelli, & Charles H. Hillman
University of Illinois, Urbana–Champaign

59. The Relationship of Age and Fitness to Attentional Orienting and Task Difficulty

Matthew B. Pontifex¹, Charles H. Hillman¹, & John Polich²
¹*University of Illinois, Urbana–Champaign*, ²*The Scripps Research Institute*

60. Neuroelectric Indices of Error Correction and the Regulation of Cognitive Control

Charles H. Hillman, Jason R. Themanson, Matthew B. Pontifex, Douglas C. George, Kelli M. Thompson, Teresa A Valentini, & Kristopher J. Wnek
University of Illinois, Urbana–Champaign

-
- 61. Cardiorespiratory Fitness Influences on the Modulation of Neuroelectric and Behavioral Indices of Action Monitoring**
Jason R. Themanson, Matthew B. Pontifex, & Charles H. Hillman
University of Illinois, Urbana–Champaign
- 62. Resting Brain Activity Predicts Emotion Regulation Success**
Marina L. Bontowski, Christen M. Deveney, & Diego A. Pizzagalli
Harvard University
- 64. Affective Modulation of the Acoustic Startle Eyeblink Reflex in Fibromyalgia**
Emily J. Bartley, Amy E. Williams, & Jamie L. Rhudy
University of Tulsa
- 65. The Influence of Emotionally-Charged Facial Expressions on the Acoustic Startle Reflex**
Klanci M. McCabe, Amy E. Williams, Emily J. Bartley, & Jamie L. Rhudy
University of Tulsa
- 66. Emotional Modulation of Nociceptive Reactions: Do Borderline Personality Traits Play a Role?**
Jennifer L. Russell, Amy E. Williams, Klanci M. McCabe, & Jamie L. Rhudy
University of Tulsa
- 67. Affective Modulation of Blink Reflexes Following Painful Trigeminal Nerve Stimulation**
Amy E. Williams & Jamie L. Rhudy
University of Tulsa

- 68. The Influence of Behavioral Activation and Behavioral Inhibition on Affective Modulation of Nociception**
Carl P. Lattimore, Amy E. Williams, Klanci M. McCabe, & Jamie L. Rhudy
University of Tulsa
- 69. Preparation for Speeded Action: Distinguishing the Effects of Phasic Arousal and Temporal Orienting with fMRI**
Robert Langner¹, Bettina Rolke², Rolf Ulrich², Michael Erb², Wolfgang Grodd², & Steven A. Hackley³
¹*Aachen University*, ²*University of Tübingen*,
³*University of Missouri—Columbia*
- 70. Neural Mechanisms of Visual Working Memory Deficits**
Eun-Young Lee¹, Cowan Nelson¹, Rolan Terry¹, Edward K. Vogel², & Steven A. Hackley¹
¹*University of Missouri—Columbia*, ²*University of Oregon*
- 71. Out of Sight But Still in Mind: Shift of Attention Precedes Shift of Dominance in Binocular Rivalry**
Andrea Schankin¹, Fernando Valle-Inclan², & Steven A. Hackley³
¹*Ludwig Maximilian University—Munich*,
²*University of La Coruna*, ³*University of Missouri—Columbia*
- 72. Expectancy-Driven Modulation of Primary Auditory Cortical Responses**
Thomas Hartmann¹, Nathan Weisz², Winfried Schlee¹, Katalin Dohrmann¹, & Thomas Elbert¹
¹*University of Konstanz*, ²*INSERM U821*
- 73. Neuromagnetic Activity During Recognition of Emotional Pictures**
Anne Hauswald & Johanna Kissler
University of Konstanz

- 74. Childhood Stress Load Affects Psychoendocrinological Responses in Psychiatric Patients**
Katja Weber¹, Jens Borgelt¹, Barbara Awiszus¹, Tzvetan Popov¹, Brigitte Rockstroh¹, Harald Engler², & Manfred Schedlowski³
¹University of Konstanz, ²Swiss Federal Institute of Technology Zurich, ³University of Duisburg-Essen
- 75. Intensity Information Encoded in Auditory Imagery as Indexed by Electrophysiological and Behavioral Measures**
Jianhui Wu¹, Yuejia Luo², Zhulin Yu³, Xiaoqin Mai¹, & Junxian Shen³
¹Institute of Psychology, Chinese Academy of Sciences, ²Beijing Normal University, ³Institute of Biophysics, Chinese Academy of Sciences
- 76. Comparing Working Memory Contents vs. Recalling Working Memory Contents: P3 and Late Negative Component Differences**
Jason W. Wyatt, James K. Kroger, & Doerte K. Spring
New Mexico State University
- 77. Increased Activation of the Frontal P3 During Encoding is Associated with Poorer Working Memory Performance in Middle Aged Adults**
Ashley S. Hamlin, Janet L. Shucard, Ayda Tekok-Kilic, & David W. Shucard
University at Buffalo, SUNY
- 78. An Electrophysiological Study of Age-Related Differences in Encoding and Maintenance During a Spatial Working Memory (WM) Task**
Ayda Tekok-Kilic, Janet L. Shucard, Ashley S. Hamlin, & David W. Shucard
University at Buffalo, SUNY
- 79. Asymmetrical Frontal EEG and Anger Following Social Rejection**
Carly K. Peterson & Eddie Harmon-Jones
Texas A&M University

80. Physiological Arousal During Narration of Emotional Events in Secure and Dismissive Attached Individuals

Ana E. Wyman¹, Arlene R. King², & Carol Magai³

¹*Intercultural Institute for Human Development and Aging*, ²*Columbia University*, ³*Long Island University*

81. Voiced Laughter Elicits More Positive Affect in Listeners than Unvoiced Laughter

Michael C. Philipp, Eric J. Vanman, & Michael J. Owren

Georgia State University

82. Low-Cost EEG/ERP Lab Development and Validation Using a Visual CPT Oddball Paradigm

Richard T. Amoss & Eric J. Vanman

Georgia State University

83. Simple Affective Conditioning to Colors as Revealed by Brow and Cheek Electromyographic Activity

Lisa A. Elliott, Emma Kearney, Will Kearney, & Eric J. Vanman

Georgia State University

84. Fight or Flight: Fear, Anger, and Aggressive Responding

Ashley Kilmer¹, Naomi Sadeh¹, & Edelyn Verona²

¹*University of Illinois, Urbana–Champaign*,

²*University of Illinois, Chicago*

85. Eyeblink and Post-Auricular Startle Modulation During Reward, Punishment, and Frustration in Deprived and Non-Deprived Smokers

Miguel A. Muñoz¹, Steve S. Hackley¹, Sonia S. Rodriguez¹, Luis C. Delgado¹, Isabel I. Antunes de Paula², M^aCarmen Fernández-Santaella¹, & Jaime J. Vila¹

¹University of Granada, ²Federal Fluminense University

86. Differences in Exercise and Baseline Heart Rate Interactions in High and Low Worriers

Michael M. Knepp & Laura E. Tiffin
Virginia Tech

87. Frustration and Novelty: Effects on Autonomic Response in Internet Users

Michelle A. Patriquin, Michael M. Knepp, Bruce H. Friedman, Angela Scarpa, & Anthony O. Wells
Virginia Tech

88. Cortical Dynamics of Object-Sensitive Neural Activity

Emily A. Slocombe, Lisa C. Lucia, & Haline E. Schendan
Tufts University

89. Differential Effects of Chocolate and Coffee Scents on Cognition, Physiology, and Clerical Office Work

Daniel Felbaum, Kristen Koval, Justin Schmitt, & Bryan Raudenbush
Wheeling Jesuit University

90. Differential Effects of Visual Distractions on Pain Threshold and Tolerance

Daniel Felbaum, Ryan Hunker, Bryan Raudenbush, Corrine Chamberlin, & Jerry Nolan
Wheeling Jesuit University

- 91. The Role of the Cholinergic Pathway in Airway Response to Emotional Stimuli**
Antje Kullowatz¹, Hans-Juergen Smith², Stefan Weber³, Frank Kannies⁴, Helgo Magnussen⁴, Bernhard Dahme³, & Thomas Ritz¹
¹*Southern Methodist University*, ²*Jaeger/Toennies GmbH*, ³*University of Hamburg*, ⁴*Hospital Grosshansdorf*
- 92. Emotional Reactivity of the Airways in Asthma: Association with Markers of Airway Reactivity and Pathophysiology**
Thomas Ritz¹, Antje Kullowatz¹, Hans-Juergen Smith², Christopher Burrows¹, Frank Kannies³, Bernhard Dahme⁴, & Helgo Magnussen³
¹*Southern Methodist University*, ²*Jaeger/Toennies GmbH*, ³*Hospital Grosshansdorf*, ⁴*University of Hamburg*
- 93. Paced Breathing Does Not Alter Respiratory Resistance in Healthy Individuals**
Bernhard Dahme¹, Miriam Thoens¹, & Thomas Ritz²
¹*University of Hamburg*, ²*Southern Methodist University*
- 94. Respiratory Muscle Tension as a Determinant of Breathlessness in Individuals with High and Low Anxiety Sensitivity**
Sibylle Petersen¹, Lavanya Bhaskara², Catherine P. Seger², Tristan A. Knowles², Alicia E. Meuret², & Thomas Ritz²
¹*University of Hamburg*, ²*Southern Methodist University*
- 95. Time Estimation Differences in Low and High Hostile Men: Behavioral and Physiological Correlates of Right Frontal Regulation of an Internal Clock**
Holland K. Alissa, Joseph E. Carmona, David E. Cox, Thomas Belcher, Samantha Wolf, & David Harrison
Virginia Polytechnic Institute and State University

- 96. Younger and Older Adult Slow Wave Potentials During Problem Solving are Differentially Modified by Strategy Training**
Kimberly H. Anderson, Dana L. Byrd, & W. Keith Berg
University of Florida
- 97. The Effects of Methylphenidate on Attention and Inhibition in Attention-Deficit/Hyperactivity Disorder**
Rebecca L. Ashare¹, Larry W. Hawk, Jr.¹, Keri Shiels Keri, Sarah V. Spencer², Brian Gangloff¹, James G. Waxmonsky¹, William E. Pelham, Jr.¹, & Jerry B. Richards¹
¹*University at Buffalo, SUNY*, ²*Umberto I Hospital-Mestre*
- 98. Placebo Analgesia Related to Reduced Negative Emotions**
Per Aslaksen & Magne Arve Flaten
University of Tromsø
- 99. Processing Self-Triggered Sounds: Evidence for Precise Forward-Models**
Pamela Baess, Thomas Jacobsen, & Erich Schröger
University of Leipzig
- 100. Orienting of Attention Influences Visual Memory Storage**
Marcin Biernacki¹, & Adam Tarnowski²
¹*Polish Air Force Institute of Aviation Medicine*,
²*Warsaw University*
- 101. Possible Antioxidant and Neuroprotective Mechanisms of Zolpidem in Attenuating Typical Antipsychotic-Induced Orofacial Dyskinesia—A Biochemical and Neurochemical Study**
Mahendra Bishnoi, Shrinivas Kulkarni, & Kanwaljit Chopra
Panjab University

- 102. Use of Video Games to Distract Physical Therapy Patients from Pain and Anxiety**
Trevor Cessna & Bryan Raudenbush
Wheeling Jesuit University
- 103. Event-Related Potential Correlates of Individual Differences in Activation of Achievement Goals**
Sonja Damnjanovic & Ira Fischler
University of Florida
- 104. Looking at Small Emotional Pictures: Arousal and Attention**
Andrea De Cesarei, Martina Luchetti, & Maurizio Codispoti
University of Bologna
- 105. The Effects of Audio-Visual Stimulation on Heart Rate Variability**
Ralph W. Emerson, Thomas J. Pardikes, Bruce H. Friedman, & Chad L. Stephens
Virginia Polytechnic Institute and State University
- 106. The Effects of Smoking on Heart Rate Response to Emotionally Valenced Slides in Adolescent Smokers**
Daniel P. Evatt, Jon D. Kassel, Justin E. Greenstein, Megin C. Wardle, Jenn C. Veilleux, Linda L. Roesch, & Robin Mermelstein
University of Illinois, Chicago
- 107. Changes in Respiratory Sinus Arrhythmia in Response to Low and High Workload Conditions on a Military Forward Observer PC Simulator (FOPCSIM) Task**
Stephanie R. Fishel, Lyndsey Banks, Lauren N. Brewer, Jarryd Player, Adam W. Hoover, & Eric R. Muth
Clemson University
- 108. Relative Left Frontal EEG Activation Predicts Attentional Narrowing Following Appetitive Stimuli**
Philip A. Gable & Eddie Harmon-Jones
Texas A&M University

- 109. Age-Associated Hemispheric Asymmetry Reduction on the Auditory M100 to Nonverbal Stimuli**
Yuan Gao, Megan Boyd, Leonard Poon, & Brett Clementz
University of Georgia
- 110. Modulation of the ERN in Lose/Lose Trials in Individuals with Obsessive-Compulsive and Depressive Symptomology**
Theo O. J. Gründler¹, James Cavanagh², Michael J. Frank², & John J. B. Allen²
¹*University of Trier*, ²*University of Arizona*
- 111. A Call for Pseudo-Randomization: The Influence of Preceding Picture Affect Type in Affective Modulation of Startle**
Valerie L. Hobson, Jared P. Dempsey, Lee M. Cohen, Megan Jaeger, & Paige Miller
Texas Tech University
- 112. Social Anxiety Attenuates PPI and Alters Laterality of Response**
Andrea M. Hopkins, Patricia M. White, Shannon L. Hopkins, & Bill T. Troyer
University of Oregon
- 113. Feedback-Related Negativity Reflects the Evaluation Based on One's Own Criteria**
Shun Itagaki¹ & Jun'ichi Katayama²
¹*The University of Tokyo*, ²*Hokkaido University*
- 114. Deficient Habituation During Negative Mood States: A Potential Risk Factor for Borderline Personality and Alcohol Use Disorders**
Lisa M. James, Leonardo Bobadilla, Mark D. Reeves, & Jeanette Taylor
Florida State University
- 115. Emotional Startle Modulation During Script Driven Imagery in Patients with Borderline Personality Disorder**
Anke Limberg, Sven Barnow, Harald J. Freyberger, & Alfons O. Hamm
University of Greifswald

- 116. Age-Related Changes in P3 Response and Executive Functioning**
David A. S. Kaufman, William M. Perlstein, Michelle J. Blanco, Michael J. Larson, & Dawn Bowers
University of Florida
- 117. Effect of Sodium Valproate (Depakin) on EEG Patterns in Epileptic Children**
Irma O. Khachidze, Viktor I. Maloletnev, & Manana L. Gugushvili
Georgian I. Beritashvili Institute of Physiology
- 118. Decreased Lateralization of the P2 Event-Related Brain Potential (ERP) Component in Response to Visual Word Stimuli in Schizophrenia**
Michael Kiang, Marta Kutas, Gregory A. Light, & David L. Braff
University of California, San Diego
- 119. Context-Dependent Differences in the Pre-Attentive Processing of Familiar and Unfamiliar Sounds**
Ursula Kirmse, Erich Schröger, & Thomas Jacobsen
University of Leipzig
- 120. Evidence that Aversive Conditioning Occurs While Assessing Prepulse Inhibition of Acoustic Startle**
Frauke Nees¹, Melanie Hahn¹, Terry D. Blumenthal², & Hartmut Schächinger¹
¹*University of Trier*, ²*Wake Forest University*
- 121. Hypocortisolism Facilitates Trace, But Not Delay Classical Conditioning**
Frauke Nees, Steffen Richter, & Hartmut Schächinger
University of Trier

- 122. Performance Monitoring, the P300, and Externalizing: What Relationships Among ERP Measures Tell Us about the Neural Substrates of Impulse Control Problems**
Lindsay D. Nelson, Edward E. Bernat, & Christopher J. Patrick
University of Minnesota
- 123. Long-Term Retention of Extinction Memory for Explicitly Learned Fear Relevant Stimuli**
Julia Ofer, Alexander Kroll, & Christiane Hermann
Central Institute for Mental Health
- 124. Crossmodal Effects of Attention: Visual Load Modulates Processing of Visual and Auditory Distractors**
Nathan A. Parks, Matthew R. Hilimire, & Paul M. Corballis
Georgia Institute of Technology
- 125. Presaccadic Interhemispheric Spatial Updating in Humans**
Nathan A. Parks & Paul M. Corballis
Georgia Institute of Technology
- 126. Emotional Responses Vary with Awareness: Psychophysiological Responses to Masked Spiders**
Nathalie Peira¹, Armita Golkar¹, Arne Öhman², & Stefan Wiens¹
¹*Stockholm University*, ²*Karolinska Institutet*
- 127. Emotion is Good: Psychological Well-Being Predicts Heightened Cardiovascular Response to Another's Distress**
Elaine F. Perea¹, Michelle N. Shiota¹, & Robert W. Levenson²
¹*Arizona State University*, ²*University of California, San Francisco*

- 128. Altered Resting-State Brain Connectivity in Tinnitus Patients Revealed by Phase-Synchrony Analysis**
Winfried Schlee¹, Nathan Weisz², Thomas Hartmann¹, Katalin Dohrmann¹, & Thomas Elbert¹
¹*University of Konstanz*, ²*INSERM U821 Lyon*
- 129. Selective Emotion Processing as a Function of Perceptibility: An ERP Analysis**
Ralf Schmäzle, Jessica Stockburger, Florian Bublitzky, Tobias Fleisch, & Harald T. Schupp
University of Konstanz
- 130. Cardiovascular Fitness and Executive Control: An ERP Study**
Jenna L. Scisco¹, & P. Andrew Leynes²
¹*Clemson University*, ²*The College of New Jersey*
- 131. Cardiovascular Reactivity and Affective Startle Modulation During Emotional Picture Viewing**
Simona Scozzari, Michela Sarlo, Marta Ghisi, Luciano Stegagno, & Daniela Palomba
University of Padova
- 132. Susceptibility of the Pattern MMM to the Attentional Demands of Continuous Multiple Object Tracking**
Lauren D. Sculthorpe, Kenneth B. Campbell, & Charles A. Collin
University of Ottawa
- 133. Predicting Emotional Experience from Autonomic Physiology Using Machine Learning Methods**
Ekaterina Spriggs¹, Emily A. Butler¹, Kobus BarnardKobus, Frank H. Wilhelm², & James J. Gross³
¹*University of Arizona*, ²*University of Basel*,
³*Stanford University*

134. The Role of Somatomotor Representations in the Recognition of Affective Prosody: An ERP Study

Valery Sramko & Mario Liotti
Simon Fraser University

135. The Impact of Unconscious Facial Expressions on Consumption Behavior Involves Changes in Positive Affect: Evidence from EMG and Appetitive Reflex-Modulation

Mark J. Starr, Johnny Lin, & Piotr Winkielman
University of California, San Diego

136. Brain Correlates of Selective Stopping: Playing Safe?

Marijke van de Laar¹, Wery van den Wildenberg¹, Geert van Boxtel², & Maurits van der Molen¹

¹*University of Amsterdam*, ²*University of Tilburg*

137. Emotion Regulation Strategies: Differential Cognitive and Physiological Effects

Rachael N. Volokhov & Heath A. Demaree
Case Western Reserve University

Poster Session III
Saturday, October 20, 2007

7:00 P.M.—9:00 P.M.

Harborside Center

Poster Presenter Schedule

8:00 A.M.—9:30 A.M. Posters Assembled

9:30 A.M.—7:00 P.M. Posters Available for Viewing

7:00 P.M.—9:00 P.M. Authors Present for
 Discussion and Questions

9:00 P.M.—10:00 P.M. Dismantle Posters

1. The Effects of Pramipexole, a D2/D3 Agonist, on Reward Processing: An ERP Source Localization Study

Diane L. Santesso¹, Erika Cowman¹, Petra Pajtas¹, A. Eden Evans², & Diego A. Pizzagalli¹
¹*Harvard University*, ²*Massachusetts General Hospital*

2. Visual Fixations Reveal Hemispheric Asymmetries in Meaning Selection and Revision

Aaron M. Meyer & Kara D. Federmeier
University of Illinois, Urbana—Champaign

3. Neuromagnetic Indicators of Selective Distractor Suppression While Anticipating an Auditory Target

Nathan Weisz & Olivier Bertrand
INSERM U821

4. How Picture Repetition Affects Attention and Emotion

Vera Ferrari¹, Margaret M. Bradley¹, Maurizio Codispoti², & Peter J. Lang¹
¹*University of Florida*, ²*University of Bologna*

5. **Emotional Stimuli in the Visual Periphery Successfully Compete for Resources with a Foveal High-Load Primary Task**
Andreas Keil, Dean Sabatinelli, Margaret M. Bradley, & Peter J. Lang
University of Florida
6. **Recognition Memory for Emotional and Non-Emotional Pictures**
Francesco Versace, Margaret M. Bradley, & Peter J. Lang
University of Florida
7. **Negative Affect and the Reflex Physiology of Emotion**
J. Carson Smith¹, Margaret M. Bradley², & Peter J. Lang²
¹*University of Wisconsin—Milwaukee*, ²*University of Florida*
8. **Neuronal Correlates of Explicit Versus Implicit Processing of CS-US Contingency During Fear Conditioning**
Christiane Hermann, Alexander Kroll, & Julia Ofer
Central Institute for Mental Health
9. **Adapting the P300-Brain Computer Interface (BCI) for the Control of a Wheelchair-Mounted Robotic Arm System**
Yael Arbel, Redwan Alqasemi, Rajiv Dubey, & Emanuel Donchin
University of South Florida
10. **Cardiac Reactivity in Active Coping: Influence of Task Difficulty and Incentive Value**
Michael Richter & Guido H. E. Gendolla
University of Geneva

- 11. Physionomics of Tax Evasion: Cheating Rationally or Deciding Emotionally**
Giorgio Coricelli¹, Mateus Joffily¹, Claude Montmarquette², & Marie-Claire Villeval³
¹*Institute of Cognitive Sciences, CNRS,*
²*University of Montreal,* ³*GATE, CNRS*

- 12. Voluntary Movements Mechanism Formation in Right- and Lefthanded Children in Ontogegesis**
Mariam Bezroukikh
Institute of Development Physiology, RAO

- 13. Mental Counting and Operating: An ERP Study about Task Switching**
James Kroger, Doerte K. Spring, Holly Archer, & Breannan Stone
New Mexico State University

- 14. Resting Frontal Brain Asymmetry and Behavioral Activation and Inhibition**
Daren C. Jackson¹, Cory A. B. Jackson¹, Aminda O'Hare², Nicholas G. Schwab¹, & Danielle J. Maack¹
¹*University of Wyoming,* ²*University of Kansas*

- 15. Coherence Between Physiological and Experiential Response Systems is Positively Associated with Emotional Recovery from Negative Pictures**
Regina C. Lapate, Carien M. vanReekum, Catherine J. Norris, Larry L. Greischar, Jennifer M. Oh, & Richard J. Davidson
University of Wisconsin—Madison

- 16. Binary Evaluation of Reward Versus Non-Reward: Reflected by Feedback Negativity and P300**
Yue-Jia Luo¹, Yu-Xia Huang¹, & Kin-Hung Ting²
¹*Beijing Normal University,* ²*The Hong Kong Polytechnic University*

- 17. Action Monitoring of Perceived Errors in a Target Force Production Task**
Hiroaki Masaki¹, Keiko Ogawa², Werner Sommer³, Noriyoshi Takasawa⁴, & Katuo Yamazaki¹
¹Waseda University, ²Japan Society for the Promotion of Science, ³Humboldt University of Berlin, ⁴Edogawa University
- 18. The Effect of Punishment on Action Monitoring**
Keiko Ogawa¹, Hiroaki Masaki², Noriyoshi Takasawa³, Katuo Yamazaki², & Werner Sommer⁴
¹Japan Society for the Promotion of Science, ²Waseda University, ³Edogawa University, ⁴Humboldt University of Berlin
- 19. Lack of N170 Modulation by Facial Emotion in Schizophrenia: A Preliminary Analysis**
Spencer K. Lynn, Robert W. McCarley, & Dean F. Salisbury
Harvard Medical School
- 20. Sensory Processing, Physiological Reactivity and Adaptive Behavior in Children with Autism and Sensory Modulation Dysfunction**
Roseann C. Schaaf & Teal Benevides
Thomas Jefferson University
- 21. Spreading Activation or Semantic Integration: Proverbs Test the Nature of the N400**
Boris Kotchoubey & Miriam Jander
University of Tübingen
- 22. Activation, Connectivity, and Morphology of the Amygdala Predict Individual Differences in Blood Pressure Reactivity to Psychological Stress**
Peter J. Gianaros, Lei K. Sheu, Karen A. Matthews, & Ahmad R. Hariri
University of Pittsburgh

- 23. Event-Related Potentials Differences in the Processing of Emotional-Content Words and Pictures**
José A. Hinojosa¹, Luis Carretié², María A. Valcárcel¹, & Miguel A. Pozo¹
¹*Universidad Complutense de Madrid*,
²*Universidad Autónoma de Madrid*
- 24. The Effect of Task Difficulty on the Stimulus-Preceding Negativity**
Yasunori Kotani¹, Yoshimi Ohgami¹, Tatsuya Yoshihiro¹, Tetsuji Tsukamoto², Junichiro Arai³, Yusuke Inoue⁴, & Yasutsugu Aihara⁵
¹*Tokyo Institute of Technology*, ²*GE-Yokogawa Medical Systems*, ³*Daikin Industries*, ⁴*The University of Tokyo*, ⁵*Tokyo Metropolitan University*
- 25. The Effect of Stimulus Properties on the Stimulus-Preceding Negativity (SPN)**
Yoshimi Ohgami¹, Yasunori Kotani¹, Tatsuya Yoshihiro¹, Tetsuji Tsukamoto², Yasutsugu Aihara³, Junichiro Arai⁴, & Yusuke Inoue⁵
¹*Tokyo Institute of Technology*, ²*GE-Yokogawa Medical Systems*, ³*Tokyo Metropolitan University*, ⁴*Daikin Industries*, ⁵*The University of Tokyo*
- 26. Specification of Emotion by Means of Specific Autonomic Response Patterns**
Eddy Esselink, Johanna Kuenzel, René Lion, & Qizheng Sheng
Unilever Research & Development Vlaardingen
- 27. Early Activation of Anterior Cingulate Cortex in Conflict Resolution During Voluntary Orienting of Spatial Attention**
Alberto Zani¹, Valentina Rossi², & Alice M. Proverbio²
¹*National Research Council*, ²*University of Milano-Bicocca*
- 28. Threat-Related Attentional Bias in Anxiety**
Heleen A. Slagter, Bridget J. Kelly, Alexander J. Shackman, & Richard J. Davidson
University of Wisconsin—Madison

- 29. Electrodermal Response Modulation as a Possible Endophenotype for Substance Dependence**
Jeanette Taylor¹, Scott R. Carlson², & William G. Iacono³
¹Florida State University, ²University of British Columbia, ³University of Minnesota
- 30. Eye-Blink Startle Evoked by Defense Noise and Modulated Presenting Affective Sounds**
Jose L. Mata¹, Sonia Rodriguez², Miguel A. Muóoz², Gabriela Souza³, Laura Miccoli², Lourdes Anllo-Vento², & Jaime Vila²
¹University of Jaen, ²University of Granada, ³Federal University of Rio de Janeiro
- 31. Threat of Shock During Picture Viewing: An ERP Study**
M. Carmen Pastor¹, Rosario Poy¹, Pilar Segarra¹, Raquel López¹, Susana Montañés¹, Javier Moltó¹, & Margaret M. Bradley²
¹Jaume I University, ²University of Florida
- 32. Threat of Shock During Picture Viewing: Peripheral Correlates**
Rosario Poy¹, Raquel López¹, M. Carmen Pastor¹, Pilar Segarra¹, Susana Montañés¹, Javier Moltó¹, & Peter J. Lang²
¹Jaume I University, ²University of Florida
- 33. An Event-Related Potential Paradigm for Identifying Contextually Significant Attitude Stimuli Even When People Intentionally Misreport Their Attitudes**
Stephen L. Crites¹, Andrew Mojica², Guadalupe Corral¹, & Jennifer Taylor¹
¹University of Texas at El Paso, ²University of Arizona
- 34. Erp N400 Effect with Evaluatively Incongruent Attitudes**
Stephen L. Crites, Jennifer H. Taylor, Guadalupe Corral, & Andrew Mojica
The University of Texas-El Paso

- 35. Poor Electrodermal Response Modulation: A Specific Putative Biomarker for Substance Dependence**
Jeanette Taylor, Leonardo Bobadilla, Lisa M. James, & Mark D. Reeves
Florida State University
- 36. Children's Physiological Responses to Animal and Human Emotional Faces as a Function of Age**
P. Gayle Nadorff, Sungkyoung Lee, Madhuja Banerjee, & Annie Lang
Indiana University
- 37. The Effect of Perceived Susceptibility on Autonomic Responses to and Memory for Health-Related News**
Kevin Wise, Petya Eckler, Anastasia Kononova, & Jeremy Littau
University of Missouri—Columbia
- 38. Reading and Watching News Online: Orienting to a Text-Video Modality Switch and Recognition Memory as a Function of Text Structure and Video Intensity**
Kevin Wise, Paul D. Bolls, Justin Myers, Rachel Heaton, & Brian Pellot
University of Missouri—Columbia
- 39. Pet Dogs Attenuate Cardiovascular Stress Responses Among Women with Rheumatoid Arthritis**
Karen M. Allen
University at Buffalo, SUNY
- 40. Startle Modulation by Affective Faces**
Andrey P. Anokhin & Simon Golosheykin
Washington University School of Medicine
- 41. Visual Mismatch Negativity to Orientation Changes: A Memory-Based Process**
Piia Astikainen¹, Elina Lillstrang¹, & Timo Ruusuvirta²
¹*University of Jyväskylä*, ²*University of Helsinki*

- 42. Following of Lobotomised Temporal Lobe Epileptic Patients Using Auditory Brainstem and Middle-Latency Evoked Responses**
Margarita M. Báez-Martín, Lilia M. Morales-Chacón, & Ivette Cabrera Abreu
International Center for Neurological Restoration
- 43. Developmental Trajectories of Working Memory Performance and Frontal EEG Between 5 and 10 Months of Age**
Martha Ann Bell
Virginia Tech
- 44. Auditory Entrainment in Schizophrenia and Schizotypal Personality Disorder**
Colleen A. Brenner¹, William P. Hetrick¹, Anantha Shekhar², & Brian F. O'Donnell¹
¹*Indiana University, Bloomington*, ²*Indiana University School of Medicine*
- 45. Coupling Strength Between Low Frequency Phase and High Frequency Power in the Resting EEG of Healthy Individuals**
Colleen A. Brenner, Giri Krishnan, William P. Hetrick, & Brian F. O'Donnell
Indiana University—Bloomington
- 47. ERP Affective Modulation and Perceptual Load**
Rossella Cardinale, Andrea De Cesarei, & Maurizio Codispoti
University of Bologna

- 48. Alpha Desynchronization and Cognitive Control: Sensitivity of Prestimulus Alpha to Prior and Subsequent Behavior**
Joshua Carp & Rebecca J. Compton
Haverford College
- 49. Interpersonal Similarity Modulates Observational Error Processing**
Joshua Carp, Michael Halenar, Lorna C. Quandt, Alfredo Sklar, & Rebecca J. Compton
Haverford College
- 50. Resting Respiratory Sinus Arrhythmia and Task Working Memory Load Jointly Relate to Prefrontal and Parietal Activations and Limbic Deactivations**
Israel C. Christie, Matthew J. Robinson, Matthew F. Muldoon, Julie C. Price, & J. Richard Jennings
University of Pittsburgh
- 51. Enhanced Sensory Cortical Gamma Oscillations During Fear-Conditioning Revealed by Spatially-Filtered Magnetoencephalography (MEG)**
Brian R. Cornwell, Linda L. Johnson, & Christian Grillon
National Institute of Mental Health
- 52. Chronometry of Threat Modulated Startle in Children: A Growth Curve Modeling Approach**
Michael J. Crowley, Lei Liu, Jessica L. Borelli, Heping Zhang, & Linda C. Mayes
Yale University
- 53. Morphed Intensity of Emotional Expressions and Event-Related Potentials**
Michael J. Crowley, Christopher A. Bailey, Eric M. Langlois, Adriane Levin, & Linda C. Mayes
Yale University

- 54. Emotion Perception: Affective Modulation by Long-Duration Sustained Exposure**
Bruce Cuthbert, Michelle Roth, Jeffrey Engelmann, Daniel Goldman, Adam Wilke, & Kevin Keane
University of Minnesota
- 55. Exteroceptive and Interoceptive Mental States: EEG Testimony**
Sergey G. Danko, Yulia A. Boitsova, & Maria L. Solovjeva
Institute of the Human Brain, Russian Academy of Sciences
- 56. Impact of Internally Induced Emotions on EEG and RCBF Activations**
Sergey G. Danko, Nathalya V. Shemyakina, Nathalya P. Bechtereva, & Svyatoslav V. Medvedev
Institute of the Human Brain, Russian Academy of Sciences
- 57. Cardiovascular Responses to Blood Donation and Applied Tension**
Blaine Ditto, Nelson Byrne, & Diana Miceli
McGill University
- 58. An Artificial Neural Network Model of Orienting Attention Towards Threatening Somatosensory Stimuli**
Robert Dowman & Daniel ben-Avraham
Clarkson University
- 59. When Novelty Wears Off: Effects of Probability on P3A**
Connie C. Duncan¹, Frances H. Gabbay¹, Antonee R. Stern¹, Preetha A. Abraham¹, & Michiel B. de Rooter²
¹*Uniformed Services University of the Health Sciences*, ²*University of Amsterdam*

- 60. The Effects of Lighting on Autonomic Control of the Heart**
Eve Edelstein¹, Robert J. Ellis², John J. Sollers, III², & Julian F. Thayer²
¹*Academy of Neuroscience for Architecture*, ²*The Ohio State University*
- 61. Fear or Disgust: Psychophysiological Responses to Emotional Pictures**
Francisco Esteves¹, Elisabeth Ruiz-Padial², Ana C. Ferreira¹, & Gustavo Reyes-del-Paso²
¹*Instituto Superior de Ciências do Trabalho e da Empresa*, ²*Universidad de Jaén*
- 62. Neural Correlates of Automatic Attention to Smoking Cues: Development of the Smoking Oddball Task**
David E. Evans¹, Nathan Maxfield², Carrie Rix², John Johnston², & David J. Drobos²
¹*Moffitt Cancer Center*, ²*University of South Florida*
- 63. Attentional Bias for Threat in Anxiety is Revealed by the Early N2PC Component of Attention**
Elaine Fox¹, Nazanin Derakshan², & Leor Shoker²
¹*University of Essex*, ²*Birkbeck University of London*
- 64. No Joke: Motivated Cognition While Viewing the Daily Show and Broadcast Network Newscasts**
Julia R. Fox¹, Brian Wilson¹, Volkan Sahin¹, Ashley Sanders-Jackson², Glory Koloen¹, & Ya Gao¹
¹*Indiana University*, ²*University of Pennsylvania*
- 65. A Measurement of EEG Response Differences Between Media Used for Stimuli Presentation**
Joel C. Geske
Iowa State University

- 66. Emotion Processing in Depersonalization Disorder**
Timo Giesbrecht¹, Harald Merckelbach¹, & Daphne Simeon²
¹Maastricht University, ²Mount Sinai School of Medicine
- 67. ERP Sequential Effects in a Cueing Paradigm**
Carlos M. Gómez, Angelica Flores, Marcia R. Digiacomo, & Manuel Vázquez-Marrufo
University of Sevilla
- 68. Late Endogenous ERPs Associated to Invalidly Cued Targets**
Carlos M. Gómez, Angelica Flores, Marcia R. Digiacomo, & Javier González-Rosa
University of Sevilla
- 69. Semantic Information is Retrieved Earlier than Phonological Information in Chinese Word Production: An ERP Study**
Taomei Guo, Danling Peng, Chunming Lu, & Hongyan Liu
Beijing Normal University
- 70. Neural Circuitry of Attentional Startle Modulation Deficits in the Schizophrenia Spectrum**
Erin A. Hazlett, Monte S. Buchsbaum, Kim E. Goldstein, Randall E. Newmark, Catherine F. Glanton, King-Wai Chu, M. Mehmet Haznedar, Antonia S. New, & Larry J. Siever
Mount Sinai School of Medicine
- 71. Differences in Autonomic Nervous System Activation Between Amusement and Joy/Happiness**
David Herring, Michael Devine, Amy Larson, Cristina Sable, Kari Guarriello, Megan Davidson, Sophia Froumis, Sharon Coleman, Nicole Roberts, & Mary H. Burleson
Arizona State University

- 72. Right Prefrontal Brain Activation for Intrinsic Alertness Measured with Functional Near Infrared Spectroscopy (FNIRS)**
Martin J. Herrmann, Eva Woidich, Theresa Schreppel, Paul Pauli, & Andreas J. Fallgatter
University of Würzburg
- 73. The Effect of Response Overlap and Stimulus Presentation Frequency on Event-Related Potentials in an Auditory Choice Reaction Time Task**
János Horváth, Urte Roeber, & Erich Schröger
University of Leipzig
- 74. Task Conflicts and Switch-Related Event-Related Potentials**
Shulan Hsieh¹ & Hanjung Liu²
¹National Chung Cheng University, ²Chung Cheng University
- 75. Feedback Negativity in Contingency Judgment**
Nobuyoshi Iwaki, Mika Ifuku, & Saika A-nan
Kyushu Women's University
- 76. Induced Oscillatory Activity During Retention in Visual Short-Term Memory**
Pierre Jolicoeur, Stéphan Grimault, Nicolas Robitaille, Jean-Marc Lina, Christophe Grova, & Anne-Sophie Dubarry
University of Montreal
- 77. Reference-Independent ERP Old/New Effects of Auditory and Visual Word Recognition Memory: Joint Extraction of Stimulus- and Response-Locked Neuronal Generator Patterns**
Jürgen Kayser, Craig E. Tenke, Nathan A. Gates, & Gerard E. Bruder
New York State Psychiatric Institute

- 78. Inversion Effect of Schematic Face on N170**
Koji Kazai¹, Kyota Konishi¹, Patrick J Bennett²,
Allison B Sekuler², Akihiro Yagi¹, Haruhiro
Katayose¹, & Masayoshi Nagai³
¹*Kwansei Gakuin University*, ²*McMaster
University*, ³*National Institute of Advanced
Industrial Science and Technology*
- 79. Cross-Modality Attentional Training Effects of
Musical Experience**
Victoria A. Kazmerski¹, Dawn G. Blasko¹,
Holly Blasko Drabik², Michael Hall³, A.
Walker¹, & Kristin McQueeney¹
¹*Penn State Erie, The Behrend College*, ²*University
of Central Florida*, ³*James Madison University*
- 80. Effect of Smoking Status on Cardiovascular
Reactivity in Young Adults**
John S. Kelly & Samantha Vickery
University of Chichester
- 81. Cardiovascular Reactivity and Beta-1-
Adrenergic Receptor Gene Variation in
Black Youth**
Robert M. Kelsey¹, Bruce S. Alpert¹, Shelley R.
Gabel¹, Jade A. Thompson¹, Rongling Li¹, Mary
K. Dahmer², & Michael W. Quasney²
¹*University of Tennessee Health Science Center*,
²*Medical College of Wisconsin*
- 82. Involvement of Memory-Based Change
Detection in Visual Distraction**
Motohiro Kimura¹, Jun'ichi Katayama², &
Harumitsu Murohashi²
¹*Nagoya University*, ²*Hokkaido University*

- 83. Impulsivity, Anxiety, and Individual Differences in Evoked and Induced Brain Oscillations**
Gennady G. Knyazev¹, Evgenij A. Levin², & Alexander N. Savostyanov²
¹*Siberian Branch of the Russian Academy of Medical Sciences*, ²*State Research Institute of Physiology, Siberian Branch of Russian Academy of Medical Sciences*
- 84. Decreased PE, But Not ERN, Amplitude Following Treatment of Children Diagnosed with an Anxiety Disorder: Preliminary Results**
Cecile D. Ladouceur, Ronald E. Dahl, Boris Birmaher, David A. Axelson, & Neal D. Ryan
University of Pittsburgh
- 85. Functional Brain Responses During Fear Conditioning are Correlated with the Extent of Dissociative Symptoms: A Risk Factor for Posttraumatic Stress Disorder?**
Simone Lang, Beate Herbert, Stephanie Ridder, Slawomira Lipinski, & Herta Flor
University of Heidelberg
- 86. Subjective and Physiological Responses in Defensive Individuals Under Conditions of Social Evaluative Stress**
Steven LaRowe, Angela Waldrop, Sudie Back, Aimee McRae, & Kathleen Brady
Medical University of South Carolina
- 87. EEG Coherence Effects of Intermittent Photic Stimulation in Neurologic Disorders in Children**
Vladimir V. Lazarev, Maria Alice Genofre, Adailton Pontes, & Leonardo C. deAzevedo
Oswaldo Cruz Foundation
- 88. Predicting Temperament from EEG Asymmetry in Infants**
Vanessa LoBue, James Coan, Judy S. DeLoache, & Catherine Thrasher
University of Virginia

- 89. Optical Measurement of Startle Eyeblinks During Functional Neuroimaging**
Christopher T. Lovelace, Elizabeth R. Duval, & Diane L. Filion
University of Missouri—Kansas City
- 90. Frequency Analysis of Narrative Imagery**
Andreas Löw, Lisa M. McTeague, Bethany C. Wangelin, Robert G. Sivinski, Margaret M. Bradley, & Peter J. Lang
University of Florida
- 91. The Role of Brain Regulatory Systems in Cortex Functional Organization and Information Processing Development in Primary School Children**
Regina Machinskaya & Olga Semenova
Institute of Development Physiology, RAO
- 92. Physiological Responses During Cart Pushing on Slippery and Non-Slippery Floors: A Psychophysical Study**
Rammohan V. Maikala, Patrick G. Dempsey, Vincent M. Ciriello, & Niall V. O'Brien
Liberty Mutual Research Institute for Safety
- 93. Developmental Change in Event-Related Time-Frequency Components**
Stephen M. Malone, Edward M. Bernat, & William G. Iacono
University of Minnesota
- 94. Cognitive and Autonomics Measures of Face Familiarity**
Frank M. Marchak, Tanner L. Keil, Pamela S. Westphal, & David M. Bechberger
Veridical Research and Design
- 95. Positive and Negative Audiences, Heart Rate Variability and Performance of a Motor Skill: A Preliminary Study**
Terry McMorris, Daniel Flooks, & John Kelly
University of Chichester

- 96. Pain Expectancy in Fibromyalgic Patients: An Event-Related Potential Study**
Francisco Mercado, Paloma Barjola, Lilian Velasco, José L González, & Cecilia Peñacoba
Universidad Rey Juan Carlos
- 97. Intensity-Dependence of the Auditory P2 in Monozygotic Twins Discordant for Vietnam Combat: Associations with PTSD**
Linda J. Metzger¹, Scott P. Orr¹, Stephen R. Paige², & Roger K. Pitman³
¹*VA Medical Center, Manchester*, ²(deceased),
³*Massachusetts General Hospital*
- 98. Mapping of MEG Slow Wave Activity in Alzheimer's Disease Using Distributed Source Models**
Stephan Moratti, Alberto Fernandez, Fernando Maestu, Pablo Campo, & Tomas Ortiz
University Complutense of Madrid
- 99. Do Musicians Have Superior Neural Processing for All Auditory Stimuli? P1 and MMN Responses to Music, Speech, and Pure Tones**
Dee A. Nikjeh, Jennifer J. Lister, & Victoria Gonzalez
University of South Florida
- 100. Effects of Stimulus Delay on Event-Related Potentials in the Mouse Click Paradigm**
Hiroshi Nittono
Hiroshima University
- 101. Event-Related Potentials to Auditory Stimulus Omissions During Visually Paced Trials**
Helge Nordby¹, Tom Eichele¹, Matthias Moosmann¹, & Walton T. Roth²
¹*University of Bergen*, ²*Stanford University, Veterans Affairs Health Care System*

102. The Labial Thermistor: Support for Discriminant Validity and Utility for Between-Subjects Designs

Nicole R. Prause

Indiana University—Bloomington

104. Psychophysiological Investigation of the Vigilance Decrement: Boredom Rather than Cognitive Fatigue

Nathalie Pattyn¹, Xavier Neyt², David Henderickx³, & Eric Soetens³

¹*Vrije Universiteit Brussel*, ²*Royal Military Academy-Brussels*, ³*Vrije Universteit Brussel*

105. Reactivity Revisited: Different Effects of Real-Life Stress and Mental Tasks on Cardio-Respiratory Parameters

Nathalie Pattyn¹, Pierre-Francois Migeotte², Xavier Neyt³, & Raymond Cluydts⁴

¹*Vrije Universiteit Brussel*, ²*Universite Libre de Bruxelles*, ³*Royal Military Academy, Brussels*, ⁴*Vrije Universteit Brussel*

106. ERP Correlates of Mental Arithmetic in Preadolescents: Influence of Ability and Effects of Morning Nutrition

R. T. Pivik

University of Arkansas for Medical Sciences

107. Infant Diet and the Development of Cardiovascular Reactivity During the First Year of Life

R. T. Pivik, H. Jing, J. M. Gilchrist, & T. M. Badger

University of Arkansas for Medical Sciences

**108. Unconscious Emotional Processing
in Alexithymia**

Olga Pollatos¹, Anna Schubö¹, Andrea Schankin², Beate Herbert², Ellen Matthias², & Rainer Schandry²

¹*Ludwig Maximilian University*, ²*University of Heidelberg*

109. Cardiovascular, Electrodermal, and Facial Skin Surface Temperature Components of the Startle Response

Dean A. Pollina¹, Colin A. Puri², Andrew B. Dollins¹, Stuart M. Senter¹, & Troy E. Brown¹

¹*Defense Academy for Credibility Assessment*,
²*University of Houston*

110. The Relationships Between Baroreceptor Cardiac Reflex Sensitivity and Cognitive Performance are Modulated by Tonic Blood Pressure Levels

Gustavo A. Reyes del Paso¹, José A. Hernández¹, María I. González¹, Stefan Duschek², & Nicolás Gutiérrez¹

¹*Universidad de Jaén*, ²*University of Munich*

111. Sex Differences in Affective Modulation of Pain and the Nociceptive Flexion Reflex

Jamie L. Rhudy & Amy E. Williams
University of Tulsa

112. Respiratory Rhythm of the Airway Smooth Muscle: An Index of Vagal Outflow to the Airways?

Thomas Ritz¹, Miriam Thoens², & Bernhard Dahme²

¹*Southern Methodist University*, ²*University of Hamburg*

113. Early Feature-Specific ERP-Effects of Visual Awareness Following Binocular Rivalry

Urte Roeber, Sandra Vesper, & Erich Schröger
University of Leipzig

- 114. Anticipatory Bradycardia in Tasks with Prolonged Stimulus Exposition**
Andrzej Rynkiewicz
Warsaw University
- 115. Abnormal P3 Topography in Relation to Impulsive Antisociality**
Nicolas J. Schliez, Rebecca J. Houston, & Jamie M. Ostrov
University at Buffalo, SUNY
- 116. Electrodermal Arousal and Reactivity During Sensation in Typically Developing Children**
Sarah A. Schoen, Barbara Brett-Green, Lucy J. Miller, & Marianne Reale
SPD Foundation
- 117. This Will Hurt Me as Much as it Will Hurt You: Cingulate Activation Associated with Observing Another's Mistakes Correlates with Self-Reported Empathy and Psychopathy**
Matthew S. Shane, Carla L. Harenski, & Kent A. Kiehl
The MIND Institute
- 118. Electrophysiological Evidence of Auditory Attentional Blink**
Dawei Shen, Claude Alain, & Yu He
Baycrest Centre for Geriatric Care
- 119. Do Females and Males Have Different Fear System? Processing Fear Messages Containing Physical Threat vs. Social Threat**
Mija Shin, Rebecca Van de Vord, & Yvonne Chen
Washington State University
- 120. Physical Threat vs. Social Threat: Effects of Anti-Drug PSAS on Viewers' Cognitive and Emotional Responses**
Mija Shin, Rebecca Van de Vord, & Yvonne Chen
Washington State University

- 121. Mood, Task Valence, and Difficulty Effects on Cardiovascular and Facial EMG Reactivity**
Nicolas Silvestrini & Guido H. E. Gendolla
University of Geneva
- 122. ERP Study of Response Conflict and Error Monitoring Deficits in Cocaine Abuse and in PTSD**
Tato Sokhadze, Allan Tasman, Shraddha Singh, Christopher Stewart, Anton Surja, & Michael Hollifield
University of Louisville
- 123. Mental Tasks and Cardiovascular Response Patterns**
Tytus Sosnowski, Andrzej Rynkiewicz, & Aleksandra Bala
Warsaw University
- 124. A Validation of the Post-Auricular Response as a Physiological Indicator of Appetitive Activation During Television Viewing**
Johnny V. Sparks
The University of Alabama
- 125. Sequential Picture Processing: An ERP-Analysis of Affective Primes and Targets**
Jessica Stockburger, Tobias Flaisch, Florian Bublatzky, Ralf Schmäzle, & Harald Schupp
University of Konstanz
- 126. Event-Related Potential (ERP) Responses to the Visuospatial Priming Task in Children**
Denis G. Sukhodolsky, Michael J. Crowley, James F. Leckman, Larry Scahill, & Linda C. Mayes
Yale School of Medicine
- 127. Autonomic Changes During the Perception of Emotional Facial Expressions**
Paola Surcinelli & Maurizio Codispoti
University of Bologna

128. The Effects of Neighborhood Density and Neighbor Frequency on Lexical Processing: An ERP Study

Vanessa Taler, Jennifer Trudeau-Malo, & Natalie A. Phillips
Concordia University

129. Novelty P3 Reductions in Depression: Characterization Using CSD-PCA

Craig E. Tenke, J. Kayser, Christopher J. Kroppmann, Nathan A. Gates, Jennifer D. Schaller, Jonathan W. Stewart, & Gerard E. Bruder
New York State Psychiatric Institute

130. Performance of Sternal Skin Conductance Measures of Hot Flashes: Variation by Race and Body Mass Index

Rebecca C. Thurston
University of Pittsburgh

131. Cortical Plasticity, College Experience, and the Transcendental Meditation Technique

Frederick Travis¹, Melissa Tanner², David Haaga², & Robert Schneider¹
¹*Maharishi University of Management*, ²*American University*

132. Fear Conditioned Avoidance in Breathing Behavior

Ilse Van Diest, Stien Fannes, Ann Meulders, Deb Vansteenwegen, & Omer Van den Bergh
University of Leuven

133. Does Combining Autonomic Measures Enhance Detection of Concealed Information?

Bruno Verschuere¹ & Matthias Gamer²
¹*Ghent University*, ²*Mainz University*

134. Effect of Alcoholism on Gamma-Band Phase Synchrony During Visual and Auditory Target Processing

Todd D. Watson, Suchitra Krishnan-Sarin, Stephanie S. O'Malley, Elsa Daurignac, Krystal H. John, & Daniel H. Mathalon

Yale School of Medicine

135. Alterations in P50 Response Asymmetry During a Stressor Task

Patricia M. White, Andrea M. Hopkins, Shannon L. Hopkins, & Bill T. Troyer

University of Oregon

136. ERP Indices of Error Processing in Adults With ADHD

Jan R. Wiersema¹, Jacob J. van der Meere², & Herbert Roeyers¹

¹*Ghent University*, ²*University of Groningen*

137. Affective Computing: Using Computational Intelligence Techniques to Classify the Psychophysiological Signatures of Fearful, Sad, and Calm Affective States

Frank H. Wilhelm¹, Vitaliy Kolodyazhniy¹, Sylvia D. Kreibig², Walton T. Roth³, & James J. Gross³

¹*University of Basel*, ²*University of Geneva*,

³*Stanford University*

INDEX

[NOTE: *s indicate possible spelling discrepancies.]

A

- Abdullaev, Yalchin 70
 Abraham, Preetha A. 107
 Abramson, Lyn Y. 33, 73
 Abreu, Ivette Cabrera... 105
 Adam, Andrea 61
 Adorni, Roberta 44
 Adrover, Margarita 67
 Agran, Jason 77
 Aihara, Yasutsugu 102
 Ajibishe, Elham Dianati.....
 70
 Akinola, Modupe N. 67
 Alain, Claude, 47 117
 Albert, Jacobo 32, 60
 Albrecht, Björn 71
 Alexopoulos, George S.
 42
 Alhadad, Sakinah 61
 Alho, Kimmo 47
 Alissa, Holland K. 90
 Allen, John J. B. 27, 32,
 33, 41, 58, 93
 Allen, Karen M. 104
 Alorda, Catalina 67
 Alpers, Georg W. 62
 Alpert, Bruce S. 111
 Alqasemi, Redwan 99
 Alvarez, Ruben 34, 73
 Amador, Alfredo Alvarez....
 67
 Amodio, David M. 53
 Amoss, Richard T. 88
 A-nan, Saika 110
 Anderson, Kimberly H.
 91
 Angrilli, Alessandro 59,
 67
 Anllo-Vento, Lourdes
 103
 Anokhin, Andrey P. 104
 Ansari, Tahereh L. 54
 Arai, Junichiro 102
 Arbel, Yael 99
 Archer, Holly 100
 Aronoff, Joel 32
 Arroyo, Guadalupe 77
 Ashare, Rebecca L. 91
 Asherson, Philip 71
 Aslaksen, Per 91
 Asli, Ole 80
 Astikainen, Piia 104
 Atwell, Anita 67
 Austin, Benjamin P. 76
 Aviyente, Selin 56
 Awiszus, Barbara 63, 87
 Axelson, David A. 26,
 112
 Aydarkina, Ekaterina 67

B

- Bachman, Peter 66
 Back, Sudie 112
 Backonja, Misha M. 73
 Badger, T. M. 115
 Baess, Pamela 91
 Báez-Martín, Margarita M.
 105
 Bähne, Christina G. 62
 Baijal, Shruti 67
 Bailey, Christopher A.
 106
 Bailey, Rachel 81
 Bala, Aleksandra 118
 Baldrige, Robyn M. 83
 Ballou, Sarah K. 60
 Banaschewski, Tobias 71
 Banerjee, Madhuja 104
 Bang, Janet Y. 66
 Banks, Lyndsey 92
 Barjola, Paloma 114
 Barnard, Kobus 96
 Barnow, Sven 93
 Barros, Eduardo M. 80
 Bartholow, Bruce D. 41,
 49, 64

- Bartley, Emily J. 85
 Bearden, Carrie E. 66
 Beauchaine, Ted P. 38
 Bechberger, David M.
 113
 Bechtereva, Nathalya P.
 107
 Becker, Judith V. 58
 Belcher, Thomas 90
 Bell, Martha Ann 105
 ben-Avraham, Daniel... 107
 Bendixen, Alexandra 47,
 74
 Benevides, Teal 101
 Bennett, Patrick J. 111
 Benning, Stephen D. 53
 Ben-Shakhar, Gershon... 28
 Berg, W. Keith 91
 Bernat, Edward M. 55,
 56, 73, 95, 113
 Berntson, Gary G. 38
 Bertenthal, Bennett I. 47
 Bertrand, Olivier 98
 Bezroukikh, Mariam... 100
 Bhaskara, Lavanya 90
 Bianchin, Marta 67
 Biernacki, Marcin 91
 Biggs, Arter 34, 73
 Birmaher, Boris 26, 112
 Bishnoi, Mahendra 91
 Bismark, Andrew 58
 Blanchard-Fields, Fredda ...
 61
 Blanco, Michelle J. 55,
 94
 Blasko, Dawn G. 111
 Blechert, Jens 38
 Blumenthal, Terry D.
 30, 52, 54, 55, 75, 94
 Bobadilla, Leonardo 93,
 104
 Bogdanov, Volodymyr... 81
 Boitsova, Yulia A. 107
 Bolls, Paul D. 81, 82,
 104
 Bontowski, Marina L. 85
 Borchardt, Amy R. 58
 Borelli, Jessica L. 106
 Borgelt, Jens 63, 87
 Bostanov, Vladimir 57
 Bovin, Michelle J. 78
 Bowers, Dawn 55, 94
 Bowker, Kelly Beth 54,
 55, 75
 Boyd, Megan 93
 Bradley, Margaret M.
 43, 56, 57, 60, 71, 98,
 99, 103, 113
 Brady, Kathleen 112
 Braff, David L. 94
 Brandeis, Daniel 71
 Braun, Elsie L. 83
 Brenner, Colleen A. 105
 Brett-Green, Barbara... 117
 Brewer, Lauren N. 92
 Briedenbach, Warren C.
 63
 Brinkmann, Kerstin 39
 Brosschot, Jos F. 64
 Brown, Sarah M. 26
 Brown, Troy E. 116
 Bruder, Gerard E. 110,
 119
 Brumback, Carrie R. 77
 Bublatzky, Florian 63,
 96, 118
 Buchsbaum, Monte S.
 109
 Buck, Sarah M. 84
 Buodo, Giulia 59
 Burleson, Mary H. 109
 Burrows, Christopher 90
 Butler, Emily A. 96
 Bykowski, Cathy A. 59
 Bylsma, Lauren M. 59
 Byrd, Dana L. 91
 Byrne, Nelson 107
- C**
- Cabeza, Roberto 45
 Cacioppo, John T. 35, 47
 Cadwallader, Meredith
 55, 56
 Cagy, Mauricio 79

- Camchong, Jazmin 76,
..... 77
- Campo, Pablo 114
- Campos-Bueno, Jose Javier
..... 67
- Cannon, Tyrone D. 66
- Capuana, Leslie 75, 76
- Cardinale, Rossella 105
- Carlson, Scott R. 103
- Carmona, Joseph E. 90
- Carp, Joshua 106
- Carpenter, Jenna G. 65
- Carpenter, Thomas L. 84
- Carretié, Luis ... 32, 60, 102
- Castelli, Darla M. 84
- Cavanagh, James 68, 93
- Cavanagh, Sarah R. 60
- Cessna, Trevor 92
- Chamberlin, Corrine 89
- Chambers, Andrea S. 58
- Chang, Wen-Pin 75
- Chapa, Carly J. 71
- Chavanon, Mira-Lynn ... 39
- Chen, Shanon 66
- Chen, Yvonne 117
- Cheng, Cho Kim 55
- Chopra, Kanwaljit 91
- Christensen, Jana C. 55
- Christie, Israel C. ... 48, 106
- Christmann, Christoph
..... 34
- Chu, King-Wai 109
- Ciriello, Vincent M. 113
- Clementz, Brett A. 76,
..... 77, 93
- Clift, April 59
- Cluydts, Raymond 115
- Coan, James A. 30, 33,
..... 35, 112
- Codispoti, Maurizio 56,
..... 92, 98, 105, 118
- Cohen, Lee M. 93
- Colby, Amanda 83
- Colcombe, Stan 77
- Coleman, Ian 69
- Coleman, Sharon 109
- Collin, Charles A. 96
- Compton, Rebecca J. ... 106
- Connolly, John F. 44
- Conzelmann, Annette ... 62
- Cooper, Lynn 28
- Corballis, Paul M. 42,
..... 61, 69, 95
- Coricelli, Giorgio 100
- Cornwell, Brian R. 34,
..... 73, 106
- Corral, Guadalupe 68,
..... 103
- Correll, Joshua 68
- Costa, Vincent D. 57
- Coulter, Heather M. 68
- Coutinho, Evandro F. S.
..... 80
- Cowman, Erika 98
- Cox, David E. 90
- Crites, Stephen L. 68,
..... 103
- Crowley, Michael J.
..... 106, 118
- Curtin, John J. 30, 78
- Cuthbert, Bruce N. 68,
..... 71, 107
- D**
- Dahl, Ronald E. 26,
..... 53, 112
- Dahme, Bernhard 90,
..... 116
- Dahmer, Mary K. 111
- Damjanovic, Sonja 92
- Danko, Sergey G. 107
- Dao, An T. 55, 56
- Daurignac, Elsa 120
- David, Isabel P. A. 79
- Davidson, Megan 109
- Davidson, Richard J. 32,
..... 33, 35, 73, 100, 102
- Davies, Patricia L. 75, 76
- Davis, Claude E. 80
- Davis, Michael 29
- Dearing, Eric 82
- deAzevedo, Leonardo C.
..... 112
- De Cesarei, Andrea 92,
..... 105

- Del Jesus, Maria Isabel
 Viedma..... 65
- Delgado, Luis Carlos 65,
 89
- DeLoache, Judy S. 112
- Demaree, Heath A. 97
- Dempsey, Jared P. 93
- Dempsey, Patrick G. 113
- Denney, H. Ted 65
- Dennis, Tracy A. 37
- de Paula, Isabel I. Antunes
 89
- De Peuter, Steven 60
- Derakshan, Nazanin 54,
 108
- Detloff, Allison 73
- de Ruiter, Michiel B. ... 107
- Deveney, Christen M. ... 85
- Devine, Michael 109
- Devyllder, Jordan E. 61,
 69
- Diamond, Lisa M. 35
- Dicks, Bethany A. 55
- Dicorcia, Jennifer A. 60
- Dien, Joseph 44, 72
- Digiacommo, Marcia R.
 109
- Dipoce, Matthew 76
- Ditto, Blaine 70, 107
- Dobkins, Karen R. 77
- Dohrmann, Katalin 86,
 96
- Dollins, Andrew B. 116
- Donchin, Emanuel 99
- Dowman, Robert 107
- Drabik, Holly Blasko ... 111
- Draper, Nick 69
- Drobes, David J. 83, 108
- Dubarry, Anne-Sophie
 110
- Dubey, Rajiv 99
- Duncan, Connie C. 107
- Dunning, Jonathan P.
 37, 55, 68
- Duschek, Stefan 116
- Duval, Elizabeth R. 78,
 113
- Dweck, Carol S. 41
- Dyckman, Kara A. 76
- Dywan, Jane 75, 76
- Dzafic, Alma 56
- ## E
- Eckart, Janet A. 53
- Eckler, Petya 104
- Edelstein, Eve 108
- Edgar, Christopher J. 73
- Eichele, Tom 114
- Elbert, Thomas 86, 96
- Elkins, Amanda N. 84
- Elliott, Lisa A. 88
- Ellis, Robert J. 64, 108
- Elmore, Wade R. 78
- Emerson, Ralph W. 92
- Ena, Anatoliy 81
- Engelmann, Jeffrey 107
- Engler, Harald 87
- Epton, Thomas W. 84
- Erb, Michael 86
- Erickson, Kirk I. 42
- Ernst, Monique 27
- Erthal, Fatima 79
- Esselink, Eddy 102
- Esteves, Francisco 108
- Ethridge, Lauren E. 76
- Eunsam, Shin 77
- Evans, A. Eden 98
- Evans, David E. 108
- Evans, Karen M. 82
- Evatt, Daniel P. 68, 92
- Everhart, Daniel E. 80
- ## F
- Fabiani, Monica 42,
 77, 78
- Fallgatter, Andreas J. 110
- Fannes, Stien 119
- Faria, Jr., Aydamari J. P.
 79
- Fazio, Russell H. 65
- Fearn, Meghan 33
- Federmeier, Kara D. 31,
 82, 83, 98
- Fedorchuk, Svitlana 81

- Felbaum, Daniel 89
 Fernandez, Alberto..... 114
 Fernandez, Hubert H..... 55
 Fernández-Santaella
 M^aCarmen 89
 Ferrara, Agnese 65
 Ferrari, Vera..... 56, 98
 Ferreira, Ana C. 108
 Ferrer, Emilio 35
 Figueira, Ivan..... 79, 80
 Fillion, Diane L. 78, 113
 Fischer, Nastassja L..... 80
 Fischler, Ira..... 92
 Fishel, Stephanie R. 84,
 92
 Fisher, Joscelyn E..... 73
 Fisher, Patrick M. 26
 Flaisch, Tobias 63,
 96, 118
 Flaten, Magne Arve..... 80,
 91
 Flooks, Daniel 113
 Flor, Herta..... 34, 71,
 80, 81, 112
 Flores, Angelica..... 109
 Forbes, Chad E. 41, 58
 Forbes, Erika E. 26
 Forth, Derek..... 69
 Foti, Dan 37, 55, 68
 Fox, Elaine..... 54, 108
 Fox, Julia R..... 108
 Frank, Michael J. 93
 Franklin, Joseph C..... 54,
 55, 75
 Frey, Monkia C. M..... 62
 Freyberger, Harald J..... 93
 Friederici, Angela D..... 83
 Friedman, Bruce H. 48,
 65, 89, 92
 Frishkoff, Gwen A. 44
 Froumis, Sophia..... 109
 Fryer, Simon..... 69
 Fujioka, Yuki 67
 Fuller, Rebecca L. 83
 Furman, Senta 71
 Furtado-Martins, Eduardo
 78
- G**
- Gabbay, Frances H. 107
 Gabel, Shelley R..... 111
 Gable, Philip A. 92
 Gamer, Matthias 119
 Gangloff, Brian 91
 Ganis, Giorgio 29
 Gao, Ya..... 108
 Gao, Yuan..... 93
 Gates, Nathan A. 110,
 119
 Gavin, William J..... 75, 76
 Gendolla, Guido H. E.....
 39, 64, 99, 118
 Genofre, Maria Alice.... 112
 George, Douglas C..... 84
 Gerdes, Antje B. M. 62
 Gerding, Alan L. 80
 Geske, Joel C. 108
 Ghisi, Marta..... 96
 Ghosh, Shuvo 70
 Giada, Franco 59
 Gianaros, Peter J. 101
 Giesbrecht, Timo..... 109
 Giessmann, Thomas 52
 Gilchrist, J. M..... 115
 Gillath, Omri..... 35
 Glanton, Catherine F.....
 109
 Gold, James M..... 83
 Goldman, Daniel J..... 68,
 107
 Goldstein, Kim E. 109
 Golkar, Armita..... 95
 Golosheykin, Simon.... 104
 Gómez, Carlos M..... 109
 González, José L..... 114
 González, María I. 116
 Gonzalez, Victoria..... 114
 González-Rosa, Javier.....
 109
 Good, Catherine D. 41
 Goodie, Adam..... 77
 Gordon, Brian A. 77
 Gorgo, Yuriy 81
 Gorlov, Dmytro 81
 Gratton, Caterina..... 82

- Gratton, Gabriele 42,
..... 77, 78
- Green, Michael F..... 66
- Greenstein, Justin E..... 68,
..... 92
- Greischar, Larry L..... 33,
..... 100
- Griffith, Barron M..... 69
- Grillon, Christian 34,
..... 73, 106
- Grim, Rodney D. 69
- Grimault, Stéphan 110
- Grodd, Wolfgang 86
- Gross, James J..... 41, 48,
..... 96, 120
- Grossman, Paul 38
- Grova, Christophe 110
- Gründler, Theo O. J..... 93
- Grüsser, Sabine M. 71
- Guarriello, Kari 109
- Guerra, Pedro 60, 65, 79
- Gugushvili, Manana L.
..... 94
- Gunnar, Megan R. 53
- Gunning-Dixon, Faith... 42
- Guo, Taomei 109
- Gutiérrez, Nicolás..... 116
- Gyurak, Anett..... 54
- H**
- Haack, Lauren M. 84
- Haaga, David..... 119
- Hackley, Steve S. 89
- Hackley, Steven A..... 30,
..... 86
- Haghparast, Abbas..... 70
- Hahn, Melanie 94
- Hajcak, Greg 37, 55, 68
- Halenar, Michael 106
- Hall, Jason R. 55
- Hall, Julie L. 46, 69
- Hall, Michael..... 111
- Hämäläinen, Heikki 47
- Hamamoto, Yuki..... 57
- Hamlin, Ashley S..... 87
- Hamm, Alfons O..... 43,
..... 53, 93
- Hammel, Kristen 66
- Handelman, Mika..... 71
- Harden, Emily 71
- Harenski, Carla L. 117
- Hariri, Ahmad R... 26, 101
- Harmon-Jones, Eddie
..... 33, 56, 87, 92
- Harrison, David..... 90
- Hartmann, Thomas . 86, 96
- Hauswald, Anne 86
- Hautzinger, Martin..... 57
- Hawk, Jr., Larry W..... 91
- Hazan, Cindy 35
- Hazlett, Erin A..... 109
- Haznedar, M. Mehmet
..... 109
- He, Sheng 56
- He, Yu 117
- Heaton, Rachel 104
- Heffner, Kathi L. 58
- Heilman, Keri..... 71
- Heim, Sabine 57
- Heller, Wendy 30, 73
- Helt, Molly 41
- Hempel, Roelie J..... 69, 80
- Henderickx, David 115
- Henderson, Heather A.....
..... 37
- Hengeveld, Michael W.
..... 69, 80
- Herbert, Beate 112, 116
- Herbert, Cornelia 63
- Hermann, Christiane 95,
..... 99
- Hernández, José A. 116
- Herring, David 109
- Herrmann, Martin J. ... 110
- Hetrick, William P. 105
- Hicks, Angela..... 35
- Hilimire, Matthew R.
..... 61, 69, 95
- Hillman, Charles H. 84,
..... 85
- Hilton, John 28
- Hinojosa, José A. ... 32, 102
- Hira, Shinji..... 57
- Hobson, Valerie L..... 93

- Hodgson, Christopher I. 69
 Hofer, Beate..... 63
 Holcomb, Phillip J..... 30
 Holley, Sarah R..... 54
 Hollifield, Michael..... 118
 Hoover, Adam W. ... 84, 92
 Hopkins, Andrea M..... 93,
 120
 Hopkins, Shannon L..... 93,
 120
 Hoptman, Matthew J. ... 42
 Horváth, János..... 110
 Houston, Rebecca J. 117
 Hsieh, Shulan 110
 Huang, Yu-Xia..... 100
 Hugdahl, Kenneth 47
 Hunker, Ryan 89

I

- Iacono, William G. 76,
 84, 103, 113
 Ifuku, Mika 110
 Ihssen, Niklas 57
 Imbiriba, Lu's Aureliano
 78
 Inoue, Yusuke 102
 Inzlicht, Michael..... 41, 42
 Isato, Furumitsu 57
 Itagaki, Shun 93
 Ito, Tiffany A..... 68
 Iwaki, Nobuyoshi 110

J

- Jackson, Colleen 77, 78
 Jackson, Cory A. B..... 82,
 100
 Jackson, Daren C..... 82,
 100
 Jacob, Christian 62
 Jacobs, Emily C. 41
 Jacobsen, Thomas 73,
 91, 94
 Jaeger, Megan 93
 Jagusztyn, Nicole E..... 59
 James, Lisa M. 93, 104

- Jander, Miriam 101
 Jansma, Bernadette M.... 31
 Jennings, J. Richard 106
 Jiang, Yi 56
 Jing, H. 115
 Joffily, Mateus..... 79, 100
 John, Krystal H..... 120
 Johnson, Kareem J. 73
 Johnson, Linda L. 106
 Johnson, Wendy 84
 Johnston, John..... 108
 Johnstone, Tom 73
 Joksimovic, Ljiljana..... 34
 Jolicoeur, Pierre 110
 Jones, Glenys A..... 69
 Jost, David L..... 82
 Joye, Isabelle Ancel..... 39
 Junghöfer, Markus 63

K

- Kang, Sonia..... 42
 Kanniess, Frank 90
 Kanwisher, Nancy..... 40
 Kaplan, Daniel M. 61
 Kappas, Arvid 70
 Kappenman, Emily S. ... 52,
 83
 Karl, Anke..... 34
 Karlsdottir, Mardis..... 59
 Kassel, Jon D. 68, 83, 92
 Katayama, Jun'ichi..... 72,
 74, 93, 111
 Katayose, Haruhiro 111
 Kaufman, David A. S. ... 55,
 94
 Kayser, Jürgen..... 110, 119
 Kazai, Koji 111
 Kazmerski, Victoria A.
 111
 Keane, Kevin..... 107
 Kearney, Emma 88
 Kearney, Will..... 88
 Keifer Jr., Orion P. 42,
 61
 Keil, Andreas..... 57, 99
 Keil, Tanner L. 113
 Kelley, Loran..... 58

- Kelley, William M. 27
 Kelly, Bridget J. 102
 Kelly, John S. 111, 113
 Kelsey, Robert M. 111
 Kemeny, Margaret E. 68
 Kemper, Christoph 39
 Kensinger, Elizabeth A.
 27
 Kessel, Dominique 60
 Keune, Kristen M. 78
 Key, Sasha 63
 Khachidze, Irma O. 94
 Khetrapal, Neha 67
 Kiang, Michael 94
 Kiehl, Kent A. 117
 Kilmer, Ashley 65, 88
 Kimura, Motohiro 111
 King, Arlene R. 88
 King, Joseph S. 69
 King, Thomas S. 59
 Kirmse, Ursula 94
 Kirsch, Laura G. 58
 Kirschbaum, Clemens 34
 Kissler, Johanna 63,
 70, 86
 Klein, Daniel N. 55
 Kluender, Robert 31
 Knepp, Michael M. 65,
 89
 Knowles, Tristan A. 90
 Knyazev, Gennady G.
 112
 Kolodyazhniy, Vitaliy ... 38,
 120
 Koloen, Glory 108
 Konishi, Kyota 111
 Kononova, Anastasia ... 104
 Koruth, Jacob 82
 Koslov, Katrina R. 83
 Kössler, Susanne 70
 Kosslyn, Stephen M. 29
 Kotani, Yasunori 102
 Kotchoubey, Boris 57,
 101
 Kovacs, Marika 33
 Koval, Kristen 89
 Kramer, Alexis 71
 Kramer, Art F. 77
 Kreibig, Sylvia D. 48,
 64, 120
 Krishnan, Giri 105
 Krishnan-Sarin, Suchitra
 120
 Kroger, James K. 71, 81,
 87, 100
 Kroll, Alexander 95, 99
 Krompinger, Jason W. ... 64
 Kroppmann, Christopher J.
 119
 Krusemark, Elizabeth 77
 Kuenzel, Johanna 102
 Kuester, Dennis 70
 Kulkarni, Shrinivas 91
 Kullowatz, Antje 90
 Kuntsi, Jonna 71
 Kurita, Satoko 82
 Kutas, Marta 30, 94
- L**
- Ladouceur, Cecile D. ... 112
 Lages, Ana C. 79
 Lang, Annie 70, 82, 104
 Lang, Peter J. 43, 56,
 57, 60, 71, 99,
 103, 113
 Lang, Simone 34, 80,
 81, 112
 Langleben, Daniel 29
 Langlois, Eric M. 106
 Langner, Robert 86
 Lapate, Regina C. 100
 Laplante, Marie-Claude
 71
 LaRowe, Steven 112
 Larson, Amy 109
 Larson, Christine L. 31,
 32
 Larson, Michael J. 55, 94
 Laszlo, Sarah 31, 82
 Lattimore, Carl P. 86
 Lazarev, Vladimir V. 112
 Leckman, James F. 118
 Lee, Chia-lin 82
 Lee, Eun-Young 86

- Lee, Sungkyong 70,
..... 82, 104
- Lee, Yukyung..... 77
- Leobow, Jocelyn 71
- Lesch, Klaus-Peter.... 34, 62
- Leshner, Glenn 81
- Leskin, Lorraine P..... 70
- Leue, Anja..... 39
- Levenson, Robert W. 53,
..... 54, 63, 95
- Levin, Adriane 106
- Levin, Evgenij A. 112
- Levin, Rebecca L..... 73
- Lewkowski, Maxim..... 70
- Leynes, P. Andrew 96
- Li, Rongling..... 111
- Light, Gregory A..... 94
- Likowski, Katja 62
- Lillstrang, Elina..... 104
- Lim, Kelvin O. 42
- Limberg, Anke 93
- Lin, Johnny..... 97
- Lina, Jean-Marc 110
- Lion, René 102
- Liotti, Mario 97
- Lipinski, Slawomira 34,
..... 80, 81, 112
- Lipp, Ottmar V. 61, 71
- Lissek, Shmuel 34, 73
- Lister, Jennifer J..... 114
- Littau, Jeremy 104
- Liu, Hanjung 110
- Liu, Hongyan 109
- Liu, Lei 106
- Lleras, Alejandro 77
- LoBue, Vanessa..... 112
- Longo, Matthew R..... 47
- Lonsdorf, Tina B. 52
- López, Raël..... 103
- López-Martín, Sara 32,
..... 60
- Lovelace, Christopher T.
..... 113
- Löw, Andreas 56, 113
- Low, Kathy A..... 77, 78
- Lowe, Karsten L..... 84
- Lu, Chunming..... 109
- Luchetti, Martina..... 92
- Lucia, Lisa C..... 89
- Luck, Steven J.... 21, 52, 83
- Lundgren, Jennifer D..... 78
- Luo, Yuejia..... 83, 87, 100
- Lust, Sara A..... 64
- Lynn, Spencer K. 101
- M**
- Maack, Danielle J..... 100
- Machado-Pinheiro, Walter
..... 79
- Machinskaya, Regina ... 113
- Macizo, Pedro 31
- Maclin, Ed L..... 77
- Madalosso, Michela 59
- Maercker, Andreas 34
- Maess, Burkhard 83
- Maestu, Fernando 114
- Magai, Carol 88
- Magnussen, Helgo 90
- Mai, Xiaoqin..... 87
- Maikala, Rammohan V.....
..... 113
- Mallan, Kimberley M..... 71
- Maloletnev, Viktor I. 94
- Malone, Stephen M. 76,
..... 84, 113
- Mangels, Jennifer A..... 28,
..... 41
- Maniscalco, Brian 41
- Marchak, Frank M..... 113
- Margraf, Jürgen..... 38
- Martin, Frances..... 61
- Martin, Samantha L..... 26
- Marx, Brian P. 78
- Masaki, Hiroaki 101
- Mata, Jose Luis 65, 103
- Mathalon, Daniel H. ... 120
- Mathewson, Karen J. 75
- Mathis, Kristopher I..... 66
- Matthews, Karen A. 101
- Matthias, Ellen..... 116
- Maxfield, Nathan..... 108
- Mayes, Linda C..... 106,
..... 118
- McAuley, Edward 77

- McCabe, Klanci M. 85,
..... 86
- McCarley, Robert W.
..... 101
- McCarthy, Megan E. 54
- McClure, Erin B. 26, 27
- McCool, Martha F. 71
- McDowell, Jennifer E.
..... 76, 77
- McLoughlin, Gráinne 71
- McMenamin, Brenton W.
..... 33
- McMorris, Terry 69, 113
- McQueeney, Kristin 111
- McRae, Aimee 112
- McTeague, Lisa M. 56,
..... 71, 113
- Medvedev, Svyatoslav V. ...
..... 47, 107
- Meijer, Ewout H. 28
- Meldahl, Michael L. 55
- Melzig, Christiane A. 52
- Mendes, Wendy B. 67,
..... 83
- Mendlowicz, Mauro V.
..... 80
- Mendonza-de-Souza, Ana
C. F. 80
- Mendoza, Saaid A. 53
- Mercado, Francisco 114
- Merckelbach, Harald L. G.
J. 28, 108
- Mermelstein, Robin 92
- Metzger, Linda J. 114
- Meulders, Ann 119
- Meuret, Alicia E. 90
- Meyer, Aaron M. 98
- Miccoli, Laura 103
- Miceli, Diana 107
- Michael, Tanja 38
- Michalowski, Jarek M. 52
- Mienaltowski, Andrew ... 61
- Migeotte, Pierre-Francois
..... 115
- Mikkelsen, Eli J. 71, 81
- Miller, Bruce L. 53
- Miller, Gregory A. 73
- Miller, Lucy J. 117
- Miller, Paige 93
- Moberg, Christine A. 78
- Mocaiber, Izabela 79
- Mojica, Andrew J. 68,
..... 103
- Molfese, Dennis L. 44,
..... 63, 72
- Moll, Jorge 79
- Moltó, Javier 103
- Moncrieft, Ashley ... 65, 67
- Montañés, Susana 103
- Montmarquette, Claude ...
..... 100
- Montoya, Pedro 67
- Moore, Megan E. 65
- Moosmann, Matthias.
..... 114
- Morales-Chacón, Lilia M.
..... 105
- Moratti, Stephan 114
- Morimoto, Fumihito 65
- Mörsen, Chantel P. 71
- Moser, Jason 64, 72
- Moss, Jason D. 84
- Mucha, Ronald F. 62
- Mühlberger, Andreas 62
- Muldoon, Matthew F.
..... 106
- Müller, Matthias 74
- Munafò, Marianna 59
- Munro, Gillian E. S. 75
- Muñoz, Miguel A. 89,
..... 103
- Murata, Asuka 72
- Murohashi, Harumitsu
..... 111
- Murphy, Christopher F. ...
..... 42
- Murphy, Mary C. 41
- Muth, Eric R. 84, 92
- Myers, Justin 104
- N**
- Nadorff, Gayle 70,
..... 82, 104
- Nagai, Masayoshi 111

- Nascimento, Billy E. M. 79
- Nawa, Norberto E. 27
- Nees, Frauke 94
- Nelson, Cowan 86
- Nelson, Eric E. 27
- Nelson, Lindsay D. 95
- Neufeld, Samantha L. 63
- New, Antonia S. 109
- Newman, Randy L. 44
- Newmark, Randall E. 109
- Neyt, Xavier 115
- Nikjeh, Dee A. 114
- Nittono, Hiroshi 114
- Nolan, Jerry 89
- Nordby, Helge 114
- Norris, Catherine J. 47, 100
- Norte, Carlos E. 79
- Nuechterlein, Keith H. 66
- Nusslock, Robin 32, 33, 73
- O**
- O'Brien, Niall V. 113
- O'Donnell, Brian F. 105
- Ofer, Julia 95, 99
- Ogawa, Keiko 101
- Oh, Jennifer M. 100
- O'Hare, Aminda J. 44, 72, 100
- Ohgami, Yoshimi 102
- Ohira, Hideki 72
- Öhman, Arne 52, 53, 95
- Okun, Michael S. 55
- Oliveira, Laura A. S. 78
- Oliveira, Letícia 79, 80
- O'Malley, Stephanie S. 120
- O'Rourke, Polly 31
- Orr, Scott P. 114
- Ortiz, Tomas 114
- Ostrov, Jamie M. 117
- Osugi, Akemi 72
- Osumi, Takahiro 72
- Otter-Henderson, Kimberly 35
- Ovchinnikov, Kirill 72
- Owren, Michael J. 88
- P**
- Paige, Stephen R. 114
- Pajtas, Petra 98
- Paller, Ken A. 28
- Palomba, Daniela 59, 96
- Pappens, Meike 60
- Pardikes, Thomas J. 92
- Parks, Nathan A. 61, 95
- Parrish, Jessica M. 27
- Pastor, M. Carmen 103
- Patrick, Christopher J. 55, 56, 68, 73, 95
- Patriquin, Michelle A. 89
- Pattyn, Nathalie 115
- Pauli, Paul 62, 110
- Peira, Nathalie 95
- Pelham, Jr., William E. 91
- Pellot, Brian 104
- Peña, Paloma 65
- Peñacoba, Cecilia 114
- Peng, Danling 109
- Penolazzi, Barbara 59
- Perakakis, Pandelis 65, 79
- Perea, Elaine F. 95
- Pereira, Mirtes G. 79
- Perlman, Greg 84
- Perlstein, William M. 55, 94
- Pessoa, Luiz 79
- Petersen, Sibylle 90
- Peterson, Carly K. 56, 87
- Peterson, Mary A. 27
- Pfaltz, Monique C. 38
- Philipp, Michael C. 65, 88
- Philippsen, Christine 57, 58
- Phillips, Natalie A. 62, 119
- Pierce, Thomas W. 69

- Pine, Daniel S..... 27
 Pitman, Roger K..... 114
 Pivik, R. T..... 115
 Pizzagalli, Diego A..... 98
 Player, Jarryd..... 92
 Pohnitzsch, Katja..... 34
 Poli, Silvia..... 59
 Polich, John..... 84
 Pollatos, Olga..... 116
 Pollina, Dean A. 116
 Pontes, Adailton 112
 Pontifex, Matthew B.... 84,
 85
 Pontoski, Kristin E. 78
 Poon, Leonard..... 93
 Popek, Varinia..... 52
 Popov, Tzvetan..... 63, 87
 Porges, Stephen W. 71
 Port, Johannes 57
 Potanina, Polina V..... 53
 Potter, Robert F..... 82
 Poy, Rosario 103
 Pozo, Miguel A. 102
 Pratt, Nikki L. 63, 72
 Prause, Nicole R. 115
 Price, Julie C. 106
 Proverbio, Alice M..... 44,
 102
 Puri, Colin A. 116
 Purkis, Helena M. 61
- Q**
- Quandt, Lorna C..... 106
 Quasney, Michael W.....
 111
 Quevedo, Karina M..... 53
- R**
- Rabe, Sirko 34
 Rabin, Stephanie 34, 73
 Raudenbush, Bryan 89,
 92
 Reale, Marianne..... 117
 Reeves, Mark D. 93, 104
 Reuter-Lorenz, Patricia A.
 46, 69
 Reyes, Ana Agustina
 Calzada..... 67
 Reyes-del-Paso, Gustavo
 108, 116
 Rhudy, Jamie L..... 85,
 86, 116
 Richards, Jerry B..... 91
 Richter, Michael 99
 Richter, Steffen 57, 94
 Ridder, Stephanie 34,
 80, 81, 112
 Rietschel, Marcella..... 80
 Rinne, Teemu..... 47
 Ritz, Thomas ... 38, 90, 116
 Rix, Carrie 108
 Roberts, Nicole 109
 Robinson, Benjamin 83
 Robinson, Matthew J.....
 106
 Robitaille, Nicolas..... 110
 Rochette, Lynn M..... 58
 Rockstroh, Brigitte..... 63,
 87
 Röder, Christian H. 69,
 80
 Rodrigues, Erika C. 78
 Rodriguez, Sonia S..... 89,
 103
 Roeber, Urte 47,
 110, 116
 Roemer, Sonja 76
 Roesch, Linda L. 83, 92
 Roeyers, Herbert..... 120
 Rohleder, Nicolas 34
 Rolke, Bettina 86
 Rosenfeld, Peter 28, 29
 Rossi, Cesare..... 59
 Rossi, Valentina 102
 Roth, Michelle 107
 Roth, Walton T. 48,
 114, 120
 Rottenberg, Jonathan..... 59
 Roye, Anja 73
 Rue, Alysia R. 63
 Ruiz-Padial, Elisabeth ... 64,
 108
 Russell, Jennifer L..... 85
 Ruusuvirta, Timo 104

- Ryan, Neal D.....26, 112
 Rykhlevskaia, Elena I.77
 Rynkiewicz, Andrzej ... 117,
 118
- S**
- Sabatinelli, Dean..... 57, 99
 Sable, Cristina..... 109
 Sadeh, Naomi65, 73, 88
 Sahin, Volkan 108
 Salisbury, Dean F.....78,
 101
 Salomon, Kristen 59
 Salomons, Tim V.....73
 Salonen, Johanna 47
 Sanders-Jackson, Ashley.....
 108
 Sandt, Arthur R. 73
 Santesso, Diane L. 98
 Sarlo, Michela..... 59, 96
 Sass, Sarah M..... 73
 Saupe, Katja..... 74
 Savage, Cary R..... 44
 Savostyanov, Alexander N.
 112
 Sawaki, Risa..... 74
 Sbarra, David A. 35
 Scahill, Larry..... 118
 Scarpa, Angela 89
 Schaaf, Roseann C. 101
 Schächinger, Hartmut... 57,
 58, 76, 94
 Schaefer, Hillary S. 32,
 35
 Schaer, Thomas 53
 Schaller, Jennifer D..... 119
 Schalling, Martin 52
 Schandry, Ranier 116
 Schankin, Andrea..... 86,
 116
 Schedlowski, Manfred.... 87
 Schendan, Haline E. 27,
 89
 Schepers, Monica..... 64
 Scherer, Klaus R..... 64
 Schlee, Winfried 86, 96
 Schlien, Nicolas J. 117
 Schmader, Toni41, 58
 Schmäzle, Ralf.....63,
96, 118
 Schmitt, Justin89
 Schneider, Nils J. 77
 Schneider, Robert 119
 Schoen, Sarah A. 117
 Schreppel, Theresa 110
 Schröger, Erich47,
73, 74, 91, 94,
 110, 116
 Schubö, Anna 116
 Schultheiss, Oliver C....46,
69
 Schultz, S. C. 26
 Schulz, Andre..... 58
 Schumann, Gunter 80
 Schupp, Harald T. 52,
63, 96, 118
 Schwab, Nicholas G.....82,
100
 Scisco, Jenna L. 96
 Scott, Siri A..... 55
 Scott, Walter D..... 82
 Scozzari, Simona 96
 Sculthorpe, Lauren D.... 96
 Segalowitz, Sidney J.75,
76
 Segarra, Pilar 103
 Seger, Catherine P..... 90
 Sekuler, Allison B..... 111
 Semenova, Olga 113
 Senter, Stuart M..... 116
 Service, Elisabet 44
 Shackman, Alexander J.
33, 102
 Shane, Matthew S. 117
 Shannon, Robert W..... 56
 Sharma, Ritu..... 65
 Shekhar, Anantha..... 105
 Shemyakina, Nathalya V.
 107
 Shen, Dawei..... 117
 Shen, Junxian..... 87
 Sheng, Qizheng..... 102
 Sheu, Lei K. 101
 Shiels, Keri..... 91
 Shin, Eunsam..... 77

- Shin, Lisa M. 60
 Shin, Mija..... 117
 Shiota, Michelle N..... 63,
 95
 Shoker, Leor 54, 108
 Sholty, Gretchen L. 66
 Shook, Natalie 65
 Shucard, David W. 87
 Shucard, Janet L. 87
 Shumen, Joshua R. 71
 Siegmund, Werner..... 52
 Siever, Larry J. 109
 Sigelman, Jonathan D.... 33
 Silvestrini, Nicolas 118
 Simeon, Daphne..... 109
 Simons, Robert F..... 49,
 64, 72
 Singh, Shraddha 118
 Sitges, Carolina..... 67
 Sivinski, Robert G. 56,
 57, 113
 Sklar, Alfredo..... 106
 Skowronek, Markus..... 80
 Slagter, Heleen A. 102
 Sloan, Denise M. 73, 78
 Slocombe, Emily A. 89
 Smith, Hans-Juergen 90
 Smith, J. Carson 99
 Smulders, Fren Ty 28
 Snyder, Peter J..... 75
 Soetens, Eric 115
 Sokhadze, Tato 118
 Soldan, Anja 28
 Sollers, III, John J. 64,
 65, 108
 Solovjeva, Maria L. 107
 Somerville, Leah H. 27
 Sommer, Werner 101
 Sosnowski, Tytus 118
 Souza, Gabriela G. L.,... 80,
 103
 Sparks, Johnny V..... 118
 Spencer, Sarah V..... 91
 Spironelli, Chiara..... 59
 Sprester, Carrie D..... 78
 Spriggs, Ekaterina 96
 Spring, Doerte K. 71,
 81, 87, 100
 Sramko, Valery 97
 Srinivasan, Narayanan ... 67
 Stanford, Matthew S..... 83
 Stanton, Steven J. 46, 69
 Starr, Mark J..... 97
 Steele, Claude M..... 41
 Stegagno, Luciano..... 96
 Stemmler, Gerhard 39,
 48
 Stender, Jan P. 52
 Stephens, Chad L.... 48, 92
 Stern, Antonee R. 107
 Stern, Yaakov 28
 Stewart, Christopher 118
 Stewart, Jennifer L. 73
 Stewart, Jonathan W.... 119
 Stieben, Jim 37
 Stockburger, Jessica..... 63,
 96, 118
 Stone, Breannan 100
 Strobel, Alexander..... 34
 Sturm, Virginia E. 53
 Subotnik, Kenneth L. 66
 Sukhodolsky, Denis G.
 118
 Sullivan, Kerry 41
 Sun, Jane C..... 66
 Surcinelli, Paola 118
 Surico, Nicole M. 84
 Surja, Anton 118
 Sze, Jocelyn A. 54
- T**
- Tabatabaei, Mir Ali Khatigi
 70
 Takasawa, Noriyoshi.... 101
 Takio, Fiia 47
 Taler, Vanessa 119
 Tanner, Melissa 119
 Tapia, Manuel 60
 Tarnowski, Adam 91
 Tasman, Allan..... 118
 Taylor, Grantley W. 78
 Taylor, Jeanette..... 93,
 103, 104
 Taylor, Jennifer H. 68,
 103

- Taylor, Shelley E..... 66
 Tays, William J..... 75, 76
 Tekok-Kilic, Ayda..... 87
 Tenke, Craig E. ... 110, 119
 Terry, Rolan 86
 Thayer, Julian F..... 48,
 64, 65, 108
 Themanson, Jason R..... 84,
 85
 Thoens, Miriam..... 90, 116
 Thomas, Kathleen M. 26
 Thompson, Jade A..... 111
 Thompson, Kelli M. 84
 Thorne, Brandon W. 55
 Thrasher, Catherine..... 112
 Thurston, Rebecca C.
 119
 Tiffin, Laura E. 89
 Ting, Kin-Hung 100
 Ting, Tao Yin 61
 Torpey, Dana C..... 55
 Towers, David N. 33
 Travis, Frederick..... 119
 Troyer, Bill T..... 93, 120
 Trudeau-Malo, Jennifer
 119
 True, Maren M..... 63
 Trujillo, Logan T. 27
 Trujillo-Barreto, Nelson J.
 47
 Tse, Chun-Yu 77
 Tsukamoto, Tetsuji..... 102
 Tucker, Don 30
 Tulen, Joke H. M. ... 69, 80
 Turner, Benjamin O. 64
 Turonie, Lee 33
- U**
- Ulrich, Rolf..... 86
 Urosevic, Snezana 33
 Urry, Heather L. 60, 61
- V**
- Vaidyanathan, Uma 56
 Valcárcel, María A. 102
 Valentini, Teresa A. 84
 Valle-Inclan, Fernando.....
 86
 Van Beveren, Nico J. M.
 69,, 80
 van Boxtel, Geert 97
 van de Laar, Marijke 97
 Van Den Bergh, Omer.....
 60, 119
 van den Wildenberg, Wery
 97
 van der Meere, Jacob J.
 120
 van der Molen, Maurits
 97
 Van de Vord, Rebecca.. 117
 Van Diest, Ilse 60, 119
 Vanman, Eric J. 65,
 67, 88
 Van Petten, Cyma..... 31
 vanReekum, Carien M.....
 100
 van Steenis, Hugo G. 80
 Vansteenwegen, Deb..... 60,
 119
 Vargas, Cláudia D..... 78
 Vázquez-Marrufo, Manuel
 109
 Veilleux, Jennifer C..... 83,
 92
 Velasco, Lilian..... 114
 Venables, Noah C. ... 55, 56
 Verkuil, Bart 64
 Verona, Edelyn 30,
 65, 73, 88
 Versace, Francesco ... 57, 99
 Verschuere, Bruno 28,
 119
 Vesper, Sandra 116
 Vickery, Samantha 111
 Vila, Jaime J. 43, 65,
 79, 80, 89, 103
 Villeva, Marie-Claire... 100
 Vizueta, Nathalie 26,
 55, 56
 Vogel, Edward K..... 86
 Volchan, Eliane..... 43,
 78, 79, 80
 Volokhov, Rachel N..... 97

- Voss, Joel L. 28
 Vythiingam, Meena 34
- W**
- Wacker, Jan 48
 Waldrop, Angela 112
 Walker, A. 111
 Walker, Alexander D. 84
 Wan, Xiaoang I. 77
 Wang, Jun 77
 Wang, Naiyi 83
 Wangelin, Bethany C.
 56, 113
 Wardle, Margaret C. 83
 Wardle, Megin C. 92
 Watson, Todd D. 120
 Waugh, Christian E. 46,
 69
 Waxmonsky, James G. 91
 Weber, Katja 63, 87
 Weber, Stefan 90
 Weike, Almut I. 52, 53
 Weisz, Nathan ... 86, 96, 98
 Wells, Anthony O. 89
 Wessa, Michèle 34,
 81, 81
 Westphal, Pamela S. 113
 Weyers, Peter 62
 Weymar, Mathias 52
 Whalen, Paul S. 27
 White, Kristi E. 59
 White, Patricia M. 70,
 93, 120
 Widmann, Andreas 74
 Wiens, Stefan 32, 95
 Wiersema, Jan R. 120
 Wieser, Matthias J. 62
 Wig, Gagan S. 27
 Wilhelm, Frank H. 30,
 38, 48, 96, 120
 Wilke, Adam 107
 Williams, Amy E. 85,
 86, 116
 Williams, Asia 67
 Williams, Terrance J. 66
 Wilson, Brian 108
 Wilson, Jennifer 77
 Winkielman, Piotr 97
 Winneke, Axel H. 62
 Wirth, Michelle M. 46,
 69
 Wise, Kevin 81, 104
 Wlotko, Edward W. 83
 Wnek, Kristopher J. 84
 Woidich, Eva 110
 Wolf, Jutta M. 34
 Wolf, Samantha 90
 Wölfling, Klaus 71
 Wraga, Maryjane 41
 Wright, Rex A. 39
 Wu, Jia 63
 Wu, Jianhui 87
 Wyatt, Jason W. 87
 Wyman, Ana E. 88
- Y**
- Yagi, Akihiro 65, 111
 Yamazaki, Katuo 101
 Yates, Marisa C. 83
 Yee, Cindy M. 66
 Yoshihiro, Tatsuya 102
 Young, Simon N. 70
 Yu, Zhulin 87
 Yuan, Joyce W. 54
 Yuki, Hamamoto 57
- Z**
- Zani, Alberto 44, 102
 Zarahn, Eric 28
 Zhang, Heping 106
 Zheng, Xin 76
 Zhu, David C. 32
 Zollner, Tanja 34

NOTES

NOTES

NOTES

PROGRAM SCHEDULE AT-A-GLANCE

Tuesday, October 16, 2007

8:30 A.M.–5:00 P.M., Verelst Room, Pre-Conference Workshop (available for an additional fee), *The ERP Mini Boot Camp*

Wednesday, October 17, 2007

8:30 A.M.–5:00 P.M., Regency Ballroom A, Pre-Conference Workshop, *The ERP Mini Boot Camp* (continued)

12:00 noon–5:30 P.M., Westbrook, *SPR Board of Directors Meeting*

5:30 P.M.–8:00 P.M., Regency Ballroom Foyer, *Registration Opens*

5:30 P.M.–8:00 P.M., Scarborough Ballroom, *Opening Reception*. Cash bar and hors d'oeuvres. **All attendees are welcome!**

Thursday, October 18, 2007

7:30 A.M.–4:00 P.M., Regency Ballroom Foyer, *Registration*

8:00 A.M.–3:00 P.M., Mezzanine Level, *Exhibits Open*

8:00 A.M.–9:00 P.M., Regency Ballroom Foyer, *Internet Station*

8:30 A.M.–10:00 A.M., Regency Ballroom A, Symposium 1, *The Role of the Amygdala in Social/Emotional Cognition Across Development*

8:30 A.M.–10:00 A.M., Scarborough Ballroom 1, Symposium 2, *Cortical Dynamics for Visual Knowledge about Objects: Where Vision Meets Memory*

8:30 A.M.–10:00 A.M., Scarborough Ballroom 3, Symposium 3, *Deception Detection: New Procedures and Techniques for the 21st Century*

10:00 A.M.–10:30 A.M., Mezzanine Level, *Refreshment Break*

10:30 A.M.–11:30 A.M., Regency Ballroom D, Invited Address, *Neural Systems Involved in Fear Extinction: Relevance to Psychotherapy*, Michael Davis

11:30 A.M.–1:00 P.M., *Break for Lunch* (on your own)

11:30 A.M.–1:00 P.M., Verelst Room, *Education and Training Committee Roundtable Discussions*

1:00 P.M.–2:30 P.M., Regency Ballroom D, Presidential Symposium, *Twenty-Seven Years of the Psychophysiology of Language Processing*

2:30 P.M.–3:00 P.M., Mezzanine Level, *Refreshment Break*

3:00 P.M.–4:30 P.M., Regency Ballroom A, Symposium 4, *Spotting Danger: Stimulus Properties and Individual Differences Underlying Threat Detection*

3:00 P.M.–4:30 P.M., Scarborough Ballroom 1, Symposium 5, *Issues in Frontal EEG Asymmetry as a Marker of Risk for Psychopathology*

4:30 P.M.–4:45 P.M., *Break*

4:45 P.M.–6:15 P.M., Regency Ballroom A, Symposium 6, *Stress Sensitization and Fear Learning in Posttraumatic Stress Disorder*

4:45 P.M.–6:15 P.M., Scarborough Ballroom 1, Symposium 7, *The Psychophysiology of Adult Attachment*

6:15 P.M.–8:15 P.M., Harborside Center, *Poster Session I*

8:15 P.M.–10:15 P.M., Scarborough Ballroom 2, *Early Careers Conversation Hour* (pre-registration requested)

Friday, October 19, 2007

8:00 A.M.–4:00 P.M., Regency Ballroom Foyer, *Registration*

8:00 A.M.–3:00 P.M., Mezzanine Level, *Exhibits Open*

8:00 A.M.–9:00 P.M., Regency Ballroom Foyer, *Internet Station*

8:30 A.M.–10:00 A.M., Regency Ballroom A, Symposium 8, *Neurophysiological Correlates of Emotion Regulation in Adults and Children*

8:30 A.M.–10:00 A.M., Scarborough Ballroom 1, Symposium 9, *Emerging Perspectives in Cardiovascular Psychophysiology: RSA, Vagal Tone and Beyond*

- 8:30 A.M.–10:00 A.M., Scarborough Ballroom 3, Symposium 10, *Personality, Affect, and Cardiovascular Response: Evidence for Motivational Gains and Deficits*
- 10:00 A.M.–10:30 A.M., Mezzanine Level, *Refreshment Break*
- 10:30 A.M.–11:30 A.M., Regency Ballroom D, Invited Address, *Functional Specificity in the Cortex: Selectivity, Experience, & Generality*, Nancy Kanwisher
- 11:30 A.M.–1:00 P.M., *Break for Lunch* (on your own)
- 11:30 A.M.–1:00 P.M., Verelst, *Women in Science Lunch Box Discussion* (pre-registration requested)
- 1:00 P.M.–2:30 P.M., Regency Ballroom A, Symposium 11, *An Integrative Approach to Understanding How Cultural Stereotypes Affect Performance, Learning, and Retention*
- 1:00 P.M.–2:30 P.M., Scarborough Ballroom 1, Symposium 12, *When Structure Meets Function: New Frontiers in Neuroimaging*
- 2:30 P.M.–3:00 P.M., Mezzanine Level, *Refreshment Break*
- 3:00 P.M.–4:30 P.M., Regency Ballroom A, Symposium 13, *The Defense Cascade: The Dynamics of Fear Reaction*
- 3:00 P.M.–4:30 P.M., Scarborough Ballroom 1, Symposium 14, *How Early is Semantics? Electrophysiological Correlates of Semantic Processing Peaking Earlier than the N400*
- 4:30 P.M.–4:45 P.M., *Break*
- 4:45 P.M.–5:45 P.M., Regency Ballroom D, Invited Address, *Neural Correlates of Recollection and Familiarity in Young and Older Adults*, Roberta Cabeza
- 5:45 P.M.–6:00 P.M., *Break*
- 6:00 P.M.–8:00 P.M., Harborside Center, *Poster Session II*
- 10:00 P.M., *Student Social* (location to be announced). **All students are invited!**

Saturday, October 20, 2007

- 8:00 A.M.–10:30 A.M., Mezzanine Level, *Exhibits Open*
- 8:00 A.M.–9:00 P.M., Regency Ballroom Foyer, *Internet Station*
- 8:30 A.M.–10:00 A.M., Regency Ballroom A, Symposium 15, *Implicit Processes of Motivation: Evidence from Neuroimaging, Neuroendocrinology, and ERP Research*
- 8:30 A.M.–3:00 P.M., Regency Ballroom Foyer, *Registration*
- 8:30 A.M.–10:00 A.M., Scarborough Ballroom 1, Symposium 16, *Attention and Memory in Audition: Measurements of Brain Activity and Behavior*
- 8:30 A.M.–10:00 A.M., Scarborough Ballroom 3, Symposium 17, *William James' Legacy: The Present State of Autonomic Response Specificity of Emotion*
- 10:00 A.M.–10:30 A.M., Mezzanine Level, *Refreshment Break*
- 10:30 A.M.–11:00 A.M., Regency Ballroom D, Award for Distinguished Early Career Contribution to Psychophysiology, *Investigating Mechanisms of Social Cognition with Event-Related Brain Potentials*, Bruce D. Bartholow, PhD
- 11:00 A.M.–12:00 noon, Regency Ballroom D, Presidential Address, *The Way of Our Errors: Theme and Variations*, Robert F. Simons
- 12:15 P.M.–2:15 P.M., Scarborough Ballroom, *Business Meeting and Luncheon*
- 2:15 P.M., *Free Afternoon to Explore Savannah!*
- 7:00 P.M.–9:00 P.M., Harborside Center, *Poster Session III*
- 9:00 P.M.–12:00 midnight, Regency Ballroom D, *Saturday Night Social*. **All attendees are welcome!**

Sunday, October 21, 2007

- 8:00 A.M.–10:00 A.M., Regency Ballroom A, *Farewell Breakfast*. **All attendees are welcome!**
- 8:30 A.M.–12:00 noon, Westbrook, *SPR Board of Directors Meeting*