

Texas Association of Assessing Officers - Annual Conference

August 25-28, 2019

J.W. Marriott Resort - Grand Oaks Ballrooms K-S - San Antonio, Tx

REVISION
Date: 1/15/2019
By: TINA ALLISON(NCRDC)

BOOTH COUNT

Inventory as of 01/15/2019

Dimension	Qty
10'x10'	26
10'x20'	8
10'x30'	1

BLDG. LEGEND:

- EP - Denotes Electrical Panel
- - Denotes Electrical Floor Port
- FE - Denotes Fire Extinguisher
- ⊞ - Denotes Wall Sconce

DRAWING INFO

Passport Line Item Number:

#4609223

Facility:
J.W. Marriott Resort

Hall / Level:
Grand Oaks Ballrooms K-S

City & State:
San Antonio, Tx

Scale: Custom

Job #: 430741

AE: KAHLEI MATEJEK

Prod. AE: KAHLEI MATEJEK

Started: 1/15/2019

Started By: Fred De Leon, SRDC

Prod. Branch: San Antonio

F R E E M A N

Disclaimer - Every effort has been made to ensure the accuracy of all information contained on this floorplan. However, no warranties, either expressed or implied, are made with respect to this floorplan. If the location of building columns, utilities or other architectural components of the facility is a consideration in the construction or usage of an exhibit, it is the sole responsibility of the exhibitor to physically inspect the facility to verify all dimension and locations.
© Copyright 2007, Freeman Co. All rights reserved.

Confidential and Proprietary - the information contained herein is the proprietary information of Freeman and by accessing the information, the recipient agrees to keep the information confidential and not disclose it to any third party without the prior consent of Freeman. Recipient also agrees to only use the information for its internal evaluation purposes and for no other purpose, without the prior consent of Freeman.

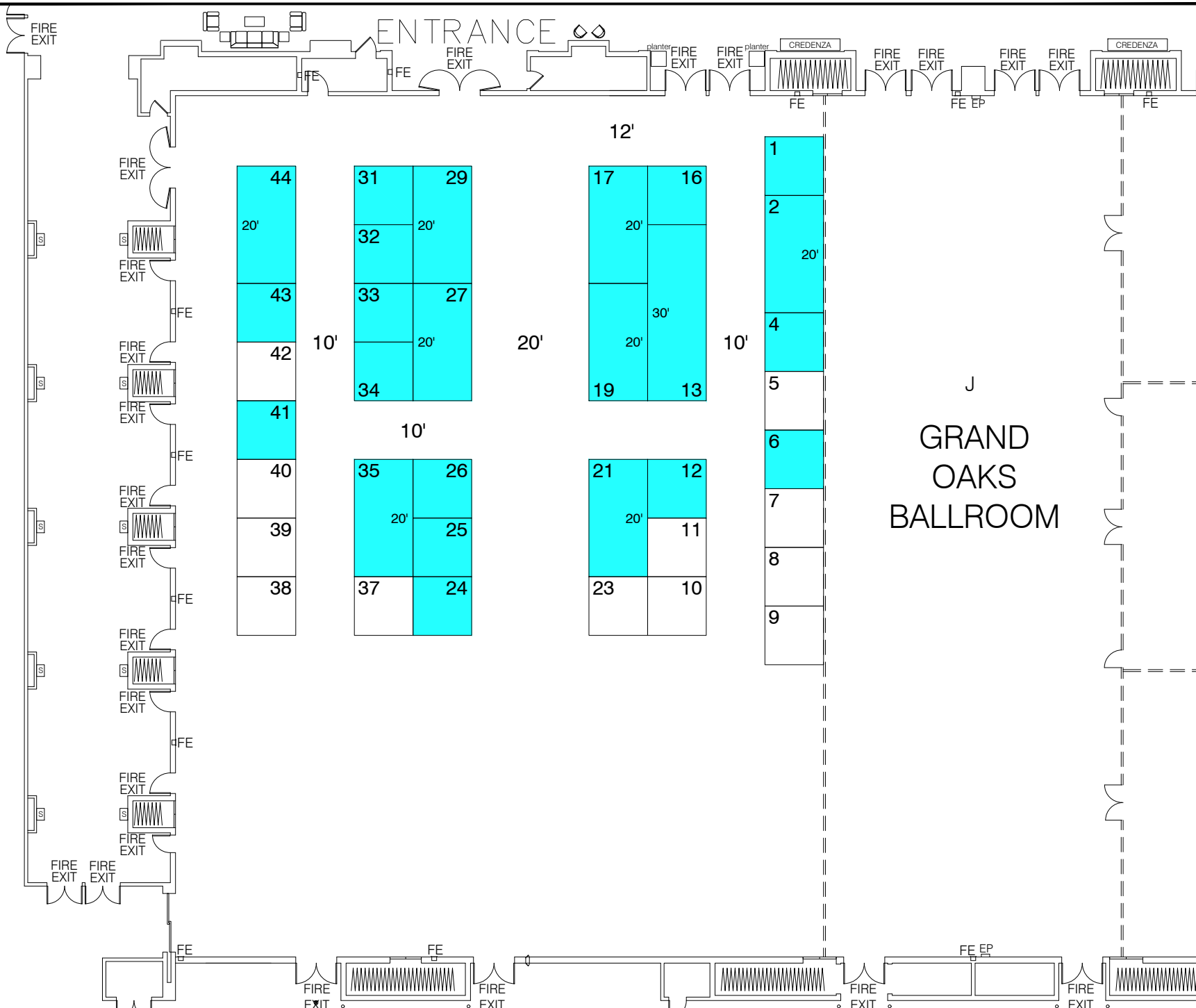

File Path: P:\San Antonio\Branch\Design\FLOOR PLANS\2019\08-Aug\TX Assn of Assessing Officers (430741)\DWG Files\TAAO 0819.dwg | Tab Name: 8.5x11L

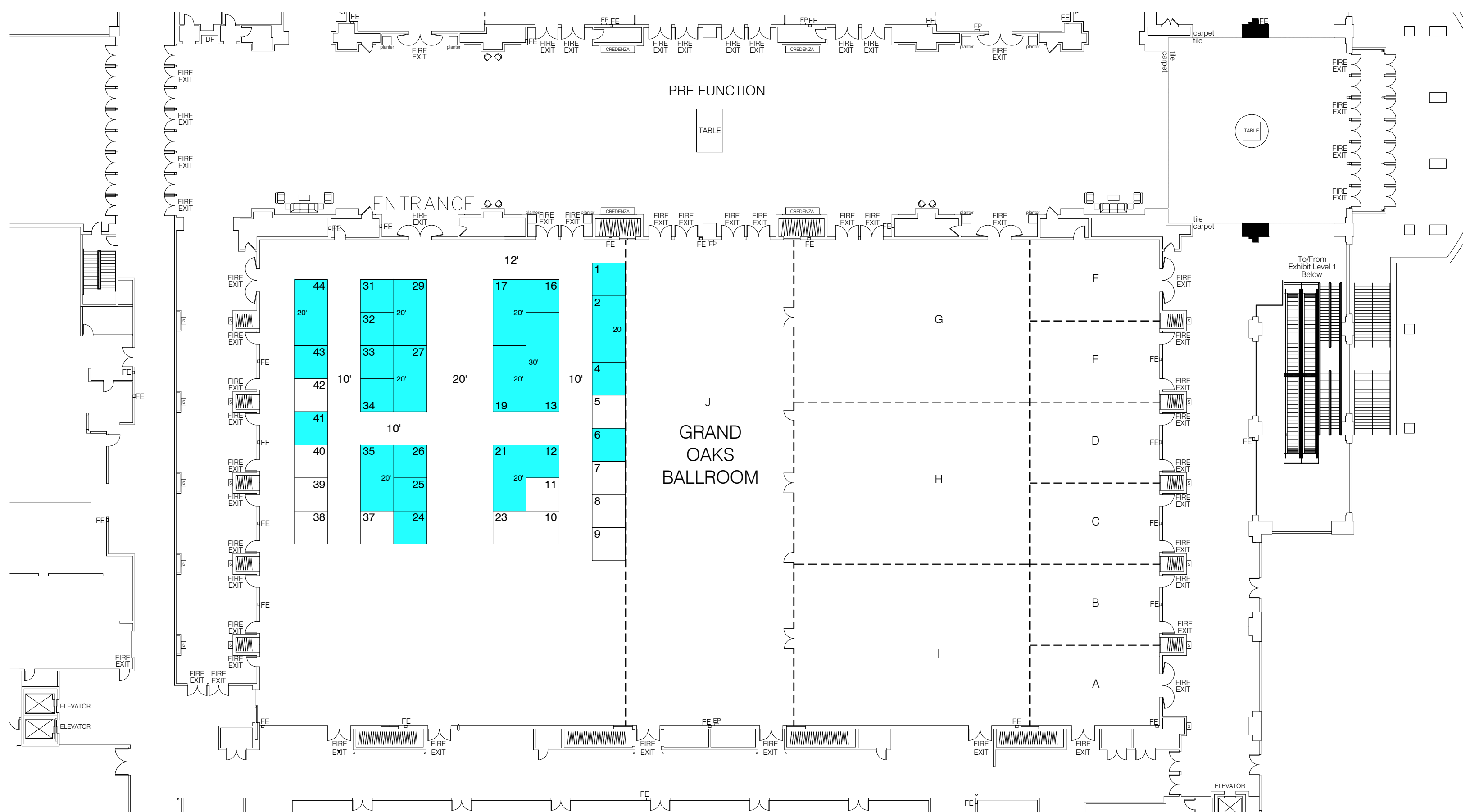

Texas Association of Assessing Officers - Annual Conference - August 25-28, 2019

J.W. Marriott Resort - Grand Oaks Ballrooms K-S - San Antonio, Tx

FREEMAN

Disclaimer - Every effort has been made to ensure the accuracy of all information contained on this floorplan. However, no warranties, either expressed or implied, are made with respect to this floor plan. If the location of building columns, utilities or other architectural components of the facility is a consideration in the construction or usage of an exhibit, it is the sole responsibility of the exhibitor to physically inspect the facility to verify all dimension and locations. © Copyright 2007, freeman, all rights reserved.
Confidential and Proprietary - the information contained herein is the proprietary information of Freeman and by accessing the information, the recipient agrees to keep the information confidential and not disclose it to any third party without the prior consent of Freeman. Recipient also agrees to only use the information for its internal evaluation purposes and for no other purpose, without the prior consent of Freeman.

Drawing Started:
1/15/2019
Started By:
Fred De Leon, SRDC

Account Exec:
KAHLEI MATEJEK
Producing Exec:
KAHLEI MATEJEK

Revision Date:
1/15/2019
Revised By:
TINA ALLISON(NCRDC)

Line Item:
#4609223
Scale:
Custom