



THE AMERICAN INSTITUTE OF ARCHITECTS

I O W A C H A P T E R

Celebrating the Past, Designing the Future | 1857 - 2007



This year, the members of the American Institute of Architects mark the AIA's 150 years of service to the profession and the nation.

On February 23, 1857, thirteen architects met in an office in New York City to form what would become The American Institute of Architects. The group sought to create an architecture organization that would "promote the scientific and practical perfection of its members" and "elevate the standing of the profession."

Today, the AIA has more than 300 components in the United States and its territories, as well as in the United Kingdom, Continental Europe, and Hong Kong. This includes the Iowa Chapter of the American Institute of Architects, established in 1904 and headquartered in Des Moines. AIA members share a commitment to producing excellence in design and helping our state and our nation create better places to live, work, and play.

Architecture of the Century

In 2004 a panel of distinguished Iowans selected 50 buildings that represent the best of Iowa Architecture, 1900-1999. The buildings selected celebrate a small portion of Iowa's exceptional architecture and the high quality of the communities which created them.

AIA Iowa



A Chapter of
The American Institute of Architects



1900
St. Paul's Episcopal Church
Proudfoot & Bird
Harlan

1903
Des Moines Public Library
Smith & Gutterson
Des Moines

1905
Kendall Young Library
Patton & Miller
Webster City

1906
Polk County Courthouse
Proudfoot & Bird
Des Moines

1909
City National Bank Building /
Park Inn Hotel
Frank Lloyd Wright
Mason City

Architects ... more than designers of buildings

AIA architects advocate design excellence for a better, more sustainable, more economically vibrant Iowa

Through education and professional training architects are ... perceptive listeners, planners, problem solvers, creative thinkers and pragmatic visionaries who, as advocates for their clients, are facilitators of a planning and design process focused on place-making and creating better places to live, work and play. As organizers of both internal and external space, architects are responsible for creating a sense of place in the communities they serve.

The American Institute of Architects, Iowa Chapter (AIA Iowa) has established an advocacy platform which embraces many of the issues important to the economic viability of Iowa as identified in the "Iowa 2010 Plan" promoted by Iowans for a Better Future.

AIA Iowa advocates a holistic approach to the planning, design and construction process; this approach embraces the principles of sustainability to create more livable communities. These communities are of the highest quality that will meet the needs of the present generation without compromising the ability of future generations to meet their own needs.

AIA members have consistently championed the principles of ...

Sustainability

Preserving Iowa's rich natural resources for future generations will require a conscious, holistic approach to integrating energy efficiency, utilizing resources responsibly and creating a symbiotic relationship between the built and natural environments. To accomplish this, we need: 1) new regulations governing project delivery—from planning through construction, 2) the establishment of design and construction requirements to meet an industry-wide acceptable minimum standard of energy, and 3) environmental and land use.

These new standards should apply to all public architecture in Iowa, including all State-owned buildings and public schools, to ensure that all Iowans, present and future, are the beneficiaries of the socio-economic, cultural and environmental benefits that are gained.



Examples of architecture that make Iowa a better, more sustainable, more economically vibrant place to live: TOP: Marion Arts & Entertainment Center, Marion, RDG Planning & Design Photo by Kun Zhang, RDG Planning & Design ABOVE: Grand River Center, Dubuque, HOK Architects (Durrant-Interiors, Steve Ulstad-Landscape) Photo by David Grissel, HOK Architects

Livable Communities

Well-planned and well-designed communities must: 1) provide a physical environment that promotes inclusiveness and accessibility; 2) offer affordable, appropriate, and accessible housing; 3) provide accessible, affordable, reliable, and safe alternative transportation systems; 4) promote business, volunteer, and educational

opportunities; 5) provide access to key health and support services; and, 6) encourage participation in civic, cultural, social and recreational activities.

Within each of these six areas, a livable community strives to maximize people's independence, assure safety and security, promote inclusiveness and provide choice. As a result, extraordinary improvements in

the quality of life for all Iowans will be realized and Iowa could be recognized as America's Most Livable State.

Quality Design

Design is both a process and a product, which in the context of architecture and the built environment has a significant impact on quality of life issues that touch all of us where we live, work and play. Investment in a well-designed Iowa will benefit all Iowans by attracting new businesses, residents and visitors to Iowa; by creating a positive socio-economic and cultural impact on our communities; and, by sustaining economic growth and vitality through environmentally and ecologically sensitive and responsive solutions.

So what is AIA Iowa doing to promote our advocacy positions?

AIA Iowa is collaborating with other agencies and associations representing the myriad of elected officials, appointees and professionals within government, planning, development, design and construction throughout the State of Iowa to help create a win-win for all Iowans.

Our Goal

IOWA — America's Most Livable State

So how is AIA Iowa going to help achieve this lofty, yet attainable goal?

As an organization, we are supporting efforts and legislation that ...

- embrace the principles of Green Architecture promoting sustainability and the responsible use of our state resources;
- provide for the research and development of alternative and renewable energy sources for use throughout the state;
- allocate income tax credits for historic preservation and rehabilitation;
- create a state-wide comprehensive energy code and establish an energy fund providing financial assistance to building owners to help offset the additional costs (design, documentation and commissioning) of the design and construction of state-funded projects that meet minimum criteria for energy efficiency and ecologically responsible design and construction.



<p>1910 Iowa State Historical Memorial and Art Building <i>Smith & Gutterson and Smith & Gage</i> Des Moines</p>	<p>1913 Masonic Temple <i>Proudfoot Bird & Rawson</i> Des Moines</p>	<p>1914 Joshua G. Melson House <i>Walter Burley Griffin Architect</i> Mason City</p>	<p>1915 Merchants National Bank Building <i>Louis H. Sullivan</i> Grinnell</p>	<p>1918 Woodbury County Courthouse <i>William Steels and Purcell & Elmslie</i> Sioux City</p>	<p>1920 C.B. Baldwin House <i>G.M. Kerns</i> Farson</p>	<p>1922 Roosevelt High School <i>Proudfoot Bird & Rawson</i> Des Moines</p>	<p>1923 Equitable Building <i>Proudfoot Bird & Rawson</i> Des Moines</p>	<p>1923 First National Bank Building <i>Frank A. Childs & William Jones Smith</i> Davenport</p>
---	---	---	---	--	--	--	---	--

THE AMERICAN INSTITUTE OF ARCHITECTS

Join Us in Celebrating the Past, Designing the Future | 1857 - 2007

This year, the members of the American Institute of Architects mark the AIA's 150 years of service to the profession and the nation.

You are invited to participate in the special AIA150 celebration.

Online

Visit www.IowaArchitecture.org to learn more about contemporary and historical architecture in Iowa.

Visit www.AIAIowa.org to learn more about The American Institute of Architects.

At the State Fair

Iowa Architecture is a special class in the 2007 Iowa State Fair Photography Salon. All Iowans are invited to participate, and your assignment is to photograph a piece of the built environment within the borders of the state, a place where we live, work, or play. The Iowa Architecture special class is open to both adults and youth, black & white or color photographs. Remember the judges are looking for creativity and entries that convey emotion. The entry deadline is July 1. For more information, visit the Iowa State Fair website at www.iowastatefair.com.

At Your Local Library

Local libraries around the state have copies of *A Century of Iowa Architecture*, a special book focusing on Iowa buildings during the 20th century, in addition to a special architecture puzzle that will be on display this year. If your local library does not have a copy of the book or puzzle display, ask them to contact AIA Iowa to request one!

In a Walking Tour

Learn about Des Moines' history and architectural heritage during the Iowa Architectural Foundation's Architecture at Hand walking tours. These summer tours are a great way to learn from a local architect what makes Iowa's capitol unique, and they are perfect for both Des Moines natives who want to learn more about their hometown and for out-of-town visitors who would like to spend a day in the city. Participants may choose from three routes, North, West and Des Moines' East Village.

All tours start at 5:30 p.m. at the Crusoe Umbrella on Nollen Plaza every other Thursday evening starting June 14, 2007.

Suggested donation: \$10 per person

Tour dates are:

- June 14 & 28
- July 12 & 26
- August 9 & 23
- September 6

Walking tours are sponsored by the Iowa Architectural Foundation, an independent, non-profit group dedicated to fostering an appreciation of design excellence and working for preservation of Iowa's cultural heritage.

In Print

Iowa Architect is a national award-winning magazine published four times a year by AIA Iowa. Each issue includes reviews of new construction and historically significant buildings in Iowa, along with additional information for noteworthy events and achievements in the arts.

Subscriptions are available to the public at a cost of \$25 per year or \$45 for two years. To subscribe, contact AIA Iowa at 515-244-7502 or info@aiaIowa.org.



Why You Should Hire an AIA Architect

Architects solve problems in creative ways. An AIA architect...

- can see the big picture and create a total environment.
- can help you meet your needs and work within your budget and time frame.
- has broad knowledge of design and construction.
- can show you alternatives and options you might have never thought of on your own.
- can save you money.
- can design space that meets your needs today and is flexible enough to meet your needs tomorrow.
- will provide services that are a wise investment for your money.
- will conceive a project that can be built more efficiently and economically.
- can design an energy efficient building

- that can save you money on fuel bills down the road.
- can help you choose materials and finishes that are durable as well as beautiful, saving on frequent maintenance and replacement costs.
- looks out for your interests and finds ways to make the building process run smoothly.
- can coordinate an appropriate team of quality experts for your project so you don't have to.
- can take a large amount of information and synthesize it into a focus and direction. The architect is the one professional who has the education, training, experience, and vision to guide you through the entire design and construction process by helping you get the most for your construction dollar...good design is good business.



TOP: St. Paul's Lutheran Church, Winterset, RDG Planning & Design
Photo by Farshid Assassi, Hon. AIA, Assassi Productions **BOTTOM: Novak Residence, Cedar Rapids, Novak Design Group, P.L.C.** Photo by Novak Design Group, P.L.C.



AIA Iowa thanks the following azsponsors for making this publication possible.





1928
Salisbury House
Boyd & Moore and
Rasmussen & Wayland
Des Moines

1930
Badgerow Building
Knut Westerlind
Sioux City

1932
Iowa-Des Moines
National Bank Building
Proudfoot Rawson Souers
& Thomas
Des Moines

1935
Grandview Park Band Shell
Henry L. Kamphoefner
Sioux City

1936
Eagle Point Park Shelters
Alfred Caldwell
Dubuque

1937
Earl Butler House
Kraetsch & Kraetsch
Des Moines

1941
High School Auditorium
and Gymnasium
Thorwald Thorson
Ventura

1943
Julien Dubuque Bridge
Edward L. Ashton
Dubuque

1944
Chicago, Burlington and
Quincy Station
Holabird & Root
Burlington

Livable Community = a well-planned, well-designed community that supports inclusiveness, accessibility, affordability, health, and opportunity for all; a great place to live

Iowa: Becoming America's Best Place to Live

By Matt Cole, AIA and Tim Hielkema, AIA

What will it take to make Iowa America's Most Livable State? The answer lies in the design and planning of our communities and neighborhoods.

What makes Iowa special? Most people reminisce about a small Iowa town that they grew up in or visited as a child. Whether they describe the Amana Colonies, Winterset's covered bridges or the quaint Dutch architecture of Pella, the response is typically the same; they describe a community that grew through the generations to typify the social her-



LEFT: Great places to live provide choices and vibrant public spaces, example: Village of Ponderosa, West Des Moines, BSB Design Rendering by Milo Olea, Olea Studio **RIGHT: Good design can revitalize urban centers, example: Durrant Office, Des Moines, Durrant** Office, Photo by Rick Peters, InsideOut Studios

itage of the residents.

Some people may recall landmarks of the larger cities, such as the State Capitol or a Regent's University, or a specific neighborhood within an urban core like Cedar Rapids' Czech Village or the East Village in Des Moines. Still others refer to naturally occurring phenomena such as the Iowa Great Lakes, the Loess Hills or the Rivers that bracket Iowa's borders. Although these answers are diverse, they paint an appropriate framework for the continuance of the underlying principles that make Iowa such a great

place to live and raise a family.

The American Institute of Architects has published a list of 10 Principles for Livable Communities. These tenets work together to maximize people's independence, assure safety and security, promote inclusiveness and provide choice.

Communities that are truly great places to live do not happen by accident. They must be carefully planned and consistently promote the highest quality of design. Members of The American Institute of Architects provide their services to help communities accomplish this.





ALLIANT ENERGY
Interstate Power and Light

Create buildings that perform as good as they look

Our non-residential new construction program provides a unique opportunity for the building owner and design team members to participate in an integrated design process that uses building performance simulation modeling to identify and implement cost-effective energy-efficiency strategies which add significant investment value.

The buildings features in this ad have not taken part in the program – they are shown for artistic purposes only.



Call 1-866-ALLIANT or visit our web site at
www.alliantenergy.com/newconstruction
to find out if your next Iowa project qualifies.

The Atheneum, New Harmony, IN Vontz Center for Molecular Studies, Cincinnati, OH

© 2007 Alliant Energy 113108 3/07 JS



1948
Des Moines Art Center
Saarinen Swanson & Saarinen
Architects and Brooks Borg,
Architects-Engineers
Des Moines

1948
Fitch Pharmacy Hall,
Drake University
Saarinen, Saarinen, Swanson
and Associates
Des Moines

1950
"Cedar Rock"
(Lowell Walter House)
Frank Lloyd Wright
Quasqueton

1951
Jack Lamberson House
Frank Lloyd Wright
Oskaloosa

1955
Charles Medbury Hall and
Oreon E. Scott Chapel,
Drake University
Eero Saarinen & Associates
Des Moines

1959
Central YMCA Building
Wetherell & Harrison
Des Moines

1959
Crites House No. 1
Crites & McConnell
Cedar Rapids

1962
Home Federal Savings
& Loan Building
Ludwig Mies van der Rohe
Des Moines

1966
American Republic
Insurance Building
Skidmore, Owings & Merrill
Des Moines

The American Institute of Architects' 10 Principles for Livable Communities



Iowa must continue to keep an eye on the past as we look forward to the future. We must celebrate the land and culture that has made this state so beautiful. This cannot be attained alone, without the support of both the public and private sectors. It must be embraced by small cities as well as by major metropolitan areas. It must be championed by farmers as well as financiers, by mayors as well as mailmen, by educators as well as students.

Iowans must band together to create a groundswell of support for these guidelines through integrated policies and action. As a result, Iowa can improve upon its successes and become America's "Most Livable State."

1 Design on a Human Scale

Compact, pedestrian-friendly communities allow residents to walk to shops, services, cultural resources, and jobs and can reduce traffic congestion and benefit people's health.

2 Provides Choices

People want variety in housing, shopping, recreation, transportation, and employment. Variety creates lively neighborhoods and accommodates residents in different stages of their lives.

3 Encourage Mixed-Use Development

Integrating different land uses and varied building types creates vibrant, pedestrian-friendly and diverse communities.

4 Preserve Urban Centers

Restoring, revitalizing, and infilling urban centers takes advantage of existing streets, services and buildings and avoids the need for new infrastructure. This helps to curb sprawl and promote stability for city neighborhoods.

5 Vary Transportation Options

Giving people the option of walking, biking and using public transit, in addition to driving, reduces traffic congestion, protects the environment and encourages physical activity.

6 Build Vibrant Public Spaces

Citizens need welcoming, well-defined public spaces to stimulate face-to-face interaction, collectively celebrate and mourn, encourage civic participation, admire public art, and gather for public events.

7 Create a Neighborhood Identity

A "sense of place" gives neighborhoods a unique character, enhances the walking environment, and creates pride in the community.

8 Protect Environmental Resources

A well-designed balance of nature and development preserves natural systems, protects waterways from pollution, reduces air pollution, and protects property values.

9 Conserve Landscapes

Open space, farms, and wildlife habitat are essential for environmental, recreational, and cultural reasons.

10 Design Matters

Design excellence is the foundation of successful and healthy communities.

gewattier architecture inc.
305 east court avenue
Des Moines, IA 50309
P 515.243.0074
F 515.243.0075
www.gewattier.com

Serving the architectural needs of clients in the Upper Midwest for more than 50 years.

Special Events Center, Bettendorf

DOWNING ARCHITECTS PC

2415 Eighteenth Street | Bettendorf, Iowa 52722 | ph 563.355.1856 | www.downingarchitects.com

"Our mission is to provide exceptional design services with the highest level of integrity and creativity."

Cannon Moss Brygger & Assoc. ARCHITECTS

Sioux City, Spencer, & Ames, IA; and Grand Island, NE
<http://www.cmbaarchitects.com>

celebrating **60** + years

listening... understanding... performing...

Design Alliance Inc

14225 university avenue suite 110 waukee iowa 50263 ph: 515.225.3469 fax: 515.225.9649
e-mail: dharrison@designallianceinc.com www.DesignAllianceInc.com

AIA 150



1968
Des Moines Art Center
Addition
I.M. Pei & Partners
Des Moines

1969
C.Y. Stephens Auditorium,
Iowa State University
*Crites & McConnell and
Brooks Borg & Skiles,*
Architects-Engineers
Ames

1969
Maucker Union Building,
University of Northern Iowa
*Hunter, Rice & Engelbrecht
and Brooks, Borg & Skiles*
Architects-Engineers
Cedar Falls

1971
A.H. and Theo Blank
Performing Arts Center,
Simpson College
Charles Herbert & Associates
Indianola

1972
Brenton Bank & Trust
Company Building
Charles Herbert & Associates
Urbandale

1972
Iowa Society of Christian
Churches Building
Smith, Voorhees, Jensen
Des Moines

1975
Ruan Center,
Bankers Trust Building
Kendall Griffith Russell Arltaga
Des Moines

1979
Civic Center of
Greater Des Moines
Charles Herbert & Associates
Des Moines

1982
Carver-Hawkeye Arena,
University of Iowa
*Caudill Rowlett Scott
Architects and Durrant*
Iowa City

Good Design is Good Business

By Matt Ostanik, AIA, Greg Kanz, APR, and Jessica Reinert

A building is a building, right? It is common to hear ads on the radio for steel buildings constructed for less money and delivered in a shorter time frame than traditional construction. More and more it seems, buildings are like commodities—no difference other than price.

Research is painting a different picture. In fact, studies indicate that well designed buildings actually enhance an organization's bottom line, and this is getting the attention of businesses and organizations throughout Iowa.

A team of researchers at Iowa State University noted that the relationship between good architecture and good business is critical, but often overlooked. The researchers found that in many organizations, decisions about the design of facilities or offices were made on the basis of technical, financial, or political concerns, without looking at the broader perspective of how the overall design shapes and influences every aspect of the workplace.

Identity

Architecture can provide a sense of identity for businesses and organizations, identity that strengthens relationships and perceptions among customers, local communities and employees. In an era of generic office buildings, architectural identity might seem way down the list of priorities,



Examples of investments in design that improve business identity, efficiency, and productivity: FAR LEFT: Plaza Towers, Iowa City, Neumann Monson Architects, Photo by Farshid Assassi, Hon. AIA, Assassi Productions LEFT: Wells Fargo Home Mortgage, West Des Moines, SVPA Architects, Photo by Cameron Campbell, AIA

but it has become even more important and rewarding to those who invest in it.

An example can be seen in the Meredith Corporate Expansion project in Des Moines, which was recognized for the sense of corporate and community identity it provides as it welcomes visitors to the downtown district. The project was credited with helping to spur other development in the Gateway West area, including a new downtown library, performing arts and higher education centers, and other corporate expansions. As an added bonus the building saved costs for its owner with energy efficiencies, including a 46 percent reduction in lighting costs that earned it MidAmerican Energy's highest award for energy conservation.

Efficiency

Good design of a workplace can play a key role in improving efficiency by reducing the costs of construction materials,

energy usage and other direct costs. At the Iowa Association of Municipal Utilities Training and Office Facility in Ankeny, the

In a world of global markets and increasingly intense competition, business can't afford to not invest in good design.

design strived for maximum energy performance. The results were stunning: the facility uses 28,000 BTU/square foot per year, a savings of 65 percent compared to a similar building in the same climate.

Other means of efficiency can also be found with visionary thinking about opportunities for partnerships and economies of scale. The Citizen's Community Center in Huxley started as a simple idea for a new library. But it was

realized that by combining a library with town offices, educational spaces, and a recreational complex, greater efficiencies could be achieved for those organizations and for all the citizens of Huxley who rely on them. In the first year alone, recreation center revenue came in three times higher than anticipated, the city saved countless dollars in operational efficiencies, and the library was able to expand their staff, hours and book collection.

Productivity

Just as design can affect an organization's inputs and reduce costs, it can also boost the outputs by increasing overall organizational productivity. In many cases, this productivity enhancement may be much more significant

making MORE of LIFE
through purpose-driven design

RDg...
PLANNING • DESIGN

301 Grand Avenue
Des Moines, Iowa 50309
515.288.3141
www.rdgusa.com

LEADING IOWA IN SUSTAINABLE DESIGN SOLUTIONS

NEUMANN MONSON
ARCHITECTS

Davenport Police Facility
Slated to be Iowa's 1st LEED Municipal Building

221 East College St. Suite 303 Iowa City, IA 52240 p. 319.338.7878 www.neumannmonson.com



1985
Des Moines Convention Center
Brooks Borg & Skiles,
Architects-Engineers
and Loschky Marquardt
and Nesholm
Des Moines

1985
Des Moines Art Center
Addition
Richard Meier
Des Moines

1986
Agronomy Hall Expansion
and Remodeling,
Iowa State University
Bussard / Dikis Associates
Ames

1987
Coppola House
Douglas A. Wells Architect
Des Moines

1991
801 Grand Building
Hellmuth, Obata
& Kassabaum
Des Moines

1992
Iowa Advanced
Technologies Laboratory,
University of Iowa
Frank O. Gehry & Associates
and Herbert Lewis Kruse
Blunck Architecture
Iowa City

1992
Forest Avenue Library,
Public Library of Des Moines
Baldwin Clause Architects
Des Moines

1997
EMC Insurance Building
Brooks Borg Skiles
Architecture-Engineering
Des Moines

1998
Meredith Corporation
Headquarters Expansion
Herbert Lewis Kruse Blunck
Architecture
Des Moines

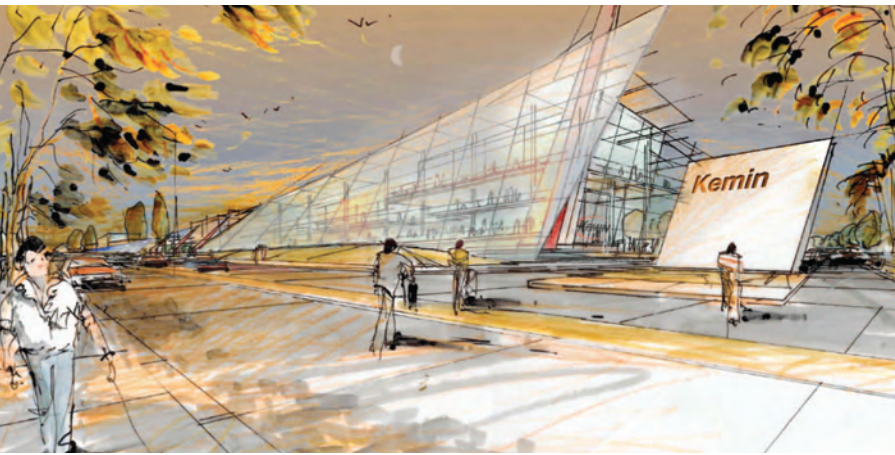

Kemin Industries, Des Moines, Shive-Hattery Architecture-Engineering with Architetto Ken Sowerby, Rendering by Architetto Ken Sowerby

than any direct cost savings from reduced energy use or other efficiencies.

The Rocky Mountain Institute's (RMI) Greening the Building and the Bottom Line, noted that the costs of human capital are much higher than the resources spent on building maintenance and energy usage. According to RMI's research, a typical U.S. office building in the 1990s spent \$1.81/SF on energy, \$1.37/SF on maintenance, \$21/SF for rent, and \$130/SF for employee salaries. In an article published

in the October 2004 Environmental Building News, author Alex Smith noted that a building design that creates even a tiny improvement in employee productivity or reduces staff absenteeism ultimately has a tremendously significant impact on the organization's bottom line.

Research continues into the exact links between design and productivity, but most experts agree there is ample evidence to show they are interrelated. Various national studies have shown links

between productivity and design elements such as daylighting, access to outside views and environmental controls that can be customized at each employee's workstation. In one famous example, the design of a new, daylit Lockheed-Martin facility was credited with reducing employee absenteeism by 15 percent and improving organizational efficiency and creativity such that the company was able to land significant new contracts—all as a result of good design.

Iowa State University researchers noted that many design variables contribute to job satisfaction and overall productivity, including office layout, air quality, noise, temperature and lighting. In addition, design also shapes how different components of the organization relate to each other, how communication occurs and how basic operational tasks are accomplished.

Good Design Means a Competitive Edge

The results are in, and the verdict is clear. In a world of global markets and increasingly intense competition, business can't afford to not invest in good design. A number of companies and organizations have led the way in demonstrating how working closely with architects to focus on the value of good design can result in real, meaningful improvements to their business model. Will others follow suit? How can they afford not to?

RESOURCES
"Good Design is Good Business." Published by AIA Iowa. Created by the Department of Architecture, College of Design, Iowa State University. Kate Schwennsen, Editor. Jamie Horwitz, PhD., Research Consultant. 1997.

STRUXTURE

ARCHITECTS

Complete Architectural Services
Interior Design & Planning
Since 1934





Commercial • Civic • School
Collegiate • Health & Life Care
Religious • Residential

Call for a free consultation!

100 Court Ave., Ste. 425
Des Moines, IA 50309
PH: (515) 283-5101

314 E. 4th Street
Waterloo, IA 50703
PH: (319) 234-1515

www.struxture.com

510 East Locust Street
Suite 200
Des Moines, IA 50309

T 515.309.0945
F 515.309.0944

700 Locust Street
Suite 942
Dubuque, IA 52001

T 563.583.9131
F 563.557.9078

www.durrant.com



Architecture
Engineering
Planning
Project Delivery
Financing
Interior Design



DURRANT®

GOOD DESIGN SAVES SOME GREEN

Congratulations AIA in celebrating 150 years!

In addition to developing great looking designs, Iowa Architects are helping to construct highly-efficient buildings. Together with AIA members, MidAmerican Energy is succeeding in its efforts to bring maximum value-added energy design to commercial buildings in Iowa. It's a partnership that achieves form and function for our clients. For more information on participating in our Commercial New Construction program visit us on the Web or give us a call.



MidAmerican
ENERGY

OBSESSIVELY, RELENTLESSLY AT YOUR SERVICE.™



800-292-6448
www.MIDAMERICANENERGY.com/ee

Morale is hurting.
Productivity is down.
Profitability is off.

Better call an architect.

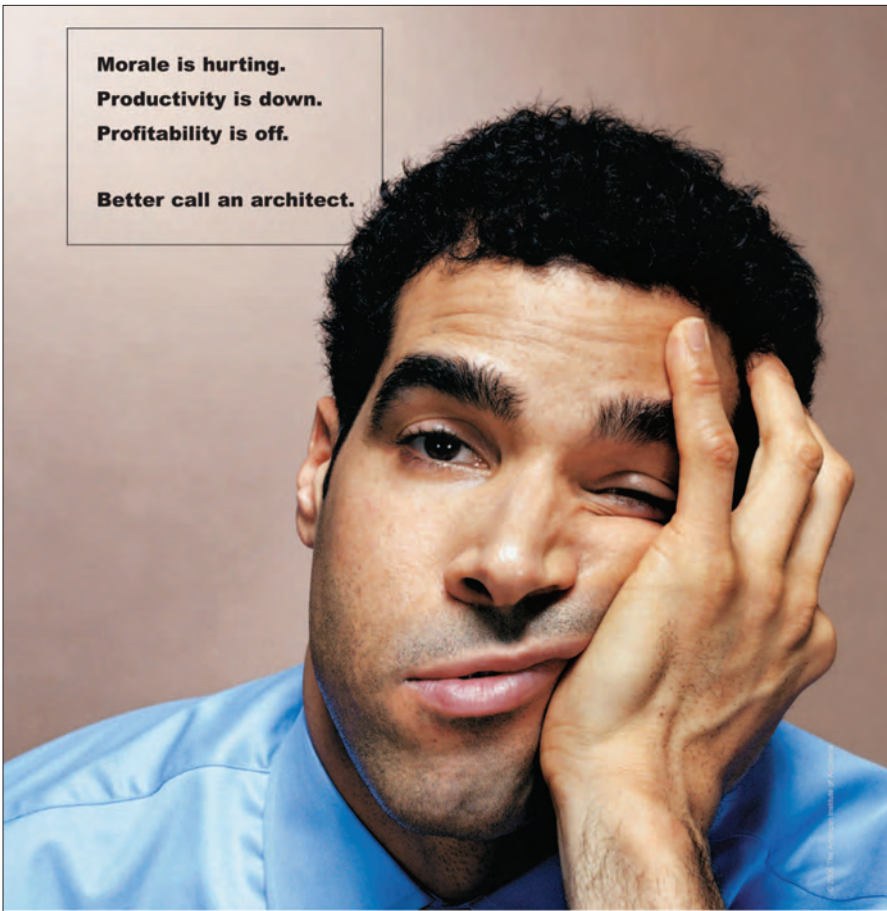

The design of a workspace can profoundly impact the effectiveness of a workforce. AIA architects design spaces that inspire and motivate. So your employees stay engaged and productive, and bottom lines stay healthy. And the sooner you hire an architect the more productive and healthy you'll be. To find an AIA architect, visit www.aia.org. **Good design makes a difference.**



THE AMERICAN
INSTITUTE
OF ARCHITECTS

Deliver dynamic presentations and improve meeting productivity



Business professionals trust AVI Systems and SMARTBoard™ interactive whiteboard solutions to make their presentations more productive, efficient and interactive.

Experience the power:

- **TOUCH** screen controls
- **WRITE** in electronic ink
- **SAVE**, print or email notes
- **HIGHLIGHT** key information easily



SMARTBoard™
interactive whiteboard

Call AVI Systems at **515-254-9850** to experience a SMARTBoard in action and to discuss system design, implementation and on-site service support for all SMART Technologies solutions and other communication systems.



FOCUSED ON YOUR SUCCESS
www.avisystems.com

3001 104th Street, Urbandale, IA Tel. 515-254-9850

Honey Creek Resort State Park



- Pre-Design Collaboration
- Architecture
- Engineering
- Construction
- Building Commissioning

DESIGN.

For our clients.

For Iowa's future.



Marshalltown ■ Omaha ■ Minneapolis ■ Rochester ■ Sioux Falls ■ Rapid City ■ Sheridan
www.teamtsp.com phone (641) 752-3930

Mom's cranky.
Dad's irritable.
The kids are grouchy.
Everybody needs counseling.

With an architect.



How living quarters are designed can enhance quality of life. AIA architects assess things like usage patterns, flow and privacy needs to design spaces that work for the whole family. Whether you need to expand, remodel or build from scratch, call an architect early. So you all can enjoy home sweet home. To find an AIA architect, visit www.aia.org. **Good design makes a difference.**



THE AMERICAN
INSTITUTE
OF ARCHITECTS