

Conference Schedule and Map

DoubleTree - Lloyd Center Map

First Floor

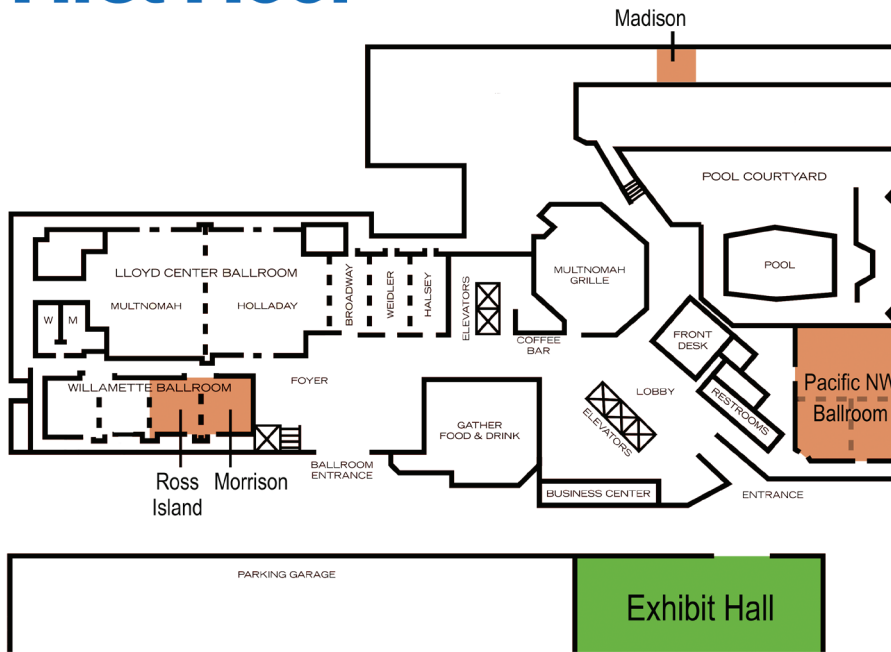

Second Floor

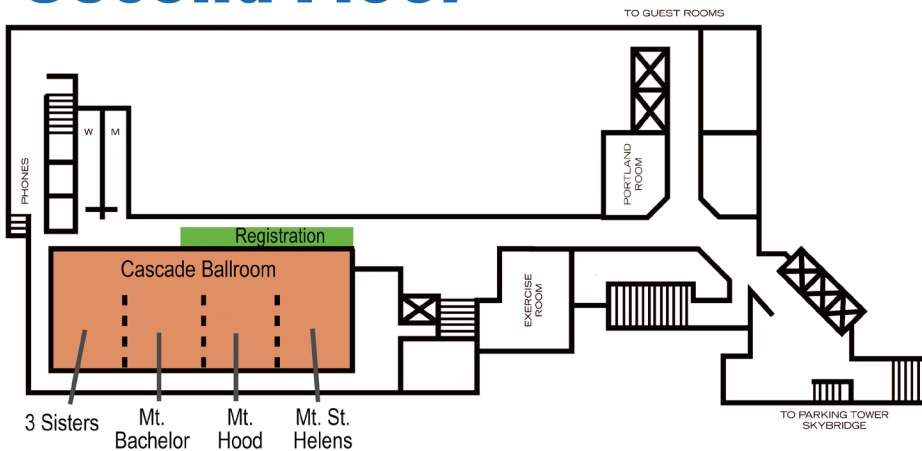

Program Schedule

Day 1 - Wednesday, Oct. 10, 2018

| Time | # | Session Title | Speaker | CE (Pharm) | Room |
|-------------|-----|--------------------------------------|------------------|------------|---------------------|
| 6:00-7:00pm | | Registration | | | |
| 7:00-8:15pm | 100 | Legal Issues for Nurse Practitioners | Michael Loughran | 1.25 (0) | Pacific NW Ballroom |

41ST ANNUAL
Nurse Practitioners of Oregon
NPO Education
Conference
Oct. 10-13, 2018 • Portland, OR

Day 2 - Thursday, Oct. 11, 2018

| Time | # | Session Title | Speaker | CE (Pharm) | Room |
|------------------|-----|--|--|-------------|------------------|
| 6:30-7:00am | | Morning Yoga Session (bring your own yoga mat) | | | Madison |
| 7:00-8:00am | | Registration / Visit Exhibits | | | |
| 8:00-8:30am | | Welcome/Announcements | | | Cascade Ballroom |
| 8:30-9:45am | 101 | Care Givers: Take Care! | Jerry Bridge | 1.25 (0) | Cascade Ballroom |
| 9:45-10:15am | | Exhibit Break | | | |
| 10:15-11:30am | | Break Out Sessions | | | |
| | 102 | Going Beyond Time Management: Productivity, Well Being and Peace of Mind | Jerry Bridge | 1.25 (0) | Mt. St. Helens |
| | 103 | WORKSHOP: Beginning Suturing (limited to 30) | Mary Fey, FNP, MSN | 1.25 (0) | Morrison |
| | 104 | Poster Presentations Session 1 | Various | 1.25 (0) | Mt. Bachelor |
| | 105 | WORKSHOP: Trigger Point Injections (limited to 30) | Amanda St. John, DNP, FNP-C | 1.25 (0) | Ross Island |
| 11:30am -12:45pm | | Lunch | | | Exhibit Hall |
| 12:45-2:00pm | | Break Out Sessions | | | |
| | 106 | Coding and Billing | Carol Wintermute, ACS-EM | 1.25 (0) | Mt. St. Helens |
| | 107 | WORKSHOP: Advanced Suturing (limited to 30) | Mary Fey, FNP, MSN | 1.25 (0) | Morrison |
| | 108 | Poster Presentations Session 2 | Various | 1.25 (0) | Mt. Bachelor |
| | 109 | WORKSHOP: Splinting (limited to 30) | Kari Komlofske, FNP-C | 1.25 (0.25) | Ross Island |
| 2:00-2:25pm | | Exhibit Break | | | |
| 2:25-3:25pm | | Break Out Sessions | | | |
| | 110 | AANP Region X Update | Tracy Klein, PhD, ARNP, FNP, FAAN, FAANP | 1.0 (0) | Ross Island |
| | 111 | Impact Teen Drivers: What Do You Consider Lethal? | Kelly Browning, PhD | 1.0 (0) | Morrison |
| | 112 | Newer Agents in Diabetic Management | Rebecca Castner, PharmD, BCACP, AAHVP and Megan Viehmann, PharmD, BCACP | 1.0 (0.5) | Mt. St. Helens |
| | 113 | Hormone Replacement: Case Studies for Your Gender Diverse Population | Allison Fox, MSN, FNP | 1.0 (0.75) | Mt. Bachelor |
| 3:25-3:45pm | | Exhibitor Break | | | |
| 3:45-4:45pm | | Break Out Sessions | | | |
| | 114 | How to Balance Graduate School and Life | Patricia Cox, DNP, MPH, FNP-BC and Amber Vermeesch, PhD, MSN, FNP-C, RN, CNE | 1.0 (0) | Morrison |
| | 115 | The Weight of Talking About Weight | Lindsey Wismer, ANP-BC, WHNP-BC, RN, MSN, BSN, BS | 1.0 (0.41) | Mt. St. Helens |
| | 116 | Self-Care Using Mind-Body Medicine | Rebecca Castner, PharmD, BCACP, AAHVP | 1.0 (0) | Ross Island |
| | 117 | Buprenorphine in Primary Care | Allison Fox, MSN, FNP | 1.0 (0.41) | Mt. Bachelor |
| 4:45-5:00pm | | Exhibitor Break | | | |
| 5:00-6:00pm | | Break Out Sessions | | | |
| | 118 | Parkinson's Treatment and Other Trends | Patricia Cox, DNP, MPH, FNP-BC and Melody Rasmor, EdD, RN, ARNP-BC, COHN-S | 1.0 (0.66) | Mt. Bachelor |
| | 119 | Zebras in Primary Care | Laurel Hallock Koppelman, DNP, FNP-C, APRN | 1.0 (0) | Mt. St. Helens |
| | 120 | The Silent Epidemic of TBIs | Shauna Hahn, BA, PMHNP, CBIS | 1.0 (0.08) | Morrison |
| | 121 | Nurse Practitioners Role within Oregon Workers Compensation | Nicholas Ring and Tim Kessel | 1.0 (0) | Ross Island |

Day 3 - Friday, Oct. 12, 2018

| Time | # | Session Title | Speaker | CE (Pharm) | Room |
|-----------------|-----|--|--|-------------|------------------|
| 6:30-7:00am | | Morning Yoga Session (bring your own yoga mat) | | | Madison |
| 7:00-8:00am | | Registration / Visit Exhibits | | | |
| 8:00-8:15am | | Welcome/Announcements | | | Cascade Ballroom |
| 8:15-9:30am | 201 | Holistic Care / Integrative Health | Tal Cohen, DAOM, L.Ac., Scott Wagnon, PA-C, and May-Lynn Chu, DO | 1.25 (0) | Cascade Ballroom |
| 9:30-10:00am | | Exhibit Break | | | |
| 10:00-11:15am | | Break Out Sessions | | | |
| | 202 | WORKSHOP: Skin Biopsy Technique & Basic Suturing (limited to 40) | Eric Harmon, PA-C | 1.25 (0) | Mt. St. Helens |
| | 203 | WORKSHOP: Suture Workshop (limited to 30) | Heather Onoday, RN, MN, FNP-C | 1.25 (0.08) | Ross Island |
| | 204 | WORKSHOP: Women's Health (limited to 40) | Laurel Hallock Koppelman, DNP, FNP-C, APRN | 1.25 (0) | Morrison |
| | 205 | Stretching Your ECG Skills | Steven Wahls, MD, FAAFP | 1.25 (0.08) | Mt. Bachelor |
| 11:15 -11:30am | | Exhibit Break | | | |
| 11:30am-12:30pm | | Break Out Sessions | | | |
| | 206 | Cannabis for Opioid Reduction in Pain | Kim Dupree Jones, PhD, FNP, FAAN | 1.0 (0.41) | Mt. St. Helens |
| | 207 | Dying is Still Living: Integrative Clinical Pearls for Comforting Terminally Ill Patients and Their Families | May-Lynn Chu, DO | 1.0 (0) | Morrison |
| | 208 | Female Athlete Triad | Melissa Novak, DO | 1.0 (0.16) | Ross Island |
| | 209 | The Perfect Pelvic Exam | Jacquelyn Quetal, FNP-C | 1.0 (0) | Mt. Bachelor |
| 12:30-1:00pm | | Exhibit Break | | | |
| 1:00-3:00pm | 210 | NPO Quarterly Business Meeting | NPO Executive Board | 2.0 (0) | Cascade Ballroom |
| 3:00-3:15pm | | Exhibit Break | | | |
| 3:15-4:15pm | | Break Out Sessions | | | |
| | 211 | What To Do When Patients Don't Comply: How to Cover Yourself Legally | Carolyn Buppert, MSN, JD | 1.0 (0.16) | Mt. St. Helens |
| | 212 | Self Care through a Trauma-Informed Lens | Diane Solomon, PhD, PMHNP-BC, CNM | 1.0 (0) | Morrison |
| | 213 | The Hidden Curriculum | Madeleine Sanford, FNP | 1.0 (0) | Ross Island |
| | 214 | Oregon Medicaid: Evidence and Policy | Cat Livingston, MD, MPH | 1.0 (0) | Mt. Bachelor |
| 4:15-4:30pm | | Exhibitor Break | | | |
| 4:30-5:30pm | | Break Out Sessions | | | |
| | 215 | Risks of Treating Family or Friends | Carolyn Buppert, MSN, JD | 1.0 (0.33) | Ross Island |
| | 216 | Diabetic Foot Ulcers & Cellulitis | Brenda Ormesher, MD | 1.0 (0.25) | Mt. St. Helens |
| | 217 | Evidence Updates in the Adolescent WCC | Madeleine Sanford, FNP | 1.0 (0.66) | Mt. Bachelor |
| | 218 | Reducing Unnecessary Opioid Exposure | Paul Coelho, MD and Josh Steenstra, MBA | 1.0 (0.75) | Morrison |

Day 4 - Saturday, Oct. 13, 2018

| Time | # | Session Title | Speaker | CE (Pharm) | Room |
|-----------------|-----|---|---|------------|------------------|
| 6:30-7:00am | | Morning Yoga Session (bring your own yoga mat) | | | Madison |
| 7:00-8:00am | | Registration | | | |
| 8:00-8:15am | | Welcome/Announcements | | | Cascade Ballroom |
| 8:15-9:30am | 301 | Protecting and Managing Your Professional Identity & Digital Reputation | Barbara Phillips, APRN, GNP, FNP-BC, FAANP | 1.25 (0) | Cascade Ballroom |
| 9:30-9:45am | | Break | | | |
| 9:45-10:45am | | Break Out Sessions | | | |
| | 302 | Addressing Obesity in Primary Care | Capella Crowfoot Lapham, RN, BSN, MS, FNP-C | 1.0 (0) | Mt. Bachelor |
| | 303 | The A, B, C, D & Es of Viral Hepatitis | Terrance James, FNP | 1.0 (0.5) | Mt. St. Helens |
| | 304 | Transgender and Nonbinary Primary Care | Kelly Washburn, AGNP-C | 1.0 (0.75) | Morrison |
| | 305 | Breastmilk as Epigenetic Medium: Turning On the Right Genes | Sylvia Metzger, MPH, MSN, FNP-C, CNL, IBCLC, ANLC | 1.0 (0.33) | Ross Island |
| 10:45 -11:00am | | Break | | | |
| 11:00am-12:00pm | | Break Out Sessions | | | |
| | 306 | Basics of Medical Abortion | Mary Stark, DNP, FNP | 1.0 (0.25) | Morrison |
| | 307 | Hip Joint | Kari Komlofske, FNP-C | 1.0 (0.5) | Mt. St. Helens |
| | 308 | Diabetic Insulin Management | Kelly Washburn, AGNP-C | 1.0 (1.0) | Mt. Bachelor |
| | 309 | Is Yelling the New Spanking? | Jennifer Bevacqua, RN, MS, CPNP-AC/PC | 1.0 (0) | Ross Island |
| 12:00-1:00pm | | Lunch: NPO Sponsored Networking Event | | | Exhibit Hall |
| 1:00-2:00pm | | Break Out Sessions | | | |
| | 310 | Managing Early Pregnancy Loss | Mary Stark, DNP, FNP | 1.0 (0.16) | Morrison |
| | 311 | Strategies to Optimize Heart Failure Treatment: New Insights and Challenges | Harleen Singh, PharmD | 1.0 (0.66) | Mt. St. Helens |
| | 312 | Targeting ACES via Resilience Intervention | Amy Stoeber | 1.0 (0) | Mt. Hood |
| | 313 | A Primer on Oregon Health Policy | Diane Solomon, PhD, PMHNP-BC, CNM | 1.0 (0) | Ross Island |
| 1:00-5:00pm | 314 | PCSS MAT Buprenorphine Waiver Training | Nick Gideonse M.D. and Amanda Risser | *See Below | Mt. Bachelor |
| 2:00-2:15pm | | Break | | | |
| 2:15-3:15pm | | Break Out Sessions | | | |
| | 315 | Intro to Global Health & Travel Medicine | Ariane Rasori, RN, FNP | 1.0 (0.33) | Morrison |
| | 316 | An Anti-Inflammatory Approach to ASCVD | Scott Coon, PharmD, BCPS, BCACP | 1.0 (0.91) | Mt. St. Helens |
| | 317 | Gun Safety | Valerie Cecil, FNP and Tara O'Connor, MSN, APRN, PMHNP-BC | 1.0 (0) | Ross Island |
| | 318 | Contraception Updates and Management | Mary Stark, DNP, FNP | 1.0 (0.5) | 3 Sisters |
| 3:15-3:30pm | | Break | | | |
| 3:30-4:30pm | | Break Out Sessions | | | |
| | 319 | Clinical Radiology | Matthew Tommack, DO | 1.0 (0) | Mt. St. Helens |
| | 320 | Long-term Safety/Efficacy of MAT for OUD | Scott Coon, PharmD, BCPS, BCACP | 1.0 (0.83) | Ross Island |
| | 321 | Wound Care | Rebecca Mickel | 1.0 (0) | 3 Sisters |
| | 322 | Taking Ownership as a Profession for NP Satisfaction | Nikki LeFebvre, FNP | 1.0 (0) | Morrison |

*The PCSS MAT Buprenorphine Waiver Training session is one part of an MAT waiver training, with an online training module provided by PCSS to complete the waiver training. At the end of the 8 hour MAT waiver training for NPs through PCSS (one part at this conference and one part online), participants will receive a CE Certificate for 8.0 continuing nursing education contact hours (8.0 contact hours in pharmacology) provided by the American Psychiatric Nurses Association (APNA). **NOTE: You will have to complete both the in-person training AND the online portion to receive any CE for this session. The CE is provided by APNA, not NPO or the Oregon Nurses Association.**

The American Psychiatric Nurses Association is accredited with distinction as a provider of continuing nursing education by the American Nurses Credentialing Center's Commission on Accreditation.