

PENNSYLVANIA LIBRARY ASSOCIATION

# Annual Conference

*October 1-4, 2023*

Kalahari Resorts - Pocono Manor, PA



**RISING** TO THE **CHALLENGE!**

..... Facility Map .....

**PaLA  
Registration  
Desk D**

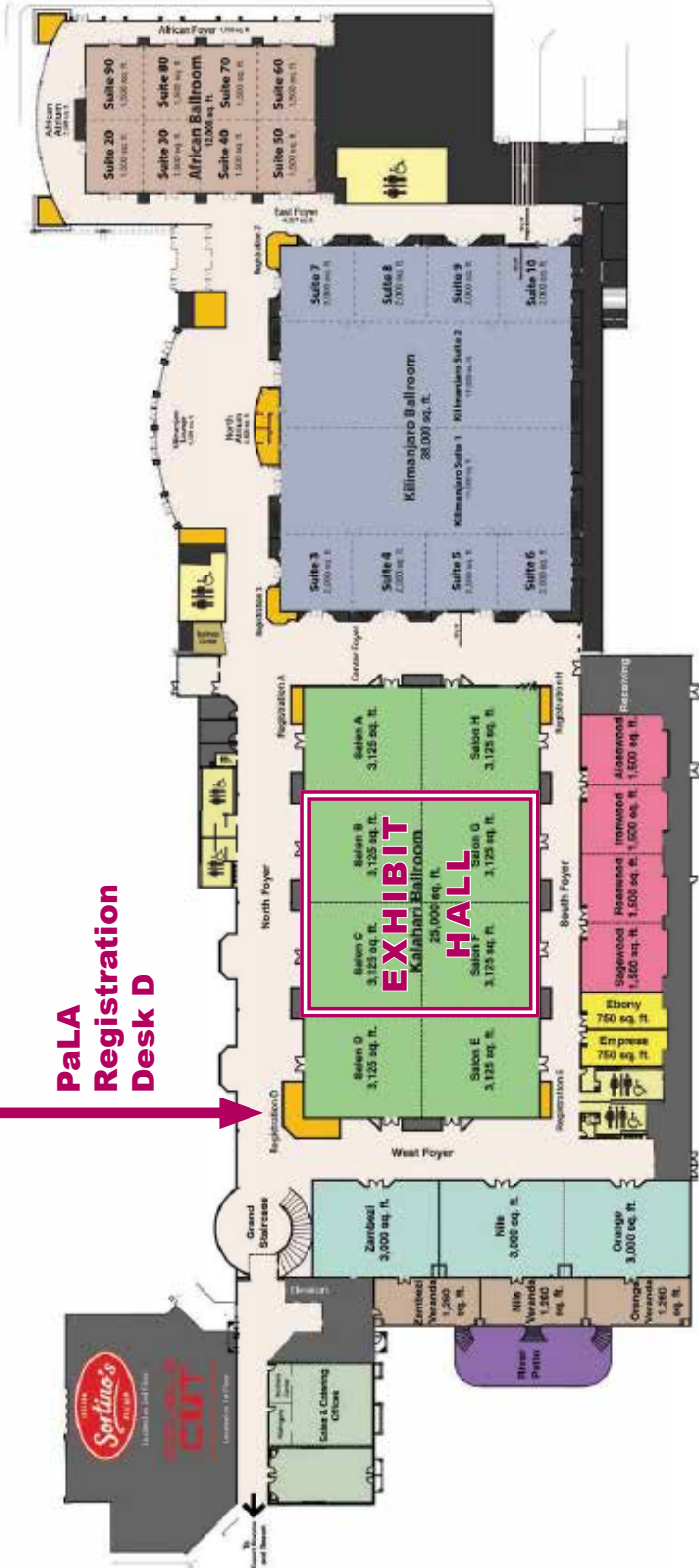



## • • • • • Contents • • • • •

- Facility Map - Inner front cover
- 2** Conference Services
- 3** Welcome
- 4** Ex Libris Society
- 5** Conference Planning Committee
- 6** Sponsors
- 7** PaLA Annual Business Meeting
- 8** Acknowledgements
- 9** PaLA Store
- 10** Continuing Education
- 11** At-A-Glance
- 16** PaLA Annual Conf. Session Evaluation
- 18** Conference Program
  - 18** Sunday, October 1
  - 23** Monday, October 2
  - 38** Tuesday, October 3
  - 52** Wednesday, October 4
- 54** Exhibit Hall Activities
- 57** Exhibitors
- 71** Exhibitors by Product
- 74** Raffle Instructions
- 76** Session Evaluation Link
- Exhibit Hall Map - Inner back cover
- Staff - Outer back cover

# ••••• Conference Services •••••

## PaLA Registration Desk

*Registration Desk D, North Foyer*

Sunday, Oct. 1 .....	8:30AM – 5:00PM
Monday, Oct. 2 .....	8:00AM – 5:00PM
Tuesday, Oct. 3 .....	8:00AM – 5:00PM
Wednesday, Oct. 4 .....	8:00AM – 12:30PM

## PaLA Store

*Exhibit Hall*

*Kalahari Ballroom, Salons B,C,F,G*

Sunday, Oct. 1 .....	Set-up
Monday, Oct. 2 .....	12:30PM – 5:30PM
Tuesday, Oct. 3 .....	9:30AM – 2:30PM
Wednesday, Oct. 4 .....	Closed

## Headshot Photography

*North Foyer*

Sunday, Oct. 1 .....	Set-up
Monday, Oct. 2 .....	12:30PM – 5:30PM
Tuesday, Oct. 3 .....	9:30AM – 2:30PM
Wednesday, Oct. 4 .....	Closed

## Local Information Table - Self Service

*North Foyer*

## Poster Sessions

*North Foyer*

Monday, Oct. 1 .....	2:15PM – 3:15PM
Tuesday, Oct. 2 .....	10:00AM – 11:00AM and 1:00PM – 2:00PM

## Exhibits

*Kalahari Ballroom, Salons B,C,F,G*

Sunday, Oct. 1 .....	Set-up
Monday, Oct. 2 .....	12:30PM – 5:30PM
Tuesday, Oct. 3 .....	9:30AM – 2:30PM
Wednesday, Oct. 4 .....	Closed

## Exhibitor Registration

*Registration Desk D, North Foyer*

Sunday, Oct. 1 .....	5:00PM – 7:00PM
Monday, Oct. 2 .....	8:00AM – 12:00PM

*\*The desk will also be staffed during exhibit hours to assist with exhibitor needs.*

## PaLA Headquarters Offices/AV Room

*Empress Boardroom*

## Badge Emblems

A blue ribbon on a badge indicates a **new** PaLA member. Please welcome them!

## Monitoring of Events

Meeting and social events will be monitored. Please wear your registration badge at all times. A registration badge or “exhibits only” pass is required for entrance to the Exhibit Hall.

## Anti-Harassment Policy

PaLA is dedicated to providing a harassment-free conference experience for everyone, regardless of gender, gender identity and expression, sexual orientation, disability, physical appearance, body size, race or religion. We do not tolerate harassment of or by conference participants in any form. Conference participants violating these rules may be sanctioned or expelled from the conference without compensation or refund of registration fees, at the discretion of the conference management.

## Smoking

Smoking is not permitted.

## Conference Evaluation Forms

**General conference evaluations** will be solicited online through Survey Monkey. The form will be available online after the conference via a link that will be emailed to all conference attendees.

## **Individual session evaluation forms**

will be collected electronically via Google forms. Look for the link on the conference mobile app. In addition, the URL and QR code will be posted at the entrance to the session rooms.

We look forward to your input! The deadline for evaluations is **October 31, 2023**.



# President's Welcome

## *Greetings & Salutations!*

It is my honor and pleasure to welcome you to the 2023 Pennsylvania Library Association Annual Conference at the beautiful Kalarahi Resorts! I am so excited to be here with you. We had such a great time in 2016 that I know 2023 is destined to be even better.

This year's conference has much to offer. There are so many interesting sessions, poster presentations, and vendor showcases. Truly, there is something for everyone. We are very appreciative of the many volunteers who created a well-rounded conference. Please join me in thanking Rose Chiocchi and her incredible committee for their dedication and thoughtfulness in planning this fantastic event. Of course, the conference could not have become a reality without the leadership and expertise of Kim Snyder-Wise. The annual conference is a huge undertaking, and we are forever grateful to all those that volunteered to help. Thank you!

A dynamic conference requires a lot of support. Vendors, sponsors, and exhibitors are vital in offering the conference and help us keep costs at bay. Make sure you stop by the exhibit hall to see the latest in library services and products and thank the vendors for attending. As a bonus, you will get a sneak peek of what is new on the horizon for libraries.

The best part of attending a conference is seeing everyone in person. Sometimes we can learn so much just from chatting with each other. I am looking forward to our Welcome Reception on Sunday from 5-6pm and there are a number of other networking opportunities scheduled throughout the week. Don't forget the chapter dine-outs, Trivia Competition, Game Night, Comedy Club, and LibCraft for Librarians. More importantly, join us for the celebration in the Waterpark on Tuesday evening while we float down the lazy river, and make sure to stop by the PaLA Cabana to say hello. I hope to see everyone there.

Our conference theme is Rising to the Challenge! The conference is a great opportunity to reflect on how we met and continue to support one and another when faced with any challenge. With every day seeming to present a new issue, it is my sincere hope the conference recharges and energizes you. Always know that your Pennsylvania Library Association friends are here to support you. **Here's to a phenomenal annual conference!**

***Cheers!***

**Melissa Rowse**

2023 President

Pennsylvania Library Association

# Ex Libris Society



## 2022 Ex Libris Donors

### FOLIO

Susan M. Banks  
Deborah J. Dorshimer  
Joseph Fennewald\*  
Mary Garm\*  
Glenn Miller\*  
Evelyn C. Minick\*  
Nancy Posel  
David G. Schappert  
M. Clare Zales\*

### QUARTO

Karen DeAngelo  
Mary Anne C. Fedrick\*  
Judy L. Keogh\*  
Rob Leshner\*  
Janis Stubbs\*

### OCTAVO

David L. Belanger\*  
Thomas Duszak  
Tina L. Hertel  
Timothy J. Salony\*  
Ann M. Snowman  
Margie Stern\*  
Denise Sticha\*  
Jennifer L. Stock  
Karla J. Trout\*  
Edward D. Wolf

### CHAPBOOK

Dana Barber  
Christi Buker  
Christine Caputo\*  
Leslie W. Christianson  
Jeanne M. Clancy\*  
Jonelle P. Darr\*  
Cindy J. Deluca  
Richard Fitzsimmons\*  
Katie Greenleaf Martin  
Karl W. Helicher\*  
James L. Hollinger\*  
Michelle L. Kehoe  
Jo Ellen Kenney\*

Carol H. Kern  
Jennifer S. Knisely  
Anny Laepple  
Dennis P. Leeper\*  
Michelle Lesniak  
Jennifer L. Long  
Alice L. Lubrecht\*  
Allison Mackley  
Mary Jane Mannherz  
Steven J. Mayover  
Ryan McCrory  
Susan K. Nenstiel

Tom Reinsfelder  
Melissa Rowse  
Patricia M. Ryan\*  
Elizabeth Schetroma  
Joseph L. Sherwood  
Jeffrey D. Swope  
Carrie Turner\*  
Leslie A. Wishard

\*Founding Member  
Updated 01/06/23

Join us: [www.palibraries.org/donations/](http://www.palibraries.org/donations/)

# ••••• Conference Planning Committee •••••



*Pictured, left to right*

**1<sup>st</sup> Row:** Rose Chiocchi and Kim Snyder Wise

**2<sup>nd</sup> Row:** Marleen Cloutier, Michele Legate, and Carrie Sturgill

**3<sup>rd</sup> Row:** Elizabeth Davis, Sheli Pratt-McHugh, and Mary Gazdik

**4<sup>th</sup> Row:** Kate Cummings and Holly Ambrose

**5<sup>th</sup> Row:** Mary Ann Lewis and Jennifer Long

**6<sup>th</sup> Row:** Claire Williams, Becky Wanamaker and Kim Gillingham

**PaLA Store:** Mary Ann Lewis, *Barrett Paradise Friendly Library* (Chair), Melissa Froah, *Corry Public Library*, Christine Nicholson, *Phoenixville Public Library*, and Catherine Stewart, *Nazareth Memorial Library*

**PaLA 2nd VP/2023 Conference Chair:** Rose Chiocchi, *Pike County Public Library*

**PaLA Staff Liason/Conference Manager:** Kim Snyder Wise, *Pennsylvania Library Association*

**Administrative Support:** Nicole Heyer, *Pike County Public Library*

**Education/Programming:** Kate Cummings, *University of Scranton* (Chair), Holly Ambrose, *Bucks County Free Library*, Mary Gazdik, *Chester County Library & District Center*, Karl Rebon, *Reynoldsville Public Library*, Becky Wanamaker, *Reading Library District*, and Elin Woods, *University of Scranton*

**Exhibits:** Vince Mariner, *HSLC* (Chair), Mary Gazdik, *Chester County Library & District Center*, Roane Lytle, *Williamsburg Public Library*, and Carrie Sturgill, *Radnor Memorial Library*

**Fundraising/Sponsorship:** Carrie Sturgill, *Radnor Memorial Library* (Chair), Anny Laepple, *Delaware County Library System*, Lauren Smyth, *Upper Dublin Public Library*, and Leigh-Anne Yacovelli, *Franklin Institute*

**Local Authors:** Karl Rebon, *Reynoldsville Public Library* (Chair), Amanda Boyer, *Susquehanna University*, and Amber Kennedy, *Margaret R. Grundy Memorial Library*

**Local Information/Tours:** Martina Soden, *Scranton Public Library* (Chair), Michele Legate, *Northeast District*, Alyssa Loney, *Scranton Public Library*, and Sheli Pratt-McHugh, *University of Scranton*

**Poster Sessions:** Jessica Miller, *Cleve J. Fredricksen Library* (Chair), Amanda Boyer, *Susquehanna University*, Jennifer Long, *Easton Area Public Library*, and Denise Wetzal, *Penn State University Libraries*

**Publicity:** Kim Gillingham, *Perkiomen Valley Library* (Chair), Debbie Jack, *Lower Macungie Library*, Christine Nicholson, *Phoenixville Public Library*, and Sheli Pratt-McHugh, *University of Scranton*

**Registration:** Kristin Smith, *Scottdale Public Library* (Chair), Elizabeth Davis, *PaLS*, Nicole Heyer, *Pike County Public Library*, Jennifer Long, *Easton Area Public Library*, and Gretchen Stallone, *Margaret R. Grundy Memorial Library*

**Signage:** Claire Williams, *Huntingdon County Library* (Chair), Melissa Froah, *Corry Public Library*, and Becky Wanamaker, *Reading Library District*

**Special Events:** Michele Legate, *Northeast District* (Chair), Lauren Smyth, *Upper Dublin Public Library*, Martina Soden, *Scranton Public Library*, and Elin Woods, *University of Scranton*

**Technical Arrangements:** Marleen Cloutier, *University of Scranton* (Chair), Melisa Gallo, *University of Scranton*, Barb Mitchell, *Cambria County Library System*, Sylvia Orner, *University of Scranton*, Claire Williams, *Huntingdon County Library*, and Leigh-Anne Yacovelli, *Franklin Institute*, Becky Wanamaker, *Reading Library District*

**Volunteer Coordinator:** Anny Laepple, *Delaware County Library System* (Chair)

## ••••• Thank You, Sponsors •••••

The Pennsylvania Library Association would like to acknowledge and thank the following companies and organizations who have generously provided financial support for this year's conference.

### Diamond Sponsors

#### **EBSCO Information Services**

Opening Keynote Session  
[www.ebsco.com](http://www.ebsco.com)

#### **Pennsylvania Integrated Library System (PaILS)**

Welcome Reception and  
Badge Lanyards  
[www.sparkpa.org](http://www.sparkpa.org)

### Gold Sponsors

#### **Association of Pennsylvania Public Libraries (APPLS)**

Public Library Division Luncheon  
[www.theappls.com](http://www.theappls.com)

#### **Hosting Solutions & Library Consulting (HSLC)**

Conference Tote Bags  
[www.hslc.org](http://www.hslc.org)

#### **Pennsylvania Citizens for Better Libraries (PCBL)**

Exhibits Grand Opening Lunch  
<https://pcbipa.org/>

#### **Penn State University Libraries**

College and Research Division  
Luncheon  
<https://libraries.psu.edu/>

#### **Lackawanna County Library System**

Carolyn W. Field Award Luncheon  
<https://lclshome.org/>

### Silver Sponsors

#### **Brainfuse**

Coffee/Refreshment Break  
<https://home.brainfuse.com/>

#### **Lehigh Valley Library System**

The public libraries of Allentown,  
Bethlehem, and Easton  
Comedy Club  
<https://lehighvalleyalive.com/business/libraries.cfm>

#### **Library of Congress**

#### **Federal Credit Union**

Registration Packet Insert  
<https://www.lcfcu.org/home/home>

#### **Midwest Tape/hoopla Digital**

Coffee/Refreshment Break  
[www.midwesttape.com](http://www.midwesttape.com)

#### **Old Dominion University**

Coffee/Refreshment Break  
<https://ww1.odu.edu/eps/departments/stemps/academics/library-science/mlis>

### Bronze Sponsors

#### **PA Humanities**

Humanities in Action Award  
<https://pahumanities.org/>

Thank You!

••••• Pennsylvania Library Association •••••  
Annual Business Meeting

Tuesday, October 10, 2023

1:00PM – 2:15PM

- Join us online for this annual meeting of the PaLA membership. Hear reports from our leaders on program successes and accomplishments
- Meet and congratulate the Distinguished Service Award, and Library of the Year Award winners
- Meet the 2024 Board of Directors and learn about the organization's vision for the coming year

Register to attend at:

<https://www.palibraries.org/event/PaLA2023AnnBizMtg>

Take 30% off when you order online @ [tupress.temple.edu](http://tupress.temple.edu)

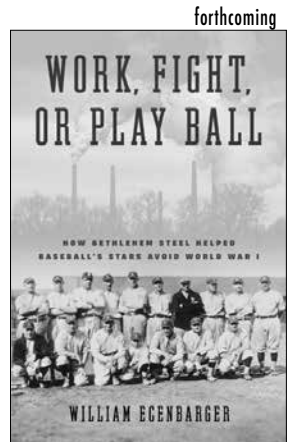
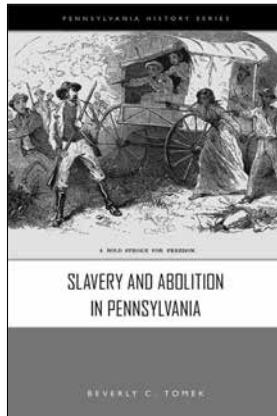

Enter promo code: TLIB23 for discount • expires 11/30/2023

Applies to all our Philadelphia and Regional titles



## ••••• Acknowledgements •••••

The Pennsylvania Library Association would like to thank the following groups who have provided support for coffee and refreshment breaks during the conference. The informal networking opportunities provided by these breaks are excellent vehicles for idea-sharing and relationship-building among librarians and are an important element of a successful conference experience.

### **Thank you for being a Friend!**

**Friends of the Abington Community Library**  
**Friends of the Altoona Area Public Library**  
**Friends of the Bangor Public Library**  
**Friends of the Bosler Memorial Library**  
**Friends of the Bowlby Public Library**  
**Friends of Clymer Library**  
**Friends of Easton Area Public Library**  
**Friends of the Elizabethville Library**  
**Friends of Joseph T. Simpson Public Library**  
**Friends of Lower Macungie Library**  
**Friends of the Martinsburg Community Library**  
**Friends of Monroeville Public Library**  
**Friends of the Mt. Lebanon Public Library**  
**Friends of the Osterhout Free Library**  
**Friends of the Pike County Public Library**  
**Friends of the Pittston Memorial Library**  
**Pocono Mountain Public Library Trustees**  
**Friends of the Red Land Community Library**  
**Friends of Scranton Public Library**  
**Friends of the Springfield Library**  
**Friends of the Upper Dublin Library**  
**Friends of the Valley Community Library**  
**Friends of the Village Library**  
**Friends of Wayne County Public Library**  
**Friends of the Western Pocono Community Library**  
**Friends of the Wissahickon Valley Public Library**  
**Friends of Yeadon Public Library**

### **Coffee and Conversation Sponsors!**

**The College and Research Division (CRD) of Pennsylvania Library Association**  
**University of Scranton**  
**Scranton Public Library**  
**Juniata Conemaugh Chapter of Pennsylvania Library Association**  
**Southeast (SEPLA) Chapter of Pennsylvania Library Association**  
**West Branch Chapter of Pennsylvania Library Association**

••••• Shop the PaLA Store! •••••



**Created** for Librarians,

**Stocked** by Librarians,

and **Run** by Librarians!

**LOCATION!**

**LOCATION!**

**LOCATION!**



Eyeglass Holder Necklaces



Crochet Necklaces

The PaLA Store is now located in the exhibit hall for more visibility!

Open during exhibit hours on Monday & Tuesday.

**Featuring:**  
some classic favorites and new additions.

**Check us out!**

**Pennsylvania Library Association  
Book Inventory Source & Partner:**



[www.midtownscholar.com](http://www.midtownscholar.com)  
1302 N. Third Street  
Harrisburg, PA 17102

## ••••• Continuing Education •••••

### Act 48 and PaLA

PaLA is pleased to announce that twenty-six (26) conference sessions meet the requirements for Act 48 credit. Consult the conference program book for those programs identified with the Act 48 label.



**What is Act 48?** Act 48 of 1999 requires those holding Pennsylvania professional educator certification to complete 180 continuing education requirements every five years in order to maintain their certification. This law applies to those with certification as school librarians, classroom teachers, and school administrators.

The Act 48 database does not accept workshop or conference activities that award less than three Act 48 credits. If you attend the conference, be sure to attend at least three sessions that qualify for Act 48 credit. You may earn more than three credits, but the minimum is three.

**What do you need to do if you need Act 48 credit?** Consult your conference booklet for the sessions approved for Act 48 credit, collect the special voucher at the end of the session, take at least three vouchers earned to the Act 48 table at the end of the conference, and sign the credit sheet, using your PDE-selected professional personnel identification number. Credit will be entered in the state database by January of next year.

### Continuing Education

Please note that all PaLA Conference sessions, with the exception of the meetings, exhibit activities, and social events, meet the state's requirements for continuing education for public librarians and staff. Vouchers will be distributed at the conclusion of each session and should be collected until the end of your conference attendance. Simply turn in your collected vouchers at the Registration Desk and sign the CE sheet to receive your CE certificate via email noting the number of credit hours you have earned during the conference. (Also available onsite by request) If you have any questions about the requirements, please contact the District Consultant for your area.

### LSTA Funding Acknowledgment

Some conference programs were made possible by a grant from the U.S. Institute of Museum and Library Services as administered by the Pennsylvania Department of Education through the Office of Commonwealth Libraries and the Commonwealth of Pennsylvania, Josh Shapiro, Governor.

••••• **Session/Event At-A-Glance** •••••

**SUNDAY, OCTOBER 1**

**10:00 AM - 12:00 PM**

Meeting • **Governors Advisory Council (GAC) Meeting** • *Zambezi*

**12:30 PM - 1:30 PM**

Networking • **Refreshment Break** • *West Foyer*

**1:00 PM - 2:00 PM**

Career & Leadership • **GAC Open Forum** • *Zambezi*

Community Service & Engagement • **What does Outreach look like in Academic Libraries?** • *Sagewood*

Youth Services • **Baby & Toddler Storytime** • *Rosewood*

Technology & Education • **Maker Labs - Beyond Glitter Glue** • *Kilimanjaro 5/6*

Contemporary Issues • **Out Here! Presenting LGBTQIA+ Voices in Rural PA** • *Ironwood/Aloeswood*

**1:00 PM - 3:15 PM**

Community Service & Engagement • **Adult Author Panel: Cover Your Eyes Chillers & Thrillers** • *Orange*

**2:15 PM - 3:15 PM**

Collections • **Collection Development Policies and You: A Conversation** • *Zambezi*

Youth Services • **Cooking Across Cultures** • *Rosewood*

**2:15 PM - 3:15 PM** *continued*

Advocacy & Development • **Low or No Budget Marketing** • *Ironwood/Aloeswood*

Career & Leadership • **The Other Side of the Table: Library Staff Serving as Board Members** • *Sagewood*

Community Service & Engagement • **Beyond The Facts: Engaging Adult Programming** • *Kilimanjaro 5/6*

**3:30 PM - 4:45 PM**

Contemporary Issues • **Opening Keynote: Tools and Tactics for Change** • *Salon D/E*

**5:00 PM - 6:00 PM**

Networking • **Welcome Reception** • *Nile/Orange*

**6:00 PM - 8:00 PM**

Networking • **Chapter Dine Outs** • *Local Restaurants*

**8:00 PM - 9:30 PM**

Networking • **Trivia Competition** • *Nile/Orange*

Contemporary Issues • **Out Here!: LGBTQ Stories Documentary Film Showing** • *Zambezi*

## MONDAY, OCTOBER 2

**8:00 AM - 8:45 AM**

Networking • **Coffee & Un-Conference Conversations** • *Nile/Orange*

Meeting • **Technical Services Round Table Business Meeting** • *Rosewood*

**9:00 AM - 10:00 AM**

Community Service & Engagement • **A Heist in the Stacks: Tabletop Gaming Events** • *Ironwood/Aloeswood*

Youth Services • **Creative Connections between Performance, Visual Arts, and the Library Community** • *Sagewood*

Career & Leadership • **Board Blunders** • *Salon D*

Contemporary Issues • **Rising to the Challenge: Exposing Extremist Tactics to Defend Intellectual Freedom** • *Salon E*

Community Service & Engagement • **The “Heart” of Our Communities: Community Hubs** • *Zambezi*

**10:15 AM - 11:15 AM**

Technology & Education • **Data Literacy for Information Professionals** • *Ironwood/Aloeswood*

Community Service & Engagement • **Striving to Meet Special Needs Populations** • *Zambezi*

**10:15 AM - 11:15 AM** *continued*

Youth Services • **2023 Best Practices Awards** • *Sagewood*

Advocacy & Development • **Sustainable Strategies for Advocacy & Development** • *Salon E*

**10:15 AM - 12:30 PM**

Library Administration • **They did WHAT? Complicated HR Matters** • *Salon D*

Contemporary Issues • **Beyond Equal Access: Identifying Equitable and Inclusive Library Practices** • *Rosewood*

**11:30 AM - 12:30 PM**

Technology & Education • **A Beginner’s Practical Guide to Textual Analysis Research** • *Sagewood*

Advocacy & Development • **Assessing Your Library’s Capital Campaign Capacity** • *Zambezi*

Youth Services • **Young Adult Author Panel: Pride on the Pages** • *Salon E*

**12:30 PM - 5:30 PM**

Exhibits • **Library Products & Services Expo** • *Salons B,C,F,G*

**12:30 PM - 2:00 PM**

Exhibits • **Exhibits Grand Opening Lunch** • *Salons B,C,F,G*

**12:45 PM - 2:15 PM**

Youth Services • **Carolyn W. Field Award Luncheon** • *Nile/Orange*

**12:45 PM - 2:15 PM** *continued*

Contemporary Issues • **CRD Luncheon - Facing a Troubled Library Landscape: More Compassionate & Empathetic Library Work for All** • *Ironwood/Aloeswood*

**2:15 PM - 3:15 PM**

Networking • **No-Conflict Exhibit Time & Refreshment Break** • *Salons B,C,F,G*

Networking • **Poster Presentations** • *North Foyer*

**2:25 PM - 2:45 PM**

Exhibitor Showcase • **Medicare Fraud Prevention** • *Sagewood*

Exhibitor Showcase • **SPARK and AccessPA integrate to make ILLs easier!** • *Salon E*

Exhibitor Showcase • **Future-Proof Your Library** • *Rosewood*

**2:50 PM - 3:10 PM**

Exhibitor Showcase • **Sales Tax: What is It and Why Do Libraries and Friends Groups Have To Pay It?** • *Sagewood*

Exhibitor Showcase • **Partner with HSLC to Strengthen Your Library!** • *Rosewood*

Exhibitor Showcase • **Patron Engagement: Increase Your Visibility and Attract New Users** • *Salon E*

**3:30 PM - 4:30 PM**

Technology & Education • **Understanding Student Perception of LibGuides and LibAnswers FAQ Design and Content** • *Sagewood*

Career & Leadership • **I've Taken Diversity 101 Six Times, Now What?** • *Rosewood*

Contemporary Issues • **Brooklyn Public Library's Books Unbanned** • *Salon E*

Library Administration • **Achieving Success with a Solid Strategic Plan** • *Ironwood/Aloeswood*

Community Service & Engagement • **Mister Rogers' Lessons for Libraries** • *Zambezi*

Community Service & Engagement • **The Library After Dark: Expanding Community Reach** • *Salon D*

**4:30 PM - 5:30 PM**

Exhibits • **Visit the Exhibits** • *Salons B,C,F,G*

**5:00 PM - 5:30 PM**

Exhibits • **Raffle Prize Drawings** • *Salons B,C,F,G*

**5:30 PM - 6:00 PM**

Meeting • **Public Library Division Business Meeting** • *Ironwood/Aloeswood*

**5:30 PM - 6:30 PM**

Meeting • **PA Black Librarians  
Caucus General Membership Meeting**  
• *Sagewood*

**5:30 PM - 7:30 PM**

Networking • **Dinner on Your Own** •  
*Local Restaurants*

Meeting • **TL&T Round Table Business  
Meeting & Dine Out** • *Sortino's*

Networking • **Youth Services Division  
Dine Out** • *Cinco Ninos*

**7:30 PM - 9:00 PM**

Networking • **Comedy Club: Because  
Laughter is Good for the Soul!** • *Nile/  
Orange*

Networking • **Game Night** • *Ironwood/  
Aloeswood*

## **TUESDAY, OCTOBER 3**

**8:00 AM - 8:45 AM**

Networking • **SPARK & Friends Break-  
fast** • *Aloeswood*

Networking • **Coffee & Un-Conference  
Conversations** • *Nile/Orange*

**9:00 AM - 10:00 AM**

Collections • **Picture Book Neighbor-  
hoods** • *Sagewood*

Contemporary Issues • **Help! Inclusion  
is Important, But How Do I Actually  
Improve My Library?** • *Zambezi*

**9:00 AM - 10:00 AM** *continued*

Contemporary Issues • **De-Escalation  
Tips & Techniques** • *Salon D*

Community Service & Engagement •  
**Twenty First Century Teens** •  
*Rosewood*

Advocacy & Development • **How to Get  
Your Board to Fundraise** • *Salon E*

**9:30 AM - 2:30 PM**

Exhibits • **Library Products & Services  
Expo** • *Salons B,C,F,G*

**10:00 AM - 11:00 AM**

Exhibits • **No-Conflict Exhibit Time &  
Coffee Break** • *Salons B,C,F,G*

Networking • **Poster Presentations** •  
*North Foyer*

**10:10 AM - 10:30 AM**

Exhibitor Showcase • **Ten ways to rise  
to the challenges of Visibility and  
Engagement** • *Sagewood*

Exhibitor Showcase • **Out-of-the-Box  
Coding Clubs with Fiero Code** •  
*Salon E*

Exhibitor Showcase • **Digital Dish** •  
*Rosewood*

**10:35 AM - 10:55 AM**

Exhibitor Showcase • **Reading  
Programs that Actually Work** • *Salon E*

Exhibitor Showcase • **Small Games of  
Chance** • *Rosewood*

**10:35 AM - 10:55 AM** *continued*  
Exhibitor Showcase • **Expand Health Literacy with ConnectWell** • *Sagewood*

**11:15 AM - 12:15 PM**  
Technology & Education • **20 Tech Tools that Transform** • *Zambezi*

Community Service & Engagement • **Out of the Wreckage: Response to a Community Disaster** • *Rosewood*

Youth Services • **The Power of Jewish Children's Stories in Your Library** • *Sagewood*

Community Service & Engagement • **Serving Those Who Served** • *Ironwood*

Contemporary Issues • **Unite Against Book Bans** • *Salon D*

Library Administration • **Facilities 101: A Successful Maintenance Plan** • *Salon E*

**12:30 PM - 2:00 PM**  
Career & Leadership • **Public Library Division Luncheon: Learning to Break the Ice for Meaningful Interactions** • *Nile/Orange*

Exhibits • **Exhibit Hall "Strolling" Lunch** • *Salons B,C,F,G*

**1:00 PM - 2:00 PM**  
Networking • **Poster Sessions** • *North Foyer*

**2:00 PM - 2:30 PM**  
Exhibits • **Raffle Prize Drawings** • *Salons B,C,F,G*

**2:30 PM - 3:30 PM**  
Contemporary Issues • **Epistemic Vaccination: Inoculation Theory & Misinformation** • *Salon E*

Community Service & Engagement • **2023 PA Forward® Adult Literacy Programming Awards** • *Ironwood*

Advocacy & Development • **Do I Have to? Strategies for Cultivating Municipal Support** • *Zambezi*

Technology & Education • **Discover How To Increase Patron Engagement With Technology** • *Salon D*

**2:30 PM - 4:45 PM**  
Library Administration • **Recruiting and Retaining Diverse Talent** • *Sagewood*

Youth Services • **Brainstorm!: Architecture to Incorporate All the Letters of STEM** • *Rosewood*

**3:00 PM - 5:00 PM**  
Networking • **Guided Walk at the Hauser Nature Center at Long Pond** • *Hauser Nature Center*

**3:45 PM - 4:45 PM**  
Advocacy & Development • **The State Aid Formula: Preparing for the Future by Understanding the Past** • *Zambezi*

Youth Services • **Empowering Young People through Multicultural Literature!** • *Salon D*

**3:45 PM - 4:45 PM** *continued*  
Contemporary Issues • **Improving Town  
& Gown Relations with a Social Justice Book Club** • *Ironwood*

Community Service & Engagement •  
**Compassionate Computer Help** •  
*Salon E*

**5:00 PM - 6:00 PM**  
Networking • **Ex Libris Reception** •  
*Aloeswood*

**5:00 PM - 7:30 PM**  
Networking • **Dinner on Your Own** •  
*Local Restaurants*

**5:00 PM - 8:00 PM**  
Networking • **Explore the Waterpark!** •  
*Waterpark*

**7:30 PM - 9:00 PM**  
Networking • **LibCraft for Librarians!**  
• *Nile/Orange*

## **WEDNESDAY, OCTOBER 4**

**8:00 AM - 8:45 AM**  
Networking • **Coffee & Un-Conference  
Discussions** • *Zambezi/Nile/Orange*

**9:00 AM - 10:00 AM**  
Collections • **Hidden Histories: Digi-  
tizing the Black History and Visual  
Culture Collection** • *Ironwood*

Contemporary Issues • **Wait, What?!  
We Need More Than Diverse Books?** •  
*Rosewood*

**9:00 AM - 10:00 AM** *continued*  
Youth Services • **Pop-Up: School Bulletin Boards** • *Sagewood*

Library Administration • **"Right to Know"  
and Pennsylvania Public Libraries** •  
*Salon D*

Collections • **Beyond The Reluctant  
Reader: Building A Graphic Novel  
Collection** • *Salon E*

Technology & Education • **Caring for the  
Family Tree: Helping Patrons Select-  
Genealogy Software** • *Aloeswood*

**10:30 AM - 12:00 PM**  
Community Service & Engagement •  
**Closing Session: *The Good Left  
Undone* with Adriana Trigiani** •  
*Zambezi/Nile/Orange*

## **PaLA Annual Conference Session Evaluation**

**Let us know how they did!** Please  
take a few minutes to share your  
thoughts on the sessions  
you attended.

<https://forms.gle/VtTdycxTnhNMREkG6>

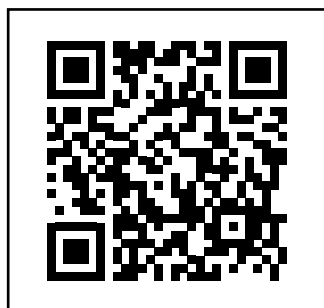

[www.assabetinteractive.com](http://www.assabetinteractive.com)

**Get 1 month free  
on your first  
year with our  
software.\***

Yes,  
and.

**Event Calendar  
with Registration**

**Meeting & Study  
Room Booking**

**Museum Pass  
Reservations**

**Library of Things**

All our modules for public library websites are easy and intuitive to use—for both patrons and staff. Stop by our booth or visit our website and request a demo today.

*\* Offer good until 11/30/23. If your library is already an Assabet subscriber, we'll apply the free month to any new module you add.*

# SUNDAY, OCTOBER 1

Registration Desk, Registration D, North Foyer .....	8:30 AM – 5:00 PM
Local Information Table, North Foyer .....	Self-service
Exhibit Hall, Kalahari Ballroom .....	Closed for set-up
PaLA Store, located in the exhibit hall .....	Closed for set-up

## 10:00 AM – 12:00 PM

*Zambezi*

### **Governor's Advisory Council Meeting**

Mary Garm, *Chair, GAC*

GAC Members

The Governor's Advisory Council (GAC) on Library Development, established by the Public Library Code, advises and makes recommendations to the Governor, the Secretary of Education and the Deputy Secretary for Libraries regarding the State Library of Pennsylvania's policies and operations as well as Pennsylvania's system of aid to libraries. Regular meetings are open to the public.

## 12:30 PM – 1:30 PM

*West Foyer*

### **Refreshment Break**

Grab a cold beverage before sessions begin, compliments of Library Friends Groups from across the state.

**Sponsored by:** Juniata Conemaugh, Southeast (SEPLA) & West Branch Chapters

## 1:00 PM – 2:00 PM

*Zambezi*

### **Governors Advisory Council on Library Development Open Forum**

Mary Garm, *Chair, GAC*

David Belanger, *Vice Chair, GAC*

Allison Mackley, *Executive Committee, GAC*

Susan Banks, *Deputy Secretary, Commissioner for Libraries, and State Librarian, Office of Commonwealth Libraries, Ex Officio Governors Advisory Council on Library Development*

Meet the members of the Governors Advisory Council on Library Development. Hear updates about the work of Council and its committees. Attendees will have opportunities to share feedback and ask questions.

*Sagewood*

## What Does Outreach Look Like in Academic Libraries?

Cori Biddle, *Student Engagement and Outreach Librarian, Penn State Altoona*

What counts as outreach at academic libraries? How does it differ from other efforts? This session will report on a 2022 survey sent to libraries nationwide and will allow attendees to share how their approach compares with the findings and consider the impact of outreach on their campus communities.

*Rosewood*

## Baby & Toddler Storytime - Serious Business, Not Just Child's Play!

Kimberly Garrison, *Project Coordinator, Read, Baby, Read!*

Sunita Balija, *Children's Librarian, Free Library of Philadelphia*

Christine Caputo, *Chief of Youth Services, Free Library of Philadelphia*



With a Diversity, Equity, and Inclusion (DEI) lens, the Free Library of Philadelphia will share best practices and skills to pump up your baby and toddler programs based on the success of the Read, Baby, Read initiative!

*Kilimanjaro 5/6*

## Maker Labs - Beyond Glitter Glue

Alan Rader, *Assistant Director Monroeville Public Library*

Learn how a Library retooled a MakerLab to meet community interests.



*Ironwood/Aloeswood*

## Out Here! Presenting LGBTQIA+ Voices in Rural Pennsylvania

Lea Chisum, *System Administrator, Library System of Bradford County*

Heather Manchester, *Director, Sayre Public Library*

Carla Salsman, *Bradford County Regional Arts Council Programming Director*

Stefan Proost, *Bradford County Regional Arts Council Marketing Director and Filmmaker*

The Library System of Bradford County and the Bradford County Regional Arts Council reflect on the partnership that led to an original film giving voice to the LGBTQIA+ experience in rural Pennsylvania. Attendees will hear from the cinematographer and architects of the film and view a trailer of the film.

*Orange***Adult Author Panel: Cover Your Eyes Chillers and Thrillers***Riley Sager, Author**Jason Rekulak, Author**Erin Adams, Author*

Hear what this panel of best-selling “chiller & thriller” authors has to say about their works and how they come up with story ideas to excite and surprise readers.

**2:15 PM – 3:15 PM**

*Zambezi***Collection Development Policies and You: A Conversation***Dr. Cathi Fuhrman, School Librarian, State College Area High School**Jonathan Moore, Cataloger, Wyomissing Public Library**Denise Sticha, Executive Director, Centre County Library and Historical Museum and Co-Director of the Centre County Federation of Public Libraries**Sylvia Orner, Collections & Resource Management Librarian, University of Scranton**Marycatherine McGarvey, Director, Free Library of Springfield Township*

A facilitated discussion between librarians from public, academic, and school libraries. We will discuss the importance of a good collection development policy, and the basic elements that should be included. We will also explore situations where challenges may arise and best practices for keeping your collection development policy current and relevant.

*Rosewood***Cooking Across Cultures***Elaine Volpe, Head of Youth Services, Bethel Park Public Library**Nancy Martin, Youth Services Librarian, Bethel Park Public Library*

What's cookin' at your library? Is it thyme to offer something new? Have you been wanting to spice things up a bit in the Children's Department? If so, have we got a class for you! Cooking Across Cultures combines literature, recipes, and multicultural education to engage children of all ages.

*Ironwood/Aloeswood***Low or No Budget Marketing***Leslie A Wishard, Green Free Library Director & Potter Tioga Library System Administrator**Ryan McCrory, Director at the Littitz Public Library**Melissa Froah, Director, Corry Public Library**Justine Yeager, Library Director, North Pocono Public Library**Barb Mitchell, County Coordinator, Cambria County Library System*

A panel will discuss engaging and informative PR strategies for libraries of all sizes, using little or no budget. Once back in their own libraries, attendees will be able to easily replicate and/or modify these ideas for their own use.

*Sagewood***The Other Side of the Table: Library Staff Serving as Board Members***Robyn E. Vittek, Director, Mt. Lebanon Public Library**Janine Strohm, Director, Rebecca M. Arthurs Memorial Library**Rob Leshner, PA Foward® Program Manager, Pennsylvania Library Association*

A panel of library workers will share their experience of serving on other organization's boards and explain what they learned and how it helped their libraries become a bigger part of their communities.

*Kilamanjaro 5/6***Beyond The Facts: Delivering Engaging Adult Programming***Jessica L. Stefano, Branch Manager/Librarian, Erie County Public Library*

Engaging adult programming takes participants beyond the facts to the heart of the matter - and the heart of the patron! Join us for this session where we will identify the components of an engaging adult program on almost any topic, define a framework for planning and delivering programs that inspire, entertain, and inform adults in our community, and learn how to create lasting connections between adults and their community library.

**3:30 PM – 4:45 PM***Salon D/E***Opening Keynote: We're Gonna Win! Tools and Tactics for Change***Emily Drabinski, President, American Library Association (ALA); Associate Professor, Queens College Graduate School of Library and Information Studies*

ALA President, Emily Drabinski will share insights from library workers organizing around the country to solve problems for themselves and their communities. Union victories in Lansing, Michigan, legislative action in Boise, Idaho, community activism in St. Tammany Parish, Louisiana, and other big wins remind us what's possible when we work together.

**Sponsored by: EBSCO Information Services**

**5:00 PM – 6:00 PM**

*Nile/Orange*

**Welcome Reception**

All conference participants are invited to network and learn more about association activities at this informal, “getting to know you” event. Light hors d’oeuvres and a cash bar will be available.

**Sponsored by: Pennsylvania Integrated Library System (PaILS)**

**6:00 PM – 8:00 PM**

*Area Restaurants*

**Chapter Dine Outs**

Join your fellow chapter members for some informal networking and fun as you share a meal at a Kalahari or other local restaurant.

*\*Pre-registration required.*

**8:00 PM – 9:30 PM**

*Nile/Orange*

**PaLA Trivia Competition**

Test your trivia skills against your colleagues from across the state at the 11<sup>th</sup> Annual Trivia Competition! Proceeds benefit the David J. Roberts EXCEL Award Fund.

*\*Additional registration fee required.*

*Zambezi*

**Out Here!: LGBTQ Stories from Bradford County Documentary Film Showing**

Out Here! is an original all-local film created by the Bradford County Regional Arts Council in partnership with the Library System of Bradford County and Sayre Public Library. Ten unique and diverse stories are told in personal narrative form accompanied by original local music and scenery of the area. Stories include dealing with a parent when coming out, coming out later in life, guiding a young adult through their emergence as trans, exploring non-binary and other identities, and so much more.

*\*Additional registration fee required.*



# MONDAY, OCTOBER 2

Registration Desk, Registration D, North Foyer .....	8:00 AM – 5:00 PM
Local Information Table, North Foyer .....	Self-service
Exhibit Hall, Kalahari Ballroom .....	12:30 PM – 5:30 PM
PaLA Store, Located in the exhibit hall .....	12:30 PM – 5:30 PM
Poster Sessions, North Foyer .....	2:15 PM – 3:15 PM

## 8:00 AM – 8:45 AM

*Rosewood*

### Technical Services Round Table Business Meeting

---

*Nile/Orange*

### Coffee & Un-Conference Conversations

Start your day with a light breakfast and conversation with fellow attendees about the previous day's sessions.

**Sponsored by: College & Research Division**

## 9:00 AM – 10:00 AM

*Ironwood/Aloeswood*

### A Heist in the Stacks: Tabletop Gaming Events with One-Page RPGs

*Kristin E. C. Green, Reference and Instruction Librarian, Penn State Scranton*

*Molly Abdalla, Student Engagement & Outreach Librarian, Penn State Wilkes-Barre*

Interested in hosting tabletop gaming events at your library but not sure how? This session details the conception, planning, marketing, and assessment of a tabletop gaming event centered around the one-page RPG, Honey Heist, at an academic library. Librarians at all types of libraries will find this session beneficial.

---

*Sagewood*

### Creative Connections between Performance, Visual Arts, and the Library Community

*Kate Coluccio, Library Director, Carnegie Free Library of Swissvale*

*Susan Pearlstein, Library volunteer and music committee member; Performer, Slagle Rock & Sue. Former board member at a nearby library.*

*Eric Slagle, Music committee member; Performer, Slagle Rock & Sue.*

Swissvale Library volunteer artist and musicians will share how and why to have live music, participatory art projects and artist shows in your library.

*Salon D***Board Blunders: Well Meaning Mistakes Board Members Make and Best Practices to Address Them**Debra Thompson, *President, Strategy Solutions*

We all want to be the board members who have “exemplary performance,” don’t we? However, we sometimes don’t know what we don’t know when it comes to board performance. Learn how to avoid the “board blunders,” well intentioned behavior that results in poor performance.

*Salon E***Rising to the Challenge: Exposing Extremist Tactics to Defend Intellectual Freedom**Joel Burkholder, *Reference and Instruction Librarian, Penn State York*Russell Hall, *Reference and Instruction Librarian, Penn State Erie*Kat Phillips, *Nursing & Allied Health Librarian, Penn State University Park*

Extremist groups claim librarians are “grooming” children by providing materials that corrupt innocence. Coordinating online, such groups push bans on materials they find objectionable. This presentation will demonstrate how to research these groups, their connections, and their rhetoric. Proactively exposing these tactics can educate your community and fight book bans.

*Zambezi***The “Heart” of Our Communities: Small Rural Libraries as Community Hubs**Kristina Russo, *Library Director, Newfoundland Area Public Library*Lynn Scramuzza, *Library Director, Hamlin Community Library*Mikki Uzupes, *Community Network Specialist, Wayne Tomorrow!*

Two rural PA libraries will discuss their community hub initiatives in conjunction with the county-sponsored group Wayne Tomorrow! The presenters will explain what a community hub is, how libraries fit this role, why becoming a community hub helps with advocacy, and the struggles and successes of the endeavor so far.

**10:15 AM – 11:15 AM***Ironwood/Aloeswood***Data Literacy for Information Professionals**Kate Cummings, *Research & Instruction Librarian for Business, University of Scranton*Sylvia Orner, *Collections & Resource Management Librarian, University of Scranton*

In this presentation, we will discuss the basic tenets of data literacy and why it is so valuable in today’s data driven world. We will also highlight ways in which data literacy can be taught to students or otherwise incorporated into information literacy sessions.

Zambezi

**Striving to Meet Special Needs Populations: Opening the Accessibility to All**

Mary Kachline, *Library Assistant 3, Autism 365 Coordinator, Wynnefield Library*  
Ethel Funches, *Library Assistant 1; Autism 365 Co-Curator, Wynnefield Library*  
Mary Graham, *Youth Services Coordinator, Abington Community Library*  
Mary Beth Parks, *LAMP, Carnegie Library*  
Diana Fishlock, *PA ABLE, PA Treasury*



This panel presentation will highlight resources as well as applications used to help increase accessibility for individuals and families with special needs. We will feature two librarians as well as individuals who provide resources for libraries. We look forward to hearing your experiences and thoughts.

Sagewood

**2023 Best Practices Awards & David J. Roberts EXCEL Award**

PaLA Best Practices Committee Members  
Best Practices Award Winners

The Best Practices Award recognizes the best youth programs of the year. Learn more about these wonderful library programs from around the state, as the winners describe their award-winning programs. The 2023 Humanities in Action Award, sponsored by PA Humanities, will also be presented.

Salon E

**Sustainable Strategies for Advocacy & Development**

Nicole Richards, *Development Director, Chester County Library System*  
Lauren Harshaw, *Staff Development & Advocacy Coordinator, Chester County Library System*

How to effectively use advocacy and development to support your funding efforts and build relationships with local municipalities.

**10:15 AM – 12:30 PM (Double Sessions)**

Salon D

**They did WHAT? A Deeper Dive into Complicated HR Matters**

Grace Bradley Kelly, *MBA, SPHR, AWI, RC Kelly Law Associates*  
Matthew Jandrisavitz, *Esq., RC Kelly Law Associates*

We know you have good basic understanding of employment laws - so let's take a deeper dive into some more complicated Human Resources scenarios - real and imagined - and work with the subject matter experts and your peers to develop a plan of action.

Rosewood

**Beyond Equal Access: Identifying Equitable and Inclusive Library Practices**

Corri Hines, Office of Commonwealth Libraries Equity, Belonging, and Inclusion Committee Chair

Patrick Frownfelter, Office of Commonwealth Libraries Equity, Belonging, and Inclusion Committee Vice Chair

Ellen Shenk, Office of Commonwealth Libraries Equity, Belonging, and Inclusion Committee Secretary

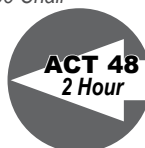

Join the Office of Commonwealth Libraries' Equity, Belonging, and Inclusion Committee in an interactive work session to identify and integrate sustainable practices for fostering a culture of inclusion and belonging in all Pennsylvania libraries.

**11:30 AM – 12:30 PM**

Sagewood

**A Beginner's Practical Guide to Textual Analysis Research: What It Is and How to Do It**

Andrea Pritt, STEM Librarian and Data and Collections Coordinator,

Penn State University Libraries - Harrisburg

Designed to be a beginner's practical guide to textual analysis research, attendees will be introduced to new concepts as well as new technology and will leave with the skills and knowledge to embark on their own textual analysis work.

Zambezi

**Assessing Your Library's Capital Campaign Capacity**

Trina Walker, Founder & Lead Consultant, TLW Strategy

Roberta Greene, Library Director (retired), Public Library for Union County

The plans to enhance your library's services or facility are READY! The project budget is SET! Are all systems GO to ask your community for their support? Learn the essential building blocks for a successful campaign and gain a tool to measure your library's readiness to proceed.

Salon E

**Young Adult Author Panel: Pride on the Pages**

Tobias Madden, Author

Brian Kennedy, Author

Robin Gow, Author/Poet



Seven out of thirteen banned books of 2022 included LGBTQIA+ content. Hear from a panel of young adult authors who are a part of the LGBTQIA+ community as they discuss their works, writing and why it's important to have representation and diversity in our collections.

**12:30 PM – 5:30 PM**

*Kalahari Ballroom, Salons B,C,F,G*

**Library Products & Services Expo**

Find out what's new in library design, furnishings, services, equipment and technology all under one roof! Gather raffle tickets from our exhibitors for the prize drawings beginning at 5:00 p.m.

**12:30 PM – 2:00 PM**

*Kalahari Ballroom, Salons B,C,F,G*

**Exhibits Grand Opening Lunch**

A walk around lunch, compliments of the Pennsylvania Citizens for Better Libraries (PCBL) will kick off the opening of exhibit hall. Maximize your time by combining lunch and visits with our exhibitor partners!

**Sponsored by: Pennsylvania Citizens for Better Libraries (PCBL)**

**12:45 PM – 2:15 PM**

*Nile/Orange*

**Carolyn W. Field Award Luncheon**

Attend the luncheon where PaLA's Youth Services Division will recognize the best book for youngsters written or illustrated by a Pennsylvanian in the prior year through the Carolyn W. Field Award. Pennsylvania is setting the bar high for exceptional children's literature and services for our youth - join us in celebrating these achievements!

**Sponsored by: Lackawanna County Library System**

*Ironwood/Aloeswood*

**CRD Luncheon - Facing a Troubled Library Landscape: Seeking More Compassionate and Empathetic Library Work for All**

*Abigail Phillips, Assistant Professor in the School of Information Studies, University of Wisconsin-Milwaukee*

As librarians and library workers, we are combating censorship, budget cuts, and an uncertain future. As a result, burnout begins to increase, and librarians and library workers begin to leave the field in droves. In this keynote, the presenter will provide practical takeaways which can be employed in the workplace to support both ourselves and our community.

**Sponsored by: Pennsylvania State University Libraries**

**2:15 PM – 3:15 PM**

*Kalahari Ballroom, Salons B,C,F,G*

**No-Conflict Exhibit Time, Poster Presentations & Refreshment Break**  
*(Poster Presentation Schedule see pages 30-31)*

Take a break from formal education settings and enjoy a cold beverage while strolling among the exhibits to gather information on new library innovations and collect tickets for the exhibit raffle. View the posters presented by library colleagues about successful ideas or programs that could be replicated in your library.

**Sponsored by: Midwest Tape/hoopla Digital**

**2:25 PM – 2:45 PM**

*Sagewood*

**Exhibitor Showcase: Medicare Fraud Prevention for Professionals**

*Dan Milloy, Outreach and Engagement Supervisor, CARIE*

This presentation will cover Medicare fraud prevention, with particular emphasis on preventing, detecting, and reporting suspected fraud, errors, or abuse within the community. The session will cover how and why scammers target older adults, case examples, and will train attendees on how to fight back against fraud.

**Sponsored by: Center for Advocacy for the Rights and Interest of Elders (CARIE)**

*Salon E*

**Exhibitor Showcase: SPARK and AccessPA Integrate to Make ILLs Easier!**

*Katie Greenleaf Martin, Executive Director, Pennsylvania Integrated Library System (PaILS)*

*Erin Halovanic, Director of Library Services, HSLC*

PaILS and HSLC have partnered together to integrate the communication between SPARK and SHAREit, allowing for more streamlined ILL workflows and processes. Interested libraries can have Evergreen (SPARK) 'talk' directly to SHAREit (Access PA) to do just that. Join us to learn how the SPARK team, HSLC, Auto-Graphics, and Equinox all worked together to deploy the process using the NCIP protocol and find out how you can simplify your resource sharing processes for the betterment of your staff and your library users.

**Sponsored by: Pennsylvania Integrated Library System (PaILS)**

*Rosewood*

**Exhibitor Showcase: Future-Proof Your Library**

*Larry Payne, AIA, NCARB, LEED AP BD+C | President & CEO, WTW Architects*

This exhibitor showcase will evaluate the benefits associated with incorporating flexible power and data infrastructure and interior architecture into your library project. We will review the generational traits of today's students, and the role libraries play in

supporting to ever-changing collaborative environments. And, we will examine opportunities to embed technology that will enable your patrons to convert “raw” information into knowledge, and understand which options may be suitable for your facility.

**Sponsored by: WTW Architects**

**2:50 PM – 3:10 PM**

*Sagewood*

**Exhibitor Showcase: Sales Tax: What is it and Why Do Libraries and Friends Groups Have to Pay it?**

*Brandt Ensor, Assistant Executive Director, Adams County Library System & Treasurer, Pennsylvania Citizens for Better Libraries (PCBL)*

*Denise Sticha, Executive Director, Centre County Library & Historical Museum & Past President, Pennsylvania Citizens for Better Libraries (PCBL)*

Have you ever wondered why Friends of the Library Groups and 501c3 Public Libraries need to collect sales tax? Does your library or friends group not currently do it? We will explore what sales tax is and why it needs to be collected by non-profit organizations, including Friends of the Library Groups and Public Libraries. We will also discuss how you pay it, what you have to charge it for, and what happens if you don't. This is a very important session for board members, first time directors, and lead library staff who work with Friends of the Library Groups.

**Sponsored by: Pennsylvania Citizens for Better Libraries (PCBL)**

*Rosewood*

**Exhibitor Showcase: Partner with HSLC to Strengthen Your Library!**

*Maryam Phillips, Executive Director, HSLC*

*Erin Halovanic, Director of Library Services, HSLC*

*Tracy Carey, User Experience Specialist, HSLC*

HSLC's mission is dedicated to contributing to the success of libraries by delivering technical solutions and consulting services that meet the challenges facing libraries in the 21<sup>st</sup> century. We are excited to partner with libraries across Pennsylvania to assist your organization in navigating that environment for the benefit of your library facility, your staff, and your community at large. Come hear about HSLC's expansion of services - learn about upcoming webinars as well as consulting opportunities that address such topics as library administration, managing volunteer groups, web hosting solutions, and more! Attendees present for the entire presentation will be entered in a raffle to win a \$100 Amazon gift card.

**Sponsored by: Hosting Solutions and Library Consulting (HSLC)**

# ••••• Poster Presentation Schedule •••••

Monday, October 2, from 2:15 PM – 3:15 PM in the North Foyer

## A Year of Interactive Boards

Susan Strnisha, *Library Manager, Chartiers-Houston Community Library*

This poster will feature interactive bulletin boards used in our library in 2022 that can be replicated and used all year long. Obtain passive program ideas, ways to encourage community involvement, and also gather patron perspective for future events at the library. Boards displayed will show more than one function through decoration as well as programming in a small space.

## Children's Room Re-classification Project

Nicole Heyer, *Technical Services Manager, Pike County Public Library*

In 2022, our library received a grant to assist in creating a dedicated space for children. We're reclassifying picture books and easy readers to make it easy for kids to find what they want to read. This aligns with our goal of creating a welcoming atmosphere for all children!

## Creating Something Exciting: Makerspaces in Public Libraries

Briana Cimino, *Circulation Services Manager, Albright Memorial Library (Scranton Public Library)*

This poster will share information about the Albright Memorial Library Makerspace and the equipment, tools, and resources it uses to provide one-on-one appointments and group classes to patrons. Examples of projects created and classes held will be shared to inspire other libraries, and advice for best practices will be shared from the experience of this public library.

## Engaging Teens Through Mural Art

Maria Zervos, *Youth Services Librarian, Radnor Library*

Teens like to see themselves represented in their spaces. At Radnor Memorial Library, we invited teens to work with a local mural artist to design and paint three mural panels that were installed in the Teen Room. The creative collaboration was very successful.

## Exploring Outdoors at the Library

Jessica Connot, *Youth Librarian, Spring Township Library Association*

Whether you have a large or small outdoor space, an urban space, or are restricted to bringing the outdoors inside, there are ways to inspire all ages to appreciate natural sciences through books, activities, and journaling. Discover tried and true ways to blend literature and natural sciences in programs.

## How to Use PaLA's Equity, Diversity, and Inclusion Resource Directory

Sheli Pratt-McHugh, *Research & Instruction Librarian for Technology & Outreach, University of Scranton*

Mary Gazdik, *Library Director, Chester County Library & District Center*

Learn how to find equity, diversity, and inclusion resources with the PaLA's EDI Resource Directory.

••••• **Poster Presentation Schedule** •••••

Monday, October 2, from 2:15 PM – 3:15 PM in the North Foyer

This tool provides access to timely and authoritative information to aid development of equitable library services, diversify the profession, strengthen our communities, and advance discussion, understanding, and advocacy of EDI topics.



**Library Days**

Marissa Guidara, *Reading Library District*

Library Days is an event series where patrons from across our district can explore a community organization for free by showing their library card. It helps connect our patrons to organizations they may not otherwise have known about or utilized, while allowing a rare opportunity for independent libraries to collaborate.



**Need a Brain? We've Got You! Bringing Medical & Technology Reserves to Students**

Jackie Rhule, *Information Resources and Services Manager, Penn State Altoona Eiche Library*

Penn State Altoona's Eiche Library has found a way to introduce its Equipment and Medical Reserve Collection to first year students. This is achieved by connecting with students at New Student Orientation and in the classroom with a Reserve Collection Binder and classroom posters. The results are more faculty support and increased usage of equipment and models.



**One Year In: An LGBTQIA+ Collection in an Academic Library**

Teresa Slobuski, *Head Librarian, Penn State Brandywine*  
Jane Homan, *Information Resources and Services Specialist, Penn State Brandywine*

One library seeks to combat patterns of LGBTQIA+ discrimination by establishing a new collection, Pride+, to demonstrate their commitment to making LGBTQIA+ materials available for the long term. This poster presentation will provide details about creating and managing the collection including how usage has been in its first year.



**Where is Houdini? How to Transform the Death of a Library Pet into a Positive PA Forward® Basic Literacy Program for all Ages**

Jackee Sharayko, *Assistant Director, Kutztown Community Library*  
Janet Yost, *Director, Kutztown Community Library*

The death of a library pet turned into a program about the wonders of the world while encouraging reading and the collection. Patrons suggest a place to send Houdini on "vacation." A "Where is Houdini?" bulletin board connects the postcard to a map and features books about the location.

**2:50 PM – 3:10 PM** *continued*

*Salon E*

**Exhibitor Showcase: Patron Engagement: Increase Your Visibility and Attract New Users**

*Jake Simone, Regional Sales Manager, EBSCO*

Today, when users search for information, the first place that they look is not their library's catalog. EBSCO has created a variety of tools to help users discover and access your library's content from anywhere on the web. This session will discuss how EBSCO can help make your collection discoverable to your patrons where they are online. We'll discuss how EBSCO's new Bibliograph service will: Appear in Google's Knowledge Panels; Go directly from Google to your catalog with just one click; Enhance your records through linked data; Empower your library to create community partnerships; Draw patrons into your library. Join us to learn how to strengthen your library's online presence and attract new users to your catalog!

**Sponsored by: EBSCO Information Services**

**3:30 PM – 4:30 PM**

*Sagewood*

**Understanding Student Perception of LibGuides and LibAnswers FAQ Design and Content**

*Michael LaMagna, Information Literacy Program & Library Services Coordinator; Professor of Library Services, Delaware County Community College*

*Andrea Rodgers, Assistant Professor of Library Services, Delaware County Community College*



LibGuides and LibAnswers FAQ are ubiquitous in many academic libraries. This presentation will communicate the results of a recent research study at a large, suburban community college that examined student perception of the usefulness of the information provided and the way in which the information is presented.

*Rosewood*

**I've Taken Diversity 101 Six Times, Now What? Why Approach Matters**

*Dr. Ellen Newell, Associate Professor of Psychology, Wilkes University*

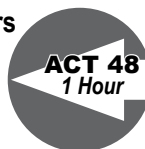

Social psychologist, Dr. Ellen Newell, will discuss how increased self-awareness regarding diversity, equity, and inclusion can be impactful. Topics discussed include the importance of identity, how to recognize bias, prejudice, and stigma and what to do about it, and discuss both successes and pitfalls when trying to foster inclusive environments.

Salon E

**Brooklyn Public Library’s Books Unbanned: Libraries Resisting Censorship**

Amy Mikel, *Director of Customer Experience, Brooklyn Public Library*

Jackson Gomes, *YA Internship Coordinator, Brooklyn Public Library*

Summer Boismier, *Teen Initiatives Project Mgr., Brooklyn Public Library*



Hear from Brooklyn Public Library’s Books Unbanned team about their work on this award-winning anti-censorship campaign, plus learn how your library - regardless of size or budget - can take steps to defend Intellectual Freedom.

Ironwood/Aloeswood

**Achieving Success with a Solid Strategic Plan**

Dr. Carlee Ranalli, *Dean of Planning and Institutional Effectiveness, Hagerstown Community College*

Strategic planning is important in daily operations, fundraising, and advocacy efforts. The planning process helps the library focus on goals and achieve success. This session will discuss steps in facilitating a successful strategic planning process. Participants will be provided tools to lead a planning process at their home library.

Zambezi

**Mister Rogers’ Lessons for Libraries**

Ryan Rydzewski, *Communications Officer, The Grable Foundation; Co-author of When You Wonder, You’re Learning: Mister Rogers’ Enduring Lessons for Raising Creative,*

*Curious, Caring Kids*

Gregg Behr, *Executive Director, The Grable Foundation; founder of Remake Learning,*

*and co-author of When You Wonder, You’re Learning: Mister Rogers’ Enduring Lessons for Raising*

*Creative, Curious, Caring Kids*



In this interactive lecture, we’ll explore what librarians can learn from Pennsylvania’s favorite neighbor: Fred Rogers. Together, we’ll discover how caring adults everywhere can use Fred’s blueprints to build libraries and learning spaces that spark wonder, belonging, and joy.

Salon D

**The Library After Dark: Expanding Community Reach Through Social Programming**

Emily Fear, *Head of Teen Department, Sewickley Public Library*

Richelle Klug, *Communications/Social Media Librarian, Sewickley Public Library*

This session is all about breaking with that mentality to embrace the social potentials of programming in your library - and how those programs could be the key to expanding your community reach.

**4:30 PM – 5:30 PM**

*Kalahari Ballroom, Salons B,C,F,G*

**Exhibit Hall Reception**

Visit our exhibitor partners to find out what's new on the library scene and obtain raffle tickets for a chance to win a prize! The raffle drawings will begin at 5:00 p.m.

**5:00 PM – 5:30 PM**

*Kalahari Ballroom, Salons B,C,F,G*

**Raffle Prize Drawings**

Raffle tickets may be obtained through conversations with our exhibitor partners. Deposit tickets by 5 p.m. for a chance to win some of the incredible prizes donated by our generous exhibitors, then join us to find out if you are a winner!

*\*You must be present to win.*

**5:30 PM – 6:00 PM**

*Ironwood/Aloeswood*

**Public Library Division Business Meeting**

Attend, to receive updates on Public Library Division (PLD) activities, current and future.

**5:30 PM - 6:30 PM**

*Sagewood*

**Pennsylvania Black Librarians Caucus General Membership Meeting**

PABLC will hold its annual membership meeting, followed by a Meet and Greet with prospective members. You are invited to join us for the meeting, which will include updates on this year's activities. Following the meeting, mix and mingle with PABLC members, and learn how you can join our efforts to support African Americans in the library profession across Pennsylvania.

**5:30 PM – 7:30 PM**

*Cinco Ninos*

**Youth Services Division Dine Out**

Join your colleagues for a meal at one of Kalahari's most popular restaurants, located just off the main lobby.

*Sortino's*

## Teaching, Learning & Technology Round Table Business Meeting & Dine Out

Receive updates on round table activities, past & present and share a meal with colleagues.

---

*Area Restaurants*

### Dinner on Your Own

Check the Local Information Table for dining locations and make plans to dine with a friend!

**7:30 PM – 9:00 PM**

*Nile/Orange*

### Comedy Club: Because Laughter is Good for the Soul!

Regina DeCicco, *Stand-Up Comic*

Moody McCarthy, *Stand-Up Comic & Writer*

Rodney Laney, *Stand-up Comedian & Author*

You've seen them on late-night comedy shows, now see them live, right here at the PaLA Conference! Join us for some much needed laughter as we are entertained by some of New York City's top comics.

**Sponsored by: Lehigh Valley Library System - The public libraries of Allentown, Bethlehem, and Easton**

---

*Ironwood/Aloeswood*

### Game Night

Put your "game face" on and participate in an in-house Game Night! We'll have STEM kits to explore and about two dozen unique card and board games for two to six, or more players. Hosts will be on hand to provide game instruction.

# Libby Extras

## Content that entertains & educates

Serve more of your community's interests with access to current events, arts and crafts, lectures, collectibles, music, test prep, movies and more—all available in the Libby app



Visit OverDrive's booth **#404** to learn more!

kanopy

THE  
GREAT COURSES  
LIBRARY COLLECTION

KOVELS

Craftsy

ArtistWorks.com

GROUND  
News

LawDepot®

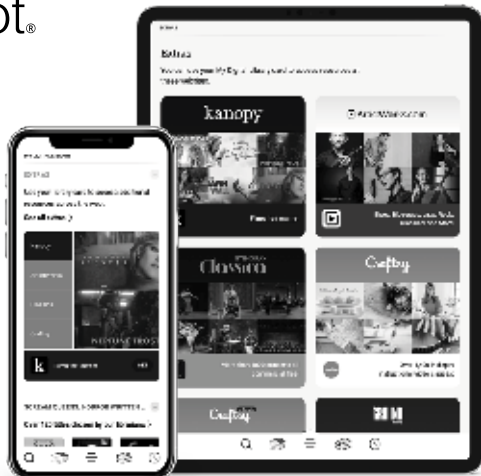

OverDrive



LACKAWANNA  
COUNTY LIBRARY  
SYSTEM

PROUDLY SPONSORS THE

*CAROLYN W. FIELD  
AWARD LUNCHEON*

IN HONOR OF LACKAWANNA COUNTY  
AUTHOR AND FIVE-TIME AWARD WINNER

**SUSAN CAMPBELL BARTOLETTI**

IMAGINE THAT . . .

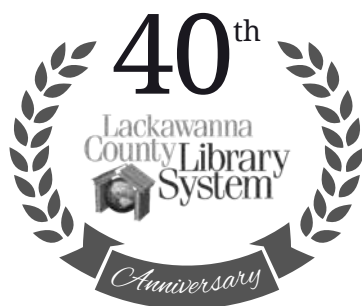

CONGRATULATIONS TO 2023 WINNER



**BROOKE BARKER**  
*HOW DO MEERKATS ORDER PIZZA?*

# TUESDAY, OCTOBER 3

**Registration Desk**, Registration D, North Foyer ..... 8:00 AM – 5:00 PM  
**Local Information Table**, North Foyer ..... Self-service  
**Exhibit Hall**, Kalahari Ballroom ..... 9:30 AM – 2:30 PM  
**PaLA Store**, Located in the exhibit hall ..... 9:30 AM – 2:30 PM  
**Poster Sessions**, North Foyer ..... 10:00 AM – 11:00 AM, 1:00 PM – 2:00 PM

## 8:00 AM – 8:45 AM

*Aloeswood*

### **SPARK & Friends Breakfast**

Pennsylvania Integrated Library System (PaILS) will be hosting a “SPARK & Friends” breakfast for SPARK consortium members and their guests. A light breakfast will be served alongside an opportunity to learn more about being a SPARK member, to network with other SPARK members, and to hear an update on PaILS/SPARK news from Executive Director, Katie Greenleaf Martin.

**Sponsored by: Pennsylvania Integrated Library System (PaILS)**

---

*Nile/Orange*

### **Coffee & Un-Conference Conversations**

Start your day with a light breakfast and conversation with fellow attendees about the previous day’s sessions.

**Sponsored by: Scranton Public Library & University of Scranton, Weinberg Memorial Library**

## 9:00 AM – 10:00 AM

*Sagewood*

### **Picture Book Neighborhoods: Making Your Library Accessible to Pre-Readers**

Laura Arnhold, *Library Director/Upper Merion Township Library*  
Becky Ginther, *Head of Children’s Services/Upper Merion Township Library*



Learn the step-by-step guide of how our library converted the picture book collection into neighborhoods - empowering pre-readers to find the books they love and discover new titles while increasing our circulation!

Zambezi

## Help! Inclusion is Important, But How Do I Actually Improve My Library?

Kate Cummings, *Research & Instruction Librarian, University of Scranton*  
Dr. Ellen Newell, *Associate Professor of Psychology, Wilkes University*



Research and instruction librarian, Kate Cummings, and social psychologist, Dr. Ellen Newell, will discuss inclusion in libraries and practical ways libraries can reevaluate areas such as programming, collection development, and policies. Attendees will have the opportunity to discuss their individual challenges and receive feedback and support from the speakers.

Salon D

## De-Escalation Tips & Techniques in Situations of Concern

Rick Capozzi, *Founder, Survival Mindset Co.*

Typically what comes before the violence is escalation. In this program, international speaker and founder of Survival Mindset Co., Rick Capozzi will be sharing proven ideas and principles that you can apply to effectively defuse conflicts where temperatures are rising.

Rosewood

## Twenty First Century Teens: Literacy Skills for Young Adults and Teens

Rob Leshner, *PA Forward® Program Manager, Pennsylvania Library Association*

Mary Graham, *Youth Services Coordinator, Abington Community Library*

Laura Harding, *Young Adult Librarian, Osterhout Free Library*

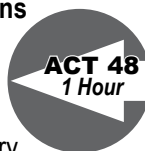

Learn how libraries are using the PA Forward® framework to plan and carry out young adult/teen programming.

Salon E

## How to Get Your Board to Fundraise

Chad Barger, *Speaker, Trainer & Coach, Productive Fundraising*

Join fundraising master trainer, Chad Barger, CFRE, for a workshop focused on equipping and motivating your board members to be great fundraisers. You'll learn how to help them get over their fear of fundraising and develop the fundraising habit. Accountability and follow through will also be discussed. The session includes tools and samples that you can use to start building a fundraising culture within your board.

## ••••• Poster Presentation Schedule •••••

Tuesday, October 3, from 10:00 AM – 11:00 AM in the North Foyer

### 5 Years of Resource Sharing in SPARK

Elizabeth Davis, *Pennsylvania Integrated Library System*

SPARK libraries have now been sharing materials among systems, districts and unaffiliated locations for over 5 years; and we are adding more resource sharing relationships every year. Learn about how libraries in the SPARK consortium have expanded resource sharing among affiliated and non-affiliated libraries over the past 5+ years. See how resource sharing has increased in popularity among SPARK libraries, and hear about some projects that are just now spinning up. Understand the negotiation process and logistical concerns for libraries who want to share materials with each other.

---

### BOOKTENDER--Your Personalized Book Service

Rachel Mabb, *Altoona Area Public Library*

Imagine going out to restaurant or bar and telling them you would like something fruity or sweet then they make a drink just for you. Now imagine it for books. Are you looking for mystery, historical romance, non-fiction, or a thriller similar to Patterson? BOOKTENDER is our personalized book selection service to pick books based on a patron's taste.

---

### Grab & Go: Take & Make Kits for Library Outreach

Emily Zimmerman, *Reference & Instruction Librarian, Penn State Dubois*

Cori Biddle, *Student Engagement and Outreach Librarian, Penn State Altoona*

This poster will highlight our redesign of outreach strategies in response to changing patron habits. Take 'n' Make crafts replaced in-person events, allowing participation on patron's own terms, and more flexible staffing. This strategy is relevant to both public and academic libraries. Supply lists and best practices will be offered.

---

### How to Get Started with a Library of Things Collection

Amber Osborne, *Library Director, Easttown Library*

Audrey Young, *Head of Adult Services & Assistant Director, Easttown Library*

With an aim toward demystifying the process for starting a Library of Things collection, librarians from Easttown Library will share details of their experience from start to finish. Ideas will be shared for choosing equipment, locating funding, ordering and processing items, making Things user friendly, and advertising the collection.

---

### Mindful Moment Grab & Go Bags

Jeanne Zucker, *Cataloger, Abington Township Public Library*

Launched in May 2023 for Mental Health Awareness Month, these free bags contain resources for self-care, mindfulness, and meditation. Contents include information on meditation, a journal prompt, puzzle, bookmark to color, an object for meditation, and information on breath awareness, the benefits of meditation and mindfulness, exercise, yoga, gratitude, etc.

## ••••• Poster Presentation Schedule •••••

Tuesday, October 3, from 10:00 AM – 11:00 AM in the North Foyer

### **Programming in the Stacks: Using Your YA Collection to Get Teens In Your Library**

Mary Graham, *Youth Services Coordinator, Abington Community Library*

This poster will highlight different titles and topics you can use for engaging teen programs. The main focus will be on graphic novels, manga, and non-fiction. Receive advice on where to locate titles, passive and active program ideas, and how to best incorporate the collection in a way that appeals to teens.

---

### **Self-Care Station: Bridging Gaps One Toothbrush at a Time**

Sara Huff, *Young Adult Librarian, Abington Township Public Library*

In the fall of 2022, a Self-Care Station was created in the Teen Space of the library. Run mostly by donations, this station provides free toiletries (toothbrushes, soap, period products, etc.) to local teens. Learn how you too can provide these necessities to your patrons, regardless of your budget!

---

### **Virtual Reality in the Classroom**

Emma Beaver, *Head Librarian, Penn State Fayette Library*

Academic libraries play a pivotal role in the education and engagement of students, and as we evolve with changing technologies, so does our role in the classroom. Penn State Fayette's library has been using virtual reality (Oculus Quest 2) to connect with students and faculty with experiences beyond the traditional.

---

### **Where Have All the Females Gone? Losing (and Hopefully Finding) Half of Our Ancestors**

Mary Porter, *Technical Services Librarian and Genealogist*

For most of our historical record, to find a female ancestor, you needed to find the male ancestor she was married to, the daughter of , or the mother of. This poster will list ways to find female ancestors, and also give some reasons why they couldn't be found in a normal genealogical search.

---

### **You Can Get that Job!**

Robyn Vittek, *Director, Mt. Lebanon Public Library*

A public library Director with extensive experience on both sides of the interview table will provide tips and tricks to make your application stand out, to ace your interview, and to help you make the best possible play for the job you want!

**9:30 AM – 2:30 PM**

*Kalahari Ballroom, Salons B,C,F,G*

**Library Products & Services Expo**

Find out what's new in library design, furnishings, services, equipment and technology all under one roof! Gather raffle tickets from our exhibitors for the prize drawings beginning at 2:00 p.m.

**10:00 AM – 11:00 AM**

*Salons B,C,F,G*

**No-Conflict Exhibit Time, Poster Presentations & Coffee Break**

*(Poster Presentation Schedule see pages 40-41)*

Take a break from formal education settings and enjoy a hot beverage while strolling among the exhibits to gather information on new library innovations and collect tickets for the exhibit raffle. View the posters presented by library colleagues about successful ideas or programs that could be replicated in your library.

**Sponsored by: Brainfuse**

**10:10 AM – 10:30 AM**

*Sagewood*

**Exhibitor Showcase: Ten Ways to Rise to the Challenges of Visibility and Engagement**

OCLC Leaders

Pennsylvania libraries already work together to make resources more visible and useful within the communities they serve—and increased library cooperation can provide even more benefits. At this session, you'll learn ten specific, collaborative actions that can improve your library's visibility while increasing engagement with users. This will include ways to better leverage resource sharing, elevate discovery of your library and its materials, increase engagement through mobile services... and more. When libraries rise to the challenge, everyone benefits!

**Sponsored by: OCLC**

*Salon E*

**Exhibitor Showcase: Out-of-the-Box Coding Clubs with Fiero Code**

*Jake Simone, Regional Sales Manager, EBSCO*

The technology and computer programming fields offer some of the highest paying jobs to those graduating high school and college. In addition to preparing today's youth for tomorrow's careers, learning to code also develops critical thinking skills and nurtures creativity. As trusted and valued institutions for lifelong learning, libraries are perfectly poised to deliver coding education. Join us to learn how Fiero Code, a

learn-to-code software platform available through EBSCO, makes it easy for libraries to provide facilitated and non-facilitated coding instruction to all learners in your community.

**Sponsored by: EBSCO Information Services**

---

*Rosewood*

**Exhibitor Showcase: Digital Dish**

*Marne Fellows, Sales Representative, Baker & Taylor*

*Tarita Murray, Sales Representative, Baker & Taylor*

Discuss ideas to engage your community, enhance your library, and expand your library's brand with new digital products. Digital Dish session will focus on ePop Up Library which is a simple way to remove barriers to digital reading, attracts and welcomes new library users and extends the libraries reach into the community, Boundless Kids & Teens our newest community-centric app offering a massive selection of curated age-appropriate content in a safe, library-supported environment. Additionally, attendees will learn about ParentTV and how to support those who care for children from infancy to teenage years.

**Sponsored by: Baker & Taylor**

**10:35 AM – 10:55 AM**

*Salon E*

**Exhibitor Showcase: Reading Programs that Actually Work**

Join Reader Zone founder, Jake Ball, to talk reading programs and how you can make your summer and year-round reading programs a bright spot for your library and community. There are three principles that drive high-participation reading programs for patrons of all ages. During this session, we will discuss these principles and how you can employ them in your library at no cost. We will demonstrate the Reader Zone platform and show how libraries throughout Pennsylvania are using Reader Zone to build cultures of reading in their communities.

**Sponsored by: Reader Zone**

---

*Rosewood*

**Exhibitor Showcase: Small Games of Chance: Do We Really Need a Permit for That?**

*Brandt Ensor, Assistant Executive Director, Adams County Library System & Treasurer, Pennsylvania Citizens for Better Libraries (PCBL)*

*Denise Sticha, Executive Director, Centre County Library & Historical Museum & Past President, Pennsylvania Citizens for Better Libraries (PCBL)*

There are many rules and regulations regarding raffles, silent auctions, bingo games, and pull tab games. Do you know two of the games I just mentioned are covered

under the small games of chance law and two are not.... But yet many public libraries and friends of the library groups have them all the time. A description of the legal requirements for Small Games of Chance will be explored and some examples of what you can or can't do. We promise it is easier than it sounds!

**Sponsored by: Pennsylvania Citizens for Better Libraries (PCBL)**

---

*Sagewood*

**Exhibitor Showcase: Expand Health Literacy with ConnectWell**

Andrea Bloom, *Founder, ConnectWell*

Health literacy is more important than ever with the healthcare system struggling to provide adequate care for the U.S. population that is experiencing a decline in mental and physical health. The Health Literacy Initiative at PA Forward® is designed to support libraries in fulfilling the key role they play in elevating the quality of life in Pennsylvania. In this Presentation, you will get a brief overview of the PA Forward® Health Literacy Initiative from Rob Leshner, PA Forward® Program Manager. Andrea Bloom, ConnectWell's Founder, will share how bringing ConnectWell to your library can advance and scale health literacy with ConnectWell which qualifies as a PA Forward® Health Literacy Initiative. Andrea will provide a full demo of ConnectWell an "all-in-one" digital health and wellness information resource that is academically sourced and designed for a consumer audience to engage people in their health and well-being.

**Sponsor: ConnectWell**

**11:15 AM - 12:15 PM**

*Zambezi*

**20 Tech Tools that Transform**

Katie Dunbar, *Youth Services District Consultant, Montgomery County Library District*

Tracey Reed, *District Consultant, Montgomery County Library District*



Join us for a 60 minute tour of 20 free technology tools that streamline mundane tasks, increase collaboration, improve communication, and make you look more professional!

---

*Rosewood*

**Out of the Wreckage: One Library's Response to a Community Disaster**

Molly Kane, *Head of Library Systems & Building Operations, Upper Dublin Public Library*

Cheri Fiory, *Director, Upper Dublin Public Library*

Learn how the one library responded after a tornado devastated its community and discover how a new model of community collaboration benefits the Library, the community, and its residents in unexpected ways. UDPL's service to its community was recognized by the Pennsylvania Library Association with the 2022 Library of the Year award.

*Sagewood*

## **The Power of Jewish Children's Stories in Your Library**

Stacy Nockowitz, *Children's Author & Middle School Librarian, Columbus Academy*



Jewish books are diverse books! And Jewish stories are more than just stories of the Holocaust. Join award-winning children's author and school librarian Stacy Nockowitz for a lively discussion about identifying books with authentic Jewish representation and thoughtfully adding them to your collection and programming to benefit your library community.

*Ironwood*

## **Serving Those Who Served: Reaching Out and Engaging Veterans in Your Community**

Paul McMonigle, *Engineering Instruction Librarian, Penn State University Libraries*

This session is intended to help public and academic librarians better understand the veteran population of their communities and create ways to provide services and support to them. Presented by a librarian and veteran, the session will be an interactive, engaging conversation on programs and collections for this unique group.

*Salon D*

## **Unite Against Book Bans: ALA's Policy Corp Changing the Narrative**

Kent Oliver, *Senior Fellow, ALA PPA*

Sukrit Goswami, *Director, Haverford Township (PA) Free Library*

Eric Strohshane, *Assistant Director of Member Services, ALA's Office for Intellectual Freedom*



ALA's Policy Corps is actively spreading a unified message supporting librarians in their efforts opposing book bans. Find out what that impactful messaging entails and hear actionable intelligence to assist you in your community before and after the censor is at the door.

*Salon E*

## **Facilities 101: Developing and Implementing a Successful Maintenance Plan**

Zachary Zimmerman, *Facilities Manager, York County Libraries*

This session will discuss the basic needs to maintain a building, allowing it to operate safely and efficiently for as long as possible. An effective facilities management plan will create a safe, clean and pleasant environment for staff and patrons. We will discuss developing and implementing a plan that includes HVAC equipment, control systems and custodial operations. Attendees will learn about common issues that arise during general maintenance and procedures to correct them.

12:30 PM – 2:00 PM

*Nile/Orange***Public Library Division Luncheon: Learning to Break the Ice for Meaningful Interactions***Jobany Bedoya, Owner, Diversity Mixers and Red Tie Affairs, LLC*

During this fun and interactive presentation, individuals will learn and immediately apply the simple tools on how to break the ice, network, and relieve some of the stress that comes with leaving their comfort zone with strangers.

**Sponsored by: Association of Pennsylvania Public Library Systems (APPLS)***Kalahari Ballroom, Salons B,C,F,G***Exhibit Hall “Strolling” Lunch**

Stroll through the exhibit hall while enjoying tasty, portable treats and take advantage of this last opportunity to collect raffle tickets from exhibitors for the 2:00 p.m. prize drawings!

1:00 PM – 2:00 PM

*North Foyer***Poster Sessions***(Poster Presentation Schedule see pages 48-49)*

View the posters presented by library colleagues about successful ideas or programs that could be replicated in your library.

2:00 PM - 2:30 PM

*Kalahari Ballroom, Salons B,C,F,G***Raffle Prize Drawings**

Raffle tickets may be obtained through conversations with our exhibitor partners. Deposit tickets by 2 p.m. for a chance to win some of the incredible prizes donated by our generous exhibitors, then join us to find out if you are a winner!

*\*You must be present to win!*

2:30 PM – 3:30 PM

*Salon E***Epistemic Vaccination: Inoculation Theory and Misinformation***Ian O'Hara, Assistant Professor & Research & Instruction Librarian, Weinberg Memorial Library-University of Scranton*

This workshop aims to thoroughly discuss inoculation theory, why it is valuable, and how it can be implemented in the classroom to engender the necessary critical skills to function within our expanding and opaque information sphere.

*Ironwood*

## **2023 PA Forward® Adult Literacy Programming Awards**

Rob Leshner, PA Forward® Program Manager, Pennsylvania Library Association

Award Winners

Come and learn about the 2023 PA Forward® Adult Literacy Programming Award winning libraries.

*Zambezi*

## **Do I Have to? Strategies for Cultivating Municipal Support with Confidence**

Amy Resh, Executive Director, James V. Brown Library; System Administrator, Lycoming County Library System

Becky Wanamaker, District Consultant, Reading Library District

Looking for support and motivation to develop a connection and increased funding from your municipality? Join two experienced directors for a play-by-play to start refining your municipal relationships as well as for tips and tricks that will keep you motivated to interact with your municipalities regularly.

*Salon D*

## **Discover How To Increase Patron Engagement With Technology at Your In-Person Programs**

Matt Mazur, Director, Turtle Dance Music LLC and AutismFriendlyShows.com



Come to this session to learn about free tools that you can incorporate into your programming to increase patron engagement at your events.

**2:30 PM – 4:45 PM (Double Sessions)**

*Sagewood*

## **Recruiting and Retaining Diverse Talent: Addressing Barriers and Improving Culture Experiences**

Jessica Purdy, Founder | CEO, FIC Human Resource Partners

Recruiting and retention of diverse talent are inextricably linked. Participants will be led through lecture and discussion sessions of the specific barriers BIPOC people who may become interested in the library sciences face, the culture experiences that lead to poor retention of diverse talent, and options for addressing these challenges.

*Rosewood*

## **Brainstorm!: Architecture to Incorporate All the Letters of STEM**

William Fee, Lead Instructor, STEMLab, State Library of Pennsylvania



Come build with the State Library's head of the STEMLab. Go hands on with activities, tips and tricks for incorporating architecture in your STEM programming. Hints for how to procure expert help and volunteers provided.

## ••••• Poster Presentation Schedule •••••

Tuesday, October 3, from 1:00 PM – 2:00 PM in the North Foyer

**\*\*blinking lights\*\* “WE’RE OVER HERE!” \*\*blinking lights\*\***

### **Outreach to Post-Pandemic College Students**

Sheli Pratt-McHugh, *Research & Instruction Librarian, Technology & Outreach, University of Scranton*

Since fully reopening and welcoming students back to campus post-covid, our outreach efforts had to be reexamined. We have added two new campus wide digital platform, embraced video content like reels, and increased social media content overall. Come hear what has and hasn’t worked to capture the attention of Gen-Z.

---

### **Collaborating with a Campus Writing Committee to Create an Information Literacy Wheel**

Beth M. Transue, *Information Literacy Librarian, Messiah University*

The Writing Across the Curriculum Committee created an Essay Wheel to help students visualize the writing process. Librarians then collaborated with the Committee to map information literacy concepts onto the Essay Wheel and create a Research Strategies Wheel to illustrate the intersection of information literacy and the writing process.

---

### **Does Reading Actually Make a Difference? Reading Impacts on “Searching as Strategic Exploration”**

Brendan Johnson, *Outreach and Engagement Librarian, Penn State Abington*

Emily Reed, *Reference and Instruction Librarian, Penn State Harrisburg*

This poster will share the results of a study that examined incoming first-year college students’ reading preferences and their information literacy, highlighting the finding that students’ practice of wide reading and possession of books in the home has a positive correlation with the “Searching as Strategic Exploration” information literacy frame.

---

### **From Citations to Connections: Using Citation Management Software for Collaboration**

Sara Kern, *Engineering Librarian, Penn State*

This poster will share how Zotero groups can be used to foster research collaboration. This includes exploring opportunities to teach Zotero or other reference management software and considering ways participants might use Zotero for research in their own library, from student group projects to community genealogy resources, and beyond!

---

### **From Stacks to Spaces: How the PSU Engineering Library is Going Bookless**

Katelin Woods, *Information Resources and Services Support Specialist, Pennsylvania State University Libraries*

Paul McMonigle, *Engineering Instruction Librarian, Pennsylvania State University Libraries*

Denise Wetzel, *Science & Engineering Librarian, Pennsylvania State University Libraries*

Penn State is rising to meet changing user needs by transitioning its University Park Engineering Library from a traditional location with over 30,000 holdings into a space focused on collaboration and digital

# ••••• Poster Presentation Schedule •••••

Tuesday, October 3, from 1:00 PM – 2:00 PM in the North Foyer

resources. Join Penn State Engineering Library staff to discuss the workflows that go into creating a bookless library.

---

## **I Did That: Student Scholarship in Academic Libraries**

*Kayla Van Osten, Research & Instruction Librarian, Widener University*

*Kristina Dorsett, Research & Instruction Librarian, Widener University*

*Jill Borin, Head of Archives & Distinctive Collections, Widener University*

Reflecting on the work from the previous academic year, we aim to highlight and celebrate student scholarship in the physical space and digital collections. This will include QR codes to student work from the Archives Digital Collections that feature topics of interest.

---

## **Reflections on Moving Student Employee Training to a Virtual and Asynchronous Model**

*Monica Gingerich, Student Engagement Coordinator, Pennsylvania State University Libraries*

A positive outcome of the pandemic has been the introduction of more flexible modes of delivery for information, including training materials for newly hired student employees. This poster will explore the outcomes of moving the majority of a student employee training model to a virtual and asynchronous setting.

---

## **Rising to the Challenge of Equitable Student Success**

*Rebecca Miller Waltz, Associate Dean for Learning and Engagement, Penn State University Libraries*

National higher education data shows that student groups from different backgrounds do not experience proportionate success and graduation rates. What can academic libraries do to change this? This poster explores how Penn State University Libraries uses high-impact practices to help close equity gaps and enhance equitable student success.

---

## **Student and Faculty Attitudes Toward eBook Piracy**

*Rob Sieczkiewicz, Director, Blough-Weis Library, Susquehanna University*

*Haley Dittbrenner, OER Intern, Blough-Weis Library, Susquehanna University*

The high cost of textbooks encourages many students to seek alternative means of access, including pirate sites (AKA, shadow libraries). To better understand students' behavior as well as campus attitudes toward ebook piracy, we surveyed Susquehanna University faculty and students. Our findings will shape our library's Open Educational Resources (OER) efforts.

---

## **Too Difficult to Catalog: Identifying Solutions to Reduce Backlogs and Expose Hidden Collections**

*Marleen Cloutier, Cataloging & Metadata Librarian, Weinberg Memorial Library, University of Scranton*

Backlogs happen. Catalogers are often confronted with original materials that are complicated to catalog. This poster session will offer some insight as to why and how cataloging gets set aside and considers some possible solutions to help expose our hidden collections and reduce backlogs.

**3:00 – 5:00 PM***Hauser Nature Center***Guided Walk at the Hauser Nature Center at Long Pond**

Take a break from sessions and enjoy nature on this guided 1.65 mile walk along Cathy's Trail at the Hauser Nature Center. Our walk will be guided by Carol Hillestad, a long-time hike leader and writer for Get Outdoors Poconos, a grant-funded series administered by Brodhead Watershed Association. Participants are asked to dress in layers, bring a water bottle and wear sturdy walking shoes for the approximate one-hour walk over a sometime rocky or root-filled trail.

**3:45 – 4:45 PM***Zambezi***The State Aid Formula: Preparing for the Future by Understanding the Past***David Belanger, Library Consultant/Retired Librarian**Mary Garm, Executive Director of the Lackawanna County Library System,*

As a follow up to last year's program on the History of Pennsylvania Libraries, the presenters will take an in-depth look at the formula for state aid to public libraries. Attendees will learn about the forces that came together to create a major increase in funding, how that funding was distributed, and how state budget cuts impacted the formula.

*Salon D***Empowering Young People through Multicultural Literature!***Richard E Ashby, Jr., President, Pennsylvania Black Librarians' Caucus**Simone Adjei, Executive Director, iReadify*

Explore the importance of re-engaging readers with Multicultural Literature and the benefits of culturally relevant children's books. Discuss the importance of multicultural Literature and its impact on young people. Examine how the author's identity helps shape the story and how multicultural Literature helps children embrace their culture and the culture of others.

*Ironwood***Improving Town & Gown Relations Through a Social Justice Book Club***Amanda Boyer, First-Year Experience Librarian, Susquehanna University**Amir El-Chidiac, Diversity Resident, Susquehanna University**Nici Baer, Circulation & Interlibrary Loan Assistant, Susquehanna University*

This presentation will detail how we started our Social Justice Book Club in collaboration with our public library, our Office of Inclusive Excellence, and some local restaurants to create a safe space for people from all backgrounds to come together to learn about social justice issues (and do a little reading, too!).

*Salon E*

## **Compassionate Computer Help: Supporting Digital Inclusion Goals by Setting Reasonable Limits**

Caitie Morphew, Library Services Admin. for Neighborhood Libraries, Carnegie Library of Pittsburgh  
Daniel Hensley, Coordinator of Staff Training and Development, Carnegie Library of Pittsburgh

Computer help is a critical part of virtually every public library's services, and is often recognized as one of the most important ways that libraries support our communities. It is also often a source of frustration, both by patrons, whose expectations are not grounded in an understanding of the service responsibilities of staff, and by staff, who despite their best efforts, may come up short of patron's expectations.

**5:00 PM – 6:00 PM**

*Aloeswood*

### **Ex Libris Reception**

A "thank you" reception for Ex Libris Society members. Not a member? Donate now at <https://www.palibraries.org/donations/donate.asp?id=7130>.

*\*By invitation only!*

**5:00 PM – 7:30 PM**

*Area Restaurants*

### **Dinner on Your Own**

Check the Local Information Table for dining locations and make plans to dine with a friend!

**5:00 PM – 8:00 PM**

### **Explore the Waterpark!**

Put on your swim or warm weather gear and join your colleagues for this unique opportunity to explore the Kalahari Waterpark at whatever level you wish. Float in the lazy river, soak in the indoor/outdoor family hot tub, get your thrill on by riding one of the park's exciting waterslides! Or, simply gather with colleagues at the PaLA Cabana sponsored by the Northeast Chapter.

*\*A waterpark pass (included with lodging) is required.*

**7:30 PM – 9:00 PM**

*Nile/Orange*

### **LibCraft for Librarians!**

Hang out and relax with other crafters working on individual handiwork projects.

# WEDNESDAY, OCTOBER 4

Registration Desk, Registration D, North Foyer .....	8:00 AM – 12:30 PM
Local Information Table, North Foyer .....	Self-service
Exhibit Hall, Kalahari Ballroom .....	Closed
PaLA Store, Located in the exhibit hall .....	Closed

## 8:00 AM – 8:45 AM

*Zambezi/Nile/Orange*

### Coffee & Un-Conference Discussions

Enjoy a light breakfast with fellow attendees to discuss sessions from the previous day.

**Sponsored by: Library Friends Groups from across the state**

## 9:00 AM – 10:00 AM

*Ironwood*

### Hidden Histories: Digitizing the Black History and Visual Culture Collection

*Bethann Rea, Digital Collections Management Librarian, Penn State University Libraries*

A presentation providing an overview of the digitization workflow for the Black History and Visual Culture collection held at The Pennsylvania State University. Selected materials required condition assessments, metadata enhancements, and in-depth evaluations for copyright and sensitive content. This collection is serving as a model for digitizing other diverse collections.

*Rosewood*

### Wait, What?! We Need More Than Diverse Books?

*Rachel Fecho, Children's Librarian, William Jeanes Memorial Library*

Yes books, but displays, language, facilities, programs, media, and resources must also reflect and teach diversity, equity, and inclusion. Discover practical ways to create a comprehensively diverse experience for families.



*Sagewood*

### Pop-Up: School Bulletin Boards as Outreach and Engagement Tools

*Jaime Poland, Youth Services Librarian, Penn Hills Library*

*Addie Macioce, Library Assistant, Penn Hills Library*

Penn Hills Library staff will discuss our monthly bulletin board pop-ups at a local middle school and the outcomes from the 2022-2023 school year. We will cover the entire process of creating our pop-up bulletin boards from the brainstorming phase to the set up. Various examples will be included.



*Salon D***“Right to Know” and PA Public Libraries: Sharing is Always Good, Right?**Scott Thomas, *CEO, Scranton Public Library*Josh Berk, *Executive Director, Bethlehem Area Public Library*Elizabeth Wagenseller, *Executive Director, Office of Open Records*

This panel discussion will explore the tension between the profession’s values of sharing and openness and concerns about how internal information may be used once shared. The session will also include background information on Right to Know from the PA Office of Open Records.

*Salon E***Beyond The Reluctant Reader: Building A Graphic Novel Collection For Everyone**Mark Conner, *Collection Management Coordinator, Bucks County Free Library*

 ACT 48  
1 Hour

From cultivating important visual literacy skills to featuring diverse and underrepresented voices, graphic novels are a vital form of communication for more than just the reluctant reader. In this lecture we will discuss this value to library collections and how to stay in touch with this growing and changing medium.

*Aloeswood***Caring for the Family Tree: Helping Patrons Select Genealogy Software**Beth M. Transue, *Information Literacy Librarian, Messiah University*Rob Leshner, *PA Forward® Program Manager, Pennsylvania Library Association*

 ACT 48  
1 Hour

This session will help librarians work with patrons to select genealogy software. It will provide an overview of genealogy research products and software. The session will provide knowledge and skills for the reference librarian to successfully assist patrons to select the right software for their individual needs and budgets.

**10:00 AM – 10:30 AM**

**Hotel Checkout**

Hotel check out is 11 a.m., so take advantage of this break to check out and take your belongings to your car before returning for our entertaining Closing Session with New York Times best-selling author, Adriana Trigiani!

**10:30 AM – 12:00 AM**

*Zambezi/Nile/Orange***Closing Session: *The Good Left Undone* with Adriana Trigiani**

Hear from New York Times best-selling author, Adriana Trigiani on her latest book, *The Good Left Undone*, as she discusses her inspiration for the book, family stories, WWII history, and more.

**Refreshments Sponsored by: Old Dominion University**

# •••• 2023 Library Products & Services Expo ••••

*Learn about Trending Products & Services for Libraries in One Place!*

Interaction between conference attendees and exhibitors is crucial for the success of the conference and benefits all. Our exhibitors are our partners and are experts when it comes to new products and services for our libraries. Visiting the exhibit hall is the most efficient way to learn about and consider new innovations from multiple sources!

**Monday, October 2 • 12:30 PM – 5:30 PM**

- 12:30 – 2:00 PM **Exhibits Grand Opening Lunch\***  
Combining lunch and visits with our exhibitor partners!  
*\*Sponsored by PA Citizens for Better Libraries (PCBL)*
- 2:15 – 3:15 PM **Refreshment Break/No Conflict Exhibit Time/Poster Sessions\***  
No sessions scheduled to allow time to visit the exhibits and enjoy a cold beverage. View the posters and connect with colleagues about successful programs and events taking place in Pennsylvania libraries.  
*\*Sponsored by Midwest Tape/hoopla Digital*
- 2:25 – 2:45 PM **EXHIBITOR SHOWCASE**  
***Medicare Fraud Prevention for Professionals***  
*Presented by Dan Milloy, Center for Advocacy for the Rights and Interests of Elders (CARIE)*
- EXHIBITOR SHOWCASE**  
***SPARK and AccessPA Integrate to Make ILLs Easier!***  
*Presented by Katie Greenleaf Martin, Pennsylvania Integrated Library System (PaILS) & Erin Halovanic, Hosting Solutions & Library Consulting (HSLC)*
- EXHIBITOR SHOWCASE**  
***Future-Proof Your Library***  
*Presented by Larry Payne, AIA, NCARB, LEED AP BD+C, WTW Architects*
- 2:50 – 3:10 PM **EXHIBITOR SHOWCASE**  
***Sales Tax: What is It and Why Do Libraries and Friends Groups Have to Pay It?***  
*Presented by Brandt Ensor & Denise Sticha, Pennsylvania Citizens for Better Libraries (PCBL)*

## **EXHIBITOR SHOWCASE**

### ***Partner with HSLC to Strengthen Your Library!***

*Presented by Maryam Phillips, Erin Halovanic & Tracy Carey,  
Hosting Solutions and Library Consulting (HSLC)*

## **EXHIBITOR SHOWCASE**

### ***Patron Engagement – Increase Your Visibility and Attract New Users***

*Presented by Jake Simone, EBSCO*

4:30 – 5:30 PM

### **Visit the Exhibits**

Take advantage of this final opportunity to connect with exhibitors and obtain raffle tickets for a chance to win some awesome prizes!

5:00 – 5:30 PM

### **Raffle Prize Drawings**

Be sure to deposit your exhibitor-supplied raffle tickets for the chance to win a great prize! *You must be present to win.*

**Tuesday, October 3 • 9:30 AM – 2:30 PM**

10:00 – 11:00 AM

### **Exhibits No-Conflict Exhibit Time/Poster Sessions/ Coffee Break\***

No sessions scheduled to allow time to enjoy a hot beverage while visiting the exhibits. View the posters and connect with colleagues about successful programs and events taking place in Pennsylvania libraries.

*\*Sponsored by Brainfuse*

10:10 – 10:30 AM

## **EXHIBITOR SHOWCASE**

### ***Rise to the Challenges of Visibility and Community: Meeting Library Users Where They Are***

*Presented by OCLC*

## **EXHIBITOR SHOWCASE**

### ***Out-of-the-Box Coding Clubs with Fiero Code***

*Presented by Jake Simone, EBSCO*

## **EXHIBITOR SHOWCASE**

### ***Digital Dash***

*Presented by Marne Fellows & Tarita Murray, Baker & Taylor*

**10:35 – 10:55 AM EXHIBITOR SHOWCASE**

***Reading Programs that Actually Work***

*Presented by Jake Ball, Reader Zone*

**EXHIBITOR SHOWCASE**

***Small Games of Chance: Do We Really Need a Permit for That?***

*Presented by Brandt Ensor & Denise Sticha, Pennsylvania Citizens for Better Libraries (PCBL)*

**EXHIBITOR SHOWCASE**

***Expand Health Literacy with ConnectWell***

*Presented by Andrea Bloom, ConnectWell*

**12:15 – 1:45 PM Exhibit Hall “Strolling” Lunch**

Enjoy a casual lunch as you walk through the exhibit hall and take advantage of this last opportunity to meet with exhibitors and collect raffle tickets!

**1:00 – 2:00 PM Poster Sessions**

View the posters and connect with colleagues about successful programs and events taking place in Pennsylvania libraries.

**2:00 – 2:30 PM Raffle Prize Drawings**

Last call for prizes! Be sure to deposit your exhibitor-supplied raffle tickets for the chance to win a great prize!

*You must be present to win.*

## ••••• Our Exhibitor Partners •••••

### **ABDO**

Booth 805

[www.abdobooks.com](http://www.abdobooks.com)

800-800-1312

*ABDO has been a leader in children's educational publishing for school and public libraries since 1985, providing high quality nonfiction and fiction titles for children and young adults in grades PreK–12.*

#### **Representatives:**

Donna Palamara

[donna229@comcast.net](mailto:donna229@comcast.net)

Corey Abrams

[abrams.corey@gmail.com](mailto:abrams.corey@gmail.com)

---

### **Assabet Interactive**

Booth 103

[www.assabetinteractive.com](http://www.assabetinteractive.com)

978-254-1599

*Assabet Interactive provides state-of-the-art event calendar, room booking, museum pass, and Library of Things software for public library websites—intuitive and easy-to-use for both patrons and library staff, with no limits on the number of users, amount of data held, and admin log-in location. All integrate easily with websites on any platform, helping to streamline the delivery of some of the library's most important services.*

#### **Representatives:**

Jonathan Tegg

[jtegg@assabetinteractive.com](mailto:jtegg@assabetinteractive.com)

Robert Levers

[rlevers@assabetinteractive.com](mailto:rlevers@assabetinteractive.com)

---

### **Auto-Graphics, Inc.**

Booth 702

[www.auto-graphics.com](http://www.auto-graphics.com)

909-595-7004

*Auto-Graphics, Inc. has been an industry leader in library management and resource sharing software for 50 years.*

*A-G was the first to provide Cloud-based library resource sharing solutions. Our fully integrated suite of library software products is continually improved and enhanced to address the ever-changing needs of the library community.*

#### **Representatives:**

Susan Rhoad

[shr@auto-graphics.com](mailto:shr@auto-graphics.com)

Albert Flores

[abf@auto-graphics.com](mailto:abf@auto-graphics.com)

---

### **AWE Learning**

Booth 700

<https://awelearning.com/>

917-828-3904

*AWE Learning has more than 25+ years of experience providing early childhood literacy resources to public libraries, early childhood centers, and other community organizations. Our plug-and-play digital learning solutions deliver award-winning, STREAM-aligned content through a safe learning environment. AWE Learning's flagship Early Literacy Station™ Platinum, AfterSchool Edge™ Platinum, and Bilingual Spanish Early Literacy Station Platinum received the 2023 Modern Library Awards. In 2023, AWE Learning released Version 3 Early Literacy Station™ Platinum, AfterSchool Edge™ Platinum, Biligual Spanish and French Early Literacy Stations. Version 3 provides 85+ titles with over 4,500 activities with new vendors and titles.*

#### **Representative:**

Juanita Griscom

[griscomj@awelearning.com](mailto:griscomj@awelearning.com)

---

## **Baker & Taylor**

Booth 803

[www.baker-taylor.com/](http://www.baker-taylor.com/)

800-775-1800

*Baker & Taylor is the largest supplier of library content, software and services to public and academic libraries in the US. Through its Publishers Services business, the company also provides sales, manufacturing, warehousing and distribution support to small and mid-size publishers. With these solutions, Baker & Taylor is on a mission that will benefit thousands by improving community outcomes through literacy and learning.*

### **Representatives:**

Tarita Murray

[tarita.murray@baker-taylor.com](mailto:tarita.murray@baker-taylor.com)

Marne Fellows

[marne.fellows@baker-taylor.com](mailto:marne.fellows@baker-taylor.com)

---

## **Bibliotheca**

Booth 505

[www.bibliotheca.com](http://www.bibliotheca.com)

678-336-7980

*Bibliotheca is dedicated to the development of innovative technologies and library management solutions that help sustain and grow libraries around the world. Bibliotheca reimagines how libraries function, using integrated technology to inspire and delight all kinds of people, wherever they are: at home, on the move, or within the library walls. Bibliotheca employs 400 people across 21 countries, partnering with 30,000 libraries to make the library experience—physical and digital—seamless, intuitive, and inclusive.*

### **Representatives:**

Bryan Pasteryk

[b.pasteryk@bibliotheca.com](mailto:b.pasteryk@bibliotheca.com)

Molly Haines

[m.haines@bibliotheca.com](mailto:m.haines@bibliotheca.com)

## **Bloomerang**

Booth 704

<https://bloomerang.co/>

866-322-2999

*Indianapolis-based Bloomerang is the complete donor management solution that helps thousands of small and medium-sized nonprofits deliver a better giving experience and create stable, thriving organizations. Combining robust, simple-to-use technology with people-powered support and training, Bloomerang empowers nonprofits to work efficiently, improve their donor relationships and grow their donor bases. With Bloomerang, nonprofit professionals love their work and have another teammate in the cause.*

### **Representative:**

Chad Barger, CFRE, ACNP

[chad@productivefundraising.com](mailto:chad@productivefundraising.com)

---

## **Book Systems, Inc.**

Booth 502

[www.booksys.com](http://www.booksys.com)

800-219-6571

*Atrium, our cloud-based Integrated Library System (ILS), is built on a foundation of over 30 years of library technology experience. This ultimate library management solution includes many advanced features such as configurable user interfaces, customizable reports, mobile searching, and eBook resource sharing. It also incorporates LDAP and Google Single Sign-On (SSO), Self-Service OPAC options (patrons can manage renewals, reserves, watch lists, etc.), and industry standard SIP2, NCIP, and Z39.50 protocols.*

### **Representative:**

Bruce Price

[bprice@booksys.com](mailto:bprice@booksys.com)

## **Bound to Stay Bound Books**

Booth 503

[www.BTSB.com](http://www.BTSB.com)

800-637-6586

*We provide prebound juvenile library books with full processing and automation support available. We now also offer a wide array of paperback titles and Playaway audio books.*

### **Representative:**

Jeff Meskill

[sales@btsb.com](mailto:sales@btsb.com)

---

## **Brainfuse**

Booth 405

<https://home.brainfuse.com/>

866-272-4638

*Brainfuse is a premier online homework help provider, serving millions of library patrons nationwide. Through an easy-to-use online classroom, Brainfuse offers state-aligned one-to-one tutoring, intensive writing assistance, targeted skills building, test preparation, and a full line of collaborative learning and self-study tools. Brainfuse also offers a job coaching service, which includes on-demand access to trained career experts who provide live interview coaching and resume assistance. Ask about our newest service, VetNow. Live navigators help veterans and their families understand and apply for the benefits they are eligible for from local, state, or federal programs. From housing and health care to education, mental health and more!*

### **Representative:**

Diane Bizzle

[dweltzer@brainfuse.com](mailto:dweltzer@brainfuse.com)

## **Britannica Education**

Booth 202

[www.britannicaeducation.com](http://www.britannicaeducation.com)

740-275-7655

*We believe every learner has the potential to succeed and that education is the key to unlocking that potential. That's why we provide a comprehensive selection of digital curriculum tools, professional learning programs, and ongoing support to help educators plan, deliver, and assess instruction more effectively.*

### **Representatives:**

Rick Booms

[booms@eb.com](mailto:booms@eb.com)

Christopher Heintz

[cheintz@eb.com](mailto:cheintz@eb.com)

---

## **Brodart Co.**

Booths 401/402

[www.brodart.com](http://www.brodart.com)

800-233-8467

*Since Brodart pioneered the book jacket cover in 1939, we have concentrated exclusively on helping libraries better serve their patrons. Today, Brodart provides a broad range of collection development/cataloging services, McNaughton Leasing, supplies and furnishings and custom furniture — all tailored to the unique needs and perspectives of libraries. Our singular focus and specialized expertise enable us to solve problems that others cannot. In short, Brodart knows libraries.*

### **Representatives:**

Amber Raudabaugh

[Amber.Raudabaugh@brodart.com](mailto:Amber.Raudabaugh@brodart.com)

Erica Sommer

[Erica.Sommer@brodart.com](mailto:Erica.Sommer@brodart.com)

Bennett Wilder

[Bennett.Wilder@brodart.com](mailto:Bennett.Wilder@brodart.com)

Michael Zingaro

[Michael.Zingaro@brodart.com](mailto:Michael.Zingaro@brodart.com)

## **Calgi Construction Company, Inc.**

Booth 603

[www.calgiconstruction.com](http://www.calgiconstruction.com)

914-682-9423

*Construction Management Services*

### **Representative:**

Dominic Calgi

[dcalgi@calgiconstruction.com](mailto:dcalgi@calgiconstruction.com)

---

## **CARIE**

Booth 605

<https://www.carie.org/>

1-800-356-3606

*Medicare loses nearly \$100 BILLION annually to fraud, taking money out of taxpayers' pockets and compromising beneficiary health. The Pennsylvania Senior Medicare Patrol (SMP), a federally funded program out of Health and Human Services, provides outreach, education, and advocacy to empower beneficiaries to take an active role in their health care. The SMP provides materials, speaking engagements, professional training, and one-on-one advocacy. In Pennsylvania, the program is supported by CARIE, the Center for Advocacy for the Rights and Interests of Elders, a non-profit advocacy organization in Philadelphia. To join the SMP in fighting fraud, visit our website, stop by our table or attend our showcase presentation on Monday.*

### **Representative:**

Dan Milloy

[milloy@carie.org](mailto:milloy@carie.org)

---

## **ChiliFresh.com**

Booth 302

[www.ChiliFresh.com](http://www.ChiliFresh.com)

913-244-0244

*Craft an engaging and intuitive library experience for both your staff and patrons with our next-gen online catalog solutions. Dive deeper into understanding your patrons, tailor your services by*

*analyzing anonymous user behavior, and continuously evolve your catalog to better serve your community.*

### **Representative:**

Scott Johnson

[jscott@chillifresh.com](mailto:jscott@chillifresh.com)

---

## **ConnectWell**

Booth 802

[www.connectwell.health](http://www.connectwell.health)

925-487-9370

*ConnectWell is an "all-in-one" digital health and wellness information resource that is academically sourced and designed for a consumer audience to engage people in their health and well-being. ConnectWell selectively curates health content from trusted sources to provide the latest standard of care guidelines and scientific findings on health, wellness, disease management, and nutrition. ConnectWell can help you upgrade the Health Literacy Programming that you are doing through PA Forward®.*

### **Representatives:**

Andrea Bloom

[abloom@connectwell.health](mailto:abloom@connectwell.health)

Shannon Goldrick

[sgoldrick@aol.com](mailto:sgoldrick@aol.com)

---

## **Creativebug**

Booth 200

<https://www.creativebug.com/>

779-220-0454

*Creativebug is the easy to use, high-quality online art & craft education resource used by more than 1,100 libraries worldwide. Patrons have unlimited access to thousands of classes for every skill level.*

### **Representative:**

Meghan Haddad-Null

[meghan.haddad-null@creativebug.com](mailto:meghan.haddad-null@creativebug.com)

## **D-Tech International USA, LLC**

Booth 300

[www.d-techinternational.com](http://www.d-techinternational.com)

609-435-5846

*Smart Locker Solution for media vending, self-service capabilities and device charging all in one.*

### **Representatives:**

Anne Lawler

[anne.lawler@D-techinternational.com](mailto:anne.lawler@D-techinternational.com)

Quinn Bithell

[quinn.bithell@d-techinternational.com](mailto:quinn.bithell@d-techinternational.com)

---

## **EBSCO Information Services**

Booth 207

[www.EBSCO.com](http://www.EBSCO.com)

800-653-2726

*EBSCO Information Services (EBSCO) is the preeminent provider of online research content and search technologies serving academic, school and public libraries including research, acquisition management, subscription services, discovery and analytics. EBSCO provides access to content and resources to serve the information and workflow needs of library users and organizations.*

### **Representatives:**

Jake Simone

[jsimone@ebSCO.com](mailto:jsimone@ebSCO.com)

Barbara Donlon

[bdonlon@ebSCO.com](mailto:bdonlon@ebSCO.com)

---

## **Edible Education - Kitchen a la Cart**

Booth 100

[www.edibleedu.com](http://www.edibleedu.com)

804-218-7903

*The Kitchen a la Cart is a complete, portable, kitchen on wheels. Decked out with hot and cold running water, induction burner and convection oven, and workspace for 10 students. The Fully Loaded Kitchen a la Cart comes with all the smallwares needed to create wonderful food as your community and clients*

*become excited about real food!*

### **Representatives:**

Ann Butler

[ann@edibleedu.com](mailto:ann@edibleedu.com)

Chef Raisa Wingen

---

## **EnvisionWare**

Booth 701

[www.envisionware.com](http://www.envisionware.com)

1-678-382-6500

*EnvisionWare was formed almost 20 years ago with a single purpose – to create innovative, self-service and efficiency solutions that enhance library services and empower patrons. This mission continues to be the driving focus of EnvisionWare today, backed by a commitment to ensure that every library, regardless of size, receives the highest level of customer service and support.*

### **Representative:**

Jake Young

[jacob.young@envisionware.com](mailto:jacob.young@envisionware.com)

---

## **Equinox Open Library Initiative**

Booth 306

[www.equinoxoli.org](http://www.equinoxoli.org)

770-872-8139

*Equinox provides innovative open source software for libraries of all types. We provide a wide range of services, including consultation, migration, implementation, development, training, and hosting services.*

### **Representatives:**

Galen Charlton

[gmc@equinoxOLI.org](mailto:gmc@equinoxOLI.org)

Felicia Beaudry

[felicia.beaudry@equinoxOLI.org](mailto:felicia.beaudry@equinoxOLI.org)

---

## **FacilitySight**

Booth 301

<https://facilitiesight.io>

380-212-2825

*FacilitySight helps you empower your staff with real time patron data. Libraries across the country use FacilitySight to inform their decision making, improve operations, and maximize funding.*

### **Representatives:**

Klaus Duren

[klaus@facilitiesight.io](mailto:klaus@facilitiesight.io)

Joshua Grimm

[joshua@facilitiesight.io](mailto:joshua@facilitiesight.io)

---

## **First Nonprofit**

Booth 706

[www.firstnonprofit.com](http://www.firstnonprofit.com)

814-940-1733

*First Nonprofit has helped 2,200 nonprofits across the country, including many of Pennsylvania's libraries, save millions of dollars on State Unemployment Insurance (SUI). FNP also provides a robust Employee Retention Credit (ERC) program that has helped organizations recover over \$6.7 million! Request a free, no obligation unemployment savings evaluation and ERC assessment!*

### **Representative:**

John H. Eichelberger, Jr.

[team@completeinsurancepa.com](mailto:team@completeinsurancepa.com)

---

## **Gale**

Booth 607

[www.Gale.com](http://www.Gale.com)

248-699-8988

*Gale partners with educators and librarians to connect learners and researchers to essential content through accessible technology. In collaboration with academic institutions, schools, and public libraries, Gale helps learners push past traditional research boundaries, excel in their careers, and unlock the power and*

*joy of learning. Learn more at [gale.com](http://gale.com).*

### **Representatives:**

Jackie Sullivan

[jackie.sullivan@cengage.com](mailto:jackie.sullivan@cengage.com)

Monica Wilson

[monica.wilson@cengage.com](mailto:monica.wilson@cengage.com)

---

## **Hosting Solutions and Library Consulting (HSLC)**

Booth 504

[www.hslc.org](http://www.hslc.org)

215-222-1532

*Since 1988, Hosting Solutions and Library Consulting, dba HSLC, has furthered the missions of Pennsylvania Libraries by delivering technical solutions and consulting services. HSLC's diverse and experienced team of Librarians and IT specialists is standing by to help Pennsylvania libraries further their own missions and better serve their communities. Stop by and learn how our new suite of consulting services can spell success for your library!*

### **Representatives:**

Tracy Carey

[tcarey@hslc.org](mailto:tcarey@hslc.org)

Erin Halovanic

[ehalovanic@hslc.org](mailto:ehalovanic@hslc.org)

---

## **IMR Digital a KDI Company**

Booth 903

[www.imrdigital.com](http://www.imrdigital.com)

800-582-6319

*IMR Digital, a KDI Company, is your leading provider of document scanning, imaging, and indexing services. Acquired by KDI in April 2019, IMR Digital has offered a wide range of file and document conversion services since 1978. From Large Format Scanning to Documents and Files and Specialty Scanning, IMR Digital can assist with all your conversion needs. The Department of General Services, Bureau of Procurement, has*

granted IMR Digital authorization to participate in the COSTARS Program. We are proud to be an IIMDA Member and Associate Member/Business Partner of PSATS, Pennsylvania State Association of Township Supervisors.

**Representatives:**

Chris Malatesta

[cmalatesta@imrdigital.com](mailto:cmalatesta@imrdigital.com)

Alex McGuffin

[alex.mcguffin@imrdigital.com](mailto:alex.mcguffin@imrdigital.com)

---

### **Infovision Software**

Booth 104

[www.infovisionsoftware.com](http://www.infovisionsoftware.com)

1-800-849-1655

*Evolve ILS and its mobile app are used in libraries of varying sizes, from 10,000 to 200,000 holdings. The Evolve Library Management System is a state-of-the-art integrated library system that saves you time and money while making it easy to manage your entire library collection and circulation. Designed for use in public, school, academic and special libraries. Evolve quickly and easily handle your daily activities while freeing up staff to serve your patrons with other valuable services.*

**Representatives:**

Bruce Elliott

[belliot@infovisionsoftware.com](mailto:belliot@infovisionsoftware.com)

Matthew Thomas

[mthomas@infovisionsoftware.com](mailto:mthomas@infovisionsoftware.com)

---

### **Ingram Content Group**

Booth 604

<https://www.ingramcontent.com/>

615-213-5346

*Books — printed ones, digital ones, in all their formats and the technology that keeps them moving across the globe — these are our passions and for more than 50 years they have been what we have worked to perfect every day at Ingram*

*Content Group. The world is reading, and it is our goal to connect as many people to the content they want in the simplest ways.*

**Representative:**

Doug Voss

[Doug.Voss@ingramcontent.com](mailto:Doug.Voss@ingramcontent.com)

Steve Sutton

[steve.sutton@ingramcontent.com](mailto:steve.sutton@ingramcontent.com)

---

### **J. P. Jay Associates, Inc.**

Booth 101

[www.jpjay.com](http://www.jpjay.com)

610-435-9666

*Library shelving & Furniture*

**Representative:**

Jay Malise

[jpm@jpjay.com](mailto:jpm@jpjay.com)

---

### **JanWay**

Booth 807

[www.janway.com](http://www.janway.com)

800-877-5242

*JanWay is librarians' #1 source for customer printed promotional products. Celebrating over 40 years in business, JanWay has provided libraries with products that promote public awareness of programs, services, events, openings and more. Our website is filled with products that have proven to be the most popular in the library market. Best Prices, Best Products, Best Service - Simply the Best!*

**Representatives:**

Jamie Foster

[michelle@janway.com](mailto:michelle@janway.com)

Ross Stebbins

[michelle@janway.com](mailto:michelle@janway.com)

## Junior Library Guild

Booth 602

[www.juniorlibraryguild.com](http://www.juniorlibraryguild.com)

1-800-325-9558

*A completely customizable collection-development service based on your preferences, readers' interests, and library's budget. JLG titles are curated by our renowned Editorial Team who read and review thousands of manuscript submissions each year prior to publication to choose award-worthy books for our members.*

### Representative:

Charles Hammer

[chammer@juniorlibraryguild.com](mailto:chammer@juniorlibraryguild.com)

---

## Keystone Teachers Association

Booth 901

[www.keyta.org](http://www.keyta.org)

717-763-1168

*The Keystone Teachers Association provides members with access to professional liability insurance, legal assistance, email updates, professional development, newsletters, state lobbyist that represent teachers in educational issues, state meetings, and much more.*

### Representative:

Carol Yeagy

[carol@keyta.org](mailto:carol@keyta.org)

---

## Library of Accessible Media for Pennsylvanians (LAMP)

Booth 206

[www.MyLAMP.org](http://www.MyLAMP.org)

412-687-8981

*Library of Accessible Media for Pennsylvanians – LAMP serves residents who have difficulty using standard print materials because of a visual, physical, or reading disability. Persons with low vision, blindness, a physical disability that prevents reading or holding a book, or a reading disability such as dyslexia*

*may be eligible for the free service.*

*Library materials are provided through the Library of Congress' National Library Service for the Blind and Print Disabled (NLS). Materials include digital audio-books on flash drive cartridges, braille books and downloads, large print books, digital and braille magazines, tactile and braille early literacy kits, audio described DVDs and more.*

### Representatives:

Mark Lee

[leem@carnegielibrary.org](mailto:leem@carnegielibrary.org)

Carolyn Rees

[reesc@carnegielibrary.org](mailto:reesc@carnegielibrary.org)

---

## Library Speakers Consortium

Booth 801

[www.libraryc.org](http://www.libraryc.org)

504-810-9492

*Best-Selling Author Event program for public libraries across the United States. Affordable and diverse lineup of over a dozen author talks for young adult and adult readers to access throughout the year at less than cost of hosting one author event.*

### Representative:

Leigh Mikovch

[leigh@libraryc.org](mailto:leigh@libraryc.org)

---

## NewsBank, inc.

Booth 601

[www.newsbank.com](http://www.newsbank.com)

1-800-762-8182

*NewsBank is a premier information provider of reliable, vetted and safe primary sources. Our diverse global perspectives challenge and develop critical thinking skills and promote innovation. The resources improve students' information literacy and connect learning to real world events and issues. Stop by our booth to learn how our resources are designed to support curriculum at all grade levels.*

**Representative:**

Ann McGrew  
[amcgrew@newsbank.com](mailto:amcgrew@newsbank.com)

---

**OCLC**

Booth 804  
[www.oclc.org](http://www.oclc.org)  
1-800-848-5878

*OCLC is built on the power of collaboration and innovation. Our member libraries share data, collections, services, and expertise to increase access to knowledge. Through our technology products, original research, and community programs, we empower libraries to solve critical problems, remove barriers to success, and inspire breakthroughs.*

**Representative:**

Jessica Rathjen  
[rathjenj@oclc.org](mailto:rathjenj@oclc.org)

---

**Office of Commonwealth Libraries**

Booth 205  
<https://www.statelibrary.pa.gov/>  
717-783-5725

*The Office of Commonwealth Libraries (OCL) within the Pennsylvania Department of Education (PDE) supports, develops, and provides library services for learning and advancement. The State Library of Pennsylvania and the Bureau of Library Development provide resources and support for Pennsylvanians and the libraries that serve them.*

**Representatives:**

Ellen Shenk  
[ellshenk@pa.gov](mailto:ellshenk@pa.gov)  
Sara Deegan  
[sdeegan@pa.gov](mailto:sdeegan@pa.gov)

---

**OverDrive**

Booth 404  
<https://company.overdrive.com/public-libraries/>  
216-573-6886

*Extend beyond the physical walls of your library by offering access to ebooks, audiobooks, magazines and streaming media. More than 21,000 libraries worldwide rely on OverDrive and our catalog of millions of digital titles from 30,000+ publishers. Popular apps include Libby and Kanopy.*

**Representative:**

Matt Jurns  
[mjurns@overdrive.com](mailto:mjurns@overdrive.com)

---

**Overton & Associates, LLC**

Booth 102  
[www.librarymoving.com](http://www.librarymoving.com)  
516-449-5495

*Library Moving Company with over 35 years of experience encompassing over 900 projects throughout the United States. Our goal is to assist the library throughout the entire move process and enable the staff to experience a stress free relocation project.*

**Representatives:**

Bill Overton  
[boverton@librarymoving.com](mailto:boverton@librarymoving.com)  
Jay Bowerson  
[bill.overton@librarymoving.com](mailto:bill.overton@librarymoving.com)

---

**PA Treasury**

Booth 303  
[www.patreasury.gov](http://www.patreasury.gov)  
717-772-5000

*Marketing for various Pennsylvania Treasury programs.*

**Representatives:**

Karen Carr  
[kcarr@patreasury.gov](mailto:kcarr@patreasury.gov)  
Diana Fishlock  
[dfishlock@patreasury.gov](mailto:dfishlock@patreasury.gov)

---

## **Palmer Hamilton, LLC**

Booth 705

<https://palmerhamilton.com>

800-788-1028

*Palmer Hamilton provides smart, versatile and beautiful furnishing solutions to K-12, higher education, commercial markets, libraries, fab labs and maker-spaces. We began manufacturing more than 70 years ago and quickly became the industry leader in innovation, selection and service.*

### **Representatives:**

Leslie Kearns

[lkearns@palmerhamilton.com](mailto:lkearns@palmerhamilton.com)

Brad Kingsbury

[bradk@creativelibraryconcepts.com](mailto:bradk@creativelibraryconcepts.com)

---

## **Penn State University Press**

Booth 703

<https://www.psupress.org/>

814-865-1327

*Penn State University Press publishes books, journals, and graphic novels of interest to scholars and general readers, with a focus on the humanities and social sciences. The Press is the publisher of two imprints: Eisenbrauns, specializing in scholarly books on biblical studies and the ancient Near East, and Graphic Mundi, a trade imprint of graphic novels for adults and young adults on important topics such as health, the environment, and human rights. Learn more and explore our books and journals online at [psupress.org](http://psupress.org).*

### **Representative:**

Heather Smith

[hms7@psu.edu](mailto:hms7@psu.edu)

## **Pennsylvania Citizens for Better Libraries (PCBL)**

Booth 806

[www.pcbllpa.org](http://www.pcbllpa.org)

800-870-3858

*PCBL is an organization of advocates that speak for libraries throughout Pennsylvania. Membership is open to anyone who wants to see strong, well funded libraries with the best possible library service for all of Pennsylvania's citizens. This roster includes librarians, trustees of libraries, government officials and friends of libraries, as well as the lay citizen user of libraries.*

### **Representatives:**

Brandt Ensor

[brandte@adamslibrary.org](mailto:brandte@adamslibrary.org)

Jairee Counterman

[jcounterman@cumberlandcountylibraries.org](mailto:jcounterman@cumberlandcountylibraries.org)

---

## **Pennsylvania Higher Education Assistance Agency (PHEAA)**

Booth 106

[www.pheaa.org](http://www.pheaa.org)

717-720-2700

*PHEAA - Providing Affordable Access to Higher Education*

### **Representative:**

Nancy Harvey

[nancy.harvey@pheaa.org](mailto:nancy.harvey@pheaa.org)

---

## **Pennsylvania Integrated Library System (PaILS)**

Booth 307

[www.sparkpa.org](http://www.sparkpa.org)

717-873-9461

*Pennsylvania Integrated Library System (PaILS) is a non-profit organization dedicated to providing an ILS created for Pennsylvania libraries and library systems.*

### **Representatives:**

Kat Dannehl

katherine.dannehl@sparkpa.org  
Katie Greenleaf Martin  
kgm@sparkpa.org

---

### **Playaway Pre-Loaded Products**

Booth 304

<https://shop.playaway.com/>

877-893-0808

*Playaway pre-loaded audiobooks, learning apps, videos, and read-alongs give libraries everything they need to promote literacy, bridge the digital divide, and make technology accessible to everyone. No WiFi, no downloads, no separate device needed. All Playaway products are ready-to-use right off the shelf.*

#### **Representatives:**

Donna Sestefano

[ddestefano@playaway.com](mailto:ddestefano@playaway.com)

Bethany Moore

[Bmoore@playaway.com](mailto:Bmoore@playaway.com)

---

### **Plymouth Rocket, Inc.**

Booth 900

[www.plymouthrocket.com](http://www.plymouthrocket.com)

508-210-4337

*Plymouth Rocket offers a number of solutions to choose from based on your organization's needs: EventKeeper - TixKeeper - KitKeeper - EK Registration - EK Rooms - Patron Authentication. Our solutions are used by thousands of organizations to help with event management, reservations, and class registration.*

#### **Representatives:**

Hannah Bailey

[hbailey@plymouthrocket.com](mailto:hbailey@plymouthrocket.com)

---

### **PolicyMap**

Booth 606

<https://www.policymap.com>

215-574-5996

*PolicyMap contains a wide array of community-level data ranging from age characteristics to education levels, transit*

*access, school performance, occupations, and family composition. With our data and mapping tool, libraries gain access to tens of thousands of data points to create maps, reports, and analyses designed to provide you with a deeper understanding of your changing community and help you plan successfully for the future of your library. With PolicyMap you can create maps to visualize the impact of your library and the needs of your community, run community profiles, and analyze your community with multi-layer maps to identify hot spots or gaps.*

#### **Representatives:**

Betsy Minnich

[betsy.minnich@policymap.com](mailto:betsy.minnich@policymap.com)

Aaron Klein

[aaron.klein@policymap.com](mailto:aaron.klein@policymap.com)

---

### **POWER Library (HSLC)**

Booth 203/204

[www.powerlibrary.org](http://www.powerlibrary.org)

215-222-1532

*POWER Library is the online portal to all that Pennsylvania libraries offer, with the core services being the statewide catalog and ILL service, PA Photos and Documents digital repository, Chat with a Library virtual reference service, and e-resources/e-books. Stop by the POWER Library booth and pick up free outreach materials.*

#### **Representatives:**

Vince Mariner

[vmariner@hslc.org](mailto:vmariner@hslc.org)

Ed Wolf

[ewolf@hslc.org](mailto:ewolf@hslc.org)

Maryam Phillips

[phillips@hslc.org](mailto:phillips@hslc.org)

---

## **ProQuest, Part of Clarivate**

Booth 400

<https://clarivate.com/>

734-761-4700

*Clarivate™ is home to leading research, education and library solutions, including Web of Science™, ProQuest™, Ex Libris™ and Innovative™. We connect people and organizations to transformative intelligence and trusted content. Together, we partner with academic institutions and libraries to build a better world by enabling research excellence and student success.*

### **Representative:**

Michael Tooley

[michael.tooley@clarivate.com](mailto:michael.tooley@clarivate.com)

---

## **Reader Zone**

Booth 707

<http://readerzone.com>

208-888-5160

*We help libraries host high-engagement reading programs for patrons of all ages. Reader Zone is a web-based platform that makes it simple for librarians to build reading programs and easy for patrons to join and participate with reading programs through a beautiful mobile app.*

### **Representatives:**

Jake Ball

[jake@readerzone.com](mailto:jake@readerzone.com)

Brian Henderson

[brian@reader.zone](mailto:brian@reader.zone)

---

## **Scholastic Library & Community Partnerships**

Booth 902

<https://teacher.scholastic.com/products/literacypartnerships/index.html>

1-800-387-1437 x6333

*Through our work with educators and community leaders for over 100 years, we recognize the need for programs and resources that help build the capacity*

*of the whole community. With Scholastic library digital programs and literacy partnerships, our goal is to strengthen the bridge between communities and families with equity-focused family and community engagement solutions that support literacy-based initiatives, diversity, and accessibility for all our library partners.*

### **Representatives:**

Morgan Ford

[mford1@scholastic.com](mailto:mford1@scholastic.com)

Maren Misevich

[MMisevich@Scholastic.com](mailto:MMisevich@Scholastic.com)

---

## **SenSource, Inc.**

Booth 403

<https://sensourceinc.com>

800-239-1226

*SenSource is a premier supplier of patron counting solutions for libraries of all sizes. From basic traffic reporting to fully integrated business solutions, we have what you need. Make better business decisions to keep your library relevant and operating efficiently. Knowing the details of your facility's usage enhances justification for funding and expansion as well as provides traffic pattern data for efficient staffing and operations. Visit our booth for a hardware and software demo.*

### **Representatives:**

Brendon Badway

[bbadway@sensourceinc.com](mailto:bbadway@sensourceinc.com)

Andy Clutter

[aclutter@sensourceinc.com](mailto:aclutter@sensourceinc.com)

---

## **Springshare**

Booth 600

[www.springshare.com](http://www.springshare.com)

800-451-3160

*Springshare is a leading cloud-based software provider. Our librarian-first platform includes: LibGuides, the most popular curation and knowledge-sharing tool for libraries; • LibAnswers, an online*

reference and help-desk platform now with 24/7 Chat Cooperative Staffing; • LibCal, the complete calendaring & room booking solution for libraries with interactive floor maps; • LibInsight, a single platform to store and analyze all library data; • LibWizard, the forms, surveys, quizzes, and tutorial building app; • LibConnect, customer relationship management with integrated email marketing; • LibStaffer, manage staff schedules and service point staffing.

**Representative:**

Mazen Khoury

[mazen@springshare.com](mailto:mazen@springshare.com)

---

**StackMap Inc.**

Booth 107

[www.stackmap.com](http://www.stackmap.com)

650-701-7275

Our platform can map any space and provide way-finding tools and digital browsing to help your customers and visitors find what they are looking for and see everything that your space has to offer. When you look something up in a library catalog, we make the process more meaningful by showing you where it is. We allow users to see where computers and rooms are located in a facility. Users will see which computers are available on a digital map that can be embedded anywhere. Our software allows staff to keep everyone up to date as items shift, as well as experiment and visualize floor layout.

**Representative:**

Alexa J. Roy, MLIS

[alexa@stackmap.com](mailto:alexa@stackmap.com)

**Survival Mindset Co.**

Booth 501

[www.survivalmindset.us](http://www.survivalmindset.us)

814-317-6571

Survival Mindset is preparing people for the day they hope will never come. Survival Mindset Co. offers training and consulting services on how to prepare for, respond to, and survive an armed intruder attack. Rick Capozzi, a nationally recognized presenter on preparing for armed intruders, and his team of subject matter experts have backgrounds in law enforcement, military, EMS, Fire, Education, Psychology and more. This trainings will equip you and your staff to strategize, and build muscle memory on how to respond to a variety of emergency situations.

**Representatives:**

Rick Capozzi

[Rick@SurvivalMindset.us](mailto:Rick@SurvivalMindset.us)

Lynn Herman

[LHERMAN77@comcast.net](mailto:LHERMAN77@comcast.net)

---

**Transparent Language, Inc.**

Booth 201

<https://www.transparent.com/libraries/>

603-262-6300

For over 14 years, Transparent Language, Inc. has provided cost-effective, self-paced online language resources to thousands of libraries worldwide through Transparent Language Online with exciting features, including over 120 languages, extensive English materials, engaging learning activities, and an immersive, animated children's language program.

**Representatives:**

Lauren Gancarz

[lgancarz@transparent.com](mailto:lgancarz@transparent.com)

Jim Schmidt

[jschmidt@transparent.com](mailto:jschmidt@transparent.com)

## **Turano Insurance**

Booth 500

[www.turanoinsurance.com](http://www.turanoinsurance.com)

570-253-0301

*Here at Turano Insurance, we have been providing personal and commercial insurance products and services for 50 years! We have multiple library programs, with A+ rated carriers, that can be tailor fitted to your library's needs. Stop by our booth to hear more!*

### **Representatives:**

Luke Turano

[luke@turanoinsurance.com](mailto:luke@turanoinsurance.com)

---

## **University of Pittsburgh School of Computing and Information**

Booth 105

<https://www.sci.pitt.edu//>

724-816-8451

*The University of Pittsburgh, with a 120-year history of educating leaders and innovators in the information professions, offers two degrees: ALA-accredited Master of Library and Information Science and PhD in LIS for those interested in careers in teaching and researching. MLIS students gain in-depth professional experience in their on-campus or online studies, engage in experiential learning using design methods, and pursue individualized career pathways to support their career objectives.*

### **Representatives:**

Mary Kay Biagini

[biagini@pitt.edu](mailto:biagini@pitt.edu)

Tom Dubis

[tom.dubis@gmail.com](mailto:tom.dubis@gmail.com)

## **UPMC for Kids**

Booth 305

[www.upmchealthplan.com/forkids](http://www.upmchealthplan.com/forkids)

800-650-8762

*CHIP, brought to you by UPMC for Kids, provides health insurance, including dental, vision, and pharmacy coverage to children and teens up to age 19. No family makes too much money to qualify for CHIP. For more information, visit us online at [upmchealthplan.com/forkids](http://upmchealthplan.com/forkids) or call us at 1-800-650-8762 (TTY: 711).*

### **Representative:**

Scott Crawford

[crawfords2@upmc.edu](mailto:crawfords2@upmc.edu)

---

## **WTW Architects**

Booth 800

<https://wtwarchitects.com/>

412-321-0550

*At WTW, we are passionate about creating memorable, life enhancing spaces that are highly functional. Our buildings are more than bricks and mortar, they're places of community, life experiences, and personal engagement that celebrate the human spirit. We provide human-centric solutions with a focus on sustainability, inclusion, and well-being. WTW has earned a national reputation as a leader in the programming, planning, and design of higher-ed projects incorporating student-life and collaborative program components.*

### **Representatives:**

Larry Payne

[lpayne@wtwarch.com](mailto:lpayne@wtwarch.com)

## ••••• Exhibitors by Product/Service •••••

<b>Architecture/Space-Planning/ Furniture/Shelving</b>	<u><b>Booth</b></u>	<b>Collection Development and Cataloging</b>	<u><b>Booth</b></u>
Brodart Co.	401,402	Baker & Taylor	803
J.P. Jay Associates, Inc.	101	Brodart Co.	401,402
Overton & Associates, LLC	102	EBSCO Information Services	207
Palmer Hamilton, LLC	705	Junior Library Guild	602
WTW Architects	800		
<b>Audio Books or Digital Downloads</b>		<b>Consulting</b>	
Bibliotheca	505	Calgi Construction Company	603
Brodart Co.	401,402	Hosting Solutions and Library Consulting (HSLC)	504
EBSCO Information Services	207	POWER Library (HSLC)	203,204
Library of Accessible Media for Pennsylvanians (LAMP)	206	Survival Mindset Co.	501
OverDrive, Inc.	404	<b>Digitization/Preservation</b>	
Playaway Pre-Loaded Products	304	Brodart Co.	401,402
<b>Books/eBooks</b>		IMR Digital a KDI Company	903
ABDO	805	NewsBank inc.	601
Baker & Taylor	803	POWER Library (HSLC)	203,204
Bibliotheca	505	<b>Educational Degree/Certification Programs</b>	
Bound to Stay Bound Books	503	University of Pittsburgh, SCI	105
Britannica Education	202		
Brodart Co.	401,402	<b>Insurance Products</b>	
EBSCO Information Services	207	First Nonprofit	706
Gale	607	Keystone Teachers Association	901
Junior Library Guild	602	Turano Insurance	500
Library of Accessible Media for Pennsylvanians (LAMP)	206	UPMC for Kids	305
OverDrive, Inc.	404	<b>Language Learning</b>	
Penn State University Press	703	Transparent Language	201
Playaway Pre-Loaded Products	304		
POWER Library (HSLC)	203,204		
Scholastic Education Solutions	902		

# ••••• Exhibitors by Product/Service •••••

<b>Library Automation (ILS)</b>		<b>Programs/Resources</b>	
	<b><u>Booth</u></b>		<b><u>Booth</u></b>
Auto-Graphics, Inc.	702	CARIE	605
Baker & Taylor	803	ConnectWell	802
Book Systems, Inc.	502	Creativebug	200
ChiliFresh.com	302	Library of Accessible Media	
Equinox Open Library Initiative	306	for Pennsylvanians (LAMP)	206
Ingram Content Group	604	Library Speakers Consortium	801
PA Integrated Library System	307	PHEAA	106
<b>Materials Databases</b>		<b>Reference Materials</b>	
Britannica Education	202	Britannica Education	202
ConnectWell	802	EBSCO Information Services	207
Creativebug	200	Junior Library Guild	602
Equinox Open Library Initiative	306	Library of Accessible Media	
Gale	607	for Pennsylvanians (LAMP)	206
		POWER Library (HSLC)	203,204
<b>Microfilm Readers/Scanners/Copiers/ Printers</b>		<b>RFID, Security &amp; Material Vending Systems</b>	
Brodart Co.	401,402	Bibliotheca	505
		Creativebug	200
		D-Tech International USA LLC	300
		EnvisionWare	701
		SenSource, Inc.	403
<b>Marketing/Fundraising</b>		<b>Technology Products &amp; Services</b>	
JanWay	807	AWE Learning	700
PA Treasury	303	Bloomerang	704
SenSource, Inc.	403	Brainfuse	405
		ChiliFresh	302
		EnvisionWare	701
		Equinox Open Library Initiative	306
		FacilitySight	301
		Infovision Software	104
		NewsBank inc.	601
<b>Music/Video</b>			
OverDrive, Inc.	404		
Playaway Pre-Loaded Products	304		
<b>Periodicals</b>			
EBSCO Information Services	207		
OverDrive, Inc.	404		

## ••••• Exhibitors by Product/Service •••••

### Technology Products & Services *cont'd*

	<b>Booth</b>
OCLC	804
Palmer Hamilton, LLC	705
Plymouth Rock	900
PolicyMap	606
ProQuest, Part of Clarivate	400
Reader Zone	707
Scholastic Education Solutions	902
SenSource, Inc.	403
Springshare	600
StackMap	107

### Youth Services Programming/ Materials

Baker & Taylor	803
Brainfuse	405
Brodart Co.	401,402
Creativebug	200
Edible Education – Kitchen a la Cart	100
Library of Accessible Media for Pennsylvanians (LAMP)	206
PHEAA	106
Scholastic Education Solutions	902

### Other

Assabet Interactive	103
Website software for delivering library services to patrons	
Auto-Graphics, Inc.	702
Resource Sharing (ILL)	
Brodart Co.	401,402
NcNaughton Leasing	
ConnectWell	802
Health & Wellness	

### Other *cont'd*

	<b>Booth</b>
Equinox Open Library Initiative	306
Open Source Software	
JanWay	807
Promotional Products	
Library of Accessible Media for Pennsylvanians	206
Accessibility, Dyslexia, Blindness, Visual disability	
Office of Commonwealth Libraries	205
Library Development Services and State Library Resources	
Overton & Associates, LLC	102
Library Moving	
Palmer Hamilton, LLC	705
MakerSpace, STEAM education	
Pennsylvania Citizens for Better Libraries	806
Nonprofit support for Library Friends groups	
Playaway Pre-Loaded Products	304
Guided Learning Tablets, Read-Along Books paired with Audio	
Policy Map	606
Data and Mapping Platform	
SenSource, Inc.	403
Patron Counting	

## ••••• PaLA Exhibit Raffle •••••

### WHAT?

A number of our generous exhibitors have donated prizes to include Books & Audiobooks, Gift Certificates for Services & Subscriptions and more for conference attendees to win.

### WHEN?

Drawings take place Monday, 5:00 – 5:30 p.m.  
and Tuesday, 2:00 – 2:30 p.m.

***You must be present to win!***

### WHERE?

Prizes are on display in the Exhibit Hall. Our exhibitors are the exclusive means to obtain raffle tickets!

### HOW?

Visit the exhibits and talk to exhibitors!  
Deposit your completed raffle tickets for the prizes you wish to win, then attend the drawings.

**Good Luck!**



**PLA 2024  
Conference**

April 3-5 | Columbus



The Public Library Association (PLA) will be hosting the PLA 2024 Conference, April 3–5, at the Greater Columbus Convention Center in Columbus, Ohio.

Gregg Dodd, Director of Marketing & Communications at Columbus Metropolitan Library will be available in the North Foyer to provide more information about this important event!

***Stop by and chat with Gregg in the North Foyer!***

- Monday, October 1<sup>st</sup> 12:30 PM – 5:30 PM
- Tuesday, October 2<sup>nd</sup> 9:30 AM – 2:30 PM

••••• **Notes** •••••

# PaLA Annual Conference Session Evaluation

<https://forms.gle/VtTdycxTnhNMREkG6>



**Thanks for Attending**

The 2023 PA Library Association Conference.  
Please join us next year at the Hilton Harrisburg!

*October 6 - 9, 2024*

..... **Exhibit Hall** .....

**PaLA Annual Conference & Tradeshow**  
 October 2 & 3, 2023  
 Ballrooms B-C & F-G  
 Kalahari Resort  
 Pocono Manor, PA 18349

100	101	102	103	Food & Beverage	104	105	106	107
-----	-----	-----	-----	-----------------	-----	-----	-----	-----

○ 11' ○ ○ ○ ○

200	201	202	203	204	205	206	207
300	301	302	303	304	305	306	307

○ 10' ○ ○ ○ ○

400	401	402	Prize Area	403	404	405
500	501	502		503	504	505

○ 10' ○ ○ ○ ○

600	601	602	603	604	605	606	607
700	701	702	703	704	705	706	707

○ 11' ○ ○ ○ ○

800	801	802	803	Food & Beverage	804	805	806	807
-----	-----	-----	-----	-----------------	-----	-----	-----	-----

Entrance

Entrance

Entrance

Entrance

**PaLA STORE**

11'

10'

900
901
902
903

**Produced By:**



[www.generalexposition.com](http://www.generalexposition.com)

610-495-8866  
 7.24.23 C. McKenrick V.2  
 64 - 8x10 Booths

Please note: Every effort has been made to ensure the accuracy of all the information contained on the floorplan. However, no warranties are made with respect to this floorplan. If the location of building columns, utilities or other architectural components of the building is a factor in the construction or usage of an exhibit. It is the sole responsibility of the exhibitor to physically inspect the facility to verify all dimensions and locations.

PaLA

Pennsylvania  
Library  
Association

## Meet PaLA Staff Members



**Christi Buker, CAE**  
*Executive Director*  
christi@palibraries.org



**Kimberly Snyder Wise**  
*Meetings Manager*  
kim@palibraries.org



**Rob Leshner**  
*PA Forward® Program Manager*  
rob@palibraries.org



**Susan Wertz, AA**  
*Administrative Assistant,  
Membership Coordinator*  
susan@palibraries.org