



Unitarian Universalist Ministers Association

2010 Ministry Days

June 22-23, 2010

Minneapolis, Minnesota

Welcome

We meet together
to celebrate who we are,
to share the insights which give
meaning and hope to our lives,
to learn from the wisdom of others,
that their truths
may contribute to our understanding.

We meet, we share, we learn;
we celebrate our coming together.

• Edward T. Atkinson

(From the UUM 1997 Worship Materials Collection)



PAGE 2

Ministry Days Schedule

Tuesday, June 22: Hilton Minneapolis

- 4:00-8:00 PM Registration
- 4:30-6:00 PM Singers of the Living Tradition Rehearsal — Ballroom D
- 7:00-8:00 PM Opening Worship — Ballroom D
- 8:00-9:00 PM Conversation with Peter Morales — Ballroom D
- 9:00-10:00 PM Cash Bar Reception

Wednesday, June 23: Hilton Minneapolis

- 7:00AM-5:00PM Meditation Room — Board Room 3
- 7:00-8:15 AM Breakfast — Ballroom A, B, C
- 8:30-10:00 AM Worship 25/50 Year Honorees — Ballroom D
25th — Barbara Wells ten Hove 50th — Kenneth Torquil MacLean
- 10:00 AM Coffee break
- 10:15 AM UUMA Annual Meeting — Ballroom D
UUMPs Annual Meeting — Boardroom 1
- 12:15 PM Buffet Lunch — Ballroom A, B, C
- 1:30-3:00 PM Collegial Conversations
- 3:00 PM Beverage break
- 3:30-5:00 PM Ministerial Conference at Berry Street: — Ballroom D
Lecture by the Rev. Gary Kowalski

Visit the UUMA
Publications and
Membership Booth
GR Expo Hall
#640

FOOD OPTIONS & DINING LOCATIONS

Buffet lunches on Wednesday are available to all those who pre-registered.

No meals are available for those who registered onsite

Dining Locations:

- ◆ **General Lunch Areas** — Ballroom A, B, C
- ◆ **Easy Access** — At our Buffet Meals, some tables closest to the food tables have been designated "Easy Access" to help those with mobility or other limitations. Some may want/need to sit at other tables throughout our space. As a community, we all can be helpful to our colleagues wherever they are seated by being mindful of ways we might assist them to more easily enjoy their meals.
- ◆ **Special Interest Groups** — Table markers are available for groups to meet during breakfast and/or lunch. If you represent a Special Interest Group, please see the Registration Desk for a Table Marker. The following groups have already planned a table:

Part Time Ministers

UURMaPA: UU Retired Ministers and Partners Association

TRUUsT: Transgender Religious professional UUs Together organization.

Singers of the Living Tradition

Beth Syverson, Director

Choir for the 25/50 Year Worship Service (Wednesday 8:30AM)
And the Service of the Living Tradition (Thursday 7:30 PM)

All Are Welcome!

UUMA Members, Aspirants and Candidates,
LREDA members, UUMN members, spouses and partners.

Rehearsal: Tuesday, June 22—Ballroom D
4:30—6:00 p.m.

Beth Syverson is Director of Music Ministries at Orange Coast Unitarian Universalist Church, Costa Mesa, CA.



ANNUAL

Chapter Leader Breakfast

Friday, June 25, 2010

8 a.m. to 9:30 a.m.

Hilton Minneapolis
Marquette IV

RSVP Required



The Executive Committee of the
Unitarian Universalist Ministers Association
cordially invites all ministerial aspirants and candidates to the

ANNUAL STUDENT BREAKFAST

Thursday, June 24, 2010 8 a.m. to 9 a.m.

- Hilton Minneapolis : Grand Ballroom Salon E -

RSVP Required

2010 MINISTRY DAYS
JUNE 22-23, 2010





PAGE 4

COLLEGIAL CONVERSATIONS

Hopes and Challenges: Planning for and Living With Retirement— Board Room 1

A collegial conversation with a panel of retired colleagues who will share their experiences and wisdom related to planning for, deciding upon, and moving into retirement. What is helpful? What are the joys? What are the unexpected shifts? Bring your questions, hopes and concerns. Rev. Makaanah Morriss, President, UU Retired Ministers and Partners Association, moderator.

That's Life in the Big City! (Inner City / Urban Ministry)— Director's Row 1

While many of our biggest churches are found in cities, many inner-city UU churches are floundering. Some continue a retreat to the suburbs. With so much ministry education burdened by assumptions of suburbianity; insights into, and support for urban ministry can be hard to come by. Urban ministers Alma Crawford, Colin Bossen, & Nancy Palmer Jones facilitate an exploration of both the challenges and the opportunities for UU ministry in the inner city.

Interim Ministry: What's in It for You?— Director's Row 2

Join two Accredited Interim Ministers for a conversation about interim ministry as a chosen professional path and about how interim ministers seek to serve the colleagues who precede and succeed them.

Send Me Lord: The Journey of Good Offices— Carvers Room (1st Floor)

Fred Muir will lead Good Offices Persons (present or via webinar) through the new Handbook that has been posted on the UUMA website. With recent updates along with presentations and information gathered at the 2009 GOP workshop, the instruction will be informative and the conversation insightful.

Better... Stronger... Faster... (Well, the first two anyway!) A New Vision for CENTER— Ballroom F

CENTER is committed to giving you the best in more ways and with clearer focus. We know you want more depth and more time and more collegiality and we are responding to your clear requests for these. Come talk with us about what's changing and why – we look forward to sharing our vision and excitement and hearing your concerns and hopes.

Whose Are We: A Sneak Peek— Ballroom D

Join us for a conversation designed to help us go deeper as colleagues in sharing our spiritual lives, and articulating our theology. Facilitators from each UUMA Chapter will be leading such conversations in your area, but come and get a preview today.

Exploring the Future of Ministry: Who's Doing What?— Ballroom E

Why has ministry turned out to be the topic of choice for multiple study groups this year? What are the issues? Who is studying what and why? Come, listen and ask questions with UUA Vice President of Ministries and Congregational Support, Harlan Limpert, and chair of the Commission of Appraisal, Barbara Child.

Stepping Up to the Plate: A Conversation with the Nominating Committee— UUMA Suite 1936

Have you considered volunteering to serve your colleagues at the continental level but don't know how to get your name in for consideration? We'd love to talk to you about your gifts. Our goal is to broaden our process and make it more intentional.

A Vision of Excellence: The Future of the UUMA— Marquette VII

The UUMA is in the midst of radical change. New staff, new programs, new partnerships, new possibilities for engaging and serving all our members. Join our new President, Bill Hamilton-Holway, and our Acting Executive Director, Don Southworth, for a conversation about the vision and direction of the UUMA...and your role in making it happen.

Standards of Practice: The Next Part of the Conversation— Marquette VIII

As we begin the final year of study and discussion around the major revision of our professional guidelines, the Code of Conduct is now in place, and we look to the more subtle advice about good practice that we give to one another as colleagues in the Standards section. The Guidelines Revision Committee welcomes your input and conversation to help us perfect these Standards for a final vote next year.

The Changed Nature of Ministry: Views From the Community— Marquette VI

It has now been twenty years since community ministry has been an “official” ministry of the UUA but, of course, community ministry has been around for hundreds if not thousands of years. In the changing religious landscape of the 21st century community ministry will be an even more critical to the future of Unitarian Universalism. Join community ministers in a conversation about what is happening today and the role community ministry will play in the future.

Hilton Minneapolis Facility Map

THIRD FLOOR

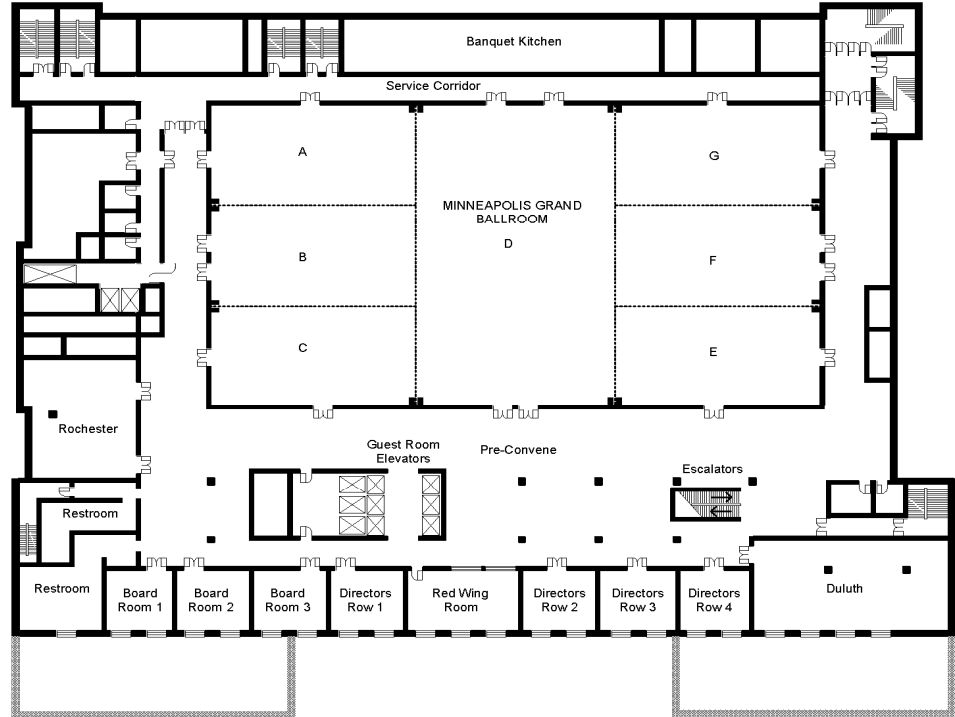

SECOND FLOOR

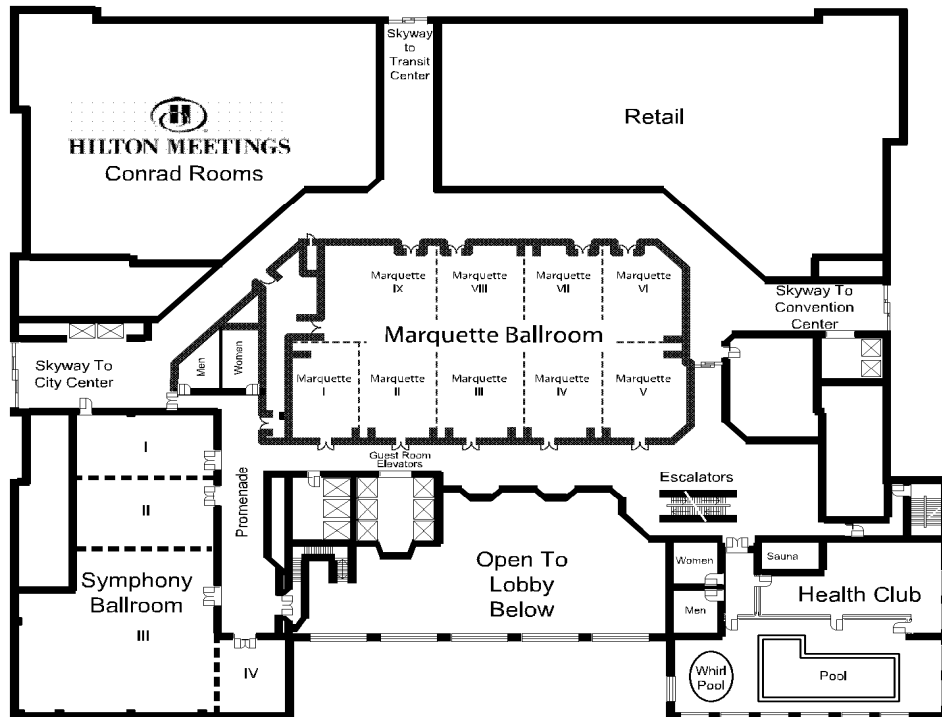

TransGender/Family Restroom located in a hotel guest room. Keys and Room Number are available from the Registration Table or TRUUsT Members Gail Geisenhainer or Paul Langston-Daley.

2010 MINISTRY DAYS
JUNE 22-23, 2010



UNITARIAN UNIVERSALIST MINISTERS ASSOCIATION

ANNUAL MEETING AGENDA

Wednesday, June 23, 2010 Minneapolis, Minnesota

- ◆ Invocation and Call to Order Rob Eller-Isaacs, President
- ◆ Worship: A Celebration of Our Ministry
- ◆ Approval of 2009 Annual Meeting Minutes Alan Taylor, Secretary
- ◆ Appointment of Parliamentarian (Eric Kaminetzky) and Time Keeper (Sarah Lammert)
- ◆ Adoption of Rules & Procedures:
 - No person may speak for more than three minutes on any one item.
 - No person may speak more than once on any one item as long as anyone else wishes the floor.
 - After initial presentation, debate time for each item requiring a vote shall be ten minutes. After ten minutes, a motion shall be automatically put, "Shall debate be extended for ten minutes?" Any time that a majority shall fail to extend time, debates shall be closed and the question on the floor put to a vote.
 - Any proposal by the Executive Committee shall automatically come before the body. Items to be presented under Other Business, must be presented in written form to the secretary or president before 9:00 AM, Wed., June 23, 2010.
- ◆ Nominating Com. Report, Appointment of Tellers, Collection of Ballots Leslie Takahashi-Morris, Chair
- ◆ Election of New Member to the Ministerial Conference in Berry Street
- ◆ President's Report Rob Eller-Isaacs, President
- ◆ Treasurer's Report, Adoption of 2010-2011 Budget Marni Harmony, Treasurer
- ◆ Acting Executive Director's Report Don Southworth, Acting Executive Director
- ◆ Membership Report Janette Lallier, Administrator
- ◆ Guidelines Revision Committee Report (see enclosed supplement for details) Kendyl Gibbons, Chair
 - ◆ Proposed Code of Professional Practice (Code of Conduct) from the GRC
 - ◆ Bylaw Revisions
 - ◆ Proposed Guidelines: Presentation of Standards for Professional Practice for 2009-10 Chapter Study
- ◆ CENTER Institute for Excellence in Ministry CENTER Committee
- ◆ Other Business
 - Response to UUA Board's 2012 GA Resolution
- ◆ Report of Election Tellers,
Announcement of Incoming UUMA Exec Members
- ◆ Recognitions and Thanks
- ◆ Adjournment

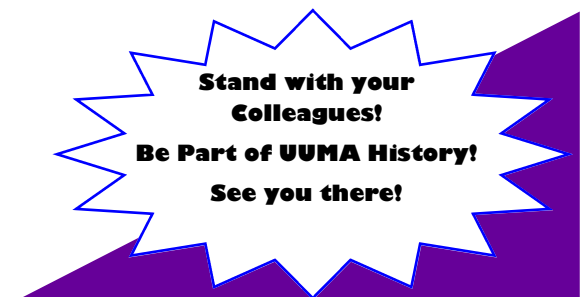

**Stand with your
Colleagues!
Be Part of UUMA History!
See you there!**

2011 Proposed Budget

| | FY11 Proposal | FY10 to date | FY10 Budget | FY09 Actual | FY09 Budget |
|--|---------------------|----------------------|---------------------|---------------------|---------------------|
| Income | | | | | |
| 101 Membership Dues | 361,500.00 | 297,704.01 | 300,000.00 | 230,116.15 | 232,333.00 |
| 102 Interest & Misc. Income | 2,000.00 | 1,647.24 | 3,000.00 | 3,161.30 | 4,000.00 |
| 106 Ministry Days | 84,000.00 | 43,045.77 | 82,500.00 | 128,176.42 | 75,000.00 |
| 107 Publications | 750.00 | 981.05 | 2,000.00 | 1,603.26 | 2,500.00 |
| 108 25/50 Collection (formerly Living Tradition) | 10,000.00 | | 10,000.00 | 15,199.08 | 10,000.00 |
| 111 from UUA (FY09/10 Excellence in Ministry*) | | 51,740.00 | 60,000.00 | 6,200.00 | |
| 500 Transfer from Funds | | 7,460.78 | | | |
| 700 Grant Money Received * | | 23,843.42 | | | |
| Total Income | \$458,250.00 | \$ 426,422.27 | \$457,500.00 | \$399,358.66 | \$323,833.00 |
| Expenses | | | | | |
| 202 Council on Church Staff Finances | 150.00 | | | | |
| 203 Good Offices--Exec | 4,000.00 | 27.68 | 5,800.00 | 2,623.36 | 2,800.00 |
| 204 Good Offices--Chapter | 1,500.00 | 100.00 | 2,000.00 | 693.10 | 2,000.00 |
| 204 Pre GA Training (GOP/Chapter) | 7,000.00 | | | 6,212.27 | |
| 206 Ministry Days Expenses | 84,000.00 | 1,312.84 | 82,500.00 | 107,133.42 | 75,000.00 |
| 208 Donations from 25/50 Collection | 10,000.00 | | 10,000.00 | 15,199.08 | 10,000.00 |
| 210 Chapter Subsidy | 8,000.00 | 4,400.00 | 8,000.00 | 5,600.00 | 8,000.00 |
| 211 Chapter Connections | 1,000.00 | 312.01 | 1,500.00 | 2,027.05 | 2,500.00 |
| 212 UURMAPA Subsidy | 1,000.00 | 500.00 | 500.00 | 500.00 | 500.00 |
| 220 Publication & Communication Expenses | 6,300.00 | 4,322.80 | 7,300.00 | 9,751.81 | 11,000.00 |
| 229 Web Design and Maintenance | 7,000.00 | 9,822.50 | 4,000.00 | 2,364.62 | 3,000.00 |
| 230 Exec Committee Meetings | 64,000.00 | 44,815.22 | 65,000.00 | 56,681.89 | 58,200.00 |
| 231 Guidelines Committee | 2,000.00 | 8,720.61 | 5,000.00 | 5,000.00 | 5,000.00 |
| 232 Nominating Committee | 250.00 | 95.43 | 100.00 | 21.35 | 100.00 |
| 233 Finance Committee | 100.00 | 38.53 | 100.00 | 47.84 | 100.00 |
| 234 Personnel Committee | 500.00 | 128.57 | 500.00 | 488.02 | 500.00 |
| 235 Financial Education and Advocacy Committee | 500.00 | 0.00 | 500.00 | | 500.00 |
| 240 Focus Groups | 850.00 | 593.93 | 2,000.00 | 452.40 | 2,000.00 |
| 242 Cmte on Ethics-Collegiality Fy09 close into Line 203 | | | | 74.31 | 5,000.00 |
| 243 Committee on Ministry for ARAOM | 5,500.00 | 1,106.75 | 6,500.00 | 4,712.92 | 6,500.00 |
| 244 Prof. Leadership Cord. Council (FY09 disbanded) | | | | | 2,000.00 |
| 250 President's Travel Expenses | 2,000.00 | 1,320.86 | 2,000.00 | 2,018.41 | 2,000.00 |
| 251 ED Travel/Professional Expenses | 10,000.00 | 8,480.47 | 10,000.00 | | |
| 252 Admin Professional Expenses | 1,500.00 | 996.04 | 1,700.00 | 971.53 | 1,000.00 |
| 253 Office Expenses | 18,800.00 | 11,825.09 | 21,000.00 | 15,306.31 | 12,000.00 |
| 254 President's Administrative Supp | 500.00 | | 500.00 | | 500.00 |
| 255 Computer/Fax Hard/Software | 1,000.00 | 1,860.62 | 1,000.00 | | 1,000.00 |
| 256 Int'l Collegiality | 1,000.00 | | 1,500.00 | 1,303.77 | 1,500.00 |
| 260 CENTER | 38,600.00 | 23,312.96 | 41,600.00 | 39,794.86 | 45,500.00 |
| 265 Institute for Excellence In Ministry | | 13,460.22 | 30,000.00 | | |
| 270 Staff Salary Reimbursement | 124,800.00 | 85,519.98 | 111,400.00 | 42,000.00 | 42,000.00 |
| 271 Staff Benefits | 43,700.00 | 28,375.72 | 26,000.00 | 14,417.13 | 14,338.00 |
| 272 Payroll Expense | 500.00 | 441.68 | 500.00 | 427.78 | 425.00 |
| 273 Search Committee Costs | 5,000.00 | | | | |
| 274 UUMA Storage | 2,650.00 | 2,429.13 | 2,650.00 | 2,520.00 | 2,520.00 |
| 280 Misc Expense | 1,000.00 | 0.00 | 1,000.00 | 1,000.00 | 1,000.00 |
| 290 Bonding/Insurance | 350.00 | 0.00 | 350.00 | | 350.00 |
| 293 Financial Review / Audit | 2,000.00 | 0.00 | 2,000.00 | | 2,000.00 |
| 294 Bank Account Fees | 50.00 | 8.00 | 50.00 | 44.00 | 50.00 |
| 295 Credit Card Fees | 600.00 | 367.84 | 400.00 | 213.95 | 400.00 |
| 301 Grants | 0.00 | | 2,000.00 | 883.99 | 2,000.00 |
| 309 UUMA Sermon Awards | 550.00 | 0.00 | 550.00 | 550.00 | 550.00 |
| 800 Grant Money Expended* | | 3,805.84 | | 14,902.45 | |
| Total Expenses | \$458,250.00 | \$ 258,501.32 | \$457,500.00 | \$385,472.84 | \$323,833.00 |
| Difference | \$ - | \$ 167,920.95 | \$ - | \$ 13,885.82 | \$ - |

* Grants include Whose Are We (\$18K) and remainder CENTER Initiative(~\$6k)



Annual Meeting: Report of the Treasurer

2010-2011 Dues Structure Revisited

At the 2010 Annual Meeting the membership raised questions regarding the new dues structure. The Executive Committee reviewed the concerns and realities of a sliding scale. The topics the committee considered were: equity at the highest and lowest salary ranges, solutions to discomfort around reporting S&H and in reporting tax information for waivers, the great disparity of outside organizational commitments, issues around professional expense packages, and the ability to administer the dues plan. The following dues structure we are recommending addresses as many concerns as possible while ensuring we have the resources to continue to live into our vision of a stronger, more effective UUMA. While we acknowledge that there is no system that will be 100% equitable across all income levels we hope you will see that the spirit of this structure is intended to level the field as much as possible. Please assume our good intentions and bring your individual concerns to either the office or treasurer. Please remember that waivers are available for those unable to pay the minimum; we especially encourage those of you who are making less than \$20,000 a year to consider asking for a full waiver. Payment plans are also available. Although the chart does not extend past \$100K, those making an income beyond that are welcome to pay .75% of their income.

Additional Dues Categories:

- One-Time Temporary Financial Hardship: \$144
- Candidate Membership: \$50
- Full Waiver with Supporting Documents: \$0
- Life Members (Yearly Contributions Welcome): \$0

If you belong to a separate organization that is necessary to your ministry, you may use a discount code to deduct a portion of your dues. Associations are assigned codes based on their dues amount. One code is allowed per membership. A partial list (based on data received from your 2009 renewals) is included below. You may submit a request to add an organization by contacting the administrator.

| 2010-2011 Dues Chart | | |
|------------------------------|---------------|------------------|
| Salary Range: | | |
| Your S&H (income) is between | | FY11 Dues (.75%) |
| - | \$ 20,000.00 | \$ 144 |
| \$ 20,001.00 | \$ 25,000.00 | \$ 169 |
| \$ 25,001.00 | \$ 30,000.00 | \$ 206 |
| \$ 30,001.00 | \$ 35,000.00 | \$ 244 |
| \$ 35,001.00 | \$ 40,000.00 | \$ 281 |
| \$ 40,001.00 | \$ 45,000.00 | \$ 319 |
| \$ 45,001.00 | \$ 50,000.00 | \$ 356 |
| \$ 50,001.00 | \$ 55,000.00 | \$ 394 |
| \$ 55,001.00 | \$ 60,000.00 | \$ 431 |
| \$ 60,001.00 | \$ 65,000.00 | \$ 469 |
| \$ 65,001.00 | \$ 70,000.00 | \$ 506 |
| \$ 70,001.00 | \$ 75,000.00 | \$ 544 |
| \$ 75,001.00 | \$ 80,000.00 | \$ 581 |
| \$ 80,001.00 | \$ 85,000.00 | \$ 619 |
| \$ 85,001.00 | \$ 90,000.00 | \$ 656 |
| \$ 90,001.00 | \$ 95,000.00 | \$ 694 |
| \$ 95,001.00 | \$ 100,000.00 | \$ 731 |
| \$ 100,001.00 | and up | \$ 750* |

* or .75% of income

Tier One Discount: \$200

- Nat. Assoc. for the Advancement of Psychoanalysis
- Assoc. of Professional Chaplains (APC)
- Assoc. of Sex Education, Counselors + Therapists
- Amer. Assoc. for Marriage + Family Therapy
- Amer. Assoc. of Pastoral Couns. (CPC Member)
- Can. Assoc. for Pastoral Practice and Education
- Assoc. for Clinical Pastoral Education (ACPE)
- Amer. Theological Library Association
- Amer. Fed. of State, County, & Mun. Employees
- Society of Teachers of Family Medicine

Other Groups as approved by the Treasurer

Tier Two Discount: \$100

- Maryland Department of Mental Hygiene
- Amer. Counseling Association
- MNSCU Inter-Faculty Organization
- Amer. Academy of Religion (AAR)
- Interim Ministry Network
- Assoc. for Persons with Severe Handicaps (TASH)
- Liberal Religious Educators Assoc. (LREDA)
- Amer. Assoc. of Pastoral Couns. (Gen. Member)
- Amer. Ethical Union Nat'l Leaders Council
- Assoc. of Intellectual & Developmental Disabilities
- Amer. Massage & Body worker Practitioner Assoc.

Other Groups as approved by the Treasurer

Tier Three Discount: \$50

- UU Collegium
- UU Historical Society
- Interim Ministry Guild
- Community College Humanities Assoc. (CCHA)
- Spiritual Directors International
- UU Society for Community Ministries (UUSCM)
- National Assoc. of Veterans Affairs Chaplains

Other Groups as approved by the Treasurer

~ CONGRATULATIONS ~

**Congratulations and thanks to the following UUMA Members, ordained in 1960,
whose service to our Association has reached the 50-year mark.**

| | | | |
|-----------------|-----------------|--------------------|-------------------|
| Greta W. Crosby | James E. Grant | Jan V. Knost | Kenneth R. Mochel |
| Neal W. Ferris | James P. Hawley | Kenneth T. MacLean | |

**Congratulations and thanks to the following UUMA Members, ordained in 1985,
whose service to our Association has reached the 25-year mark.**

| | | | |
|--------------------|-------------------|----------------------|---------------------|
| Sarah Barber-Braun | David Keyes | Laurie E. Proctor | Barbara W. ten Hove |
| Beverly M. Boke | Robert J. Klein | Doug Reisner | Robert P. Throne |
| Walter Braman | William D. Main | Mary J. Sellers | Cynthia J. Ward |
| David D. Fanning | Craig A. Moro | Stephen M. Shick | Linda Whittenberg |
| L. A. Foerster | Priscilla Murdock | Charlotte Shivvers | Helene Wolff |
| Florence Gelo | Michael L. Nelson | Suzanne R. Spencer | Gretchen L. Woods |
| Bryan D. Jessup | Emily M. Palmer | Elizabeth B. Stevens | |

.....

~ MINISTRY DAYS 2011 ~

Below are those ministers who will be celebrating anniversaries in June of 2011. If you believe your name to be on this list in error, or feel your name has been omitted please contact Janette Lallier, UUMA Administrator in the office (administrator@uuma.org, 617-848-0498.) To be included in the speaker ballot please notify us by Nov. 1, 2010.

The following UUMA Members, ordained in 1961, will celebrate 50-yrs of service:

| | | | |
|-------------------|---------------------|--------------------|-----------------------|
| George K. Beach | Richard S. Gilbert | Ronald D. Marcy | Robert A. Thayer |
| Ralph H. Cook | Richard A. Kellaway | Berkley L. Moore | Farley W. Wheelwright |
| Robert L. Fulghum | Ronald W. Knapp | Robert J. Ross | |
| Charles A. Gaines | S. H. Leggitt | Rexford J. Styzens | |

The following UUMA Members, ordained in 1986, will celebrate 25-yrs of service:

| | | | |
|---------------------------|---------------------|--------------------|----------------------|
| Mark Allstrom | Carol Fincher | Holly E. Horn | Kenneth M. Reeves |
| F. Jay Deacon | Ruth E. Gibson | Kathy F. Hurt | Patience G. Stoddard |
| Alida M. DeCoster | Karen J. Gustafson | Maureen Killoran | Audrey W. Vincent |
| Donna A. DiSciullo | Catharine W. Harris | Susan Manker-Seale | Bets Wienecke |
| Lucinda S. Duncan | Barbara L. Hebner | Sydney A. Morris | |
| Rebecca A. Edmiston-Lange | David L. Herndon | Lindi A. Ramsden | |

**2010 MINISTRY DAYS
JUNE 22-23, 2010**





PAGE 10

Whose Are We? UUMA Chapter Awards

Attend your UUMA chapter's "Whose Are We?" conversation, tell your congregation and your colleagues about it and help your chapter win \$3,000!

What? UUMA chapters will begin engaging in the "Whose Are We? - A Theological Conversation" program this coming fall. This program will provide UUMA members a chance to reflect and wrestle with the theological, vocational, collegial and personal implications of this and other related questions. The UUMA Executive Committee, with thanks to the Panel on Theological Education and the UU Funding Panel, is awarding \$3,000 each to the three UUMA chapters who participate most fully in this conversation. These awards may be used for future spiritual/theological programming or retreats so that the conversations and connections can continue.

Why? The UUMA Executive Committee has created a vision statement for chapter health by 2014 that states, in part, "We gather in a covenant shaped by a culture of vulnerability, intimacy, trust and accountability to one another in which leadership and learning are embraced." The Whose Are We program will give us a chance to speak intimately and deeply about that which we are called to serve and what nurtures our ministries. The chapter awards will give us the chance to learn more from each other and provide more opportunities for us to share with the larger Unitarian Universalist movement.

How? Participation will be determined by the number of chapter members who attend the Whose Are We conversations and who then preach or write an essay on their experience and share it with their UUMA colleagues.

When? Your chapter leaders and Whose Are We? chapter facilitators will be scheduling the conversations soon. Sermons and essays will be collected from April 1, 2011 through October 31, 2011. Awards will be announced by December 31, 2011.

For more information join the *Whose Are We?* Collegial Conversation in Ballroom D, contact your chapter leaders or the *Whose Are We?* Coordinating Team at whosearewe@uuma.com.

UUMA GA Workshops

Youth Ministry Matters

Thursday 1:00pm - 2:15pm
Convention Center - M100 IJ

After five years of study what have we learned about effective ministry to and with youth? How do our professional religious leaders hope to meet the challenge? Sponsored by the UU Minister's Association, the workshop will feature ministers and religious educators and youth leaders. Presenters: *Rev Allison Miller, Kerri Meyer, Rev. Rob Eller-Isaacs*

Credible Partners Dismantling Racism

Thursday 2:45PM - 4:00pm
Convention Center - 101 ABC

The UU Ministers Association is working hard to become a credible partner with colleagues and communities of color.

UUMA past president, Rob Eller-Isaacs and Anti-Racism chair, Hope Johnson will welcome Beth Zemsky from One Umah Consulting, an expert in multicultural awareness, in considering new approaches to the work. Presenters: *Rev Rob Eller-Isaacs, Rev. Hope Johnson, Beth Zemsky*

What Shared Ministry Really Means

Friday 4:30pm - 5:45pm
Convention Center - 101 FG

Strengthening and growing Unitarian Universalism demands that everyone - ministers, religious professionals, laity, staff - work together and challenge each other to share excellent ministry. What is excellent ministry, how do we know when we are doing it and what is being planned to achieve it? Presenters: *Rev. Don Southworth, Anne Bancroft, Dr. Keith Arnold*

UUMA PUBLICATION PRE-ORDER FORM

ORDER NOW —

Use this form to preorder your copy of **2010 DVD recordings of the CENTER Main Speaker, 25/50 Service, or Berry Street Presentations**. You must enclose payment with your order including shipping— \$5.00 per package (a package is 2 DVDs). Order before August 1, 2010 to receive the below discounted price.

All pre-orders must be received in the office no later than Aug 1, 2010.

| Item | Description | Each | Number | Total |
|--|--|-----------------------|---------------|-------|
| DVD | UUMA 2010 CENTER Main Speaker Presentation | \$15.00 before 8/1 | | |
| DVD | UUMA 2010 25/50 Worship Service | \$15.00 before 8/1 | | |
| DVD | 2010 Berry Street Essay | \$15.00 before 8/1 | | |
| Please return while at ministry days or mail to: UUMA, 25 Beacon Street, Boston, MA 02108 before Aug 1, 2010 You may also fax this form to 617-848-0973 | | | Subtotal | |
| | | | Shipping | |
| | | | TOTAL: | |

Send the above recordings to:

Name: _____

Address: _____

Phone: _____ Email: _____

Payment Method (Payment must be included):

Enclosed is a check in the amount of \$ _____ (payable to UUMA)

Please charge my: MasterCard Visa Discover American Express the amount of \$ _____

Name on Card _____

Account Number _____ Exp. Date _____

Signature _____ Date: _____

Billing Address: _____ Zip/Postal: _____

2010 MINISTRY DAYS
JUNE 22-23, 2010





2010-2011 Membership Pre-pay Options

The UUMA is committed to making the Membership Renewal process as easy as possible. According to the UUMA Bylaws “dues are payable on September 15 and are delinquent on November 15 of each year. Those who have not renewed their membership by November 15th will be discontinued from UUMA Membership.

If you would like to make a payment towards your 2010-11 membership please complete the below form and return to the UUMA Booth or mail to Janette Lallier at 25 Beacon Street, Boston, MA 02108 or fax to 617-848-0973. If you are writing a check please write FY11 Dues in the memo line. You may also renew your membership online beginning July 1, 2010.

Below is the dues chart for 2010-2011
(see page 8 for further details):

One-Time Temporary Financial Hardship: \$144

Candidate Membership: \$50

Full Waiver with Supporting Documents: \$0

Life Members (yearly contributions appreciated): \$0

If you belong to a separate organization that is necessary to your ministry, you may use a discount code to deduct a portion of your dues. Associations are assigned codes based on their dues amount. One code is allowed per membership. A partial list (based on data received from your 2009 renewals) is included below. You may submit a request to add an organization by contacting the administrator.

| 2010-2011 Dues Chart | | |
|------------------------------|------------------|---------|
| Salary Range: | | |
| Your S&H (income) is between | FY11 Dues (.75%) | |
| - | \$ 20,000.00 | \$ 144 |
| \$ 20,001.00 | \$ 25,000.00 | \$ 169 |
| \$ 25,001.00 | \$ 30,000.00 | \$ 206 |
| \$ 30,001.00 | \$ 35,000.00 | \$ 244 |
| \$ 35,001.00 | \$ 40,000.00 | \$ 281 |
| \$ 40,001.00 | \$ 45,000.00 | \$ 319 |
| \$ 45,001.00 | \$ 50,000.00 | \$ 356 |
| \$ 50,001.00 | \$ 55,000.00 | \$ 394 |
| \$ 55,001.00 | \$ 60,000.00 | \$ 431 |
| \$ 60,001.00 | \$ 65,000.00 | \$ 469 |
| \$ 65,001.00 | \$ 70,000.00 | \$ 506 |
| \$ 70,001.00 | \$ 75,000.00 | \$ 544 |
| \$ 75,001.00 | \$ 80,000.00 | \$ 581 |
| \$ 80,001.00 | \$ 85,000.00 | \$ 619 |
| \$ 85,001.00 | \$ 90,000.00 | \$ 656 |
| \$ 90,001.00 | \$ 95,000.00 | \$ 694 |
| \$ 95,001.00 | \$ 100,000.00 | \$ 731 |
| \$ 100,001.00 | and up | \$ 750* |

* or .75% of income

I would like to make a payment of \$ _____ towards my 2010-2011 membership.

Name: _____

Preferred Mailing Address: _____

Phone: _____ Email: _____

Payment Method (Payment must be included):

Enclosed is a check in the amount of \$ _____ (payable to UUMA) Please write 'FY11 Prepay' in the Memo Line.

Please charge my: MasterCard Visa Discover American Express the amount of \$ _____

Name on Card: _____

Account Number _____ Exp. Date _____

Signature _____ Date: _____

Billing Address: _____ Zip/Postal: _____