



**Western States
Communication
Association**

77th Annual Convention

Riviera Resort & Racquet Club
Palm Springs, CA
February 18-21, 2006

WWW.WESTCOMM.ORG



President
Mary Jane Collier



President Elect
Leah Vande Berg*



First Vice President
Sara Hayden



Second Vice President
Lisa Flores



Executive Director
Mark Bergstrom



Local Hosts
Donna Gotch and Heather Hundley

TABLE OF CONTENTS

Welcome from WSCA President	4
General Information	6
Convention Synopsis	6
Hotel Floor Plan.....	9
WSCA 2005 Special Events	11
Executive Council	13
WSCA Committees	14
Life Members	16
WSCA Departmental Members	17
Past Presidents	18
Distinguished Service Award Recipients	20
Convention Planners	21
Local Arrangements Team	22
Preconferences and Workshops	23
Sponsored Sessions	31
Call for Papers 2006 Convention	104
Index of Program Participants	110
Program Announcements	129

WELCOME TO WSCA'S 77TH CONVENTION

AND TO PALM SPRINGS

On behalf of the Western States Communication Association, I extend the warmest of welcomes to you! We are glad you are here for this 77th annual gathering. Following a longstanding tradition of dynamic conventions, this WSCA convention is designed to provide opportunities for seasoned, experienced, and brand new scholars to present and perform their work, to discuss current issues and controversies in international, national, campus, and local communities, as well as in the field of communication, and to spark ideas for new projects. And, of course, WSCA conventions are spaces where we can connect with colleagues and old friends as well as make new friends at sessions, over coffee, on the putting greens, or on the dance floor. You'll see that the program outlines a wide range of stimulating panels, dynamic performances, engaging roundtables, workshops, and opportunities to socialize.

The 2006 convention theme, "Cherishing (Our) Time (Together)" was developed by Leah Vande Berg. This theme encourages us "to work from within multiple viewpoints and perspectives, to think about how we spend our time as teachers, scholars, and citizens, friends, partners, and family members, and to envision and take steps toward futures characterized by humane commitments and social and environmental justice." Connie Bullis, Program Coordinator, and Dennis Alexander, Program Planner, honor her memory by maintaining this theme for the 2006 convention. We are very grateful for their willingness to step in and plan the sessions and events at the Palm Springs convention! As usual, the Interest Group Program Planners have also been hard at work to ensure that our convention experience is filled with the best of the best.

Please note that the schedule for Saturday is filled with diverse events and workshops! If this is your first WSCA convention, plan to attend the **Newcomer's Reception** on Saturday, February 18th, from 4:15 to 5:00 pm. Everyone, be sure to join us for the **Convention Opening Program** at 5:15 pm. You'll hear lively presentations from undergraduate presenters in that the 3rd Annual **Undergraduate Scholar's Research Conference** is being held from 8:30 am until 2:00 pm. Don't miss the **Welcome Reception** at 6:45 pm where you can be sure to meet old and new friends. Current and prospective graduate students please mark your schedules to attend a **Graduate Student Workshop** and a **Graduate Programs Open House** on Saturday afternoon.

What promises to be a stimulating **Keynote Address** will be given by Palm Springs Mayor Ron Oden, on Sunday at 10:30 am. The **Convention Luncheon** is an event not only where you can savor tasty cuisine, but also acknowledge

colleagues who are being honored with annual awards. Finally, it is WSCA members who, through elected representatives, create convention policies, procedures, and the quality of the convention experience. Include your voice and share your views by attending and participating in Interest Group Business Meetings.

The Riviera Resort & Racquet Club is a beautiful site where we can theorize, reflect, perform, and engage the latest research and pedagogy in comfortable meeting rooms, as well as take advantage of the swimming pool, lighted putting course, and tennis courts. Thanks to Heather Hundley and the team of local hosts at California State University, San Bernardino, there is a range of events to help us take advantage of the local scene. They have also provided us with a well staffed registration desk.

Now that we are here, let us embrace the convention theme by “Cherishing (Our) Time (Together).” Thank you for being a part of WSCA and coming to Palm Springs. Enjoy the convention!

Warmly,

Mary Jane Collier
WSCA President

GENERAL INFORMATION

REGISTRATION: DESERT CONFERENCE CENTER LOBBY

Friday 5:00 pm-9:00 pm
Saturday 7:30 am-7:00 pm
Sunday 7:30 am-4:00 pm
Monday 7:30-11:45 am

EXHIBIT AREA: DESERT CONFERENCE CENTER LOBBY
AND OLEANDER 2

Saturday Noon-5:00 pm
Sunday 8:30 am-5:00 pm
Monday 8:30-Noon

CONVENTION SYNOPSIS 2006

Friday, February 17, 2006

Finance Committee	11:00 am- 2:00 pm	Palm Suite, Date (5109)
Publications Committee	11:00 am- 2:00 pm	Palm Suite, Fan (5113)
Executive Council	2:30-10:00 pm	Boardroom

Saturday, February 18, 2006

Workshops	9:00 am-4:00 pm	
Preconference Sessions	9:00 am-4:00 pm	
Undergraduate Scholars' Research Conference:		
Welcome	8:30-9:00 am	Mesquite A
Paper Presentations	9:00-10:15 am	
Paper Presentations	10:30-11:45 am	
Paper Presentations	12:00-1:15 pm	
Awards	1:30-2:00 pm	Mesquite A
Graduate Student Workshop	2:00-3:00 pm	Mesquite A
Graduate Programs Open House	3:00-4:30 pm	Mesquite A
Newcomers' Reception	4:15-5:00 pm	Grand Ballroom West
Interest Group Planners for 2007	4:15-5:00 pm	Palm Suite, Date (5109)

Saturday, February 18, 2006 (continued)

Convention Opening

(Kick-off Program)	5:15-6:45 pm	Grand Ballroom Center
Welcome Reception	6:45-8:15 pm	Grand Ballroom East
Executives Club Dinner	7:45-9:45 pm	VIP Room

Sunday, February 19, 2006

Business Meetings:

Western Forensics Association	7:45-8:45 am	Tournament Hotel
Community College I Communication Theory	7:45-8:45 am	
Organizational Communication	7:45-8:45 am	
Panels #1	9:00-10:15 am	
Keynote Event: Mayor Ron Oden	10:30-11:45 am	Mediterranean

Business Meetings:

Intercultural Communication	12:00-1:00 pm	Celebrity Room
Media Studies	12:00-1:00 pm	Mesquite A
Rhetoric & Public Address	12:00-1:00 pm	Oleander I
Language & Social Interaction	12:00-1:00 pm	VIP Room
Panels #2	1:10-2:25 pm	
Panels #3	2:35-3:50 pm	
Panels #4	4:00-5:15 pm	

Business Meetings:

ORWAC	5:30-6:30 pm	Mesquite B
Interpersonal Communication	5:30-6:30 pm	Grand Ballroom Center
Elementary & Secondary Education	5:30-6:30 pm	Mesquite D
Community College II	5:30-6:30 pm	Grand Ballroom West
Time and Place Committee	5:30-6:30 pm	Mesquite C
Sock Hop	9:00 pm-1:00 am	Mediterranean

Monday, February 20, 2006

Business Meetings

Communication & Instruction	7:30-8:30 am	Oleander I
Health Communication	7:30-8:30 am	Grand Ballroom East
Free Expression/Legal Communication	7:30-8:30 am	Mesquite C
Performance Studies	7:30-8:30 am	Whitewater
Panels #5	8:40-9:55 am	
Panels #6	10:05-11:20 am	
Convention Luncheon	11:35am-2:00 pm	Mediterranean
Panels #7	2:10-3:25 pm	
Panels #8	3:35-4:50 pm	
Interest Group Planners for 2007	3:35-4:50 pm	Palm Suite Sago
Panels #9	5:00-6:15 pm	
Futures Committee	5:15-6:15 pm	Palm Suite Date
Exec Club Business Meeting	5:15-6:15 pm	Palm Suite Fan
Legislative Assembly	6:30-8:00 pm	Grand Ballroom West
President's Reception	9:00-11:00 pm	

Tuesday, February 21, 2006

Panels #10	8:00-9:15 am	
Executive Council	9:00-11:30 am	Boardroom
Panels #11	9:25-10:40 am	
Panels #12	10:50-12:05 am	

Hotel Maps

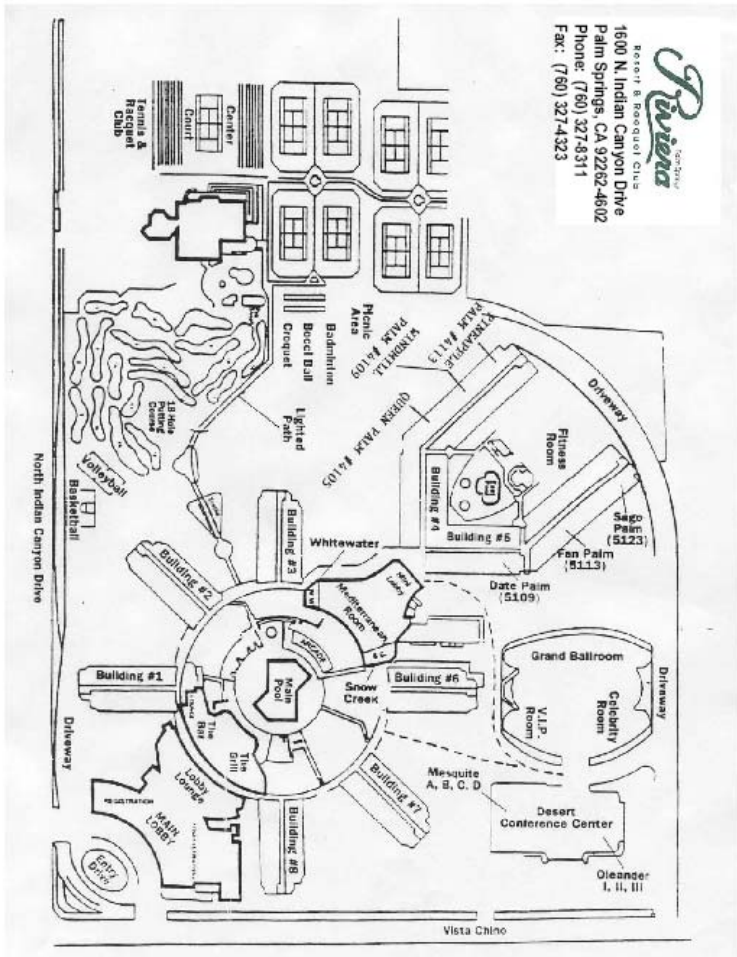

Grand Ballroom

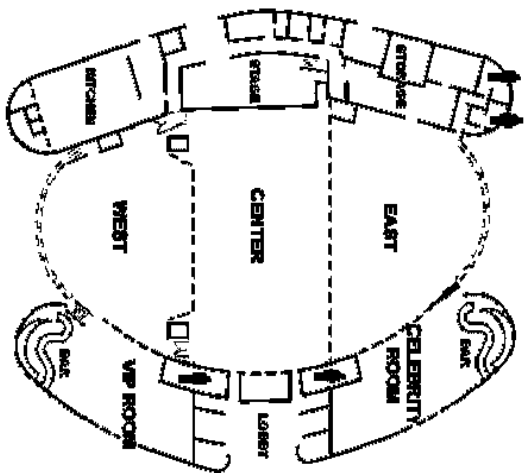

Desert Conference Center

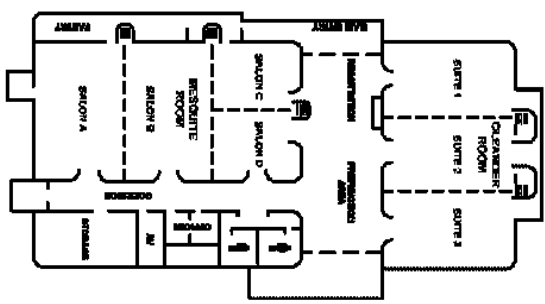

WSCA PALM SPRINGS CONVENTION 2006

THE LIVING DESERT ZOO & GARDENS TOUR

Awarded the Rand McNally Best of the Road 2003.

Revel in the desert experience. On Saturday, February 18th, discover the wildlife and habitat of 12 different desert ecosystems from the southwest and Mexico to East Africa and Madagascar. We'll take a guided tour of the park to see 450 native and exotic animals including several endangered species. Find yourself neck-in-neck with giraffes and ostriches, leopards, cheetahs, camels, zebras, and more! Admire the LGB model trains exhibit and the longest elevated model train trestle in the world! We'll end our stay by getting up close & personal with the animals in the Wildlife Wonders show, featuring Sabi, the cheetah, as well as other desert mammals, reptiles, and birds of prey. This is not just a zoo! The proceeds from group tours like ours enable The Living Desert to rehabilitate and release over 1000 desert animals each year. So come, enjoy a fun, educational and relaxing morning, and feel good about giving something back to the environment. \$50 includes transportation to and from the hotel, guided walking tour, and animal show.

PALM SPRINGS AERIAL TRAM

Experience the adventure of riding the world's largest rotating tramcars. Rising over 2 ½ miles from 2,643 feet at Valley Station to 8,516 feet at Mountain Station, the tramcars rotate slowly from within providing a spectacular 360 degree view of the valley floor and surrounding area. The Tram passes through five unique life zones—from hot Mexican Sonoran Desert to Alpine wilderness in Mt. San Jacinto State Park. Up top, the Adventure Center provides snowshoe and cross-country ski rentals to let you explore the 54 miles of wilderness trails (snow conditions permitting). In the winter, expect the weather on top to be cold, with sudden snowstorms. This is a popular holiday destination, so either go before 10:00 in the morning, or expect long lines. First car up is at 8:00am; the last car down is 9:45pm. No reservations needed. Admission for Adults \$17.65, for Children ages 5-12 \$11.65. Go to www.pstramway.com for more information. It's just a short cab ride away; this is the closest major attraction to our hotel.

DESERT ADVENTURES JEEP TOURS

Looking for a rugged adventure? Experience the real desert on one of Desert Adventures' award-winning Jeep Eco-Tours of the San Andreas Fault or Joshua Tree National Park. Knowledgeable guides will bring the geology and history to life as you travel through spectacular landscapes in jeeps with no door or windows to block your view. Tours vary from 2-5 hours depending on what you

select. Hiking tours are also available. Go to www.red-jeep.com for details on different packages or call toll free (888) 440-5337 to make your reservations. Remember we are descending on Palm Springs during their busiest time of the year, so make your reservations early.

SPA RESORT CASINO

The excitement of a casino combined with the relaxation of a spa. The brand new Spa Resort Casino (www.sparesortcasino.com) is a 24-hour-a-day playground. Filled with over 900 of the latest slot machines and 30 table games, including blackjack, mini-baccarat, 3 Card Poker™, 4 Card Poker™ and Pai Gow Poker™, the Casino offers hours of fun and great dining options. At the Spa, treat yourself to a wide variety of spa services and treatments including Swedish Massage, Aromatherapy, Shiatsu, Sports Massage, European Facials, Stone Therapy - each expertly handled by a professional massage therapist, an esthetician or a spa technician. Or enjoy the Spa's signature service "Taking of the Waters" to leave your body thoroughly refreshed, relaxed and rejuvenated. Call (888)-999-1995 for spa reservations and appointments. Discount packages are available for groups as small as six, so plan a day of luxury with your friends. Check with the hotel for information on a free shuttle service to downtown attractions.

WSCA GOLF OUTING

Join us for a relaxing day of golf in the golfing capital of the world. The Mesquite Golf and Country Club (www.mesquitegolfandcountryclub.com) features moderately rolling greens with mature trees and spectacular views of the mountains. It is well bunkered, with eight small lakes and many palm trees. We have an 8:00am tee time Saturday, February 18th. The \$65 entry fee includes green fees, cart, closest-to-the-pin and longest putt contests. If you are interested or have questions, please contact Heather Hundley hhundley@csusb.edu

WSCA EXECUTIVE COUNCIL 2005/2006

President

Mary Jane Collier, University of New Mexico

President Elect

Leah Vande Berg, California State University, Sacramento (deceased)

First Vice President

Sara Hayden, University of Montana

Second Vice President

Lisa Flores, University of Utah

Immediate Past President

Myron (Ron) W. Lustig, San Diego State University

Executive Director

Mark Bergstrom, University of Utah

Members-at-large

Brenda Allen, University of Colorado, Denver

Diane Martin, University of Portland

Brian Ott, Colorado State University

Nancy Oft Rose, South Eugene High School (retired)

Editor, *Western Journal of Communication*

Daniel J. Canary, Arizona State University

Editor Elect, *Western Journal of Communication*

Cheree Carlson, Arizona State University

Editor, *Communication Reports*

Walter Zakahi, New Mexico State University

Editor, *WSCA News*

Blaine Goss, New Mexico State University

Speech Activities Coordinator

Matt Taylor, Fullerton Community College

President, Executives Club

Patricia Ganer, Cypress College

Publications Committee Chair

Charles Braithwaite, University of Nebraska, Lincoln

Finance Committee Chair

Douglas Fraleigh, California State University, Fresno

WSCA Committees 2005-2006

Nominating Committee:

Immediate Past President Myron (Ron) Lustig, Chair; Steve Yoshimura and Anneliese Harper (elected by the Legislative Assembly) and Peter Ehrenhaus and Jan Andersen (elected by the Executive Council).

Finance Committee:

Doug Fraleigh, Chair; Larry Frey and Paul Mongeau (appointed by the President).

Publications Committee:

Chuck Braithwaite, Chair; Angela Trethewey and William Cupach (appointed by the President); Dan Canary/Cheree Carlson, Walter Zakahi, Tadasu Imahori and Blaine Goss.

Time and Place Committee:

Heather Hundley, Chair; Kathleen Haspel and Karen Lovaas (elected by the Executive Council); Robert Trapp, Speech Activities Coordinator and Myron (Ron) Lustig, Immediate Past President. Jody Kellas, Geri Merrigan.

Member Services Committee:

Julie Yingling, Chair; Michael Brydges, Matt Barton (appointed by the President), and Lisa Flores, Second Vice President.

Distinguished Service Award:

Brenda Allen, Chair; Pat Ganer, President of the Executives Club; Myron (Ron) Lustig, Immediate Past President, and Brian Ott, Chair Designate (appointed by the President).

Model Teaching Program Award:

Diane Martin, Chair; Robert Stockton, Chair of Elementary-Secondary Interest Group; Kristin Gatto-Correia, Chair of Community Colleges Interest Group; Keith Nainby, Chair of Communication & Instruction Interest Group, and Nancy Oft Rose, Chair Designate (appointed by the President).

B. Aubrey Fisher Award:

Dan Canary, Chair; William Cupach, Randall Lake, Timothy Plax, Sally Planalp, Helene Shugart, and Bryant Alexander (elected by the Executive Council).

Futures Committee:

Myron (Ron) Lustig, Chair; Ken Frandsen, Dave Natharius, Lynn Wells, William Wilmot, and Sandra Petronio (appointed by the President).

Memorial Fund Committee:

Patrick Dodge (Student Member); Dave Natharius, Bryant Alexander (Executive Club Members).

NCA Legislative Council (elected by the WSCA Legislative Assembly):

Robert Stockton, representing K-12, 2003 through 2005

Deanna L. Fassett, representing 4+ year institutions, 2004 through 2006

Tasha Van Horn, representing Community Colleges, 2005 through 2007

NCA Nominating Committee: Myron (Ron) Lustig, Immediate Past President.

Elected representatives to the Legislative Assembly 2005 & 2006

Karen Ashcraft, University of Utah; Howard Giles, UC-Santa Barbara; Karen Lovaas, San Francisco State University; Helene Shugart, University of Utah; Steve Yoshimura, University of Montana.

Elected representatives to the Legislative Assembly 2006 & 2007

Bradford 'J' Hall, University of New Mexico; Patricia O' Keefe, College of Marin; Dreama Moon, California State University, San Marcos; Peter O. Nwosu, California State University, Northridge; Susan Poulsen, Portland State University.

LIFE MEMBERS*

Katherine Adams, California State University, Fresno
Dennis Alexander, University of Utah
James A. Anderson, University of Utah
Mark Bergstrom, University of Utah
Dawn O. Braithwaite, University of Nebraska, Lincoln
William Bray, San Francisco State University
Nancy Burroughs, California State University, Stanislaus
Robert Clark, University of Oregon
Douglas Fraleigh, California State University, Fresno
Patricia M. Ganer, Cypress College
James M. Gelwicks, Western State College of Colorado
Kimberly Barnett Gibson, St. Mary's University
Susan A. Hellweg, San Diego State University
Major John M. Hinck
Suzanne McCorkle, Boise State University
Paul A. Mongeau, Arizona State University
Chevelle Newsome, Sacramento State University
Patricia O'Keefe, College of Marin
Douglas Parry, University of Alaska, Anchorage
Sue D. Pendell, Colorado State University
Sandra Petronio, Indiana University-Purdue University Indianapolis
David R. Seibold, University of California, Santa Barbara
William Sharkey, University of Hawai'i, Manoa
Malcolm O. Sillars, University of Utah
Stacey Sowards, University of Texas, El Paso
Robert Stockton, Katella High School
Robert W. Vogelsang, Portland State University
Marlene M. von Friederichs-Fitzwater, California State University, Sacramento
John L. Williams, California State University, Sacramento

*Life Members as of 01/12/06

WSCA DEPARTMENTAL MEMBERS

(as of 01/05/2006)

Arizona State University
Arizona State University West
Bakersfield College
Boise State University
Brigham Young University
California State University, Fresno
California State University, Long Beach
California State University, Northridge
California State University, Sacramento
California State University, San Bernardino
California State University, Stanislaus
Chulalongkorn University
College of Wooster
Colorado State University
Embry-Riddle Aeronautical University
Humboldt State University
Lewis-Clark State College
Los Angeles Pierce College
Merced College
Oregon State University
Portland State University
San Diego State University
San Francisco State University
San Jose State University
Santa Barbara City College
Santa Rosa Junior College
The New School University
University of California, Davis
University of Colorado, Boulder
University of Colorado, Denver
University of Denver
University of Hawaii
University of Nebraska
University of Nevada, Las Vegas
University of New Mexico
University of Northern Colorado
University of Southern California
University of St. Thomas
University of Texas, El Paso
University of Utah
University of Washington
Weber State University

PAST PRESIDENTS

WESTERN STATES COMMUNICATION ASSOCIATION

<i>President Name</i>	<i>Pres. Year</i>	<i>Affiliation</i>	<i>Conv. City</i>	<i>Conv. Date</i>
W. Arthur Cable*	1929	U Arizona	San Francisco	Nov. 1929
W. Arthur Cable*	1930	U Arizona	San Francisco	Nov. 1930
Lee Emerson Basset*	1931	Stanford	Pasadena	Nov. 1931
Ray K. Immel*	1932	USC	Los Angeles	Dec. 1932
Frederick W. Orr*	1933		Portland	Nov. 1933
E. Ray Nichols*	1934	U Redlands	Salt Lake City	Nov. 1934
Joseph F. Smith*	1935	U Utah	San Francisco	Nov. 1935
Edward Z. Rowell*	1936		Pasadena	Nov. 1936
Elwood Murray	1937	U Denver	Denver	Nov. 1937
John L. Casteel	1938	U Colorado	Seattle	Nov. 1938
Elvena Miller*	1939	Seattle P. S.	San Francisco	Nov. 1939
J. Richard Bietry	1940	U Colorado	Los Angeles	Nov. 1940
Charles F. Lindsley*	1941	Occidental	Salt Lake City	Nov. 1941
T. Earl Pardoe*	1942	Brigham Young	no convention	
Earl W. Wells*	1943	Oregon State U	Denver/Salem	Feb. 1944
Horace G. Rahskopf*	1944	U Washington	divisional	Nov. 1944
Alan Nichols*	1945	USC	Los Angeles	Apr. 1946
Mabel F. Gifford*	1946		San Francisco	Nov. 1946
Robert D. Clark	1947	U Oregon	Salt Lake City	Dec. 1947
Joseph H. Baccus*	1948	U Redlands	Seattle	Nov. 1948
Virgil A. Anderson*	1949	Stanford	San Jose	Nov. 1949
Norman Freestone*	1950	Occidental	Santa Barbara	Nov. 1950
Roy D. Mahaffey*	1951	Linfield College	San Jose	Nov. 1951
Susie S. Niles*	1952	SLC P. S.	Denver	Nov. 1952
William McCoard*	1953	USC	Fresno	Nov. 1953
Alonzo Morley*	1954	Brigham Young	Tucson	Nov. 1954
Wayne Eubank	1955	U New Mexico	Los Angeles	Dec. 1955
Milton Dickens*	1956	USC	Eugene	Aug. 1956
Kathleen Pendergast	1957	U Washington	Santa Barbara	Nov. 1957
Upton Palmer*	1958	UCSB	Salt Lake City	Nov. 1958
Johnnye Akin	1959	U Denver	Palo Alto	Nov. 1959
Lawrence Mouat*	1960	San Jose State	Corvallis	Nov. 1960
Theodore O. H. Karl*	1961	Pacific Lutheran	Fresno	Nov. 1961
John Wright*	1962	CSU Fresno	Long Beach	Nov. 1962
Joseph Wagner*	1963	CSU Long Beach	San Francisco	Mar. 1964
Ruth Jackson	1964	Palo Alto P. S.	Boulder	Apr. 1965
Halbert Greaves*	1965	U Utah	Los Angeles	Mar. 1966
Earl Cain*	1966	CSU Long Beach	Seattle	Nov. 1966
Milton Dobkin	1967	Humboldt State	Sacramento	Nov. 1967
Harold Livingston*	1968	Oregon State	Salt Lake City	Nov. 1968

PAST PRESIDENTS (Cont.)

James McBath*	1969	USC	San Diego	Nov. 1969
Marcella Oberle*	1970	CSU LA	Portland	Nov. 1970
Donald J. Cameron	1971	CSU Northridge	Fresno	Nov. 1971
John W. Keltner*	1972	Oregon State	Honolulu	Nov. 1972
Robert R. Boren	1973	Boise State	Albuquerque	Nov. 1973
Walter R. Fisher	1974	USC	Newport Beach	Nov. 1974
Eldon E. Baker	1975	U Montana	Seattle	Nov. 1975
Robert D. Kully	1976	CSU LA	San Francisco	Nov. 1976
Lucy M. Keele	1977	CSU Fullerton	Phoenix	Nov. 1977
R. Wayne Pace	1978	Brigham Young	Los Angeles	Feb. 1979
Carmendale Fernandes	1979	Fremont H. S.	Portland	Feb. 1980
Robert Vogelsang	1980	Portland State	San Jose	Feb. 1981
Nancy G. McDermid	1981	San Fran. State	Denver	Feb. 1982
William W. Wilmot	1982	U Montana	Albuquerque	Feb. 1983
John C. Hammerback	1983	CSU Hayward	Seattle	Feb. 1984
Jody Nyquist	1984	U Washington	Fresno	Feb. 1985
B. Aubrey Fisher*	1985	U Utah	Tucson	Feb. 1986
Jo Sprague	1986	San Jose State	Salt Lake City	Feb. 1987
Malcolm O. Sillars	1987	U Utah	San Diego	Feb. 1988
David Natharius	1988	CSU Fresno	Spokane	Feb. 1989
Lynn K. Wells	1989	Saddleback CC	Sacramento	Feb. 1990
Thomas M. Scheidel	1990	U Washington	Phoenix	Feb. 1991
Janis F. Andersen	1991	San Diego State	Boise	Feb. 1992
Stephen Littlejohn	1992	Humboldt State	Albuquerque	Feb. 1993
William F. Eadie	1993	CSU Northridge	San Jose	Feb. 1994
Robert K. Avery	1994	U Utah	Portland	Feb. 1995
Jolene Koester	1995	CSU Sacramento	Pasadena	Feb. 1996
Betsy W. Bach	1996	U Montana	Monterey Bay	Feb. 1997
Leslie A. Baxter	1997	U Iowa	Denver	Feb. 1998
Peter A. Andersen	1998	San Diego State	Vancouver, BC	Feb. 1999
Dennis C. Alexander	1999	U Utah	Sacramento	Feb. 2000
Dawn O. Braithwaite	2000	U Nebraska	Coeur d'Alene	Feb. 2001
Sandra Petronio	2001	Wayne State	Long Beach	Mar. 2002
Katherine Adams	2002	CSU Fresno	Salt Lake City	Feb. 2003
Connie Bullis	2003	U Utah	Albuquerque	Feb. 2004
Myron W. Lustig	2004	San Diego State	San Francisco	Feb. 2005
Mary Jane Collier	2005	U New Mexico	Palm Springs	Feb. 2006

**Indicates deceased*

DISTINGUISHED SERVICE AWARD RECIPIENTS

1979	Thorrell Fest, University of Colorado
1980	No Award
1981	Anthony Hillbruner, California State University, Los Angeles
1982	Janet Bolton, University of Southern California
1983	No Award
1984	Fred McMahon, California State University, Northridge
1985	Marcella Oberere, California State University, Los Angeles Milton Dobkin, Humboldt State University
1986	Carmendale Fernandes, Humboldt State University Gertrude Baccus, Redlands High School
1987	B. Aubrey Fisher, University of Utah
1988	Robert Kully, California State University, Los Angeles
1989	Gale Richards, Arizona State University
1990	Walter Fisher, University of Southern California
1991	James McBath, University of Southern California
1992	Malcolm O. Sillars, University of Utah
1993	Jack O. Samosky, California State University, Hayward
1994	Thomas M. Scheidel, University of Washington
1995	Nancy G. McDermid, San Francisco State University
1996	John "Sam" Keltner (deceased), Oregon State University
1997	Lucy Keele, California State University, Fullerton
1998	Robert Boren, Boise State University
1999	David Natharius, California State University, Fresno
2000	Jody Nyquest, University of Washington
2001	William W. Wilmot, University of Montana
2002	Lynn K. Wells, Saddleback Community College
2003	Dennis Alexander, University of Utah
2004	Kenneth Frandsen, University of New Mexico
2005	Leah Vande Berg (deceased), California State University Sacramento

WSCA 2006 Palm Springs Program Planners

Primary Program Planners

Dennis Alexander & Connie Bullis, University of Utah

Executive Director

Mark Bergstrom, University of Utah

Assistant to the Executive Director

Robin Heaton, University of Utah

Preconference Planners

A. Susan Owen, University of Puget Sound

Peter Ehrenhaus, Pacific Lutheran University

Communication and Instruction Interest Group

Keith Nainby, San Jose State University

Communication Theory Interest Group

Vice Chair: Eve-Anne Doohan, University of San Francisco

Community Colleges Interest Group

Kristin Gatto Correia, American River College

Elementary and Secondary Education Interest Group

Chair: Bob Stockton, Katella High School

Freedom of Speech and Legal Communication Interest Group

Suzanne Larson, Southern Utah University

Health Communication Interest Group

Anne Hubbell, New Mexico State University

Intercultural Communication Interest Group

Deanna Fassett, San Jose State University

Interpersonal Communication Interest Group

Mark Bergstrom, University of Utah

Language and Social Interaction Interest Group

Christopher Koenig, University of California, Los Angeles

Media Studies Interest Group

Teresa Bergman, California State University, Chico

Organizational Communication Interest Group

Colleen Keough, University of Southern California

Performance Studies Interest Group

Amy K. Kilgard, San Francisco State University

Rhetoric and Public Address Interest Group

Tracey Quigley, University of San Diego

Western Forensic Association

Matt Taylor, Fullerton Community College

Executives Club

Patricia Ganer, Cypress College

ORWAC

Tracey Owens Patton, University of Wyoming

LOCAL HOST COMMITTEE

Local Hosts

Donna Gotch and Heather Hundley, California State University, San Bernardino

Local Host Events

Jo Anna Grant, California State University, San Bernardino
Heather Hundley, California State University, San Bernardino

Registration

Donna Gotch, California State University, San Bernardino

Audio Visual Equipment

Brian Heisterkamp, California State University, San Bernardino
C. Rod Metts, California State University, San Bernardino

Public Relations

Ahlam Muhtaseb, California State University, San Bernardino

Palm Springs Activities

Ed Svitak and David Sullivan, Riviera Resort and Racquet Club
Palm Springs Desert Resorts Convention and Visitors Bureau
Palm Springs Bureau of Tourism

Sock Hop

Generously sponsored by **McGraw-Hill**
Live Music Presented by “**Back Pages**”

The Local Host Committee recognizes financial support and encouragement from the Department of Communication Studies' Interim Chair, Juan Delgado, the College of Arts and Letters' Dean Eri Yasuhara and Associate Dean Risa Dickson. Hosting this convention would not be possible without the stellar support, organizational skills, and suggestions from the Department of Communication Studies' Administrative Assistant, Linda Sand. Thanks to Matt Richardson for addressing all our technical needs in a timely and responsive manner. Sincere recognition is given to the numerous undergraduate and graduate students, specifically COMM 243D, 399A and 399B and the student volunteers, for assisting with the convention hosting process.

Friday, February 17

1101 FINANCE COMMITTEE

11:00am-2:00pm	Palm Suite, Date (5109)
----------------	-------------------------

1102 PUBLICATIONS COMMITTEE

11:00am-2:00pm Palm Suite, Fan (5113)

1200 EXECUTIVE COUNCIL

2:30-10:00pm Boardroom

Saturday, February 18

2000 UNDERGRADUATE SCHOLARS' RESEARCH CONFERENCE

8:30-9:00 am	WELCOME AND ORIENTATION	Mesquite A
9:00-10:15 am	Paper Presentations	
Session 1		Mesquite A
Session 2		Palm Suite, Date (5109)
Session 3		Palm Suite, Fan (5113)
Session 4		Palm Suite, Sago (5123)
10:15-11:45 am	Paper Presentations	
Session 5		Mesquite A
Session 6		Palm Suite, Date (5109)
Session 7		Palm Suite, Fan (5113)
Session 8		Palm Suite, Sago (5123)
12:00-1:15 pm	Paper Presentations	
Session 9		Mesquite A
Session 10		Palm Suite, Date (5109)
Session 11		Palm Suite, Fan (5113)
Session 12		Palm Suite, Sago (5123)
1:30-2:00pm	AWARDS PRESENTATIONS	Mesquite A

2001 GRADUATE WORKSHOP AND OPEN HOUSE

2:00-3:00 pm	Graduate Workshop Panel	Mesquite A
3:00-4:30 pm	Graduate Open House	Mesquite A

PRECONFERENCE SESSIONS

The 2006 WSCA Convention honors the memory of Leah Vande Berg. The three Preconference Sessions all resonate with Professor Vande Berg's convention theme of "Cherishing Our Time Together" and her commitment to opening spaces for marginalized voices and expanding social justice and humane relations.

2101 (2201) TAKING A COMMUNICATION PERSPECTIVE ON IMPORTANT SOCIAL ISSUES

9:00am-12pm and 1:00pm-4pm Saturday, February 8

VIP Room

One way of meeting the challenge of this convention theme, "Cherishing Our Time Together," is to explore the ways that our discipline can contribute to important social issues of our time. As used in this session, the "communication perspective" focuses on what is being made in processes of communication, and uses a vocabulary for answering that question that includes relationships, selves, episodes, organizations, conflicts, political processes, economic realities, etc. The seven presenters in this session are all experienced in applying the communication perspective to their contexts of work. All work in university contexts as well as non-academic areas. The design of the session includes opportunities for participants to learn from the experience of these presenters as well as through coached experiential activities. This session will include applications to teaching, research, consulting, coaching, citizen participation, and political processes.

Facilitator: Barnett Pearce, Fielding Graduate University

Presenters: Hilda Carpenter, Carpenter Consulting Associates

Linda Blong, California Institute on Human Services, Sonoma State U.

Sara Orem, Capella University

Shawn Spano, San Jose State University

Stephen Littlejohn, Domenici Littlejohn, Inc.

Kimberly Pearce, De Anza College

Fee: \$5

2102 CREATING TEXTS THAT INVITE US TO CHERISH (TOGETHER): POSSIBILITIES FOR AUDIO-VISUAL AUTOETHNOGRAPHY

9:00am-12:00pm, Saturday February 18

Celebrity Room

The autoethnographic turn has led to an increased appreciation of narrative, evocative, performative and experimental texts. This session invites a collaborative and experiential dialogue around the possibilities of online, digital and audio/visually recorded ethnographic texts. These modes allow for wider

dissemination and invitation to broad audiences to experience, appreciate, and cherish the cultural understanding and insights they offer. Participants will experience five brief exemplars of autoethnographic texts that invite the 'reader/recipient' to cherish the complexities of cultural experience. Participants will discuss with the creators how these autoethnographic texts open up the possibilities of their own research, inviting broader audiences and questioning the nature of traditional publication and presentation/distribution for our research, as well as the suitability of traditional codes for representation. Participants will be invited to brainstorm and share autoethnographic themes from their own actual or potential research.

Facilitator: Sarah "Amira" De la Garza, Arizona State University

Presenters: Rachel McGarry, Arizona State University
Sarah "Amira" De la Garza, Arizona State University
Eric J. Robertson, San Diego State University
Emma Kershaw, San Diego State University
Tara J. Schuwerk, Arizona State University

Fee: \$5

2202 ENHANCING DIVERSITY THROUGH INNOVATIVE PEDAGOGY

1:00pm-4:00pm, Saturday, February 18

Celebrity Room

"Enhancing Diversity through Innovative Pedagogy" will explore how faculty can be positive agents of change in the classroom by incorporating innovative pedagogies that help students feel more comfortable communicating about race and social justice. The panel will examine how to promote introspection on issues of race, ethnicity, gender, class and sexuality using experiential, collaborative and active learning elements. The goal of the roundtable discussion will be to explore how faculty can use innovative pedagogies to enhance students' communication skills, critical thinking skills, and engagement in course content and intellectual dialogue particularly in classes where students may have difficulty in discussing matters of race, and social justice.

Presenters: R. Dianne Bartlow, California State University, Northridge
Florence Kyomugisha, California State University, Northridge
Kathryn Sorrells, California State University, Northridge

Fee: \$5

WORKSHOPS

2103 (2203) PLAYBACK THEATRE AND COMMUNITY ACTION RESEARCH WORKSHOP

9:00am-12:00pm & 1:00pm-4:00pm, Saturday, February 18 Oleander Suite 1

Playback Theatre, an interactive performance form where audience members tell stories from their lives, and see them enacted on the spot, empowers audience members, offers validation of experience, and builds community. Developed in the 1970s in the Hudson River Valley in New York, Playback Theatre is now studied and practiced throughout the world in a wide variety of settings. This workshop will provide a hands-on introduction to Playback Theatre, and then an application of the form to issues of bullying, peer-pressure, diversity, and change in community schools. It demonstrates PT as a unique action-research method that allows researchers to gather data and allows audience members to put forth and “try out” community-driven solutions to problems.

The workshop will: 1) address increasing university emphases on community interaction through the contexts of ASU’s Social Embeddedness design imperative, The Hugh Downs School of Human Communication’s strategic initiative on conflict transformation, and the Performance Studies programmatic focus on social activism and advocacy; 2) consider strategies for external funding of community-related projects; 3) explore the development of both traditional and action-research methods of research; and 4) provide hands-on training in Playback Theatre as an unique tool for action research, for community education and for social intervention.

Presenters: Janet Alberts, Arizona State University
Jennifer Linde, Arizona State University
Kurt Lindemann, Arizona State University
Linda M. Park-Fuller, Arizona State University

Fee: \$10

2104 (2204) THE ORALISTIC MOVEMENT IN PUBLIC SPEAKING PEDAGOGY: HISTORY, THEORY, AND IMPLEMENTATION

Sponsored by: Chapman University and WSCA

9:00am-12:00pm & 1:00am-4:00pm, Saturday, February 18 Oleander Suite 3

The purpose of the workshop is to introduce participants to the oralistic movement in public speaking pedagogy, now five years old. “Oralistic” is a blanket term that covers “conversational quality” (Winans), “Vid-Oral” (Haynes), “Communication Orientation” (Motley) and “Oralistic Approach” (Doetkott). The oralistic movement stresses that oral communication is as different from written communication as “lightning is to a lighting bug”, to paraphrase Mark Twain. Oralists eschew the literary performance approach of all of the major academic speech texts in favor of a natural conversational pedagogy, first proposed by Winans (one of the founders of the NCA) early in

the 20th Century, as a reaction to the elocutionary practices of his day. The goals of the workshop include having the participants understand the underlying theory and history of the movement, how it differs completely from current academic practice, and how they (and their students) may benefit from the use of oralistic concepts in their own classrooms.

The three-hour morning session will cover the history, philosophy, research and practice germane to the pedagogy, featuring seven leading scholars and teachers in the movement. In the three hour afternoon session the radical oralist program established at Chapman University, now celebrating its 15th year, will be explained by the founding instructor and his adjunct. The lessons of the ongoing Chapman experiment will be used to guide participants as they work to find ways to introduce orality into their own institution's speech programs.

Presenters: Richard Doetkott, Chapman University
W. Lance Haynes, University of Missouri at Rolla
Micheal Motley, University of California, Davis
Liz O'Brien, Phoenix College
Lance Lockwood, Santa Ana College
Melinda Womack, Santiago Canyon College
Matt McGarrity, University of Washington

Fee: \$20

2105 TEACHING STUDENTS TO THINK CRITICALLY AND COMMUNICATE REFLECTIVELY

9:00am-12:00pm, Saturday, February 18

Mesquite Salon C

Student learning is not what it could be. Among the tools to improve student learning, critical thinking remains an untapped resource. Critical thinking is a tool that infuses the design and implementation of assignments, courses and curriculum to ultimately enhance true student learning. Our goals are: 1) participants will learn a critical thinking model, 2) participants will learn the common language of critical thinking and 3) participants will learn to craft effective classroom assignments. In this workshop, participants will learn a comprehensive, cross-disciplinary model of critical thinking. The model provides a simple vocabulary that faculty and students can use in the classroom and in their everyday interactions. The quality of instruction, interaction and learning can improve dramatically. The presenters will delineate and demonstrate how this works in the classroom, and then provide the participants the opportunity to demonstrate the application of the model to an assignment or activity in one of their courses. At the conclusion, we will discuss how to overcome the inevitable obstacles, both personal and institutional, that impede our progress.

Presenters: George Nagel, Ferris State University
Donna A. Smith, Ferris State University
Marcy Parry, Ferris State University
Paul Kammerdiner, Ferris State University

Fee: \$10

2106 UNIQUE CHALLENGES FACING TEACHING ASSISTANTS OF COLOR: TRAINING AND NAMING THE ELEPHANT IN THE ROOM

9:00am-12:00pm, Saturday, February 18

Mesquite Salon D

Minority Teaching Assistants face unique challenges in the college classroom stemming from the dynamics of tokenism in predominantly white classrooms, the historical regional legacies of intergroup relations in which campus communities are situated, and the nature of the multicultural course content, and areas of academic expertise they bring to the classroom. Additionally, many teaching assistants of color may be first generation non-traditional graduate students and may come to institutions with multiple professional and personal commitments that may not have allowed them the opportunities nor resources to develop their teaching practices sufficiently. The goals of this workshop are to: 1) provide participants with an overview of the historical and current research on teaching evaluations for minority instructors; 2) provide training materials, self-assessment exercises, and recommendations for intervention and programming for teaching assistants of color; 3) provide materials for peer teaching assistants, white faculty, and administrators to develop collegial awareness, and responsive institutional support for teaching assistants of color and faculty of color.

Presenter: Kathleen Wong (Lau), Western Michigan University

Fee: \$15

2107 TEACHER TO TRAINER: CONVERT YOUR EXPERTISE INTO POTENT, HIGH ENERGY TRAINING PROGRAMS

9:00am-12:00pm, Saturday, February 18

Mesquite Salon B

As communication experts, we have countless opportunities to speak with audiences outside the walls of our universities. While some of us go reluctantly, many of us seek out such opportunities as a way to boost our visibility, strengthen our service records and increase our income. Translating our knowledge to a business or civic audience, however, is not always an easy task. Even if we excel in the classroom, training outside the context of academia presents a different set of challenges.

The purpose of this workshop is to help participants successfully move from the “classroom to the boardroom” by transforming the lecture material into potent, high energy training programs.

Presenters: Heidi Reeder, Boise State University and Success Tracks, L.L.C.

Mary Dawson, Boise State University

Fee: \$20

2205 TEACHING SEXUAL IDENTITIES AND COMMUNICATION

1:00pm-4:00pm, Saturday, February 18

Mesquite Salon C

Does your college or university offer a class in sexual identities and communication? Do you include sexual identity in your courses related to social and cultural identities? What about interpersonal and family communication? How does one go about addressing controversial issues related to sexualities in the classroom context? Communication textbooks in many areas of the discipline include little if any content related to sexualities. Two of us facilitating this workshop, Karen Lovaas and Mercilee Jenkins, teach courses in sexual identities and communication and gender and communication and work to integrate this subject into our other courses. Our book, Sexual Identities and Communication, with Sage, is due out next year. Marina Whitchurch and Patrick Moe are editorial assistants on the book who have assisted with course and whose graduate work relates to gender, sexuality, and communication.

In this half-day workshop we will address the challenges and opportunities of teaching the sexual identities and communication course. We will provide participants with materials for teaching a sexual identities and communication course on their own campuses as well as integrating sexuality into other communication courses. We will discuss ways of structuring the course and talk about how we've selected the content we currently cover in our classes. We will also share ideas about supplemental resources and teaching activities. Whether you've been doing similar work for some time or just starting to think about how to do this work, we hope that you will join us as we explore ways to teach the subject of sexual identities and communication.

Presenters: Karen E. Lovaas, San Francisco State University
Mercilee Jenkins, San Francisco State University
Patrick W. Moe, San Francisco State University
Marina Whitchurch, San Francisco State University

Fee: \$15

2206 TEACHING THE PERSUASION, COMPLIANCE GAINING, AND /OR SOCIAL INFLUENCE COURSE AT THE UNIVERSITY LEVEL

1:00pm-4:00pm, Saturday, February 18

Mesquite Salon D

This course is designed for instructors who are teaching or developing courses in persuasion, using a social scientific perspective. The course covers a wide range of theories, concepts, and process related to persuasion, with an emphasis on interpersonal influence or compliance gaining. Basic instructional units are covered, along with sample course materials, readings, exercises, video clips, and instructional strategies. Two textbooks and a packet of teaching materials are included.

Presenters: Robert H. Gass, CSU, Fullerton
John S. Seiter, Utah State University

Fee: \$20

2207 TEACHING MEDIATION: HELPING OTHERS CHERISH THEIR TIME TOGETHER

1:00pm-4:00pm, Saturday, February 18

Mesquite Salon B

Mediation, where an impartial facilitator assists parties in conflict to come to their own decisions, helps individuals to have their voices heard during conflicts. Mediators can be a positive force for peaceful resolution of conflict. Teaching the basic mediation course and/or adding information on mediation to courses such as Interpersonal Conflict, Interpersonal Communication, or Business Communication can be rewarding for communication professional who want to impact how conflicts are played out in the world.

The workshop will present a variety of levels through which mediation may be included in communication curricula: Demonstration of a one day lesson plan to overview various alternative dispute resolution methods (interpersonal self-help, facilitation, mediation, arbitration, and litigation), Lesson plans and demonstration exercise for a one week unit on mediation to be dropped into courses such as Interpersonal Conflict, Interpersonal Communication, or Business Communication, and Lesson plans and demonstration exercises for a semester mediation course.

Presenters: Suzanne McCorkle, Boise State University
Melanie Reese, Boise State University

Fee: \$5

2301 NEWCOMER'S RECEPTION

4:15-5:00 pm, Saturday, February 18

Grand Ballroom West

2302 INTEREST GROUP PROGRAM PLANNERS 2007

4:15-5:00, Saturday, February 18

Palm Suite, Date (5109)

2400 CONVENTION KICKOFF PROGRAM:

Radicals in Robes: Miss Scarlett and Her Imaginary Friends

5:15 – 6:45 pm, Saturday, February 18

Grand Ballroom East

Miss Scarlett, as literary and cinematic characterization, is an embarrassing relic of Jim Crow America. At the same time, she is persistently iconic in contemporary American culture, the romantic idealization of a troubled past. Performed as postmodern parody, Miss Scarlett acquires a self-mocking political consciousness that causes her to "take to the closet" to reflect on her ontological and epistemological status. Alone in her musings about the vagaries of the 21st century, she invents a troupe of imaginary friends. Together, they discuss the contemporary scene and its relation to the past. Invented through the lenses of the comic frame, feminism, queer theory, critical race theory and camp, Miss Scarlett and Her Imaginary Friends offer a wildly irreverent performative critique of contemporary American politics. The program ends with a mediated

tribute to Leah R. Vande Berg, prepared by Diego Bonilla, California State University, Sacramento.

Participants: A. Susan Owen, University of Puget Sound
Harry W. Haines, Trinity University
Peter C. Ehrenhaus, Pacific Lutheran University
Heather L. Hundley, California State University, San Bernardino
Robert K. Avery, University of Utah
Philip C. Wander, San Jose State University
Dexter B. Gordon, University of Puget Sound
Diego Bonilla, California State University, Sacramento

2500 WELCOME RECEPTION

6:45-8:15pm, Saturday, February 18

Grand Ballroom Center

2600 EXECUTIVES CLUB DINNER

7:45-9:45pm, Saturday, February 18

VIP Room

Sunday, February 19, 2006

3001 BUSINESS MEETING: COMMUNITY COLLEGE INTEREST GROUP

7:45-8:45am, Sunday, February 19

Grand Ballroom West

3002 BUSINESS MEETING: COMMUNICATION THEORY INTEREST GROUP

7:45-8:45am, Sunday, February 19

VIP Room

3003 BUSINESS MEETING: ORGANIZATIONAL COMMUNICATION INTEREST GROUP

7:45-8:45am, Sunday, February 19

Grand Ballroom East

3004 BUSINESS MEETING: WESTERN FORENSICIS ASSOCIATION

7:45-8:45am, Sunday, February 19

Tournament Site

3101 G.I.F.T.S. I (GREAT IDEAS FOR TEACHING SPEECH)

9:00-10:15am, Sunday, February 19

Grand Ballroom West

Presented by the Community College Interest Group

This panel will highlight valuable instructional tools for the basic speech course.

Chair: Amy London, Oxnard College

Performing for the Job: Interviewing skills and public speaking

Randi Picarelli, California State University, Northridge

Defeating the Fear of Public Speaking: Overcoming Anxiety through Collaboration

Lea Gilinets, College of the Canyons

Making or Breaking your Speech with Visual Aids

Michele Mega, California State University, Northridge

Listen Up! Using the S.O.L.E.R. Stance to Increase Listening Effectiveness

Robert G. Leonard, Sinclair Community College

I Am Stories: An Exercise in Intercultural Listening

Melissa L. Beall, University of Northern Iowa

3102 A DEWEYAN ETHICAL ANALYSIS OF THE PRACTICE OF STANDARDIZED TESTING IN PUBLIC SCHOOLS

9:00-10:15am, Sunday, February 19

Mesquite D

Presented by the Elementary-Secondary Interest Group

Chair: Stephen R. Robertson, University of Southern California, Annenberg School of Communication

Cherishing Our Time together as we Reexamine Learning, Testing, and Alternatives in the K-12 World

Stephen R. Robertson

3103 MEDIATED WOMEN

9:00-10:15am, Sunday, February 19

Mesquite A

Presented by the Media Studies Interest Group

Chair: Gary Collier, California State University, Chico

O, The Oprah Magazine: Empowerment Versus Consumerism

Denae Parker, Colorado State University

Cooking Top Ramon American Style: Asian American Women Representations in *Stir*

Jennifer Huynh Thi Anh Morrison, University of Denver

Not Exactly "Daddy's Girl": The Tough Chick on *Alias*

Collette Blumer, California State University, Fullerton

Buffy Never Goes It Alone: The Rhetorical Construction of Feminism in *Buffy the Vampire Slayer's* Final Season

Susan Payne-Mulliken, San Diego State University

Respondent: A. Susan Owen, University of Puget Sound

3104 TOP FOUR PAPERS IN COMMUNICATION THEORY

9:00-10:15am, Sunday, February 19

VIP Room

Presented by the Communication Theory Interest Group

Chair: Marianne LeGreco, Arizona State University
Spirits in the Material World: Hauntology, Historical Materialism, and
Phenomenological Medium Theory (Top Paper)
 Marc Leverette, Colorado State University
Representative Anecdote: A Comic Corrective for Studies of Whiteness
 Jason Zingsheim, Arizona State University (Top Student Paper)
Déjà vu, Critique, and Beyond: Debunking Hereditarian Fallacies of
Communiology and a Path-Dependent Model of Personality Development
 Masaki Matsunaga, The Pennsylvania State University
Perspectives by Incongruity: Kenneth Burke and Queer Theory
 Dustin Goltz, Arizona State University

Respondent: Eve-Anne M. Doohan, University of San Francisco

**3105 COMMUNICATING ABOUT HEALTH: STORIES, SUPPORT
GROUPS, INFORMATION TECHNOLOGY, AND E-HEALTH**

9:00-10:15am, Sunday, February 19

Mesquite C

Presented by the Health Communication Interest Group

Chair: Kris Kirschbaum, University of New Mexico

Balance and Tension: Consequences of Positioning in Support Group
Conversations on Spouses of Persons with Dementia

 Mindi Ann Golden, University of San Francisco

Later-Life Marriage, Storytelling, and Health: A Closer Look at Health Stories
of Later-Life, Long Term Married Couples

 Fran C. Dickson, University of Denver

 Kandi L. Walker, University of Louisville

Doctor-Patient Communication: The Influence of Information Technology

 John M. McGrath, Trinity University

 Nedal H. Arar, Trinity University

 Jacqueline A. Pugh, Trinity University

E-Health, A New Kind of Telemedicine

 Gerald-Mark Breen, University of Oklahoma

 Jonathan Matusitz, University of Oklahoma

Respondent: Scott Paynton, Humboldt State University

**3106 TOP FOUR PAPERS IN ORGANIZATIONAL
COMMUNICATION**

9:00-10:15am, Sunday, February 19

Grand Ballroom East

Presented by the Organizational Communication Interest Group

Chair: Colleen M. Keough, University of Southern California

"Just Like Any Type of Business Transaction?": Homeless Newspaper Vending as Organizational Identification and Boundary Spanning Activity (Top Student Paper)

Kurt Lindemann, Arizona State University

Sexual Harassment at the Point of Intersectionality in the Raced Organization: A Grounded Theory Model

Brian Richardson, University of North Texas

Juandalynn Taylor, San Antonio, Texas

The Forms of Capital and Systematically Distorted Communication in Organizations: A Rereading of Enron's Collapse

Alexander Lyon, University of Arkansas at Little Rock

Why Did This Happen to Me?: Making Sense of Being Bullied at Work

Pamela Lutgen-Sandvik, University of New Mexico

Respondent: Sarah Tracy, Arizona State University

3107 VOICES AND CHOICES: (RE)POSITIONING FEMINIST COMMUNICATION STRATEGIES

9:00-10:15am, Sunday, February 19

Whitewater

Presented by the Organization for Research on Women and Communication

Chair: Stephanie Durnford, University of Montana

Racial Marginalization within Feminist Communication *Debut Paper

Elizabeth Martin-Calder, University of Portland

Diminishing Voices: Recreating the 'Muted Group' through On-line Harassment Prevention Training

Julie Snyder-Yuly, Iowa State University

Emotions and Ambivalence: Feelings Associated with Breastfeeding and Working

Emily T. Cripe, Arizona State University

Inviting Awareness: Invitational Rhetoric's Offer to the Post-Roe Generation Pro-Choice Movement

Nicole E. Hurt, Colorado State University

Respondent/Facilitator: Stacey Sowards, University of Texas, El Paso

3108 TOWARD A COMMUNICATION-BASED RE-CONCEPTUALIZATION OF INSTRUCTIONAL COMMUNICATION

9:00-10:15am, Sunday, February 19

Mesquite B

Presented by the Communication and Instruction Interest Group

Chair: Deanna L. Fassett, San José State University

Panelists: Deanna Fassett, San Jose State University
Jo Sprague, San Jose State University
Aimee Miller, University of Nebraska – Lincoln
Randa Garden, Wayne State College

3109 COMPETITIVE PAPERS IN COMMUNICATION AND INSTRUCTION

9:00-10:15am, Sunday, February 19

Snow Creek

Presented by the Communication and Instruction Interest Group

Chair: John T. Warren, Bowling Green State University

“We Arrived at Fantastic Shapes”: An Exploratory Investigation into Students’ Use of Materials to Convey Meaning and Ideas

Robert James Dusbabek, University of Nevada, Las Vegas

Lawrence J. Mullen, University of Nevada, Las Vegas

Negotiating Identities, Building Alliances: Feminist Critical Pedagogy and the Strategic Appropriation of Socially Constructed Boundaries

Sachi Sekimoto, California State University, Northridge

English Proficiency Tests and International Teaching Assistants: A Mythical Combination

Richie Neil Hao, Southern Illinois University, Carbondale

Immediacy, Composure, Receptivity, Communication Quality, Communication Satisfaction, Involvement and Connectedness/Mutuality in Face-to-Face and IITV Instruction

Laura R. Umphrey, Northern Arizona University

Jeffrey A. Wickersham, University of Connecticut

John C. Sherblom, University of Maine

Respondent: Keith Nainby, California State University, Stanislaus

3110 TOP STUDENT PAPERS IN RHETORIC & PUBLIC ADDRESS

9:00-10:15am, Sunday, February 19

Oleander I

Presented by the Rhetoric & Public Address Interest Group

Chair: Thomas Burkholder, University of Nevada, Las Vegas

Reading Burke in Tehran: A Burkeian Analysis of Azar Nafisi

Christina Colp-Hansbury, Arizona State University

The Public as a Rhetorical Concept in Aristotle’s *Ethics*, *Politics*, and *Rhetoric*

David Dzikowski, The Pennsylvania State University

Negotiations of Past and Present: Ted Danson’s Blackface Performance

Heidi Mueller, California State University, Los Angeles

PLYG-opoly as Multimodal Rhetoric and Subversive Synecdoche

Amy Osmond, University of Utah

Respondent: Dana Cloud, University of Texas, Austin

3111 COMPARISON, MEDIA AND CHANGE IN INTERCULTURAL COMMUNICATION

9:00-10:15am, Sunday, February 19

Celebrity Room

Presented by the Intercultural Communication Interest Group

Chair: David Zuckerman, California State University, Sacramento

The Influence of Comparative Media Use on Acculturation, Acculturative Stress, and Family Relationships

of Chinese International Students

Susan L. Kline, Ohio State University

Fan Liu, Ohio State University

Communicating Race Through Lynching and the Media: A Comparative Analysis of the Lynching and Media Representations of Africans and Chinese in the U.S.

Patrick Shaou-Whea Dodge, University of Denver

[]: Silence as Communication in Dispute

Kris Acheson, Arizona State University

Communicating in a Changing China: A Dialectical Approach to Studying Chinese Culture and Communication

Ping Yang, Arizona State University

Individualism and Collectivism on Ethnicity and Gender

Misato Yoshikawa, University of New Mexico

Respondent: Amy N. Heuman, Texas Tech University

3112 RELATIONAL DYNAMICS: CONFLICT, DIALECTICS, AND SUPPORT

9:00-10:15am, Sunday, February 19

Grand Ballroom Center

Presented by the Interpersonal Communication Interest Group

Chair: Amanda Dawn Coho, Pennsylvania State University

Serial Argumentation Goals and Their Relationships with Perceived Resolvability and Choice of Conflict Tactics

Jennifer L. Bevan, University of Nevada, Las Vegas

Karin D. Tidgewell, University of Nevada, Las Vegas

Karissa C. Barkdull, University of Nevada, Las Vegas

Lauren Cusanelli, University of Nevada, Las Vegas

Meredith Hartstern, University of Nevada, Las Vegas

Domina Holbeck, University of Nevada, Las Vegas

Jerold L. Hale, University of Georgia

Keeping the Partner Down? An Examination Gender Differences in Control Strategies in Couples Including One Depressed Individual

Ashley Duggan, Boston College

Do Interpersonal Relationships Occur in a Bubble? Toward a Dual Public/Private Presence of Interpersonal Relationships

Craig Rich, University of Utah

How Support Happens: An Ethnographic Investigation of Supportive Interactions Among Preschool Children, Peers, and Teachers

Jennifer Cummings-Witker, University of Utah

Respondent: Dan Canary, Arizona State University

3113 ON BECOMING JAPERICAN

9:00-10:15am, Sunday, February 19

Mediterranean

Presented by the Performance Studies Interest Group

This solo performance is an autoethnographic exploration of how the intersections of race, nationality, gender, and non-native speaker status influence processes of acculturation.

Chair: Matthew Spangler, San José State University

Solo Performer: Sachiko Tankei, Southern Illinois University, Carbondale

Respondent: Matthew Spangler, San José State University

3114 ESTABLISHING A NEW UNIVERSITY CAMPUS: CREATING EDUCATION OPPORTUNITIES THROUGH A PUBLIC PRIVATE PARTNERSHIP

9:00-10:15am, Sunday, February 19

Oleander III

The presenters will describe how municipal leaders and supporters of higher education worked together to develop the Palm Desert Campus of California State University, San Bernardino--the buildings of which were constructed without the use of state funds. Participants will have an opportunity to visit the campus, should they wish. Transportation will be provided to do so.

Chair: Fred E. Jandt, Dean CSUSB Palm Desert Campus

Participants: Local city officials and Capital Campaign Participants

3201 KEYNOTE PRESENTATION

10:30-11:45am, Sunday, February 19

Mediterranean

RON ODEN, MAYOR, PALM SPRINGS

AMERICA: I THOUGHT YOU SAID!?

3301 BUSINESS MEETING: INTERCULTURAL COMMUNICATION INTEREST GROUP
12:00-1:00pm, Sunday February 19 Celebrity Room

3302 BUSINESS MEETING: MEDIA STUDIES
12:00-1:00pm, Sunday, February 19 Mesquite A

3303 BUSINESS MEETING: RHETORIC AND PUBLIC ADDRESS INTEREST GROUP
12:00-1:00pm, Sunday, February 19 Oleander I

3304 BUSINESS MEETING: LANGUAGE AND SOCIAL INTERACTION INTEREST GROUP
12:00-1:00pm, Sunday, February 19 VIP Room

3401 G.I.F.T.S II (GREAT IDEAS FOR TEACHING SPEECH)
1:10-2:25pm, Sunday, February 19 Grand Ballroom West
Presented by the Community College Interest Group

This panel will highlight valuable instructional tools for the basic speech course focusing on practical evaluation and language.

Chair: Amy London, Oxnard College

From Carlin to Costello: Comedic Lessons about Language
Matt Abrahams, De Anza College

Killing a lot of Birds with One Stone: The Respondent Assignment
Karyl Kicenski, College of the Canyons

Giving and Receiving Feedback in a Multicultural Classroom: How, When, and Where?

Patricia O'Keefe, College of Marin

Student Critics Stepping Up to the Podium for Helpful Criticism
Robert B. Alto, Mendocino College

Make 'em Laugh: Speeches to Entertain as a Capstone Assignment
Joanne Babin, Skyline College

3402 COMMUNITY COLLEGE STUDENT OUTREACH: BUILDING BRIDGES
1:10-2:25pm, Sunday, February 19 Mesquite D
Presented by the Community College Interest Group

A unique look at Community College Student Outreach programs from multiple perspectives. The panel, consisting of two community college outreach specialists, an USAF education and training manager, and one very enthusiastic

speech professor, will discuss Outreach target populations, methods, and tips for how we, as community college faculty and staff, can help with these efforts.

Chair: Kris Gatto Cullivan, American River College

Find Them Anywhere You Can: Tips for Reaching Out to Prospective
Community College Students in Your Own Backyard

Kris Gatto Cullivan, American River College

Community College of the Air Force: 'Aim High'

Joseph W. Cullivan, Travis AFB Education & Training Manager

Respondents: Joslyn Gaines, Outreach Specialist, American River College

Jeri Marshall, Outreach Specialist, American River College

3403 TOP FOUR PANEL IN MEDIA STUDIES

1:10-2:25pm, Sunday, February 19

Mesquite A

Presented by the Media Studies Interest Group

Chair: Teresa Bergman, California State University, Chico

Spending Time With TV News: Time (and Place) Biases, 1982 – 2004

Steve Jones, University of Illinois at Chicago

The Production of Media Violence and Aggression Research: A Cultural
Analysis

James Anderson, University of Utah

Carnavalesque Rhetoric: *The Big Lebowski* as Cultural Critique

Paul "Pablo" Martin, San Diego State University

Valerie Renegar, San Diego State University

The Work of Art in the Age of Suicidal Destruction

Bernardo Alexander Attias, California State University, Northridge

Respondent: Greg Dickinson, Colorado State University

3404 TOP FOUR PAPERS IN LANGUAGE AND SOCIAL INTERACTION

1:10-2:25pm, Sunday, February 19

VIP Room

Presented by Language and Social Interaction

Chair: Lars Linton, University of California, Santa Barbara

Communicating *through* Children: Collaboration and Participation in the
Daycare Environment

Siri Mehus, University of Texas, Austin

Non-recognitional Reference: The Context-specific Operation of a Context-free
Organization"

Kevin Whitehead, University of California, Santa Barbara

Gene Lerner, University of California, Santa Barbara

Caregiver facilitation and child competence in parent-child daycare separations

L. D. Linton, University of California, Santa Barbara

Impression management: Server strategies with new versus repeat customers

Andrea Ann Richards, University of Montana

**3405 HEALTH COMMUNICATION IN THE MEDIA: MEDIA
COVERAGE OF HEALTH ISSUES THROUGH CONTENT ANALYSIS**

1:10-2:25pm, Sunday, February 19

Mesquite C

Presented by the Health Communication Interest Group

Chair: Cheryl Harkness, New Mexico State University

Riding the “Hormonal Roller Coaster”: A Thematic Analysis of Perimenopause
Coverage in the Media

Jessica Elton, Purdue University

The Effective Use of Popular Medical Dramas to Analyze Communication
Ethics in the Doctor-Patient Relationship

Randa Sue Garden, University of Nebraska, Lincoln

Centering Survivors and Marginalizing Victims: Faces of Cancer in the
Associated Press

Jo Anna Grant, California State University, San Bernardino

Heather Hundley, California State University, San Bernardino

Respondent: Laura Ellingson, Santa Clara University

**3406 A CONVERSATION WITH CHANCELLOR PAMELA
SHOCKLEY-ZALABAK**

1:10-2:25pm, Sunday, February 19

Grand Ballroom East

Presented by the Organizational Communication Interest Group and
Organization for Research for Women and Communication

Dr. Pamela Shockley-Zalabak is Chancellor and Professor of Communication at the University of Colorado at Colorado Springs. In this interactive session, Dr. Shockley-Zalabak will reflect on the contributions, applications and limitations of communication theory and research to her role as Chancellor.

Facilitator: Colleen M. Keough, University of Southern California

Discussant: Chancellor Pamela Shockley-Zalaback, University of Colorado,
Colorado Springs

3407 PERFORMING FEMINISMS: FEMINISM, RESISTANCE, AND POWER

1:10-2:25pm, Sunday, February 19

Whitewater

Presented by the Organization for Research on Women and Communication

Chair: Julie Snyder-Yuly, Iowa State University

Working the Pole(mics): Exotic Dancing as Resistance and Empowerment

Elizabeth Nelson, University of North Carolina at Chapel Hill

Queering Culture: Polyvocality and Affiliation in *Queer as Folk*

Julie Kalil Schutten, University of Utah

The Voices in our Heads: The Rhetorical Obsession of Preparing our Homes for Guests

Elizabeth Sink, Colorado State University *Debut Paper

Winning the Right to Vote in 2004: *Iron Jawed Angels*, Retrospective Framing, and the Woman Suffrage Movement?

Kristy Maddux, University of Georgia

Respondent: Suzanne McCorkle, Boise State University

3408 CHERISHING DESPERATION: WITNESSING THE INTERSECTION OF (H)OUR TIME AND (M)OTHERHOOD ON TV'S *DESPERATE HOUSEWIVES*

1:10-2:25pm, Sunday, February 19

Mesquite B

Presented by the Organization for Research on Women and Communication

Desperate Housewives invites multiple critical readings, offering postmodern viewers voyeuristic variety. However, since Feury and Fuery (2003) have suggested that visual communication makes "metaphors of expression" possible in sites of previous silence, (h)our reading recognizes a feminist contribution to breaking silences associated with televised (m)otherhood (p. 45-46).

Chair: Nick Burnett, California State University, Sacramento

Participants: Timi Ross Poeppelman, California State University, Sacramento

Sandra P. Wheeler, Cosumnes River College

Juliane Mora, University of Utah

Jillian A. Tullis Owen, University of South Florida

Respondent: Nick Burnett, California State University, Sacramento

3409 PRESIDENTIAL RHETORIC OF OUR TIME: GEORGE W. BUSH, PAST AND PRESENT

1:10-2:25pm, Sunday, February 19

Snow Creek

Presented by the Rhetoric & Public Address Interest Group

Chair: David Dzikowski, The Pennsylvania State University

Zooming Within George W. Bush's Environmental Frames

Samantha Senda-Cook, Colorado State University

Compassionate Rancher or Crafty Politician: Evaluation of the Ethics of President George W. Bush's "Great" Second Inaugural Address

Jennifer Soto, California State University, Los Angeles

A Statement of Crisis: Presidential Responses to Terrorist Attacks

Julie Bloomfield, Pepperdine University

Respondent: Diane Blair, California State University, Fresno

3410 TOP THREE COMPETITIVE PAPERS IN RHETORIC & PUBLIC ADDRESS

1:10-2:25pm, Sunday, February 19

Oleander I

Presented by the Rhetoric & Public Address Interest Group

Chair: Tracey Quigley, University of San Diego

The Abu Ghraib Images: 'Breaks' in a Dichotomous Frame

Christina Smith, Arizona State University

George Dionisopoulos, San Diego State University

Downwind: A Case Study of Contamination and Powerlessness in Community Environmental Action

Jennifer A. Peebles, Utah State University

German and American Holocaust Commemoration: Tragedy Transfigured in Time as Catharsis Through Praise and Blame

Paula Youra, Lynchburg College

Heidi Koring, Lynchburg College

Sarah Taylor, Lynchburg College

Respondent: Philip C. Wander, San Jose State University

3411 TOP FOUR COMPETITIVE PAPERS IN INTERCULTURAL COMMUNICATION

1:10-2:25pm, Sunday, February 19

Celebrity Room

Presented by the Intercultural Communication Interest Group

Chair: Deanna L. Fassett, San Jose State University

Remembering, Recovering and Making Sense of Race

Rona Tamiko Halualani, San Jose State University

Deanna L. Fassett, San Jose State University

Jennifer Huynh Thi Anh Morrison, University of Denver

Patrick Shaou-Whea Dodge, University of Denver

Shades of “Brown” in the Ivory Tower: A Review of Literature on Queer Mexican Migrant Men

Lucas C. Messer, Arizona State University

* Top Student Paper

Virile Shamans and Castrated Kokopellis: Masculinities in Interpretations of Native American Rock Art

Richard A. Rogers, Northern Arizona University

The Politics of Passing: Disrupting White Appearance Through Narrative Lived Experiences

Amy N. Heuman, Texas Tech University

Respondent: John T. Warren, Bowling Green State University

3412 BRING THE RESUME BUILDER TO LIFE: THE REWARDS AND CHALLENGES OF NCA STUDENT ORGANIZATIONS FOR YOUR DEPARTMENT

1:10-2:25pm, Sunday, February 19

Grand Ballroom Center

Presented by the First Vice President of WSCA

Examine the appeal of NCA’s undergraduate student organizations during this interactive poster session and roundtable discussion. Posters displaying the creativity and enthusiasm of Lambda Pi Eta members launch the session. A roundtable discussion examining the impact of student communication organizations on collegiate campuses completes the program. Current chapter advisors and student members as well as those interested in starting an NCA student organization are encouraged to participate.

Co-Chairs: Eve-Anne M. Doohan, Lambda Pi Eta - Kappa Iota Chapter, University of San Francisco, and Neil Patten, NCA Student Clubs, Ferris State University

Mu Lambda Chapter: Successful Peer Study Sessions, Finding Your Public Voice and Mentoring International Students

Vickie Harvey, Faculty Advisor, California State University, Stanislaus

Diana Breshears, Past President, Colorado State University

Judy Nelson, President, California State University, Stanislaus

Geraldina Garcia, Vice President, California State University,

Stanislaus

Nu Tau Chapter: A Successful Panel Discussion on the Media Effects and Political Ramifications of Hurricane Katrina

Kristen Moran, Faculty Advisor, University of San Diego
Michael Elliott, President, University of San Diego
Elyse Rohrer, Vice President, University of San Diego
Jessica Petrass, Secretary, University of San Diego
Nicole Woyski, Treasurer, University of San Diego

Kappa Iota Chapter: A Graduation Celebration: Annual Career Night and Alumni Presentation

Eve-Anne M. Doohan, Faculty Advisor, University of San Francisco
Evelyn Y. Ho, Faculty Advisor, University of San Francisco
Anne M. Stone, Past President, University of San Francisco
Sally Lee, Past Vice President, University of San Francisco
Jessica Anderson, President, University of San Francisco
Mariella Brodersen, Vice President, University of San Francisco
Eric Flemming, Treasurer, University of San Francisco
Courtney Leeds, Secretary, University of San Francisco

3413 UNDRRESSING ACADEMIA

1:10-2:25pm, Sunday, February 19

Mediterranean

Presented by the Performance Studies Interest Group

This two-person, multi-media performance interrogates the hidden privilege of academia and academic language.

Performers: Dustin Goltz, Arizona State University
 Karma R. Chávez, Arizona State University

Respondent: Jay Baglia, San José State University

3501 G.I.F.T.S III (GREAT IDEAS FOR TEACHING SPEECH)

2:35-3:50pm, Sunday, February 19

Grand Ballroom West

Presented by the Community College Interest Group

This panel will highlight different applications of diverse communication theory that can be used in a variety of communication courses.

Chair: Rick Hogrefe, Crafton Hills College

Using Jenga® to Teach the System Theory

 Tony Docan, University of Washington /Los Angeles Pierce College.

The Rewards and Pitfalls of Group Projects in the Basic Speech Course

 Heather Smith, Santa Monica College

Merging Mass Communication and Interpersonal Communication

 Sara Brewer, Santa Monica College

Using Student-Developed Rubrics for Peer Evaluation and Assessment

 Rick Hogrefe, Crafton Hills College

Using the “Snowball” Technique to Discuss Nonverbal Emotional Expression

 Sara J. Morgan, University of Washington

3502 CHERISHING OUR TIME TOGETHER: A DEMONSTRATION OF
NEW FORMS OF ARGUMENTATION AND RESPONSE ON THE HIGH
SCHOOL LEVEL
2:35-3:50pm, Sunday, February 19 Mesquite D
Presented by the Elementary-Secondary Interest Group

Chair: Kate Schuster, Co-Director of the Southern California Urban Debate
League at Claremont-McKenna College

Cherishing Our Time Together: A Demonstration of New Forms of
Argumentation and Response on The High School Level
Kate Schuster, Co-Director of the Southern California Urban Debate
League at Claremont-McKenna College

Additional Panelists Will Be Introduced

3503 REPRESENTATION AND POLITICS
2:35-3:50pm, Sunday, February 19 Mesquite A
Presented by the Media Studies Interest Group

Chair: Steven Brydon, California State University, Chico

In the Shadow of the Wall: The Struggle Over the War in Iraq's Identity in Gary
Trudeau's *Doonesbury*

Brian Danielson, California State University, Long Beach

Michael Moore's Mind: A Pentadic Expose of *Fahrenheit 9/11*

Samantha Senda-Cook, Colorado State University

Mobilization, Media & Distributed Action: The Impact of Blogs on Social
Movements

Anne Marie Todd, California State University, San Jose

Nathan Ditenfass, California State University, San Jose

Spectacular Bodies: The Election Campaigns of Jesse Ventura and Arnold
Schwarzenegger *Debut Paper

A. Freya Thimsen, University of Pittsburgh

Respondent: Brian Ott, Colorado State University

3504 (and 3604) CONVERSATION ANALYSIS: SEVENTEENTH ANNUAL
DATA SESSION
2:35-3:50pm, Sunday, February 19 VIP Room
Presented by Language and Social Interaction

Chair: Charlotte M. Jones, Carroll College

This program offers audience members the opportunity to observe experienced conversation analysts working with videotaped data and to participate in ongoing analysis.

Panelists:

Wayne A. Beach, San Diego State University
Leslie H. Jarmon, University of Texas at Austin
Charlotte M. Jones, Carroll College
Lars D. Linton, University of California, Santa Barbara
Daniel P. Modaff, Ohio University

3505 THEORY AND HEALTH PROMOTION: USING THEORY, FORMATIVE EVALUATION, NARRATIVES, AND PRACTICAL FRAMEWORKS TO UNDERSTAND AND CHANGE BEHAVIOR

2:35-3:50pm, Sunday, February 19

Mesquite C

Presented by the Health Communication Interest Group

Chair: Mary Brown, University of Arizona

A Social Judgment Theory Approach to Formative Research on Social Norm Messages

Sandi W. Smith, Michigan State University
Charles K. Atkin, Michigan State University
Dennis Martell, Michigan State University
Rebecca Allen, Michigan State University
Larry Hembroff, Michigan State University

The Narrative Structure of Self-Efficacy: Recommendations for Communication with Patients Undergoing Total Knee Arthroplasty

Tony L. Knoll, Texas A&M University, Baylor College of Medicine, Michael E. DeBakey VA Medical Center, and the Houston Center for Quality of Care and Utilization Studies
Barbara F. Sharf, Texas A&M University and the Houston Center for Quality of Care and Utilization Studies
Karen Carl, Baylor College of Medicine, Michael E. DeBakey, V.A. Medical Center and the Houston Center for Quality of Care and Utilization Studies
Heather Wellman, Baylor College of Medicine, Michael E. DeBakey, V.A. Medical Center and the Houston Center for Quality of Care and Utilization Studies
Maria Suarez-Almazor, Baylor College of Medicine, Michael E. DeBakey, V.A. Medical Center and the Houston Center for Quality of Care and Utilization Studies

Inoculation Theory: A Theoretical and Practical Framework for the Reduction of Skin Cancer

Jonathan Matusitz, University of Oklahoma

Gerald-Mark Breen, University of Oklahoma

Respondent: Elissa Foster, San Jose State University

3506 CREATING SUPPORTIVE ENVIRONMENTS:
CONSIDERATIONS FOR COMMUNICATION TRAINING IN DIVERSE
SETTINGS

2:35-3:50pm, Sunday, February 19

Grand Ballroom East

Presented by the Organizational Communication Interest Group

Panelists discuss how organizations either have identified the needs of their target populations, imposed barriers on members getting the support they need, or attempted to provide a supportive environment for its members.

Chair: Amie Kincaid, Eureka College

Panelists:

Virginia McDermott, University of New Mexico

Ashley Grisso, College of Santa Fe

Kris Kirschbaum, University of New Mexico

Sarah Tracy, Arizona State University

Pamela Lutgen-Sandvig, The University of New Mexico

Respondent: Amie Kincaid, Eureka College

3507 CHERISHING OUR TIME WITH HER: THE LEGACY OF LEAH
VANDE BERG

2:35-3:50pm, Sunday, February 19

Mesquite B

Presented by the Western States Communication Association

Chair: Nick Trujillo, California State University, Sacramento

Panelists:

Kathy Adams, California State University, Fresno

Kimo Ah Yun, California State University, Sacramento

Anne Bialowas, University of Utah

Heather Hundley, California State University, San Bernardino

A. Susan Owen, University of Puget Sound

Sandra Petronio, Indiana-Purdue University, Indianapolis

3508 MASTER TEACHER PANEL

2:35-3:50pm, Sunday, February 19

Whitewater

Presented by the Communication and Instruction Interest Group

Chair: John T. Warren, Bowling Green State University

Master Teacher: Jeff Kerssen-Griep, University of Portland

3509 COMMUNICATION SCHOLARS AS ADMINISTRATORS IN HIGHER EDUCATION: OUR CONTRIBUTIONS TO CURRENT CHALLENGES

2:35-3:50pm, Sunday, February 19

Snow Creek

Presented by the Communication and Instruction Interest Group

Chair: Ann L. Darling, University of Utah

Panelists: Ann Q. Staton, Texas Woman's University
Donald H. Wulff, University of Washington
Charles R. Bantz, Indiana University Purdue University at Indianapolis
Betsy W. Bach, University of Montana
Ann L. Darling, University of Utah

3510 THE RHETORIC OF THE TIME: VALORIZING THE INDIVIDUAL IN COLLECTIVE FORM

2:35-3:50pm, Sunday, February 19

Oleander I

Presented by the Rhetoric & Public Address Interest Group

Chair: Valerie Renegar, San Diego State University

Reading Sonic Culture in Emerson's "Self-Reliance"

Andrew W. Hansen, Trinity University

Get The Edge

Carl Christman, Cypress College

The Meatrix Exposed: Creating Dystopia Through Over-Reliance, Indifference and Pollution

Matthew Petrunia, University of New Mexico

Respondent: Richard Rogers, Northern Arizona University

3511 MEDIA AND RHETORIC: TRANSCENDING TIME

2:35-3:50pm, Sunday, February 19

Celebrity Room

Presented by the Rhetoric & Public Address Interest Group

Chair: Terry Filipowicz, California State University, Sacramento

Weapons of Choice: Political Narratives and U.S. / North Korean Relations

Zach Justus, Arizona State University

Disaster Images as Rhetorical Devices: Media Coverage of the Indian Ocean
Tsunami

Marissa Jimenez, University of Texas, El Paso

Stacey Sowards, University of Texas, El Paso

Illiteracy, the Reformation and Mass-Produced Image: A Visual Vernacular
Discourse

Damon Hall, University of Utah

MoveOn: Political Activism in the Digital Community

Sherry Nay, Southern Utah University

Respondent: Ann Johnson, California State University, Long Beach

**3512 ALTERNATIVE APPROACHES TO TEACHING
INTERCULTURAL
COMMUNICATION**

2:35-3:50pm, Sunday, February 19

Grand Ballroom Center

Presented by the Intercultural Communication Interest Group

Chair: Janet M. Cramer, University of New Mexico

Teaching Popular Culture as Public Pedagogy

Jing Yin, Clemson University

Applying Asiaticity in Teaching Culture and Communication: Pedagogical
Issues and Challenges

Yoshitake Miike, University of Hawaii at Hilo

Spirituality and Teaching Intercultural Communication

Bhavana Upadhyaya, University of New Mexico

**3513 (also 3613) CHERISHING OUR PERFORMANCES TOGETHER: SOLO
PERFORMANCE SHOWCASE**

2:35-3:50pm, Sunday, February 19

Mediterranean

Presented by the Performance Studies Interest Group

Chair: Amy K. Kilgard, San Francisco State University

Performances:

Excerpt from *Generation X* by Douglas Coupland

Jay Baglia, San José State University

Take This

Dom Brassey, San Francisco State University

Losing (Detach)able Parts

Ragan Fox

“Gatsby Turns Out All Right in the End”: The Secret at the End of My Father’s
Clandestine Life

H. L. (Bud) Goodall, Jr., Arizona State University

Detroit Redux: An Autoethnographic Poem

Mercilee Jenkins, San Francisco State University

Apple of My Ipod

Alexis Litzky, San Francisco State University

“Leap” by Brian Doyle

Jackson B. Miller, Linfield College

Healthy, Wealthy, and Wise: The Lure of Scientology

Heidi Reeder, Boise State University

Excerpt from *Finnegans Wake* by James Joyce

Matthew Spangler, San José State University

Still Looking for Home

Christine M. Warda, City College of San Francisco

The Making of Sandra’s Thesis: Genre-Bending as Deleuzian Line of Flight
(short film)

Director: Sandra Patrice Wheeler, Cosumnes River Community

College

Editor: Jenny Stark, Sacramento State University

Excerpt from “Drifter’s Gold” by Don Blanding

Bud Zeuschner, California Polytechnic State University

Putting Your Pants On One Leg at a Time: Retrospective Journeys of
Reflexivity for the Suicide Dead and a Living Survivor Who Is Trying to Open
the Closet Door

Nicholas Alexis Zoffel, Bowling Green State University

3601 GROUP G.I.F.T.S (GREAT GROUP IDEAS FOR TEACHING SPEECH)

4:00-5:15pm, Sunday February 19

Grand Ballroom West

Presented by the Community College Interest Group

This panel will highlight valuable instructional tools for a group communication course. The activities will also be valuable for group projects within the basic speech course.

Chair: Michael Brydges, Cypress College

Myers-Briggs Types in Groups: Vive La Difference!

Isa N. Engleberg, Prince George’s Community College

Cherishing Time Together: Fostering Critical Inquiry and Collaborative
Learning in the Small Group Research Project

Charmaine Kaimikaua, Cypress College

Collaboration Across Borders: An Online Group Assignment with American
and Taiwanese Students

P.A. Begley, Fresno City College and Dr. Loretta Ya-Wen Teng,
Taichung, Taiwan

Rising to the Occasion: A Critical Thinking Assignment Connecting Public
Speaking with Cultural Identity

Nathan Carter, Ph.D., California State University, San Bernardino
Authenticity, Accountability, and Assessment of the Group Project
Michael Brydges, Cypress College

3602 CHERISHING OUR TIME TOGETHER: A DEMONSTRATION OF
NEW FORMS OF ARGUMENTATION AND RESPONSE ON THE MIDDLE
SCHOOL LEVEL

4:00-5:15pm, Sunday February 19

Mesquite D

Presented by the Elementary-Secondary Interest Group

Chair: Kate Schuster, Co-Director of the Southern California Urban Debate
League at Claremont-McKenna College.

Cherishing Our Time Together: A Demonstration of New Forms of
Argumentation and Response on The Middle School Level

Kate Schuster, Co-Director of the Southern California Urban Debate
League at Claremont-McKenna College

Additional Panelists Will be Introduced

3603 REALITY, ART, MAGIC AND OMNITOPIA

4:00-5:15pm, Sunday February 19

Mesquite A

Presented by the Media Studies Interest Group

Chair: Amber Hutchins, University of Utah

A Captivated Audience: Assumptions and Perceptions of Reality TV Viewers
*Debut Paper

Benjamin Mabe, University of New Mexico

Curating the Website: Art Museums and Their Internet Sites

Laren Fretz, Trinity University

Sammye Johnson, Trinity University

Every Little Thing She Does is Magic: Magical Realism in *Como Agua Para
Chocolate* and *Picking Up the Pieces* *Debut Paper

Raphael Cervantes, University of Iowa

“Small World”: Alex Proyas’ *Dark City* as Omnitopia

Andrew Wood, California State University, San Jose

Respondent: Thomas Endres, University of Northern Colorado

3604 CONVERSATION ANALYSIS: SEVENTEENTH ANNUAL DATA SESSION

4:00-5:15pm, Sunday February 19

VIP Room

Presented by Language and Social Interaction

Chair: Charlotte M. Jones, Carroll College

This program offers audience members the opportunity to observe experienced conversation analysts working with videotaped data and to participate in ongoing analysis.

Panelists:

Wayne A. Beach, San Diego State University

Leslie H. Jarmon, University of Texas at Austin

Charlotte M. Jones, Carroll College

Lars D. Linton, University of California, Santa Barbara

Daniel P. Modaff, Ohio University

3605 COMMUNICATION, ILLNESS, DISABILITY, AND RELATIONSHIPS

4:00-5:15pm, Sunday February 19

Mesquite C

Presented by the Health Communication Interest Group and by the Interpersonal Communication Interest Group

Chair: Melissa Tafoya, Arizona State University

Developing Research on Communication in Personal Relationships of People with Illness and Disabilities.

Dawn O. Braithwaite, University of Nebraska-Lincoln

Relational Agency in Life Threatening Illnesses

Dan O'Hair, University of Oklahoma

Lisa Sparks, George Mason University

The Only Sure Thing is Uncertainty: Relational Dilemmas in the Experience of Breast Cancer

Leigh Arden Ford, Western Michigan University

Eileen Berlin Ray, Cleveland State University

Challenges Facing People with Disabilities in Initiating Romantic Relationships: Establishing an Agenda

Paul A. Mongeau, Arizona State University

Jade Williams, Arizona State University

Melissa Tafoya, Arizona State University

3606 ORGANIZING DISCOURSES IN A POST 9/11 WORLD

4:00-5:15pm, Sunday February 19

Grand Ballroom East

Panel co-sponsored by the Organizational Communication Interest Group, Rhetoric and Public Address Interest Group, and Freedom of Expression/Legal Communication Interest Group

This program explores the communicative dimensions of institutional responses to a post 9-11 world. Specifically, the panelists will address how institutional discourses, including those of corporations, the state, the academy, and others re-constitute surveillance, identity, resistance, and/or knowledge around issues of security and insecurity.

Chair: Bryan Taylor, University of Colorado, Boulder

Scripting Futures: The Rhetoric of Organizational Terrorism Preparedness Exercises

Lisa Keranen, University of Colorado, Boulder

Organizing Intelligence: Post 9-11 Leadership and the Management of Identity

Angela Trethewey, Arizona State University

Bud Goodall, Arizona State University

An Organizational Communication Perspective on Open Source Intelligence

Hamilton Bean, University of Colorado, Boulder

Organizing the Academy: Communicative Responses to the GWOT

Aaron Hess, Arizona State University

Zach Justus, Arizona State University

Respondent: Joseph Tuman, San Francisco State University

3607 TOP THREE PAPERS IN ORGANIZATION FOR RESEARCH ON WOMEN AND COMMUNICATION

4:00-5:15pm, Sunday February 19

Mesquite B

Presented by the Organization for Research on Women and Communication

Chair: Julie K. Schutten, University of Utah

Reconciling “Woman” and “Soldier”: Public Perceptions of Women in the U.S. Military

Rebecca Gill, University of Utah

Gender Role Identity and Feminism Revisited: A Follow-Up Study

Elizabeth A. Suter, University of Denver

Paige W. Toller, University of Nebraska-Lincoln

Turning the “Sign” in a Different Direction: Expanding on Foss’ Rhetorical Schema for the Evaluation of Visual Imagery *Debut Paper
Richard A. May III

Respondent: Erin Reser, Simpson College

3608 CHERISHING OUR TEACHING TIME TOGETHER: FIVE POWERFUL SOCIAL JUSTICE ACTIVITIES FOR THE CLASSROOM
4:00-5:15pm, Sunday February 19 Whitewater
Presented by the Communication and Instruction Interest Group

Chair: Kirsten Broadfoot, Colorado State University

Responding to Words That Wound: Constitutive Racism in a Marketplace of Ideas

Theodore Matula, University of San Francisco
Equal Voices, Silenced Stereotypes: How to Use Media in Discussions of Social Justice and Cultural Identity

Gina Martinez, University of Washington
Nancy Van Leuven, University of Washington

Social Justice on Ice: Lessons from The Sporting News about the Rhetoric of Victimage

Alena Amato Ruggerio, Southern Oregon University

Sexuality in and Out of the Closet

Jennifer Lyn Simpson, University of Colorado at Boulder
Brenda J. Allen, University of Colorado at Denver

Questioning Whiteness

Elizabeth Sink, Colorado State University

3609 LEARNING TO CHERISH SERVICE: USING THE SERVICE LEARNING MATRIX TO CHOOSE A SERVICE LEARNING MODEL
4:00-5:15pm, Sunday February 19 Snow Creek
Presented by the Communication and Instruction Interest Group

Chair: Kevin James Brown, Oregon Institute of Technology

Panelists: Kevin James Brown, Oregon Institute of Technology
Terence Schliesman, Western State College
Kathy Wilcox, Lewis and Clark State College
Donald Ritchie, Klamath Community College

3610 TOWN HALL DEBATE: RHETORICAL LEADERSHIP IN TIMES OF NATIONAL CRISIS: WHAT ARE WE MISSING?
4:00-5:15pm, Sunday February 19 Oleander I
Presented by the Rhetoric & Public Address Interest Group

Chair: Tracey Quigley, University of San Diego

Panelists: Thomas Burkholder, University of Nevada, Las Vegas
Greg Dickinson, Colorado State University
George N. Dionisopoulos, San Diego State University
Bethami Dobkin, University of San Diego
Dayle Hardy-Short, Northern Arizona University
Brian Ott, Colorado State University
Craig R. Smith, California State University, Long Beach
J. Michael Sproule, St. Louis University

3611 AN ENGAGED DEPARTMENT--REVIEW

4:00-5:15pm, Sunday February 19

Celebrity Room

Presented by the Intercultural Communication Interest Group

Chair: Robert A. Emry, California State University, Fullerton

The Center for Community Dialogue, Academic Curriculum, and University and Community Partnerships

Owen Holmes, California State University, Fullerton

Stories of Hope and Civic Renewal from a New Immigrant Community

Ruthi Hoffman Hanchett, California State University, Fullerton

Laura Miller, California State University, Fullerton

Ana Marie Vargas, California State University, Fullerton

Dialogue and Appreciative Inquiry: Community Building Tools in a Multicultural Environment

Stacy Bradshaw, California State University, Fullerton

Videography: Capturing Immigrant Stories and Building a Sense of Community

Philip Rahn, California State University, Fullerton

The Southern California Urban Debate League as a Community Building Tool

Jon Brusckhe, California State University, Fullerton

Toni Nelson, California State University, Fullerton

3612 TOP FOUR PAPERS IN INTERPERSONAL COMMUNICATION

4:00-5:15pm, Sunday February 19

Grand Ballroom Center

Presented by the Interpersonal Communication Interest Group

Chair: Jennifer Cummings-Witker, University of Utah

Persistence of Attempts to Reconcile a Terminated Romantic Relationship: An Application and Partial Test of Relational Goal Pursuit Theory (Top Paper)

William R. Cupach, Illinois State University

Brian H. Spitzberg, San Diego State University
Colleen M. Younghans, Illinois State University
Bobbi Sue Gibbons, Illinois State University

Disclosure from In-laws and the Quality of In-law and Marital Relationships
Mary Claire Morr Serewicz, University of Denver
Robert Ballard, University of Denver
Rebecca Bruflat, University of Denver
Rachel Griffin, University of Denver

An Inductive Examination of the Multi-Dimensionality of Mothers' and Fathers'
Comforting Strategies Following the Death of a Child (Top Student Paper)
Kelly Rossetto, University of Texas, Austin

An Understanding of Romantic Jealousy Experience, Expression and
Commitment Through the Lens of the Investment Model
Jennifer L. Bevan, University of Nevada, Las Vegas

Respondent: L. Edna Rogers, University of Utah

3613 CHERISHING OUR PERFORMANCES TOGETHER: SOLO
PERFORMANCE SHOWCASE

4:00-5:15pm, Sunday February 19

Mediterranean

Presented by the Performance Studies Interest Group

See **3513** for complete listing.

3701 BUSINESS MEETING: COMMUNITY COLLEGE INTEREST
GROUP

5:30-6:30pm, Sunday, February 19

Grand Ballroom West

3702 BUSINESS MEETING: ORGANIZATION FOR RESEARCH ON
WOMEN AND COMMUNICATION

5:30-6:30pm, Sunday, February 19

Mesquite B

3703 BUSINESS MEETING: ELEMENTARY SECONDARY
EDUCATION INTEREST Group

5:30-6:30pm, Sunday, February 19

Mesquite D

3704 BUSINESS MEETING: INTERPERSONAL COMMUNICATION
INTEREST GROUP

5:30-6:30pm, Sunday, February 19

Grand Ballroom Center

3705 TIME AND PLACE COMMITTEE MEETING

5:30-6:30pm, Sunday, February 19

Mesquite C

3800 WSCA SOCK HOP

9:00 pm-1:00 am, Sunday, February 19

Mediterranean

Hosted by California State University, San Bernardino

Live music by BACK PAGES

Featuring: Jim Mooney, Dean Scheibel, Bob Vitti and Javen Borgwardt

McGRAW-HILL: Thank you for supporting the Sock Hop and CSUSB. Visit the McGraw-Hill exhibit and look for their announcement in the later portion of the program.

Monday, February 20, 2006

4001 BUSINESS MEETING: COMMUNICATION AND INSTRUCTION INTEREST GROUP

7:30-8:30am, Monday, February 20

Oleander I

4002 BUSINESS MEETING: HEALTH COMMUNICATION INTEREST GROUP

7:30-8:30am, Monday, February 20

Grand Ballroom East

4003 BUSINESS MEETING: FREEDOM OF EXPRESSION/LEGAL COMMUNICATION INTEREST Group

7:30-8:30am, Monday, February 20

Mesquite C

4004 BUSINESS MEETING: PERFORMANCE STUDIES INTEREST GROUP

7:30-8:30am, Monday, February 20

Whitewater

4101 BRINGING THEORY HOME TO ROOST: APPLYING COMMUNICATION THEORY FOR LASTING RESULTS

8:40-9:55am, Monday, February 20

Snow Creek

Presented by the Community College Interest Group and Communication Theory Interest Group

This panel explores successful teaching and learning strategies to increase our students ability to apply communication theory to their everyday lives.

Chair: Patricia O'Keefe, College of Marin

"I Got WHAT Grade on my Midterm?!": Turning Student Disappointment into a Demonstration of Systems Theory and Communication Climate

Kris Gatto Cullivan, American River College

Diagnosis by Design: Applying Problem-Based Learning Case Studies to Health Communication Courses.

Kristi Vollmer Blackburn, Dona Ana Branch Community College
The Narrative Paradigm and Beyond: Communicating Stories as a Method of Teaching Uncertainty Reduction Theory in the Classroom
Melissa Beall, University of Northern Iowa

4102 CATCHING OURSELVES IN THE ACT: A COLLABORATION TO ENRICH OUR DISCIPLINE THROUGH SOCIAL CONSTRUCTIONIST APPROACHES TO COMMUNICATION

8:40-9:55am, Monday, February 20

Mesquite D

Presented by the Community College Interest Group

No more rigorous moralist than Immanuel Kant has ever lived, but even he said, in a moment of illumination, "out of the crooked timber of humanity no straight thing was ever made." To force people into neat uniforms demanded by dogmatically believed-in schemes is almost always the road to inhumanity. Isaiah Berlin, The Crooked Timber of Humanity

The participants on this panel are part of a newly formed group calling ourselves the "Crooked Timbers Initiative." The purpose of this initiative is to bring together communication teachers, researchers, scholars, and practitioners who are committed to enhancing our discipline by taking a social constructionist perspective on communication. Among other things this group is planning and hosting a 2006 NCA Summer Institute at the University of New Mexico from August 1-4.

Chair: Kim Pearce, DeAnza College

Panelists: Bill Eadie, San Diego State University
Stephen Littlejohn, Consultant
Barnett Pearce, Fielding Graduate University
Shawn Spano, San Jose State University

4103 REPRESENTING IDENTITY

8:40-9:55am, Monday, February 20

Mesquite A

Presented by the Media Studies Interest Group

Chair: Karen McCullough, The Pennsylvania State University

"I'm on the Outskirts of This Article": Magazine Reading and Consumer Identification

Trine Kvidal, University of Utah

Lost Hamster or Lost Identity:?

Debra Krummel-Abram, University of New Mexico

Attempting the Perfect Game of National Identity: Baseball, Hegemony and Fetish in Film *Debut Paper

Peter Campbell, University of Puget Sound

In Defense of Mary Sue: Performing Identity and Challenging the Author-God Function

Beth Bonnstetter, University of Minnesota

Brian Ott, Colorado State University

Respondent: Mary-Lou Galician, Arizona State University

4104 POPULAR MEDIA REPRESENTATIONS THROUGH TIME AND SPACE

8:40-9:55am, Monday, February 20

Mesquite B

Presented by the Media Studies Interest Group

Chair: Steve Classen, California State University, Los Angeles

Polysemically Perverse: Queer Readings of American Idol

Courtney Bates, California State University, Los Angeles

Out of Place: The Food Networks Constructs of Kitchens as Gendered Space

Mike Kalustian, California State University, Los Angeles

The Playboy Club: The Performance of a New American Community

Corey Leighton, Louisiana State University

The Swan: A Modern Day Makeover Show

Lorena Meza, California State University, Los Angeles

Respondent: D. Robert DeChaine, California State University, Los Angeles

4105 REVISING AND EXTENDING EXISTING COMMUNICATION THEORIES

8:40-9:55am, Monday, February 20

Mesquite C

Presented by the Communication Theory Interest Group

Chair: Matthew Petrunia, University of New Mexico

Toward Reconceptualizing Communication Competence HPC³ from a Practitioner's Perspective

Hilda V. Carpenter, Fielding Graduate University

Burke's Bureaucratization of the Imaginative and Ecofeminism: A Theoretical Link between Communication Studies and Issues of the Environment

Elizabeth Richard, Arizona State University (Student Debut Paper)

You Scream, I Scream

Chad Perry, University of New Mexico

Respondent: Jensen Chung, San Francisco State University

4106 TOP THREE PANEL IN HEALTH COMMUNICATION

8:40-9:55am, Monday, February 20

Grand Ballroom East

Presented by the Health Communication Interest Group

Chair: Anne P. Hubbell, New Mexico State University

Crossing Borders in Health Communication Research: An Ecological Approach to Community-Based Health Education in the U.S.-Mexico Borderlands

Leigh Arden Ford, Western Michigan University

Robbin D. Crabtree, Fairfield University

Parentally Bereaved Siblings and Coping Strategies as Related to Health Outcomes

Carolyn Donnerstein, University of Arizona (Top Student Paper)

Using Internet-Based Continuing Education to Enhance Pain Management Skills Among Primary Care Physicians and Hospital Nurses: An Empirical Analysis of Promoting Effective Change Among Medical Practitioners

Marlene M. von Friededrichs-Fitzwater, University of California, Davis, Cancer Center

Kimo Ah Yun, California State University, Sacramento

Michael Hogarth, Center for Medical Informatics, University of California, Davis

California, Davis

Kenneth L. Brier, Consultant

Catherine Russell McGregor, Sutter Auburn Faith Hospice

Respondent: Tamar Ginossar, University of New Mexico

4107 AND IT'S ONE, TWO, THREE STRIKES YOU'RE OUT: MAJOR LEAGUE BASEBALL AND THE STEROID CONTROVERSY

8:40-9:55am, Monday, February 20

Celebrity Room

Presented by the Western Forensics Association

Chair: Patricia M. Ganer, Cypress College

The Ethics of the Arguments Advanced in Baseball's Steroid Controversy

Luke Winslow, University of Texas, Austin

Defending Ruth by Attacking Barry Bonds: The Rhetorical Motives Behind Steroid Accusations

Shawn Whalen, San Francisco State University

"I did not use steroids. Period" Oops, make that, "...I have never intentionally used steroids:" An Analysis of the Committee on House Government Reform's Congressional Hearings on Steroids in Major League Baseball

K. Jeanine Congalton, California State University, Fullerton

Respondent: Patricia M. Ganer, Cypress College

4108 REPRESENTING RACE AND ETHNICITY: FEMINIST PERSPECTIVES

8:40-9:55am, Monday, February 20

Oleander III

Presented by the Organization for Research on Women and Communication

Chair: Sara Hayden, University of Montana

Women, Japanese Orientalism, and Imperial Desire: The Spectacle of a South Korean TV Drama in Japan

Sachi Sekimoto, California State University, Northridge

“You’d Better Build a Strong Crib:” Birth and Development of Feminist Rhetorical Theory

Charlotte Kroløkke, University of Southern Denmark

Karen A. Foss, University of New Mexico

Where are the Women? Race, Sex, and Representation in the 1992 Los Angeles Riot

Sarah E. Stone Watt, Pennsylvania State University

Stressed Out! Stressing through Work, Working Through Stress at ARTS, Inc.

*Debut Paper

Rebecca B. Moy, San Diego State University

Respondent: Monique Myers, Stonehill College

4109 TOP FOUR COMPETITIVE PAPERS IN COMMUNICATION AND INSTRUCTION

8:40-9:55am, Monday, February 20

Oleander I

Presented by the Communication and Instruction Interest Group

Chair: Keith Nainby, California State University, Stanislaus

Thinking Outside of the Disciplinary Box: A Critical Review of Oral Communication Across the Curriculum

Jessica L. Durfee, University of Utah

Interactive Management and Small Group Work in the Collegiate

Communication Classroom: A Case Study in Expanding Contexts of Facilitation

Lucas C. Messer, Arizona State University

A Longitudinal Test of Intercultural Contact’s Effects on Communication

Competence: Euro–American Novice Teachers Mentor African–American High School “Gents.”

Jeff Kerssen–Griep, University of Portland

Karen Eifler, University of Portland

An Embodied, Instructional Approach for Preventing Sexual Assault: Assessing the Impact of Augusto Boal's "Proactive Performance" on Student Empathy and Comforting

José I. Rodríguez, California State University, Long Beach

Marc D. Rich, California State University, Long Beach

Respondent: John T. Warren, Bowling Green State University

4110 PUBLIC ADDRESS AND THE QUEST FOR PROFOUND CHANGE

8:40-9:55am, Monday, February 20

Grand Ballroom West

Presented by the Rhetoric & Public Address Interest Group

Chair: Randall Lake, University of Southern California

Barack Obama and the Modern Jeremiad

Andrew L. Pendoley, San Diego State University

Transformational *Ethos*: Bill Clinton's 1992 DNC Acceptance Speech as a Model of (Re)Framing Character

Michael K. Middleton, California State University, Long Beach

Phronesis and Morality in President Jimmy Carter's Public Statements on Human Rights

Michael Kramer, St. Mary's College

An Advocate for the Unborn: A Rhetorical Analysis of Senator Mike DeWine's Speech on Fetal Rights

Nicole Hurt, Colorado State University

Respondent: Brant Short, Northern Arizona University

4111 SHAPING OUR SENSE OF SELF: CONTEXTUAL EXPLORATIONS OF CULTURAL IDENTITIES

8:40-9:55am, Monday, February 20

Grand Ballroom Center

Presented by the Intercultural Communication Interest Group

Chair: Daniel Hughes, Bluffton University

Grandma's Knitting Gifts: A Self-Reflexive Exploration of Cultural Identity

Patrick Shaou-Whea Dodge, University of Denver

Issues of Passing and Being Raced: Dialogic Analysis of Asian American Double Minority Identification

Jennifer Huynh Thi Anh Morrison, University of Denver

Multiraciality and Geodemography: Ethnomethodological Explorations of Propaganda and Advertising

Nicholas A. Zoffel, Bowling Green State University

"The Pot of Gold at the End of the Feminist Rainbow?": Doing Lesbian and Feminist Across Generation(s)

Andrea M. Davis, Bowling Green State University

4112 ATTRIBUTIONS, TRANSGRESSIONS, AND CONFLICT

8:40-9:55am, Monday, February 20

VIP Room

Presented by the Interpersonal Communication Interest Group

Chair: Craig Rich, University of Utah

Attribution and Interpersonal Communication: Out of Our Heads and Into Behavior

Valerie Manusov, University of Washington

Communication following Relational Transgressions: An Investment Model Explanation

Laura K. Guerrero, Arizona State University

Guy Foster Bachman, California State University, Long Beach

Why People Swear During Conflict: Individual, Interpersonal, and Interactional Influences on Perceived Reasons for Profanity Use

Stacy L. Young, California State University, Long Beach

Jennifer Graham, California State University, Long Beach

Erin Broadhurst, California State University, Long Beach

“She Broke My Heart, But We’re Trying to Be Friends:” Attributions in Break-up Stories and Quality of Post-Dissolutional Relationships

Aimee E. Miller, University of Nebraska-Lincoln

Respondent: Thomas Endres, University of Northern Colorado

4113 COMPETITIVE PAPERS IN PERFORMANCE STUDIES

8:40-9:55am, Monday, February 20

Whitewater

Presented by the Performance Studies Interest Group

Chair: Amy K. Kilgard, San Francisco State University

Moms Mabley: Making History through Comedic Oral Storytelling

Heidi Mueller, California State University, Los Angeles

Mirrored Asylum: Reflections on Naming, Home and Subjectivity in Ireland

Sara L. McKinnon, Arizona State University

Speaking Silence, Embodying History: Intertextual Performative Possibilities in *Memory’s Caretaker*

Kimberlee A. Pérez, Arizona State University

True Fiction: The Virtual Playback Theatre of the “Sex & the Ummah” Column

Usama Kahf, California State University, Long Beach

Respondent: Jackson B. Miller, Linfield College

4201 TEACHING THE ARGUMENTATION COURSE: CRITICAL THINKING THROUGH YEARS OF EXPERIENCE

10:05-11:20am, Monday, February 20

Snow Creek

Presented by the Community College Interest Group

Panelists focus on cherishing our time together by sharing over 100 years of experience with fashioning ideal content in an Argumentation/Critical Thinking course. This panel explores diverse methods used to teach argumentation curriculum, recognized barriers to overcome in creating a classroom climate that is both cooperative and competitive, and the evolution of the argumentation course as a cornerstone of the community college curriculum.

Chair: Joanne Babin, Skyline College

Panelists: Doug Fraleigh, California State University at Fresno
Pat Ganer, Cypress College
Michael Leigh, Orange Coast College
Patricia O'Keefe, College of Marin

4202 CHERISHING OUR TIME TOGETHER LEARNING HOW TO TALK TO EACH OTHER AND LISTEN TO EACH OTHER.

10:05-11:20am, Monday, February 20

Mesquite D

Presented by the Elementary-Secondary Interest Group

Chair: Bob Stockton-Katella High School, Anaheim, California

Cherishing our Time Together Becomes Important as we Learn to Listen in any Setting

Melissa L. Beall, University of Northern Iowa

4203 MEDIATED GENDER

10:05-11:20am, Monday, February 20

Mesquite A

Presented by the Media Studies Interest Group

Chair: Cara Buckley-Ott, Indiana University

Is It Finally Their Time? How Women Are Depicted in *Time* Covers, 1900-1999

Susanne Dorr, Trinity University

Sammye Johnson, Trinity University

The Killer Bride: A Mediated Metaphor of Third Wave Feminism in Tarantino's *Kill Bill* Films

Leah Ransom, California State University, San Bernardino

The Wardrobe Malfunction: Ritual and Superbowl XXXVIII

Eric Robertson, California State University, San Diego

Laughing at Absence: Instinct Magazine and the Hyper Masculine Gay Future

Dustin Goltz, Arizona State University

Respondent: Janellen Hill, Regis University

4204 MUSIC TELEVISION AFTER THE MUSIC VIDEO: CRITICAL PERSPECTIVES ON VH1 AND MTV

10:05-11:20am, Monday, February 20

Mesquite B

Presented by the Media Studies Interest Group

Chair: Christina R. Foust, Denver University

I Love the 80s: The Pleasures of a Postmodern History

Charles Soukup, University of Northern Colorado

The Pimping of Self-Improvement: Transgressive Excess and *Pimp My Ride*

Naomi Rockler, Colorado State University

Criticism of Consumption?: Exploring the Ideological Tensions of VH1's *Best Week Ever*

Christina Foust, Denver University

VH1's *Behind the Music* and American Culture: The Role of Myth in Meritocracy

Matthew H. Barton, Southern Utah University

Paul D. Thurman, University of Northern Iowa

Respondent: Arne G'Schwind, Regis University

4205 SOCIAL ISSUES RELATED TO THE FIRST AMENDMENT

10:05-11:20am, Monday, February 20

Mesquite C

Presented by the Freedom of Expression/Legal Communication Interest Group

Chair: Suzanne Larson, Southern Utah University

Casino City, Inc. v. U.S. Department of Justice: Regulation Commercial Expression Regarding Illegal Products and Services

Richard A. Parker, Northern Arizona University

Foregrounding Free and Responsible Speech in a Postmodern Age: The "Practical Philosophy" of Communication Ethics

Leeanne M. Bell, Duquesne University

Tricia Giannone Henson, Duquesne University

(Student Submission)

Dissent in a Time of War: Wayne Morse and Vietnam

Ron Manuto, Research Associates

Sean Patrick O'Rourke, Furman University

Thou shall not or thou shall post the Ten Commandments: The Supreme Courts confusing standard in McCreary County, Kentucky and Van Orden

Suzanne Larson, Southern Utah University

Terry West, Southern Utah University

**4206 THEORIZING FUTURE DIRECTIONS ON WORK-LIFE
TRANSITION/BALANCE RESEARCH: ROUNDTABLE DISCUSSING
WHAT COMMUNICATION SCHOLARS CAN OFFER**

10:05-11:20am, Monday, February 20

Grand Ballroom East

Presented by the Organizational Communication Interest Group

Chair: Paige Pettyjohn Edley, Loyola Marymount University

Panelists:

Sarah Tracy, Arizona State University
Angela Trethewey, Arizona State University
Jess Alberts, Arizona State University
Sarah Riforgiate, Arizona State University
Renee Houston, University of Puget Sound
Yvonne Montoya, Arizona State University
Emily Cansler, Arizona State University
Annika Hylmö, Loyola Marymount University
Elizabeth Richard, Arizona State University
Kristen Davis, Arizona State University

Respondent: Erika Kirby, Creighton University

**4207 A TIME TO GATHER TOGETHER: A COMMUNITY
DISCUSSION OF COMMUNITY COLLEGE POLICY DEBATE**

10:05-11:20am, Monday, February 20

Celebrity Room

Presented by the Western Forensics Association

Chair: Kenneth S. Lee, California State University, Los Angeles

Panelists:

Ken Sherwood, Director of Forensics, Los Angeles City
College
Jordan Mills, Director of Forensics, Southwestern College
Eric Fletcher, Director of Debate, Fresno City College
Bob Lechtreck, Co-Director of Debate, Bakersfield College
Robert Becker, Co-Director of Forensics, Northwest College

**4208 DO WE STILL NEED TALK OF OPPRESSION? AN
EXPLORATION OF POWER FEMINISM AND ITS IMAGES OF FEMINISM
IN COMMUNICATION**

10:05-11:20am, Monday, February 20

Oleander III

Presented by the Organization for Research on Women and Communication
In light of last year's pre-conference, "Interrogating Feminism," this panel proposes to reconsider some of the issues raised there and to consider the implications of some of the positions that seemed most prevalent, specifically those that fall under the category of power feminism. Power feminism is a position that contends that women need to stop focusing on oppression and start enacting their own power. Since questions of agency and power continue to remain crucial to feminist discussions in communication and elsewhere, this panel will consider: how is agency theorized within power feminist epistemology? How might this be productive and/or problematic? What is the form of power advocated by power feminists? What do power feminists have to say about gender and sexism? What fruitful critiques do power feminists have to offer to other types of feminists? What are the impacts of power feminism on feminism in communication? The panelists selected for this roundtable discussion vary in their feminist positions as well as in their perspectives on power feminism. Moreover, the panelists include two feminists who have been in the field of communication for a long period of time, two feminists who are assistant professors, and two feminists who are graduate students. The panel also includes a range of sexual, racial, and class identities.

Chair: Belle A. Edson, Arizona State University

Participants: Belle A. Edson, Arizona State University
Cindy L. Griffin, Colorado State University
Karma R. Chávez, Arizona State University
Sheena Malhotra, California State University, Northridge
Aimee Carrillo Rowe, University of Iowa
Jessie Stewart, Southern Illinois University, Carbondale

Respondent: Karma R. Chávez, Arizona State University

4209 ACTIVISM IN THE CLASSROOM: EXPLORING ETHICAL AND PRACTICAL DIMENSIONS

10:05-11:20am, Monday, February 20

Oleander I

Presented by the Communication and Instruction Interest Group

Chair: Sara DeTurk, University of Texas at San Antonio

Negotiating our Public Roles as Politically Active Citizens and Instructors
Beth Fratkin, University of Utah

Ethically Performing the Other: Ethnography and Activism in the Classroom
Kurt Lindemann, Arizona State University

Performing Activism: Theory versus Practice in the Classroom
Jay Baglia, San Jose State University

Everyday Social Justice Activism in Teaching

Jeff Kerssen-Griep, University of Portland

Environmental Activism and Classroom Instruction

Stacey K. Sowards, University of Texas at El Paso

Teaching Social Activism and Encouraging Community Engagement in the Classroom

Rebecca Imes, Carroll College

Reaching toward Praxis

D. Robert DeChaine, California State University, Los Angeles

4210 POLITICAL AND NARRATIVE TIME

10:05-11:20am, Monday, February 20

Grand Ballroom West

Presented by the Rhetoric & Public Address Interest Group

Chair: Karen Rasmussen, California State University, Long Beach

Cherishing rights and Marking Time in Roe v. Wade

Janice Schuetz, University of New Mexico

Cherishing Women's Images by Learning from the Past

Ann Johnson, California State University, Long Beach

Temporal Integration and the Cherishing of War and the Warrior in the Novels of Nelson DeMille

Sharon D. Downey, California State University, Long Beach

Cherishing Culture through Temporal Unities in Rudolfo Anaya's Bless Me, Ultima

Karen Rasmussen, California State University, Long Beach

4211 RADICALIZING OUR TIME TOGETHER: LINKING INTERCULTURAL COMMUNICATION AND SOCIAL JUSTICE

10:05-11:20am, Monday, February 20

Grand Ballroom Center

Presented by the Intercultural Communication Interest Group

Chair/Facilitator: Kathryn Sorrells, California State University, Northridge

As a result of neoliberal globalization, the “war on terror,” and the rise in religious fundamentalism in the U.S. and globally, we see a magnification of economic inequity between the rich and the poor, an escalation of the use of violence as a means to address international, inter-ethnic, inter-racial and intercultural conflict, an increase in ethnocentrism and vitriolic attacks on pluralism and cultural diversity both at home and abroad. As educators, we have a responsibility to create spaces and strategies that can help our students, our communities and ourselves understand the complex dynamics and implications of the current global situation. In this session, panelists facilitate a roundtable discussion to make visible and tangible the links between intercultural communication and social justice. Conceptual and pedagogical

strategies for integrating issues of social justice into the intercultural communication classroom are shared to advance an intercultural communication praxis based on justice, equity and peace. An additional goal of the panel is to develop online and other networks to connect intercultural educators and activists beyond this brief conference panel session.

Panelists: Alexa Dare, University of Montana
 Wenshu Lee, San Jose State University
 Karen Lovaas, San Francisco State University
 Gordon Nakagawa, California State University, Northridge
 Kathryn Sorrells, California State University, Northridge

4212 MODELING RELATIONAL CHANGE

10:05-11:20am, Monday, February 20

VIP Room

Presented by the Interpersonal Communication Interest Group

Chair: Brooke Illes, California State University Long Beach

The Influence of Investment Model Constructs on the Likelihood of Committing Infidelity

 Beth Babin-Gallagher, Arizona State University

Applying and Expanding Facework Theory to Achieve Improved Conflict Resolution Outcomes: Facework and Environmental Conflict

 Alice Hopkins-Loy, University of New Mexico

Female (in a Wheelchair) Initiation of Dating: An Investigation of First Date Goals

 Paul A. Mongeau, Arizona State University

 Jade Williams, Arizona State University

Feeling Like a Family: An Investigation of Turning points in Stepfamilies

 Allison C. Christian, University of Denver

Respondent: Maggie Pitts, University of California Santa Barbara

4213 CHERISHING (OUR) TIME (TOGETHER) THROUGH THE PERFORMANCE OF MEMORY

10:05-11:20am, Monday, February 20

Whitewater

Presented by the Performance Studies Interest Group

Chair: Diana Martinez, Syracuse University

Reshaping Memories: Remembering 9/11 through Vernacular Poetry

 Sandra Kellogg Rath, Arizona State University

Transcending Silence through the Imagination: The Use of Performative Writing in Anita Diamant's *The Red Tent*

 Diana Martinez, Syracuse University

Reconstructing Memories at “living libraries”: Using Narrative Performances to Breakdown Societal Prejudice

Gavin Humes, Pepperdine University

It’s Not Right, but It’s Okay: How Dominant Ideologies Construct a Popstar

Greg Arline, Arizona State University

Vote or Die!: Hip-hop’s Performative Action to Generate Political Empowerment

Matthew Maddex, Miami University of Ohio

4301 LUNCHEON

11:45-2:00pm, Monday, February 20

Mediterranean

4401 BUILDING A STRONG COMMUNICATION DEPARTMENT

2:10-3:25pm, Monday, February 20

Snow Creek

Presented by the Community College Interest Group

Bakersfield College transformed its department from a public speaking mill to a comprehensive communication studies discipline. This panel discusses ways of making your Communication Department stronger in the areas of articulation, showcasing, certificate programs, and connections across campus and the community. Once our presentations are completed, we hope to facilitate a round table discussion building on each other’s ideas.

Chair: A. Todd Jones, Bakersfield College

Panelists: Articulation Issues, Helen Acosta, Bakersfield College
 Communication Showcase, Michele Bresso, Bakersfield College
 Certificate Program, A. Todd Jones, Bakersfield College
 Building Bridges with Other Departments/Community, Mark Staller, Bakersfield College

4402 MODEL TEACHING AWARD

2:10-3:25pm, Monday, February 20

Mesquite D

4403 ANIMATED IDEOLOGY

2:10-3:25pm, Monday, February 20

Presented by the Media Studies Interest Group

Mesquite A

Chair: Beth Bonnstetter, University of Minnesota

A Cultural Criticism of the *Daredevil* Comic Books and Movie *Debut Paper

Bill Kelvin, California State University, Chico

Wringing Out Diversity: The Ideological Agenda(s) of *SpongeBob SquarePants*

Jason Zingsheim, Arizona State University

Encouraging Commitment to Social and Environmental Issues via the
Television Series *Captain Planet*

Lea Jane Parker, Northern Arizona University
Animated Blackness in *Shrek* *Debut Paper
Daren C. Brabham, University of Utah

Respondent: Dave Natharius, Arizona State University

**4404 PERSPECTIVES ON SCREEN AESTHETICS: WHERE NEW
MEETS OLD**

2:10-3:25pm, Monday, February 20

Mesquite B

Presented by the Media Studies Interest Group

Televisuality in the Digital Age: Mitcom, Broadbandcasting and the Persistence
of Vision

Judd Ethan Ruggill, University of Arizona

Compelled to Gaze: The Significance of Characters Looking at Fireworks in
Film and Television Stories

Mary Beth Haralovich, University of Arizona

Locating the Televisual in Golden Age Television

Caren J. Deming, University of Arizona

**4405 ISSUES AND CONCERNS ABOUT TEACHING
UNDERGRADUATE RESEARCH METHODS: A ROUNDTABLE FORUM**

2:10-3:25pm, Monday, February 20

Mesquite C

Presented by the Communication Theory Interest Group

This panel is composed of authors of communication research textbooks. The
panelists will each respond to a series of questions about teaching undergraduate
communication research courses. The hope is that audience members will
participate in the discussion after all of the panelists have spoken on each issue.

Chair: Rodney A. Reynolds, Pepperdine University

Joann Keyton, University of Kansas

John C. Reinard, California State University, Fullerton

Lawrence R. Frey, University of Colorado, Boulder

Steven T. McDermott, California Polytechnic State University

Rodney A. Reynolds, Pepperdine University

**4406 INFLUENCES ON AND IMPACTS OF INFORMATION AND
COMMUNICATION TECHNOLOGY**

2:10-3:25pm, Monday, February 20

Grand Ballroom East

Presented by the Organizational Communication Interest Group

Chair: Bettina M. Heiss, University of Southern California

Instant Messaging: Validation of a Conflict Scale

Elayne Shapiro, University of Portland

Darshan Sawantdesai, University of Portland

Culture's Impact on the Faithful Use of New Computer Mediated

Communication Technology: Considerations for Further Study (Top Debut Paper)

Jennifer L. Heckman, University of Southern California

New Tools for Learning? Integrating Information and Communication Technology in Higher Education

Renee Houston, University of Puget Sound

Josefa Lago-Grana, University of Puget Sound

Identify, Identification, and the Organization: A Burkean approach to Understanding the Use of Electronic Message Boards to Discourage Organizational Identification

Christina M. Bates, Arizona State University

Respondent: Philip Salem, Texas State University

4407 WSCA AND SUSTAINABILITY: WHERE HAVE WE BEEN, WHERE ARE WE NOW, WHERE SHOULD WE GO?

2:10-3:25pm, Monday, February 20

Celebrity Room

Presented by the Immediate Past President

The WSCA Futures Committee will discuss WSCA's sustainability initiative and WSCA's current sustainability policy. The session will then be devoted to an interactive discussion of future possibilities for WSCA and Sustainability.

Chair: Connie Bullis, University of Utah

Participants: Betsy Bach, University of Montana

Eric Morgan, New Mexico State University

Diane Martin, University of Portland

4408 (Double Session with 4508) FROM IDEA TO ARTICLE: A WORKSHOP TO FACILITATE ACADEMIC SUCCESS (DOUBLE SESSION)

2:10-3:25pm, Monday, February 20

Oleander III

Presented by the Organization for Research on Women and Communication

This hands-on, interactive program is designed to address several pressures that scholars currently face in the communication field as they work to do research and publish: (1) increasing pressures to publish; (2) the lack felt by many scholars of an intellectual community; (3) the lack of time to do research; and (4) the yearning many scholars feel for more meaningful intellectual exchange at

professional conventions. In the first part of this two-part program, experienced scholars will share ideas for making the research and publication process more effective and enjoyable. For the second part of the program, in the first part of this two-part program, participants are invited to bring an idea that they would like to develop into a publication. In small groups, participants will work with one another to facilitate the development of that idea in whatever area the participant would like assistance—for example, conceptual framing, making sense of reviewers' comments, selecting appropriate methods, selecting appropriate data, digging into the data, organizing the paper, and letting go of the paper.

PART I FROM IDEA TO ARTICLE

Chair: Sara Hayden, University of Montana

Productivity Tips for Beginners and Beyond

Helene A. Shugart, University of Utah

Building Community and Confidence through Collaboration

Jess Alberts, Arizona State University

Sarah Tracy, Arizona State University

Angela Trethewey, Arizona State University

Perishing while Trying to Publish: Publishing Experiences through the Eyes of Junior Faculty

Tracey Owens Patton, University of Wyoming

Publication from the Perspective of a Journal Editor

Michele Jackson, University of Colorado

4409 (Double panel with 4509) **CHERISHING OUR TIME WITH OUR COLLEAGUES: HONORING THE WORK OF JO SPRAGUE**

2:10-3:25pm, Monday, February 20

Oleander I

Presented by the Communication and Instruction Interest Group

This panel will give Dr. Sprague's colleagues, students and friends an opportunity to share how they have cherished their time with her by revisiting her work and charting its implications for the future. The panel chairs will introduce this panel by briefly reviewing Dr. Sprague's many contributions to our discipline; subsequent panelists will offer anecdotes, stories and snippets of research that illuminate how Jo Sprague's work has illuminated their own efforts at understanding communication in and with respect to the classroom. Audience members will be invited to share their own insights regarding Dr. Sprague's scholarship and leadership.

Co-Chairs: Deanna L. Fassett, San José State University

Beth Von Till, San José State University

Panelists: Ann Darling, University of Utah

Mindi Golden, San José State University, University of San Francisco
Jan Hoffmann, Georgia College and State University
Tina Lim, San José State University
Kevin Marinelli, San Jose State University
Shelley Medina, San Jose State University
Jody Nyquist, University of Washington
Tasha Souza, Humboldt State University
Ann Staton, Texas Woman's University
John T. Warren, Bowling Green State University
Karen Williams, San José State University
Don Wulff, University of Washington

4410 RHETORIC, FAITH, POLITICS AND THE PUBLIC: CHANGING TIMES, UNCHANGING ISSUES

2:10-3:25pm, Monday, February 20 Grand Ballroom West
Presented by the Rhetoric & Public Address Interest Group

Chair: Katie Gibson, California State University, Long Beach

Conversion Stories and the Rhetorical Rise of the American Right

Christina Foust, University of Denver

Scriptures of the Post-Christian Faith: Revisiting the Discourse of Mass Culture in the 20th Century

Marc Leverette, Colorado State University

Faith in the 2004 Presidential Election

Jeremy J. Estrella, California State University, Long Beach

Respondent: Dan Brouwer, Arizona State University

4411 MULTICULTURAL PERSPECTIVES: HIGHER EDUCATION'S IMPERATIVE

2:10-3:25pm, Monday, February 20 Grand Ballroom Center
Presented by the Intercultural Communication Interest Group

Chair: A. J. Baltes, Prairie View A & M University

Development of Cultural Viability through Hands-on Projects

B. J. Freeman, Prairie View A & M University

Incorporating Multicultural Perspectives in the Assessment Process

Eun-ho Yeo, Prairie View A & M University

Development of the Course Structure: Methods that Enhance Learning at a Black Institution

Jennifer Burke, Prairie View A & M University

Fostering a Diverse Community in Style and Rhetoric
A. J. Baltés, Prairie View A & M University

4412 PROMISING NEW MEASURES FOR COMMUNICATION RESEARCH

2:10-3:25pm, Monday, February 20

VIP Room

Presented by the Interpersonal Communication Interest Group

Quantitative research in communication is only as good as the validity and reliability of the measurement instruments and techniques. This panel of experts will identify some promising measures developed within the last 10 years in areas such as interpersonal, small group, health, organizational, mass, political, intercultural, instructional, and computer-mediated communication. They will explore the development of the measures, identify those with the most promise for future research, and suggest lines of research appropriate for such instruments.

Chair: Rebecca B. Rubin, Kent State University

Panelists: Rebecca B. Rubin, Kent State University
Alan M. Rubin, Kent State University
Elizabeth M. Perse, University of Delaware
David R. Seibold, University of California at Santa Barbara
Elizabeth Graham, Ohio University

4413 GO WEST!: PERFORMANCE STUDIES, TRADITION, AND THE TENURE-TRACK

2:10-3:25pm, Monday, February 20

Whitewater

Presented by the Performance Studies Interest Group

Chair: Jay Baglia, San José State University

Participants: Tony Perucci, California State University, Northridge
Amy K. Kilgard, San Francisco State University
Matthew Spangler, San José State University
Jay Baglia, San José State University

4501 WHAT ROLE SHOULD VALUES PLAY IN TEACHING INTERPERSONAL COMMUNICATION?

3:35-4:40pm, Monday, February 20

Snow Creek

Presented by the Community College Interest Group

The issue of values has become a subject of increasing interest in books, journals, and social and political discussion. Current research suggests that incivility is a major problem in American culture. Should we teach values in

interpersonal communication classes? Is the concept of “universal values” a valid paradigm or do humans make choices based on relativistic ethics?

Discussion of these issues could help create a national dialogue on a timely and important topic.

Chair: Patricia A. Scileppi, Riverside Community College

Discussants: Joan Gibbons-Anderson, Riverside Community College
Rick Hogrefe, Crafton Hills College
Rosemary Swade, El Camino College
Roana Thornock, Los Angeles Valley College
Melinda Womack, Santiago Canyon College
Bud Zeuschner, California Polytechnic State University, San Luis Obispo

4502 HARMONIOUS MELODIES: CLASSROOM DISCUSSIONS TO FIND (OUR) VOICES (TOGETHER)

3:35-4:50pm, Monday, February 20

Mesquite D

Presented by the Community College Interest Group

This panel focuses on creating a classroom climate that fosters open communication lines between dominant and non-dominant voices.

Chair: Joanne Babin, Skyline College Department

Co-Teaching Whiteness as a Mixed Race Team: Reflections of an Intercultural Communication Class

Brenda Ahnholz and Teresa Sutowski, Ohlone College

Three Fingers and the Mirror: An Activity on Perception and Identity

Eileen Pippins, San Francisco State University

Encouraging Audience Identification with the Ill and Disabled: Filmic Use of the Archetypal Metaphor

Lauren Popell Velasco, Foothill Community College

Blasting Heteronormativity One Perception at a Time: A Personal Narrative in Purposefully Coming Out in Class

Marina Whitchurch, Ohlone College

4503 QUEERING TELEVISION

3:35-4:50pm, Monday, February 20

Mesquite A

Presented by the Media Studies Interest Group

Chair: Anne Bialowas, University of Utah

When ‘Queer’ is Not Subverting the Subversive Through Binary Identity Construction *Debut Paper

Janel Nikol Beckham, California State University, San Diego

Crimes Against Nature: Investigating Representations of Transgendered Characters on *CSI* and *Law & Order SVU*

Karen McCullough, Penn State

Queer Eye's Critical Performances of Desire: Cultivating Queer Public with an (un)Civil Tongue

Nina Maria Lozano-Reich, Loyola Marymount University

Kyre Pearson, Loyola Marymount University

It Should Be Called *Jack & Karen*: Queering the Agon on *Will & Grace*

Cara Buckley-Ott, Indiana University

Respondent: Harry Haines, Trinity University

4504 USING COMMUNICATION THEORY TO HELP RECONCEPTUALIZE THE PAST, PRESENT AND FUTURE: APPLICATIONS TO HISTORICAL FIGURES, INTERCULTURAL ADJUSTMENTS, AND INTERSELLAR COMMUNICATION
3:35-4:50pm, Monday, February 20 Grand Ballroom West
Presented by: Communication Theory Interest Group

Chair: Joe Anderson, University of Utah

Two Memories Running Parallel: The Queering of Che Guevara's Public Memory in *The Motorcycle Diaries*

Christina Colp-Hansbury, Arizona State University

A Theory of Coculturation

Melissa L. Curtin, University of New Mexico

Theorizing the Extraterrestrial: Authorial Assumptions and the Impact on Interstellar Communication

Matthew D. Petrunia, University of New Mexico

Respondent: Thomas G. Endres, University of Northern Colorado

4505 PERFORMING HEALTH AT CULTURAL INTERSECTIONS: ICONS, ART, LABYRINTHS, PHYSICS, AND DIALECTICS
3:35-4:50pm, Monday, February 20 Mesquite
Presented by the Health Communication Interest Group

Chair: Kendra Rivera, San Diego State University

Performances of Healing Icons: Retablos, Milagros, Altars & Holy Cards in Mexican-Chicana/o Narrativity

Sarah Amira De la Garza, Arizona State University

Barbara F. Sharf, Texas A& M University

Ramon Rivera-Servera, Arizona State University

Expressing the Ineffable: The Artistic Creations of Medical Students at the End of their Hospice Rotation

Joanna Eidsmore, San Diego State University

Emma Kershaw, San Diego State University

Walking the Labyrinth: Reconnecting Spiritual Lessons to Nature

Amber Zimmerman, Southern Illinois University

Jeanine Minge, University of South Florida

Wording their Worlds: Creating Health through Discursive Structures

Alana M. Nicastro, Westmont College

Dialectics of Doubt and Acknowledgment: Re-counting What "Counts" in Cultural Immersion

Summer Carnett, San Diego State University

Katherine Slauta, San Diego State University

Patricia Geist-Martin, San Diego State University

Respondent: Eileen Berlin Ray, Cleveland State University

4506 ENGAGING ORGANIZATIONAL COMMUNICATION

SCHOLARSHIP I: USING SCHOLARSHIP TO INFORM AND TRANSFORM COMMUNITY AND ORGANIZATIONAL ENGAGEMENTS

3:35-4:50pm, Monday, February 20

Grand Ballroom East

Presented by the Organizational Communication Interest Group

“Cherishing (Our) Time (Together)” encourages us to recognize the importance of time and how we use our time as scholars, teachers, and humans. It invites us to value our WSCA family and scholarly community and to reflect on ways to extend the civic and social justice dimensions of our research and teaching activities.” These back-to-back round table sessions provide time and space for scholars concerned with engaged communication scholarship, pedagogy, and social action to engage with one another and the audience to explore how organizational communication scholarship transforms and is transformed by mindful and ethical engagement with the communities and organizations we belong to. These sessions will showcase scholars and practitioners at many stages of their professional development and encourage audience participation and discussion.

Chair: Sherwyn P. Morreale, University of Colorado at Colorado Springs

Panelists:

Sherwyn P. Morreale, University of Colorado at Colorado Springs

Patricia Riley, University of Southern California

Renée Houston, University of Puget Sound

Jennifer Lyn Simpson, University of Colorado at Boulder

Clara L Popa, Rowan University

4507 THE FUTURE OF INTERCOLLEGIATE PARLIAMENTARY DEBATE: A REVIEW OF THE PAST TO HELP SUSTAIN THE FUTURE
3:35-4:50pm, Monday, February 20
Presented by the Western Forensics Association

Celebrity Room

Chair: Nicholas Russell, California State University, Long Beach

The Future of Debate: Revisiting the Past

Joseph DeSantis, California State University, Long Beach

The Inclusion of Policy Debate Theories in Parliamentary Debate: An Examination of the Process

William Neeson, California State University, Long Beach

Strategies to Increase Participation Rates

Sarah Crachiolo, California State University, Long Beach

The Future of Government Case Construction in Parliamentary Debate: A Survey of Contemporary Approaches

Jared Miller, California State University, Long Beach

Brian Danielson, California State University, Long Beach

Narrowing the Forum: Mutually Preferred Judging and Parliamentary Debate

Michael K. Middleton, California State University, Long Beach

Respondent: Steven Robertson, University of Southern California

4508 (continued from 4408) PART II FROM IDEA TO ARTICLE
3:35-4:50pm, Monday, February 20

Oleander III

For the second part of the program will be devoted to providing assistance to the individual participants with the publication process. Participants will divide into small groups of three, with at least one facilitator in each group. The group will provide whatever assistance each individual needs for the development of an idea s/he has for research. The groups will be formed at the time of the program according to the number and interests of participants. Facilitating the groups will be:

Jess Alberts, Arizona State University

Connie Bullis, University of Utah

Suzanne M. Daughton, Southern Illinois University

Greg Dickinson, Colorado State University

Sara Hayden, University of Montana

Michele Jackson, University of Colorado

Tracey Owens Patton, University of Wyoming

Helene A. Shugart, University of Utah

Sarah Tracy, Arizona State University

Angela Trethewey, Arizona State University

4509 CHERISHING OUR TIME WITH OUR COLLEAGUES:
HONORING THE WORK OF JO SPRAGUE

3:35-4:50pm, Monday, February 20

Oleander I

See **4409** for a description and panel listing.

4510 (Double Panel with 4610) HONORING PHILIP C. WANDER:
CHERISHING FOUR DECADES OF TEACHING AND SCHOLARSHIP IN
RHETORICAL STUDIES

3:35-4:50pm, Monday, February 20

Mesquite B

Presented by the Rhetoric & Public Address Interest Group

In his four decades of scholarly work, Philip C. Wander has politicized rhetorical studies, challenging and overcoming the separation of professional activity from moral and political engagement. Professor Wander and his co-authors have tackled topics including pro-slavery rhetoric, Native American and environmental rhetoric, the rhetoric of science and of American foreign policy; feminist criticism as well as anti-war rhetoric and its relations to issues of fascism, the Cold War, the Vietnam War, the two Gulf Wars, and Neo-conservatism; and the rhetoric of science, along with media criticism and analyses of popular culture texts such as *All in the Family*, *Roots*, and *Blade Runner*. His explorations of Rhetorical Contextualization and the Third Persona have inspired a new generation of critics to read beyond the surfaces of page and screen, to seek out the voices ignored by more traditional forms of analysis.

To introduce the panel, Professor Wander will reflect on his experiences, lessons, silences, and ongoing research agenda. The participants will then share their insights into Professor Wander's impact on their lives and research. A brief slide show will follow and we will also welcome contributions from the audience.

Program Chairs: Hanns Hohmann, San José State University
Andrew Wood, San José State University

Presenter: Philip C. Wander, San José State University

Panelists: Kevin J. Ayotte, California State University, Fresno
James Bunker, University of Utah
Dana Cloud, University of Texas, Austin
Fernando Delgado, Minnesota State University
Peter Ehrenhaus, Pacific Lutheran University
Harry Haines, Trinity University
John Hammerback, California State University, East Bay
Dayle Hardy-Short, Northern Arizona University
Tom Hollihan, University of Southern California
Ako Inuzuka, University of Pittsburgh, Johnstown

Dennis Jaehne, San José State University
Jong-Hwa Lee, Loyola Marymount University
Richard Morris, Arizona State University, West
Robert P. Newman, University of Pittsburgh
A. Susan Owen, University of Puget Sound
Abhik Roy, Howard University
Brant Short, Northern Arizona University
Michael Sproule, St. Louis University
Omar Swartz, University of Colorado at Denver
James T. West, independent novelist and screen writer
(Contribution from Bruce Gronbeck, University of Iowa,
and Edwin Black, University of Wisconsin will be read at
the panel.)

Slide Show: Wenshu Lee, San José State University
Anne Marie Todd, San José State University

**4511 CONTINUING TO SPEAK (THROUGH) SILENCE: REVISIONING
THE POLITICS OF VOICE**

3:35-4:50pm, Monday, February 20

Grand Ballroom Center

Presented by the Intercultural Communication Interest Group

Soccer and Silence

Michaela Walsh, University of Iowa

A Sun/Moon Gift

Aimee Carrillo Rowe, University of Iowa

Silent Screams: Representations of Agony and Angst in Visual Narratives

Karen A. Stewart, Arizona State University

Material Reality: Silence and In/Visibility at the Site of Material Body(ies)

Kimberlee Perez, Arizona State University

4512 RELATIONAL DEMANDS, DECEPTION, AND STRESS

3:35-4:50pm, Monday, February 20

VIP Room

Presented by the Interpersonal Communication Interest Group

Chair: Erin Broadhurst, California State University Long Beach

An Exploration of the Communicative and Relational Implications of
Competitiveness among Adult Siblings

Lisa Farinelli, Arizona State University

Susan J. Messman

Message Design Logic, Goals, and Message Characteristics in Second-Request
Messages

Gwen A. Hullman, University of Nevada, Reno

Saralinda Seibert, University of Nevada, Reno

Amy Arias, University of Nevada, Reno

Janet Clark, University of Nevada, Reno

Social Skills, Psychological Well-Being, and the Mediating Role of Perceived Stress

Chris Segrin, University of Arizona

Alesia Hanzal, University of Arizona

Carolyn Donnerstein, University of Arizona

Effect of Attractiveness-Matching on Perceptions of Deception

Raven A. Pfister, Purdue University

Amy M. Bippus, California State University, Long Beach

Respondent: Paul Mongeau, Arizona State University

4513 COMPETITIVE PAPERS IN PERFORMANCE STUDIES II

3:35-4:50pm, Monday, February 20

Whitewater

Presented by the Performance Studies Interest Group

Chair: Kurt Lindemann, Arizona State University

Boxes: Exploring Identity through Intertextual Performance

Desiree D. Rowe, Arizona State University

Performative Writing, Dada, and Everyday Life

Rod Metts, California State University, San Bernardino

Native Narratives and Technology: Voice and Commercialism through Knott's Mystery Lodge

Mark Dorrrough, Orange Coast College

Taking Play Seriously

D. Robert DeChaine, California State University, Los Angeles

Respondent: Kurt Lindemann, Arizona State University

4514 PROGRAM PLANNERS MEETING 2007

3:35-4:45 pm, Monday, February 20

Palm Suite Sago (5123)

4601 COMMUNICATION VIRGINS: WAS THE FIRST TIME GOOD FOR YOU?

5:00-6:15pm, Monday, February 20

Snow Creek

Presented by the Community College Interest Group

Community college faculty play an important role in introducing and defining the communication discipline to a wide variety of students. The introductory course is both diverse and challenging across our campuses. Panelists will discuss the best content and approaches to introductory courses.

Chair: Mary O. Wiemann, Santa Barbara City College

Up front: Adapting the public speaking course to support student college success

Tasha Van Horn, Citrus College

An effective mixer: Survey courses give the most complete first-time experience

Sarah Hock, Santa Barbara City College

Plays well with others: The importance of interpersonal communication as the first communication course

Christina Harrell, Grossmont College

Playing the field: The hybrid course provides the most traditional and useful first-time view of the discipline

Mary O. Wiemann, Santa Barbara City College

4602 CHERISHING OUR TIME TOGETHER A LESSON IN TEACHING AND PRACTICING INTER-CULTURAL LISTENING

5:00-6:15pm, Monday, February 20

Mesquite D

Presented by the Elementary-Secondary Interest Group

Chair: Nancy Oft Rose, Eugene, Oregon, Retired

Cherishing Our Time Together A Lesson In Teaching and Practicing Inter-Cultural Listening

Melissa L. Beall, University of Northern Iowa

Pamela Cooper, University of South Carolina at Beaufort

4603 “THIS IS AN ISSUE THAT IS CERTAINLY TOPICAL”: SINCLAIR BROADCAST GROUP, JOHN KERRY, AND THE SWIFT BOAT VETERANS

5:00-6:15pm, Monday, February 20

Mesquite A

Presented by the Media Studies Interest Group and the Freedom of Expression and Legal Communication Interest Group

Chair: Suzanne Larson, Southern Utah University

Sinclair and the Swift Boat Veterans: First Amendment Implications

Nick Burnett, California State University, Sacramento

Media v. Media: Sinclair Broadcast Group, Agenda Setting, and Corporate Advocacy

Terry Filipowicz, California State University, Sacramento

Cruel Intentions: Analysis of Sinclair Broadcasting

Christina M. Kopinski, Miami Dade College, Wolfson Campus

Respondent: Suzanne Larson, Southern Utah University

4604 EXPLORING IDENTITY: INVESTIGATIONS INTO SOCIAL RESPONSIBILITY, DISCURSIVE IDENTITY, AND COLLECTIVE ACTION

5:00-6:15pm, Monday, February 20

Whitewater

Presented by: Communication Theory Interest Group

Chair: Melissa L. Curtin, University of New Mexico

Narratives of Social Identity: The Effect on Participation in Collective Action

Michael Coffman, University of Arizona

Jake Harwood, University of Arizona

Tell Me About Yourself: Exploring Communication and the Self Through a Model for Discursive Identity

Kendra D. Rivera, San Diego State University

A Theoretical Basis for Linking Social Responsibility and Helping

Mary H. DeCamp, University of Arizona

Respondent: Eve-Anne M. Doohan, University of San Francisco

4605 DISCOURSE THEORY, METHOD AND PRACTICE: DEFINING OURSELVES, UNDERSTANDING OTHERS AND BUILDING OUR COMMUNITIES

5:00-6:15pm, Monday, February 20

Mesquite C

Presented by the Organizational Communication Interest Group

Chair: Jennifer L. Heckman, University of Southern California

The Discursive Organization of Risk and Safety: How Firefighters Define and Appraise Occupational Hazards

Clifton Scott, University of North Carolina, Charlotte

Angela Trethewey, Arizona State University

Wresting and Arresting Sense in Academe: The Evolution of Women's discursive Structures

Alana Nicastro, Westmont College

Patricia Geist Martin, San Diego State University

Evolving Faster Intervention Via Strategic Organizational Networking: A Multi-Theory, Multi-Level, and Multi-Method Approach to Sex Trafficking in the United States

Bettina M. Heiss, University of Southern California

Employee Involvement in Community Relations: A Case Study of a National Laboratory

Yunna Rhee, California State University, Sacramento

Reviving Blue Heaven: Building Community via Communication

Mary Elizabeth Wilson, La Sierra University

Respondent: Kirsten Broadfoot, Colorado State University

4606 ENGAGING ORGANIZATIONAL COMMUNICATION
SCHOLARSHIP II: USING COMMUNITY AND ORGANIZATIONAL
ENGAGEMENTS TO INFORM AND TRANSFORM SCHOLARSHIP

5:00-6:15pm, Monday, February 20

Grand Ballroom East

Presented by the Organizational Communication Interest Group

This session is the continuation of the Engaging Organizational Communication
Scholarship roundtable and focuses on the importance of reflexivity between
engaged scholarship and practice.

Chair: Jennifer Lyn Simpson, University of Colorado at Boulder

Panelists:

Joann Keyton, University of Kansas

Amanda M. Gunn, Denison University

Christina M. Bates, Arizona State University

Robert Krizek, Saint Louis University

4607 FULL SERVICE FORENSICS PROGRAMS: STRENGTH VIA
DIVERSITY

9:25-10:40am, Tuesday, February 21

Mesquite C

Presented by the Western Forensics Association

Chair: Ryan Smith, California State University, Long Beach

Full Service Programs: A Historical Perspective

Ryan Smith, California State University, Long Beach

Community College Full Service Programs

Jared Miller, California State University, Long Beach

Full Spectrum Programs from an Interpersonal Perspective: Dysfunctional
verses Functional Families

Joseph DeSantis, California State University, Long Beach

Full-Service Programs: Effects on Individual Events

Andrea D. Thorson, California State University, Long Beach

A Community of Coaches: A Reader-Response Approach to Coaching on a
Full-Service Program

Robert Mejia, California State University, Long Beach

Respondent: Joseph Anderson, University of Utah

4608 MATERNAL MATTERS: ANALYZING CONTEMPORARY
DISCOURSES ON MOTHERHOOD

5:00-6:15pm, Monday, February 20

Oleander III

Presented by the Organization for Research on Women and Communication

Participants will examine diverse conceptual and theoretical perspectives on questions of maternity in contemporary discourses on motherhood.

Chair: D. Lynn O'Brien Hallstein, Boston University

Rhetorical Conceptions: How we talk about Birth

Suzanne Daughton, Southern Illinois University, Carbondale

Conceiving the Future: How Public Discourses Impacts Private Desires of the 'Not-Yet-Pregnant'

Elissa Foster, San Jose State University

The March for Women's Lives: Rearticulating Key Ideographs in the Abortion Debate

Sara Hayden, University of Montana

Conceiving Intensive Mothering: Rhetorical Effects of contradictory

Constructions of Mothering at Work in *The Mommy Myth* and *Maternal Desire*

D. Lynn O'Brien Hallstein, Boston University

Respondent: Cindy Griffin, Colorado State University

4609 APOLOGIA OR THE LACK THEREOF: CRITICAL SITUATIONS IN FOREIGN POLICY

5:00-6:15pm, Monday, February 20

Oleander I

Presented by the Rhetoric & Public Address Interest Group

Chair: Harry Sharp, Jr., California Polytechnic State University, San Luis Obispo

Antapologia in the 2001 Spy Plane Incident

Kevin Stein, Southern Utah University.

Self- Defense and the Indefensible: *Apologia*, Condoleezza Rice and 9/11

Karin Tidgewell, University of Nevada, Las Vegas

War Hero or Warning to Women? The Rhetorical Construction of the Jessica Lynch Story

Virginia Sanprie, University of Colorado, Boulder

Valerie Renegar, San Diego State University

Respondent: G. Mitchell Reyes, California State University, Long Beach

4610 HONORING PHILIP C. WANDER: CHERISHING FOUR DECADES OF TEACHING AND SCHOLARSHIP IN RHETORICAL STUDIES

See 4510 for a description and panel listing.

5:00-6:15pm, Monday, February 20

Mesquite B

4611 CONTEST AND COMMUNICATION: INTERCULTURAL CONTEXTS

5:00-6:15pm, Monday, February 20

Grand Ballroom Center

Presented by the Intercultural Communication Interest Group

Chair: Charmaine I. Kaimikau, Cypress College

Being Japanese: Racial Ideologies of Japanese Sojourners in the United States

Sayuri Arai, University of New Mexico

Ideal Facilitator Characteristics: A Comparative Analysis of the Role of Facilitator in U.S.-American and Chinese Contexts

Sundae R. Bean, Arizona State University

Yue Ma, Arizona State University

B. Dale Peacock, Arizona State University

Cynthia A. Reed, Arizona State University

Ping Yang, Arizona State University

Competing Memories Within the Ideal Speech Situation: A Cross-Cultural Analysis of Hiroshima Memories

Christina Colp-Hansbury, Arizona State University

Mi Casa, Your Playground: Implications of Host-Guest Interactions in Intercultural Tourism

Sundae R. Bean, Arizona State University

Respondent: David Zuckerman, California State University, Sacramento

4612 SEX DIFFERENCES VERSUS SIMILARITIES IN INTERPERSONAL COMMUNICATION

5:00-6:15pm, Monday, February 20

VIP Room

Presented by the Interpersonal Communication Interest Group

Chair: Daniel J. Canary, Arizona State University

Sex Differences in Emotional Communication.

Laura K. Guerrero, Arizona State University

Susanne M. Jones, University of Minnesota

Renee Reiter Boburka, East Stroudsburg University

Sex Differences in the Transition to a Heterosexual Romantic Relationship.

Paul A. Mongeau, Arizona State University

Mary Claire Morr Serewicz, University of Denver,

Mary Lynn Miller Henningsen, Northern Illinois University

Kristin Leigh Davis, Arizona State University

Sex Differences in Presenting and Detecting Deceptive Messages.

Judee K. Burgoon, University of Arizona

J. P. Blair, University of Texas at San Antonio

David B. Buller, Cooper Institute

Patti Tilley, Florida State University
Do Women Work Harder than Men at Maintaining Relationships?
Daniel J. Canary, Arizona State University
Jodi Wahba, Arizona State University
Sex, Power and Communication
Pamela J. Kalbfleisch, University of North Dakota
Anita L. Herold, University of North Dakota

4613 CHERISHING COMPASSION AND COMMITMENT THROUGH
PERFORMANCES OF RESISTANCE
5:00-6:15pm, Monday, February 20 Mediterranean
Presented by the Performance Studies Interest Group

Chair: Linda M. Park-Fuller, Arizona State University
Variations of a Bloodline
Kirt Shineman, Glendale Community College
30 seconds

Scott Ku, Arizona State University
This Is Not Banging the Bishop: The Performance of X-Communication
Dustin Bradley Goltz, Arizona State University
Empowerment and Oppression in The Vagina Monologues
Kimberly A. Ware, Arizona State University
From the Gutter to the Stars: The Incremental Embodiment of Transsexual Gay
Male Identity
E. Tristan Booth, Arizona State University

Respondent: Mercilee Jenkins, San Francisco State University

4701 PROGRAM PLANNERS MEETING 2007
** moved to an earlier time see 4514

4702 FUTURES COMMITTEE
5:15-6:15pm, Monday, February 20 Palm Suite Date (5109)

4703 EXECUTIVES CLUB BUSINESS MEETING
5:15-6:15pm, Monday, February 20 Palm Suite Fan (5113)

4801 LEGISLATIVE ASSEMBLY
6:30-8:00pm, Monday, February 20 Grand Ballroom West

4901 PRESIDENT'S RECEPTION
9:00-11:00pm, Monday, February 20 Mediterranean

Tuesday, February 21

5101 PUTTING THEORY INTO PRACTICE: TAKING STOCK OF AND SETTING THE AGENDA FOR APPLIED COMMUNICATION SCHOLARSHIP

8:00-9:15am, Tuesday, February 21

VIP Room

Presented by the Communication Theory Interest Group

Presentations on this panel are given by the authors of chapters from the forthcoming *Handbook of Applied Communication*.

Chair: Lawrence R. Frey, University of Colorado, Boulder

How the Idea of Applied Communication Research Developed

William F. Eadie, San Diego State University

Ethnography in Applied Communication Research

Laura L. Ellingson, Santa Clara University

Media Technologies In/As Applied Communication Research

Leah Lievrouw, University of California, Los Angeles

Applied Communication Research in Organizations

David R. Seibold, University of California, Santa Barbara

Daisy R. Lemus, California State University, Northridge

Dawna I. Ballard, University of Texas at Austin

Karen K. Myers, Purdue University

Applied Communication Research in Educational Contexts

Ann L. Darling, University of Utah

Liz Leckie, University of Utah

5102 ORGANIZATIONAL IDENTIFICATION AND SELF IDENTITY: PROCESSES OF SOCIALIZATION AND DIALECTICAL TENSIONS

8:00-9:15am, Tuesday, February 21

Celebrity Room

Presented by the Organizational Communication Interest Group

Chair: Renee Houston, University of Puget Sound

Exploring the Intersection of Organizational Identity and Narratives in

Alcoholics Anonymous

James Hedges, University of Utah

Learning to Care and Not Cure

Tia Kaye Newby, California State University, Chico

Susan Avanzino, California State University, Chico

The Jesuit Difference (?): Tensions of Negotiating Spiritual Values and Secular Practices

Erika L. Kirby, Creighton University

Sherianne Shuler, Creighton University

M. Chad McBride, Creighton University
Marty J. Birkholt, Creighton University
Mary Ann Danielson, Creighton University
Donna R. Pawloski, Creighton University

Helping the Helping Hand: The Struggles Workers and Volunteers Face while Working with Domestic Violence Victims

Nurhayat Bilge, Arizona State University

Unintended Consequences and the Management of Structure: Emotional Labor in the In-Home Daycare Context

Jennifer A. Butler, Northern Kentucky University

Daniel P. Modaff, Ohio University

Respondent: Thomas G. Endres, University of Northern Colorado

5103 CROSSING BOUNDARIES

8:00-9:15am, Tuesday, February 21

Mesquite A

Presented by the Media Studies Interest Group

Chair: Christina Foust, Denver University

Ice After Janet: Moral Cooling and Super Bowl Commercials

Lawrence Wenner, Loyola Marymount

Simulacra and Simulation: A Baudrillardian Analysis of Video Games From a Post Modern Perspective

Jonathan Matusitz, University of Oklahoma

Al Kawthar's Voice: Realigning the Zone of Speakable in Cyberspace

Naidi Zukic, Southern Illinois University

Awash in the Border(les): Elision, the Mediated Multitude and the Global Aesthetics of Disappearance

Marc Leverette, Colorado State University

Respondent: Peter Ehrenhaus, Pacific Lutheran University

5104 POPULAR TREATMENTS FOR FEMALE BODIES

8:00-9:15am, Tuesday, February 21

Mesquite B

Presented by the Organization for Research on Women and Communication

Contemporary images of female bodies offer stylized forms that, if accepted, have troubling consequences for women. They shift the focus from unspoken realities associated with being female and restrain the practical choices women make with regard to their health and bodies. By exploring the discourses about women and depression, diet, and menstrual products, this panel investigates the challenges females face when encountering constructs of bodies in social settings. We propose that many aspects of health and bodies exist in an

unexamined realm of banality, urging people to accept limited conceptions of bodies.

Chair: Karen McCullough, Pennsylvania State University

Participants: Samantha Senda-Cook, Colorado State University
Nicole Hurt, Colorado State University
Keli Larson Flewell, Colorado State University

Respondent: Lisa Keranen, University of Colorado

5105 COMMUNICATING HOPE IN COMMUNITY ORGANIZATIONS AND SERVICE LEARNING

8:00-9:15am, Tuesday, February 21

Mesquite C

Presented by the Organizational Communication Interest Group

This panel discusses a model of service learning for teaching organizational communication assessment and presents findings of team field research. The pedagogical approach is experiential and rooted in reflection on vocation as calling. Research design focused on studying practices of hope in community organizations that offer resources to pregnant mothers and the retarded.

Chair: Juanie N. Walker, Pepperdine University

Panelists:

Lisa Steepleton, Pepperdine University

Jennifer Akamine, Pepperdine University

Selin Karli, Pepperdine University

Emily Keith, Westside Pregnancy Resource Center, Santa Monica, CA

Sara Lindgren, Westside Pregnancy Resource Center, Santa Monica, CA

Jennifer Roberts, Pepperdine University

Laura Lemon, Pepperdine University

John Mudgett, Pepperdine University

Kelley Valencia, New Horizons, San Fernando Valley Association for the Retarded, Inc. North Hills, CA

Respondent: Diane Witmer, California State University, Fullerton

5106 DEMYSTIFYING THE QUEER EXPERIENCE WITH PANELS OF LESBIAN, GAY, BISEXUAL, AND TRANSGENDER PEOPLE IN THE CLASSROOM

8:00-9:15am, Tuesday, February 21

Mesquite D

Presented by the Communication and Instruction Interest Group

Chair: Daren C. Brabham, University of Utah

Panelists: Daren C. Brabham, University of Utah
Doris Dirks, Western Michigan University
Charles Milne, University of Utah
Teresa Perales, San Jose State University
Ronni Sanlo, University of California, Los Angeles
Shaun Travers, University of California, San Diego

5107 FACES AND FACETS OF TERRORISM: LOOKING FROM
DIFFERENT VANTAGE POINTS

8:00-9:15am, Tuesday, February 21

Oleander I

Presented by the Rhetoric & Public Address Interest Group

Chair: D. Robert DeChaine, California State University, Los Angeles

We Shall Overcome: Fantasy Themes and the Rhetorical Vision of the War on
Terror

Richard Jones, Jr., University of Denver

Public Discourse, Deliberation, and History: The Forgotten Face of Saddam
Hussein

James Campbell Bunker, University of Utah

Philip C. Wander, San Jose State University

Terrorism in the Hands of Justice: A Fantasy-Theme Critique of an Iraqi Reality
Television Show

Jason Tashea, Linfield College

Respondent: Kevin J. Ayotte, California State University, Fresno

5108 THEORIZING IDENTITIES IN INTERCULTURAL
COMMUNICATION

8:00-9:15am, Tuesday, February 21

Oleander II

Presented by the Intercultural Communication Interest Group

Chair: Rona T. Halualani, San Jose State University

Collaborative Theorizing, There Isn't *One*: Intersectional Articulation and the
Identity Carnival

Archana J. Bhatt, University of Richmond

Julia R. Johnson, University of Rhode Island

Tracey O. Patton, The University of Wyoming

(Re)Constructing Asian American Identity: An Autoethnographic Exploration
of Problematic Issues

Scott Ku, Arizona State University

Identity Formation in Vietnamese Adoptees of Operation Babylift: An Exploratory Study in Intercultural Communication

Robert L. Ballard, University of Denver

Interweaving History and Ideology: Experiences of Vietnamese Identity

Jennifer Huynh Thi Anh Morrison, University of Denver

Respondent: Karen Lovaas, San Francisco State University

5109 RELATIONAL CONTEXTS: FRIENDS, FAMILIES, AND SOCIETY

8:00-9:15am, Tuesday, February 21

Oleander III

Presented by the Interpersonal Communication Interest Group

Chair: Robin Heaton, University of Utah

Between Friends: Correlations between Gossip, Bonding & Relationship Maintenance

Bree McEwan, Arizona State University

A Cultural Examination of Adult Siblings Use of Social Support

Alan C. Mikkelson, Arizona State University

Jonathon Bowman, Boston College

Competition, Cooperation, and Femininity: An Exploratory Examination of Current Perspectives on Women in Sports

Mike Masowich, Baylor University

Mark T. Morman, Baylor University

Do Elements of Emotional Competence Relate To Marital Satisfaction?

Linda M. Carvalho Cooley, California State University, Fresno

Respondent: Guy Foster Bachman, California State University, Long Beach

5201 EXECUTIVE COUNCIL

9:00-11:30AM, Tuesday, February 21

Boardroom

5301 WHEN THE SPIRIT MOVES US: EXPERIENCES AND EXPRESSIONS OF SPIRITUALITY IN HEALTH CARE

9:25-10:40am, Tuesday, February 21

VIP Room

Presented by the Health Communication Interest Group

Chair: Jennifer Burke, Prairie View A&M University

Reiki as Performance: Communication, Healing, and Touch

Jay Baglia, San Jose State University

Patients' Inclusion of Spirituality within the Comprehensive Geriatric Assessment Process

Laura L. Ellingson, Santa Clara University

Spiritual Care in Hospice: Striking a Balance between Autonomy and Support

Elissa Foster, San Jose State University

The Spiritual Enchantment of Health

Patricia Geist-Martin, San Diego State University

Physician-Patient Relationships: Creating a New Theoretical Model for Improved Medical Interactions

Kris Kirschbaum, University of New Mexico

Respondent: Scott T. Paynton, Humboldt State University

5302 PLACES OF MEMORY: REMEMBERING MODERNITY'S VIOLENCE

9:25-10:40am, Tuesday, February 21

Celebrity Room

Presented by the Rhetoric and Public Address Interest Group

Memory and place are deeply connected. As Francis Yates and others detail, early rhetorical theory and pedagogy utilized architectural mnemonics to store crucial cultural information in the memory. Renaissance architects drew on these rhetorically tinged theories of memory in their creation of public and private spaces. Within modernity and postmodernity, rhetorical memories remain deeply connected to space. This panel attends to the specific ways space figures memory and memory figures space. As a group, we will make the argument that spatially coded memories are particular powerful modes for engaging audiences, and in particular, engaging audiences on topics of violence and oppression. These essays argue for the importance of understanding the emplacement of memory and, at the same time, suggest the centrality of violence to our collective memories of modernity.

Chair: Greg Dickinson, Colorado State University

The Embodiment of Space: Negotiating Holocaust Memory at the Jewish Museum Berlin

Kerri Moncrieff, Colorado State University

Space, Architecture, and Resistance at the National Civil Rights Museum's Expansion Project

Bernard Armada, University of St. Thomas

Radioactive History: Nuclear Museums in the Post-Cold War Era

Bryan C. Taylor, University of Colorado, Boulder

Domestication, Sterility, and Phallic Fetish at the Cody Firearms Museum

Eric Aoki, Colorado State University

Greg Dickinson, Colorado State University

Brian L. Ott, Colorado State University

5303 MEDIATED RHETORICS OF AMBIVALENCE: STUDIES IN CULTURAL CONTRADICTION AND HEGEMONY

9:25-10:40am, Tuesday, February 21

Mesquite A

Presented by the Media Studies Interest Group

Chair: Peter Ehrenhaus, Pacific Lutheran University

The Rhetorical Quality of Ambivalence: The Case of Women in Combat

A. Susan Owen, University of Puget Sound

Loving the Sinner: Christian Ambivalence Towards Human Rights in Alamo-land

Harry Haines, Trinity University

Commemorating the Obscene: Race Lynching and Gestures of Reconciliation

Peter Ehrenhaus, Pacific Lutheran University

War, Moral Outrage and Ambivalent Criticism

Philip Wander, California State University, San Jose

5304 ENACTING THE GODDESS: RE-DEFINING POWER AS FEMININE IN WOMEN'S LIVED EXPERIENCES

9:25-10:40am, Tuesday, February 21

Mesquite B

Presented by the Organization for Research on Women and Communication

Conceptualizing femininity as empowering and liberating, without constant comparisons to masculine and patriarchal understandings of empowerment, is one of the most argued issues in feminist and academic circles today. This panel argues that in many different circumstances women are enacting femininity and ideas associated with femininity as forms of empowerment. The panelists combine rhetorical, organizational, and textual analyses of femininity in various sites to create new definitions of femininity and feminine practices and to re-conceptualize the notion of "power" itself.

Chair: Nina Lozano-Reich, Loyola Marymount University

Empowered Goddesses: Constructing Femininity as Power

Victoria Ann Newsom, Loyola Marymount University

Toniesha L. Taylor, California State University, San Marcos

Shameless Goddesses: The Female Body and Feminine Potential in the Aesthetic Realm

Michele L. Hammers, Loyola Marymount University

Enduring Goddesses: African American Mothers as a Feminine Lineage of Survival

Eileen Pippin, San Francisco State University

Natural Goddesses: Midwifery Practices as Female Empowerment

Paige P. Edley, Loyola Marymount University

Renee Houston, University of Puget Sound
Caitlyn Quander, University of Puget Sound
Visual Goddesses: Playboy as a Means of Celebrating Feminine Sexuality
Miriam Putnam, California State University, Northridge

Respondent: Nina Lozano-Reich, Loyola Marymount University

5305 THE STATUS OF DIVERSITY IN FORENSICS: IDEOLOGICAL,
RELIGIOUS AND ECONOMIC BARRIERS TO FORENSICS
5:00-6:15pm, Monday, February 20 Celebrity Room
Presented by the Western Forensics Association

Chair: Diana Martinez, Syracuse University

Ideological Polarization on Forensics Teams: Silencing Dissent
Tony Damico, California State University, Long Beach
Religious Diversity in Forensics: The Problem of Conscious and Unconscious
Exclusion

Usama Kahf, California State University, Long Beach
Diversity Check: Are we Suffering from Groupthink?

Courtney Anderson, California State University, Long Beach
Privilege and Classism: Can Speech ever really be Free?

Joseph DeSantis, California State University, Long Beach
There's No Crying in Debate: Sexuality, Race, and Power in Academic Debate
Nicholas Russell, California State University, Long Beach

5306 TEACHING (AND LEARNING) COMMUNICATION IN CHINA
9:25-10:40am, Tuesday, February 21 Mesquite D
Presented by the Communication and Instruction Interest Group

Chair: Susan Hafen, Weber State University

Panelists: Susan Hafen, Weber State University
Laura Anderson, Weber State University
Phil Backlund, Central Washington University
Margaret Miller Butcher, Fort Hays State University
Peter DeCaro, California State University–Stanislaus
Jensen Chung, San Francisco State University
A. J. Baltes, Prairie View A&M University
Kit Lam, University of Iowa
Suzan Sims-Fletcher, Boston University

5307 CHANGING THE VIEW FROM A ROOM OF ONE'S OWN:
RHETORICAL CONSTRUCTIONS OF 'WOMAN' IN TRANSITIONAL
TIMES

9:25-10:40am, Tuesday, February 21

Oleander I

Presented by the Rhetoric & Public Address Interest Group

Chair: Tracey Quigley, University of San Diego

Mediated Representations of Social Movements: *Practical Magic*, Witchcraft
and Commodity Feminism

Julie Kalil Schutten, University of Utah

The Invisible Woman: A Rhetorical Study of the U.S. Supreme Court Abortion
Decisions

Katie Gibson, California State University, Long Beach

Managing Visibility: The Use of Personal Narrative by FTM Social Movement
Leaders

E. Tristan Booth, Arizona State University

Respondent: Neil Patten, Ferris State University

5308 NORMS AND FANTASIES, QUESTS AND PROMISES:
THEORIZING INTERCULTURAL COMMUNICATION AND
GLOBALIZATION

9:25-10:40am, Tuesday, February 21

Oleander II

Presented by the Intercultural Communication Interest Group

Chair: Charmaine I. Kaimikaua, Cypress College

The Tour Guidebook: A Rhetorical Text Prescribing the Norms of Tourism and
Intercultural Contact

Cynthia Reed, Arizona State University

Choose Your Own Adventure: Quest-ioneing the Fantasies of Intercultural
Research

Karma R. Chavez, Arizona State University

Sara L. McKinnon, Arizona State University

Global Social Justice and Inter/cultural Communication: Theorizing from the
"Beyond"

Alexa Dare, University of Montana

Promise and Predicament: Local Speaking Back in Globalization

Trine Kvidal, University of Utah

Respondent: Keith P. Berry, University of Wisconsin, Superior

5309 RELATIONAL SUPPORTS AND STRESSORS

9:25-10:40am, Tuesday, February 21

Oleander III

Presented by the Interpersonal Communication Interest Group

Chair: Cristina Pieratt, California State University Long Beach

A Thematic Analysis of Communication Advice Offered by Popular Self-Help Books

Norah E. Dunbar, California State University Long Beach

Kristine Clancy, Purdue University

Amanda Coho, Pennsylvania State University

Jennifer Graham, California State University Long Beach

Michael Middleton, California State University Long Beach

Raven Pfister, Purdue University

Kaci Sewell, California State University Long Beach

Biological Sex Differences in Usage of Partner Jealousy Expression Types and Responses to Partner Jealousy Expression from the Perspective of the Jealous Target

Jennifer L. Bevan, University of Nevada, Las Vegas

Karin D. Tidgewell, University of Nevada, Las Vegas

Indu Agarwal, University of Nevada, Las Vegas

Karissa C. Barkdull, University of Nevada, Las Vegas

Jasmine S. Crighton, University of Nevada, Las Vegas

Meredith Hartstern, University of Nevada, Las Vegas

Lynn Hayase, University of Nevada, Las Vegas

Tracilee Hoffman, University of Nevada, Las Vegas

Domina Holbeck, University of Nevada, Las Vegas

Ji Hoon Lee, University of Nevada, Las Vegas

Sarah E. Morton, University of Nevada, Las Vegas

Dawn E. Nicol, University of Nevada, Las Vegas

Shayler K. White, University of Nevada, Las Vegas

Human Affection Exchange: XIV. Relational Affection Predicts Resting Heart Rate and Free Cortisol Secretion during Acute Stress

Kory Floyd, Arizona State University

Alan C. Mikkelson, Whitworth College

Melissa A. Tafoya, Arizona State University

Lisa Farinelli, Arizona State University

Angela G. La Valley, Arizona State University

Jeff Judd, Arizona State University

Kristin L. Davis, Arizona State University

Mark T. Haynes, Arizona State University

Jason Wilson, Arizona State University

The Underbenefitted Wife and the Overbenefitted Husband: A Multi-Theoretical Perspective on Equity Differentiation in Marriages

Amanda Dawn Coho, Pennsylvania State University

Respondent: Brian Heisterkamp, California State University San Bernardino

5401 CONSTRUCTING THE SOCIAL WORLD: IDENTITIES AND GOALS IN INTERACTION

10:50am-12:05pm, Tuesday, February 21

VIP Room

Presented by Language and Social Interaction

Chair: Leah Wingard, University of California, Los Angeles

‘Think about It, Have Anxiety over It, and Guard against It, or You Might Die’:
An Analysis of Sexual-Infidelity Self-Help Websites

Tony Docan, University of Washington/Los Angeles Pierce College

Toward an Understanding of Humor Identity

Billy Fallon, San Diego State University

Differentiating Membership Categories in the Talk of Gay and Lesbian Couples

Brian L. Heisterkamp, California State University, San Bernardino

When Communication Goals Backfire: The Ideographic Misconstruction of
Iraqi *Freedom*

Matthew D. Petrunia, University of New Mexico

5402 REPRESENTING CONTROVERSY

10:50am-12:05pm, Tuesday, February 21

Celebrity Room

Presented by the Media Studies Interest Group

Chair: Susan Brockus, California State University, Chico

Security Mom: From Gun-Toting Vigilante to Candle Lighting Vigil

Michelle Rodino Colocino, University of Cincinnati

A Comparison of News Coverage of the 1999 Columbine High School and 2005
Red Lake High School Shootings *Debut Paper

Daren C. Brabham, University of Utah

One Tragedy, Two Ways of Framing: The Beslan Coverage in *The New York
Times* and *Izvestia* *Debut Paper

Olga Zaytseva, California State University, San Francisco

Testifying or Reporting? The Construction of Rwandan Women’s Rape
Narratives

Sarah Stone Watt, The Pennsylvania State University

Respondent: Arne G’Schwind, Regis University

5403 REPRESENTATIONS OF RACE, CLASS, AND GENDER IN CONTEMPORARY TELEVISION ADVERTISEMENTS: READING BEYOND STEREOTYPES

10:50am-12:05pm, Tuesday, February 21

Mesquite A

Presented by the Media Studies Interest Group

Panelists will review and discuss depictions of race, class, and gender in specific contemporary television commercials. Audience members are encouraged to join in the analysis of these ubiquitous cultural artifacts.

Chair: Mary L. Kahl, State University of New York, New Paltz

Panelists:

Teresa Bergman, California State University, Chico
Heather Hundley, California State University, San Bernardino
Mary Kahl, State University of New York, New Paltz
A. Susan Owen, University of Puget Sound
Anne Pym, California State University, East Bay

5404 COURSES IN GENDER AND COMMUNICATION: SHARING RESOURCES

10:50am-12:05pm, Tuesday, February 21

Mesquite B

Presented by the Organization for Research on Women and Communication

This program is designed to facilitate sharing of resources about courses in gender and communication. Much has changed since the development of such courses in the early days of the second wave of feminism. There are more theoretical perspectives available, the amount of resources has multiplied exponentially, and students are often very willing to engage these issues of highly resistant to them. The session will consist of small groups where participants will have the opportunity to share syllabi, resources, questions, and challenges. If you have taught a gender and communication course, please bring to the session 20 copies of your course syllabus.

Chair: Karen A. Foss, University of New Mexico

Participants: Karen A. Foss, University of New Mexico
Sonja K. Foss, University of Colorado, Denver & Health Sciences Center
Janet Cramer, University of New Mexico
Laura Hahn, Humboldt State University

5405 AN ORGANIZATIONAL COMMUNICATION RESEARCH SAMPLER

10:50am-12:05pm, Tuesday, February 21

Mesquite C

Presented by the Organizational Communication Interest Group

Chair: Juanie Walker, Pepperdine University

Subordinate Impression Management Tactics: Leader-Member Exchange and Workholism Dimensions in the Performance Appraisal Interview

Kevin G. Lamude, California State University, San Bernardino

Joseph Scudder, Northern Illinois University

Donna Simmons, California State University, Bakesfiled

Nabil Razzouk, California State University, San Bernardino

Work-Family Balance in Popular Press: Representations of Masculinity Related to Work-Life Balance in *The Nanny Diaries*

Elizabeth Richard, Arizona State University

Seating Arrangement vs. Sex as Leadership Cues: Testing the "Think-Leader, Think-Male" Heuristic

Danielle Jackson, University of Nevada, Las Vegas

Erika Engstrom, University of Nevada, Las Vegas

"I Serve at the Pleasure of the President": *The West Wing* as an Example of Workplace Friendship and the Pelz Effect in a High-Stress Organization

Laura Beth Dawes, Auburn University

Respondent: Deborah Dunn, Westmont College

5406 COLD CALLING IN DISCUSSION TEACHING: AN ANALYSIS OF STUDENT PARTICIPATION AND COMFORT

10:50am-12:05pm, Tuesday, February 21

Mesquite D

Presented by the Communication and Instruction Interest Group

Chair: Ann Q. Staton, Texas Women's University

The Influence of Cold Calling on Effective Classroom Discussion: An Analysis of Student Participation and Comfort in the Gender and Communication Classroom

Tasha J. Souza, Humboldt State University

The Influence of Cold Calling on Effective Classroom Discussion: An Analysis of Student Participation and Comfort in the Organizational Communication Classroom

Elise J. Dallimore, Northeastern University

The Influence of Cold Calling on Effective Classroom Discussion: An Analysis of Student Participation and Comfort in the Cultural Communication Classroom
Eric Aoki, Colorado State University

The Influence of Cold Calling on Effective Classroom Discussion: An Analysis of Student Participation and Comfort in the Public Speaking Classroom
Brian Pilling, Westminster College (affiliation: University of Utah)

5407 RHETORICAL STRATEGIES OF COUNTER-MEMORY

10:50am-12:05pm, Tuesday, February 21

Oleander I

Presented by the Rhetoric & Public Address Interest Group

Chair/Facilitator: Ann Johnson, California State University, Long Beach

Counter-Memory, Reflexivity, and Cultural Amnesia

G. Mitchell Reyes, California State University, Long Beach

Remembrance, Reclamation, and Redemption: The Place of Memory in Walter Mosley's The Man in My Basement

Kendall R. Phillips, Syracuse University

Catherine Thomas, Syracuse University

Re-membering Eichmann

David Schulz, California State University, Stanislaus

An Analysis of the UDC's Mythic Memories in Their Catechisms for Children

Amy L. Heyse, California State University, Long Beach

History as Setting and Aesthetic

Ann M. Johnson, California State University, Long Beach

Respondent: Sharon D. Downey, California State University, Long Beach

5408 CULTURE AND COMMUNICATION: IMPLICATIONS FOR PEDAGOGY

10:50am-12:05pm, Tuesday, February 21

Oleander II

Presented by the Intercultural Communication Interest Group

Chair: Deanna L. Fassett, San Jose State University

Race and Resistance in the Communication Classroom

Paul Mason Fotsch, California State University, Northridge

Co-Cultured Language in Education: A Personal Perspective

Chad Perry, University of New Mexico

E-Learning: Moving Past Justification to Communication and Connectivity

Lisa A. Stefani, Arizona State University

Itsuo Shirono, Meikai University, Japan

The History Keeper: "I Got to Thinking...Wait a Minute...I'm a White"

Kate Willink, University of Waterloo

Respondent: Keith Nainby, San Jose State University

5409 CHERISHING TIME: CREATIVE AGING COMMUNICATION

10:50am-12:05pm, Tuesday, February 21

Oleander III

Presented by the Interpersonal Communication Interest Group

The conference theme challenges communication scholars and practitioners to explore the notion of time and what we do with it. As the moments of our lives tick away, how do we account for the ways we have lived them? Are we cherishing our existence on the planet and leaving it better by our commitments to each other, our fellowship of the mind and heart? This panel addresses the idea of conscious, creative decision-making as we evolve through the decades of our duration together. Composing messages in accordance with the discursive enactment of time enriches community. Because we possess intellectual gifts, we charge ourselves to communicate stewardship of the environment and justice for each person as we embrace the adventure of maturing, life. Creative aging is life well lived.

Participants: Paige Edley, Loyola Marymount University
Annika Hylmo, Loyola Marymount University
M. J. Robinson, New York University
Suzanne Frentz, Loyola Marymount University

WESTERN STATES COMMUNICATION ASSOCIATION

2007 Annual Convention, Seattle, WA
February 16-20, 2007

CALL

**Competitive Papers, Program Proposals, Workshop Proposals,
Undergraduate Scholars' Research Conference (USRC), and Graduate
Students Workshops & Graduate Programs' Open House**

Promoting Social Justice through our Work

As scholars and teachers of communication, we have multiple opportunities to promote justice in our communities, work places, institutions, and interpersonal relationships. The theme of this year's conference is designed to focus our attention on those opportunities, honoring the good work that we already do and encouraging us to find new ways to use our knowledge and skills to create a more just world.

Sara Hayden, WSCA President-Elect
Primary Program Planner

- I. Competitive Papers (deadline: *received by 9/1/06*)* Submit to interest group
- II. Program Proposal (deadline: *received by 9/1/06*) Submit to interest group
- III. Workshop Proposals (deadline: *received by 9/1/06*) Submit to Hayden
- IV. Undergraduate Scholars' Research Conference (USRC) (deadline: *received by 11/1/06*) Submit to WSCA Second Vice President
- V. Graduate Student Workshops & Graduate Programs' Open House (deadline: *received by 9/1/06*) Submit to WSCA Second Vice President

***Special Note: WSCA program planning uses only one deadline for primary convention papers, programs, workshops, and graduate programs' open house. However, the USRC deadline is unique – November 1, 2006.**

Send all competitive papers and program proposals directly to the appropriate program planner for each interest group. Specific information about submitting to interest groups will be posted on the WSCA website (<http://www.westcomm.org/>) at the completion of the February 2006 conference.

Only workshop proposals should be mailed directly to the program planner Sara Hayden at the Department of Communication, The University of Montana, Missoula, MT 59812.

COMPETITIVE PAPERS

1. Authors are encouraged to submit papers to the interest groups for competitive selection. Papers may include research reports employing any methodology, theoretical developments or critiques, critical analyses, and in some cases, works in progress. Submit each paper to one interest group only.

Competitive papers should not have been presented previously at another conference, be accepted for publication, or have been published.

Special Note: Historically, the Community College and the Elementary and Secondary Education Interest Groups have not sponsored competitive papers. Please contact the interest group planner before submitting a competitive paper to either interest group.

2. Submitted papers should include:

- (a) A detachable title page with title of paper, names of all authors, and their addresses, phone numbers, email addresses, and affiliations. Again, this information should be included for each author and should be double-checked for accuracy.
- (b) A 250-500-word abstract of the paper (with title appearing on this page).
- (c) Typically, a maximum of twenty-five pages of text.
- (d) No information in the paper that identifies the author(s) (beyond that which appears on the title page).

3. Submission: Specific information about submitting to interest groups will be posted on the WSCA website (<http://www.westcomm.org/>) at the completion of the February 2006 conference and printed in the WSCA Newsletter prior to the 2007 conference. Completed papers are submitted directly to the interest group planners, unless the interest group indicates otherwise.

4. Research in Progress: Some interest groups sponsor programs of “Research in Progress.” Papers submitted to these programs should be so designated on the cover page and should not exceed ten pages in length. Be sure that the interest group to which you are planning to send your paper accepts “research in progress” before submitting it.

5. Debut Award: The WSCA Executive Club Debut Award is made to the author of a paper presented at the convention by an author or co-authors “who have not presented a paper at a state, regional, national or international convention, or published in any academic journal.” Papers presented at student-

only conferences are exempt from this requirement. All authors of a co-authored paper must meet these eligibility requirements for a paper to be considered a Debut Paper. **Papers eligible for the Debut Award should be marked “DEBUT” in the upper right-hand corner of the title page.** Please also indicate whether each author is a bachelors, masters, or doctoral student. Some interest groups also sponsor debut programs, but papers need not be presented on a debut panel to be eligible for the Executive Club Debut Award.

6. Five copies of each competitive paper must be **RECEIVED** by the appropriate interest-group planner **NO LATER THAN Friday, September 1, 2005.**

II. PROGRAM PROPOSALS

1. Program proposals should focus on a unifying theme relevant to research, theory, or instruction in the area of the sponsoring interest group. Programs may consist of a chair, individual presenters, and a critic respondent; however round-table discussions, performance venues, or other unique formats are encouraged. In alternative program formats, respondents may be included or omitted as appropriate. Innovative program proposals, especially those that provide opportunities for engaged interaction among participants and attendees, are encouraged. Programs co-sponsored with other interest groups are also welcome.

2. Program proposals should include the following:

- (a) Thematic title of the program
- (b) Names, addresses, phones, e-mail addresses, and affiliations of all participants
- (c) Title and brief description of each presentation
- (d) Equipment needed for the panel

(Note: Equipment availability is extremely limited. See the WSCA Policy on the Use of Audio-Visual Equipment at Conventions.)

3. Five copies of each program proposal must be **RECEIVED** by the appropriate interest-group program planner **NO LATER THAN Friday, September 1, 2005.** Program proposal submissions for those interest groups accepting only electronic proposals also must be received no later than Friday, September 1, 2006. Specific information about submitting to interest groups will be posted on the WSCA website (<http://www.westcomm.org/>) at the completion of the February 2006 conference and printed in the WSCA Newsletter prior to the 2007 conference.

III. WORKSHOP PROPOSALS

1. A workshop is intended as a training or informational short course that can be presented in a three-hour or six-hour time block. A workshop topic may concern the presentation of teaching innovations; an area of research; a new theoretical perspective; the application of a body of knowledge; skill development; or another clearly focused topic. Workshop leaders are encouraged to advertise their workshops and solicit participation.

2. Workshops are scheduled for the first full day of the convention, Saturday, February 17, 2007. Participants pay a modest registration fee. The fee is intended to cover only the direct costs (materials, etc.) incurred in conducting the workshop (see #4 below).

3. Workshops of interest to members of the Western Forensics Association are encouraged and will be programmed on Sunday evening, February 18, 2007, after completion of the WFA tournament.

4. Workshop proposals should include the following:

- (a) Title of the workshop
- (b) Names, full addresses, e-mail addresses, and affiliations of all presenters
- (c) Rationale and goals of the workshop
- (d) Outline and description of workshop activities
- (e) Room size and configuration requested (theater seating, etc.)
- (f) Equipment requirements (Note: Equipment availability is extremely limited. See the WSCA Policy on the Use of Audio-Visual Equipment at Conventions.)
- (g) Maximum enrollment
- (h) Fee amount, set in accordance with WSCA policy (see below)
- (i) Time-block requested (e.g., three hours, six hours)

5. Guide to setting fees for workshop leaders: WSCA has set \$5.00 as the base fee for any workshop. The first \$5.00 of each registrant's fee goes to cover convention costs. The fee above \$5.00 should be set at such a level as to provide reimbursement to the workshop leader(s) only for the cost of materials, equipment, and any out-of-the-ordinary expenses. Costs for equipment rental and costs of producing materials for participants must be covered within the overall fee that you specify. The Association cannot reimburse more money to a workshop leader than it receives from participant fees. **Special Note:** If a part or all of a fee is proposed as covering an individual's expenses or as an honorarium, Sara Hayden must approve it prior to any commitment to the individual.

TWO copies of each workshop proposal should be mailed or sent as an email attachment (saved in MS Word) to Sara Hayden. The proposal must be **RECEIVED NO LATER THAN Friday, September 1, 2006.**

Sara Hayden
Department of Communication Studies
The University of Montana
Missoula, MT 59812
Email: sara.hayden@mso.umt.edu
Telephone: (406) 243-4333

IV. PRECONFERENCE

Suzanne Daughton, Southern Illinois University, and Sarah J. Tracy, Arizona State University, are developing a preconference around the theme “Reframing Our Research for Social Change.” The preconference will be held on **Saturday, February 17, 2007**. Further information is forthcoming. Interested parties are also invited to contact Suzanne Daughton at Department of Speech Communication, Southern Illinois University, MC 6605, Carbondale, IL 62901-6605; (608) 453-1887; Daughton@siu.edu

V. 4th ANNUAL UNDERGRADUATE SCHOLARS’ RESEARCH CONFERENCE

The WSCA Second Vice President solicits submissions for the Undergraduate Scholars’ Research Conference, to be held on Saturday, February 17, 2007. Undergraduates are invited to submit papers reporting original research (i.e., critical investigation, experimentation, or analysis leading to the discovery or creation of new facts, theories or interpretation or significant revisions of already existing ones, or the practical applications of these new or revised conclusions). Diverse philosophical, theoretical and methodological approaches are welcome. All authors on papers submitted must be undergraduate students. An awards ceremony follows the last presentation. For those students whose papers are accepted, WSCA will pay \$15 of the \$25 USRC registration. Paper submissions must be received by the WSCA Second Vice President by November 1, 2006; authors will be notified of paper acceptance by January 17, 2007.

VI. GRADUATE STUDENT WORKSHOP & GRADUATE PROGRAMS’ OPEN HOUSE

On Saturday, February 17, 2007, the WSCA Second Vice President will host a **WORKSHOP** for advanced undergraduates and master’s students who are considering pursuing a master’s or doctoral degree in communication. The Workshop is designed (1) to introduce students to the benefits of graduate education, (2) to help them understand how to choose a graduate program that

meets their needs, interests, and abilities, and (3) to gain insight into the realities of graduate school life by talking with current doctoral student peers and faculty mentors. The WSCA Second Vice President will also host a Graduate Programs' OPEN HOUSE on Saturday, February 17, 2007. Undergraduate and graduate students will meet with representatives from universities that have graduate programs in communication. Faculty and current graduate students who are interested in participating in the Workshop, and Graduate Program Directors at universities and colleges that offer graduate programs in communication who wish to participate in the Open House, should contact the Second Vice-President by September 1, 2006.

Index

Abrahams, Matt 3401
Acheson, Kris 3111
Acosta, Helen 4401
Adams, Kathy 3507
Agarwal, Indu 5309
Ahntholz, Brenda 4502
Akamine, Jennifer 5106
Alberts, Janet “Jess” 2103, 2203, 4206, 4408, 4508
Allen, Brenda 1200, 3608
Allen, Rebecca 3505
Alto, Robert B. 3401
Anderson, Courtney 5305
Anderson, James 3403
Anderson, Jessica 3412
Anderson, Joe 4504, 4607
Anderson, Laura 5306
Aoki, Eric 5302, 5406
Arai, Sayuri 4611
Arar, Nedal H. 3105
Arias, Amy 4512
Arline, Greg 4213
Armada, Bernard 5302
Atkin, Charles K. 3505
Attias, Bernardo Alexander 3405
Avanzino, Susan 5102
Avery, Robert K. 2400
Ayotte, Kevin J. 4510, 4610, 5107

Babin, Joanne 3401, 4201, 4502
Babin-Gallagher, Beth 4212
Bach, Betsy W. 3509, 4407
Bachman, Guy Foster 4112, 5109
Backlund, Phil 5306
Baglia, Jay 3413, 3513, 3613, 4209, 4413, 5303
Ballard, Dawna I. 5101
Ballard, Robert 3612, 5108
Baltes, A. J. 4411, 5306
Bantz, Charles R. 3509
Barkdull, Karissa C. 3112, 5309
Bartlow, R. Dianne 2202
Barton, Matthew 4204
Bates, Courtney 4104
Bates, Christina 4406, 4606

Beach, Wayne A. 3504, 3604
Beall, Melissa 3101, 4101, 4202, 4602
Bean, Hamilton 3606
Bean, sundae R. 4611
Beckham, Janel Nikol 4503
Begley, P. A. 3601
Bell, Leanne 4205
Bergman, Teresa 3403, 5403
Bergstrom, Mark 1200
Berry, Keith P. 5308
Besker, Robert 4207
Bevan, Jennifer L. 3112, 3612, 5309
Bhatt, Archana J. 5108
Bialowas, Anne 3507, 4503
Bilge, Nurhayat 5102
Bippus, Amy M. 4512
Birkholt, Marty J. 5102
Blackburn, Kristi Vollmer 4101
Blair, Diane 3409
Blair, J. P. 4612
Blong, Linda 2101, 2201
Bloomfield, Julie 3409
Blumer, Collette 3103
Boburka, Renee Reiter 4612
Bonnstetter, Beth 4103, 4403
Booth, E. Tristan 4613, 5307
Bowman, Jonathon 5109
Brabham, Daren C. 4403, 5106, 5402
Bradshaw, Stacy 3611
Braithewaite, Charles 1102, 1200
Braithewaite, Dawn 3605
Brassey, Dom 3513, 3613
Breen, Gerald-Mark 3105, 3505
Breshears, Diana 3412
Bresso, Michele 4401
Brewer, Sara 3501
Brier, Kenneth L. 4106
Broadfoot, Kirsten 3608, 4605
Broadhurst, Erin 4112, 4512
Brockus, Susan 5402
Brodersen, Mariella 3412
Brouwer, Dan 4410
Brown, Kevin James 3609
Brown, Mary 3505
Brier, Kenneth L. 4106

Bruflat, Rebecca 3612
Bruschke, Jon 3611
Brydges, Michael 3601
Brydon, Steven 3506
Buckley-Ott, Cara 4203, 4503
Buller, David B. 4612
Bullis, Connie 4407, 4508
Bunker, James 4510, 4610, 5108
Burgoon, Judy K. 4612
Burke, Jennifer 4411, 5301
Burkholder, Thomas 3110, 3610
Burnett, Nick 3408, 4603
Butcher, Margaret Miller 5306
Butler, Jennifer A. 5102

Campbell, Peter 4103
Canary, Daniel 1102, 1200, 3112, 4612
Cansler, Emily 4206
Carl, Karen 3505
Carlson, Cheree 1102, 1200
Carnett, Summer 4505
Carpenter, Hilda 2101, 2201, 4105
Carter, Nathan 3601
Cervantes, Rafael 3603
Chavez, Karma R. 3413, 4208, 5308
Christian, Allison C. 4212
Christman, Carl 3510
Chung, Jensen 4105, 5306
Clancy, Kristine 5309
Clark, Janet 4512
Classen, Steve 4104
Cloud, Dana 3110, 4510, 4610
Coffman, Michael 4604
Coho, Amanda Dawn 3112, 5309
Collier, Gary 3103
Collier, Mary Jane 1200
Colocino, Michelle Rodino 5402
Colp-Hansbury, Christina 3110, 4504, 4611
Congalton, K. Jeanine 4107
Cooley, Linda M. Carvahlo 5109
Cooper, Pamela 4602
Crabtree, Robbin D. 4106
Crachiolo, Sarah 4507
Cramer, Janet 3512, 5404
Crighton, Jasmine S. 5309

Cripe, Emily T. 3107
Cullivan, Joseph 3402
Cullivan, Kris Gatto 3402, 4101
Cummings-Witker, Jennifer 3112, 3612
Cupach, William R. 1102, 3612
Curtin, Melissa L. 4504, 4604
Cusanelli, Lauren 3112

Dallimore, Elise J. 5406
Damico, Tony 5305
Danielson, Brian 3503, 4507
Danielson, Mary Ann 5102
Dare, Alexa 3108, 4211, 5308
Darling, Ann 3509, 4409, 4509, 5101
Daughton, Suzanne M. 4508, 4608
Davis, Andrea M. 4111
Davis, Kristen 4206
Davis, Kristin 4612, 5309
Daws, Laura Beth 5405
Dawson, Mary 2107
De la Garza, Sarah “Amira” 2102, 4505
DeCamp, Mary H. 4604
DeCaro, Peter 5306
DeChaine, D. Robert 4104, 4209, 4513
Delgado, Fernando 4510, 4610
Deming, Caren J. 4404
DeSantis, Joseph 4507, 4607, 5305
DeTurk, Sara 4209
Dickinson, Greg 3403, 3610, 4508, 5302
Dickson, Fran C. 3105
Dintenfass, Nathan 3503
Dionisopoulos, George 3410, 3610
Dirks, Doris 5106
Dobkin, Bethami 3610
Docan, Tony 3501, 5401
Dodge, Patrick Shaou-Whea 3111, 3411, 4111
Doetkott, Richard 2104, 2204
Donnerstein, Carolyn 4106, 4512
Doohan, Eve-Anne M. 3104, 3412, 4604
Dorr, Susanne, 4203
Dorough, Mark 4513
Downey, Sharon 4210
Duggan, Ashley 3112
Dunbar, Norah E. 5309
Dunn, Deborah 5405

Durfee, Jessica L. 4109
Durnford, Stephanie 3107
Dusbabek, Rabert James 3109
Dzikowski, David 3110, 3409

Eadie, Bill 4102, 5101
Edley, Paige 4206, 5304, 5409
Edson, Belle A. 4208
Ehrenhaus, Peter 2400, 4510, 4610, 5103, 5303
Eidsmore, Joanna 4505
Eifler, Karen 4109
Elliott, Michael 3412
Ellingson, Laura 3405, 5101, 5301
Elton, Jessica 3405
Emery, Robert A. 3611
Endres, Thomas G. 3603, 4112, 4504, 5102
Engleberg, Isa N. 3601
Engstrom, Erika 5405
Estrella, Jeremy J. 4410

Fallon, Billy 5401
Farinelli, Lisa 4512, 5309
Fassett, Deanna L. 3108, 3411, 4409, 4509, 5408
Filipowicz, Terry 3511, 4603
Flemming, Eric 3412
Fletcher, Eric 4207
Flewell, Keli Larson 5104
Flores, Lisa 1200
Floyd, Kory 5309
Ford, Leigh Arden 3605, 4106
Foss, Karen A. 4108, 5404
Foss, Sonja 5404
Foster, Elissa 3505, 4608, 5301
Fotsch, Paul Mason 5408
Foust, Christina 4204, 4410, 5103
Fox, Ragan 3513, 3613
Fraleigh, Douglas 1101, 1200, 4201
Frandsen, Ken 4702
Fratkin, Beth 4209
Freeman, B. J. 4411
Frentz, Suzanne 5409
Fretz, Lauren 3603
Frey, Lawrence R. 1101, 4405, 5101

Gaines, Joslyn 3402

Galician, Mary-Lou 4103
Ganer, Patricia 1200, 4107, 4201
Garcia, Geraldina 3412
Garden, Randa Sue 3108, 3405
Gass, Robert H. 2206
Geist-Martin, Patricia 4505,4605, 5301
Gersch, Beatte 5102
Gibbons, Bobby Sue 3612
Gibbons-Anderson, Joan 4501
Gibson, Katie 4410, 5307
Gilinets, Lea 3101
Gill, Rebecca 3607
Ginossar, Tamar 4106
Golden, Mindi Ann 3105, 4409, 4509
Goltz, Dustin 3104, 3413, 4203, 4613
Goodall, Bud 3513, 3613, 3606
Gordon, Dexter B. 2400
Goss, Blaine 1102, 1200
Graham, Elizabeth 4412
Graham, Jennifer 4112, 5309
Grant, Jo Anna 3405
Griffin, Cindy L. 4208, 4608
Griffin, Rachel 3612
Grisso, Ashley 3506
G'Schwind, Arne 4204, 5402
Guerrero, Laura K. 4112, 4612
Gunn, Amanda M. 4606

Hafen, Susan 5306
Hahn, Laura 5404
Haines, Harry W. 2400, 4503, 4510, 4610, 5303
Hale, Jerold L. 3112
Hall, Damon 3511
Hallstein, D. Lynn O'Brien 4608
Halualani, Rona Tamiko 5108, 3411
Hammerback, John 4510, 4610
Hammers, Michele L. 5304
Hanchett, Ruthie Hoffman 3611
Hansen, Andrew W. 3510
Hanzal, Alesia 4512
Hao, Richie Neil 3109
Haralovich, Mary Beth 4404
Hardy-Short, Dayle 3610, 4510, 4610
Harkness, Cheryl 3405
Harrell, Christina 4501

Hartstern, Meredith 3112, 5309
Harvey, Vickie 3412
Harwood, Jake 4604
Haspel, Kathleen 3706
Hayase, Lynn 5309
Hayden Sara 1200, 4108, 4408, 4508, 4608
Haynes, Mark T. 5309
Haynes, W. Lance 2104, 2204
Heaton, Robin 5109
Heckman, Jennifer L. 4406, 4605
Hedges, James 5102
Heiss, Bettina M. 4406, 4605
Heisterkamp, Brian L. 4512, 5309
Hembroff, Larry 3505
Henningsen, Mary Lynn Miller 4612
Henson, Tricia Giannone 4205
Herold, Anita L. 4612
Hess, Aaron 3606
Heuman, Amy N. 3111
Heyse, Amy L. 5407
Hill, Janellen 4203
Ho, Evelyn 3412
Hock, Sarah 4501
Hoffman, Tracilee 5309
Hoffmann, Jan 4409, 4509
Hogarth, Michael 4106
Hogrefe, Rick 3501, 4501
Hohmann, Hanns 4510, 4610
Holbeck, Domina 3112, 5309
Holmes, Owen 3611
Hollihan, Tom 4510, 4610
Hopkins-Loy, Alice 4212
Houston, Renee 4206, 5304, 4406, 4506, 5102
Hubbell, Anne P. 4106
Hughes, Daniel 4111
Hullman, Gwen A. 4512
Humes, Gavin 4213
Hundley, Heather 2400, 3405, 3507, 3706, 5403
Hurt, Nicole 3107, 4110, 5104
Hutchins, Amber 3603
Hylmo, Annika 4206, 5409

Illes, Brooke 4212
Imes, Rebecca 4209
Inuzuka, Ako 4510, 4610

Jackson, Danielle 5405
Jackson, Michele 4408, 4508
Jaehne, Dennis 4510, 4610
Jandt, Fred E. 3114
Jarmon, Leslie H. 3504, 3604
Jenkins, Mercilee 2205, 3513, 3613, 4613
Jimenez, Marissa 3511
Johnson, Ann 3511, 4210, 5407
Johnson, Kevin 3511
Jophnson, Julile R. 5108
Johnson, Sammye 3603, 4203
Jones, Charlotte M. 3504, 3604
Jones, Steve 3403
Jones, Susanne M. 4612
Jones, A. Todd 4401
Judd, Jeff 5309
Justus, Zach 3511, 3606

Kahf, Usama 4113, 5305
Kahl, Mary L. 5403
Kaimikaua, Charmaine 3601, 4611, 5308
Kalbfleisch, Pamela J. 4612
Kalustian, Mike 4104
Kammerdiner, Paul 2105
Karli, Selin 5105
Keith, Emily 5105
Kelvin, Bill 4403
Keough, Colleen M. 3106, 3406
Keranen, Lisa 3606, 5104
Kershaw, Emma 2102, 4505
Kerssen-Griep, Jeff 3508, 4109, 4209
Keyton, Joann 4405, 4606
Kicenski, Karyl 3401
Kilgard, Amy K. 3513, 3613, 4113, 4413
Kincaid, Amie 3506
Kirby, Erika 4206, 5102
Kirschbaum, Kris 3105, 3506, 5301
Kline, Susan L. 3111
Knoll, Tony L. 3505
Kopinski, Christina M. 4603
Koring, Heidi 3410
Kramer, Michael 4110
Krizek, Robert 4606
Krolokke, Charlotte 4108

Krummel-Abram, Debra 4103
Ku, Scott 4613, 5108
Kvidal, Trine 4103, 5308
Kyomugisha, Florence 220

Lago-Grana, Josefa 4406
Lake, Randall 4110
Lam, Kit 5306
Lamude, Kevin 5405
Larson, Suzanne 4205, 4603
La Valley, Angela G. 5309
Lechtreck, Bob 4207
Leckie, Liz 5101
Lee, Ji Hoon 5309
Lee, Jong-Hwa 4510, 4610
Lee, Kenneth S. 4207
Lee, Sally 3412
Lee, Wenshu 4211, 4510, 4610
Leeds, Courtney 3412
LeGreco, Marianne 3104
Leigh, Michael 4201
Leighton, Corey 4104
Lemon, Laura 5105
Lemus, Daisy R 5101
Leonard, Robert G. 3101
Lerner, Gene 3404
Leverette, Marc 3104, 4410, 5102
Lievrouw, Leah 5101
Lim, Tina 4409, 4509
Linde, Jennifer 2103, 2203
Lindemann, Kurt 2103, 2203, 3106, 4209, 4513
Lindgren, Sara 5105
Linton, Lars 3404, 3504, 3604
Littlejohn, Stephen 2101, 2201, 4102
Litzky, Alexis 3513, 3613
Liu, Fan 3111
Lockwood, Lance R. 2104, 2204
London, Amy 3101, 3401
Lovaas, Karen E. 2205, 3706, 4211
Lozano-Reich, Nina Maria 5304, 4503
Lustig, W. (Ron) Myron 1200, 3706, 4702
Lutgen-Sandvik, Pamela 3106, 3506
Lyon, Alexander 3106

Ma, Yue 4611

Mabe, Benjamin 3603
Maddex, Matthew 4213
Maddux, Kristy 3407
Malhorta, Sheena 4208
Manusov, Valerie 4112
Manuto, Ron 4205
Marinella, Kevin 4409, 4509
Marshall, Jeri 3402
Martell Dennis 3505
Martin, Diane 1200, 4407
Martin, Paul "Pablo" 3403
Martin-Calder, Elizabeth 3107
Martinez, Diana 4213, 5305
Martinez, Gina 3608
Masowich, Mike 5109
Matsunaga, Masaki 3104
Matula, Theodore 3608
Matusitz, Jonathan 3105, 3505, 5102
May, Richard A. 3607
McBride, M. Chad 5102
McCorkle, Suzanne 2207, 3407
McCullough, Karen 4103, 4503, 5104
McDermott, Steven T. 4405
McDermott, Virginia 3506
McEwan, Bree 5109
McGarrity, Matt 2104, 2204
McGarry, Rachel 2102
McGrath, John M. 3105
McGregor, Catherine Russell 4106
McKinnon Sara L. 3108, 4113, 5308
Medina, Shelley 4409, 4509
Mega, Michele 3101
Mehus, Siri 3404
Mejia, Robert 4607
Messer, Lucas C. 3411, 4109
Messman, Susan J. 4512
Metts, Rod 4513
Meza, Lorena 4104
Middleton, Michael K. 4110, 4507, 5309
Miike, Yoshitake 3512
Mikkelson, Alan C. 5109, 5309
Miller, Aimee 3108, 4112
Miller, Jackson 3513, 3613, 4113
Miller, Jared 4507, 4607
Miller, Laura 3611

Mills, Jordan 4207
Milne, Charles 5106
Minge, Jeanine 4505
Modaff, Daniel P. 3504, 3604, 5102
Moe, Patrick W. 2205
Moncrief, Kerri 5302
Mongeau, Paul 1101, 3605, 4212,4512, 4612
Montoya, Yvonne 4206
Mora, Juliane 3408
Morgan, Eric 4407
Moran, Kristen 3412
Morgan, Sara 3501
Morman, Mark T. 5109
Morreale, Sherwyn P. 4506
Morris, Richard 4510, 4610
Morrison, Jennifer Huynh Thi Anh 3103, 3411, 4111, 5108
Morton, Sarah E. 5309
Motley, Michael 2104, 2204
Moy, Rebecca M. 4108
Mudgett, John 5105
Mueller, Heidi 3110, 4113
Mullen, Lawrence J. 3109
Myers, Karen K. 5101
Myers, Monique 4108

Nagel, George 2105
Nainby, Keith 3109, 4109, 5408
Nakagawa, Gordon 4211
Natharius, David, 4702, 4403
Nay, Sherry 3511
Neeson, William 4507
Nelson, Elizabeth 3407
Neson, Judy 3412
Nelson, Toni 3611
Newby, Tia Kaye 5102
Newman, Robert P. 4510, 4610
Newsom, Victoria Ann 5304
Nicastro, Alana M. 4505, 4605
Nicol, Dawn E. 5309
Nyquist, Jody 4409, 4509

O'Brien, Liz 2104, 2204
O'Hair, Dan 3605
O'Keefe, Patricia 3401, 4101, 4201
O'Rourke, Sean Patrick 4205

Oden, Ron 3201
Orem, Sara 2101, 2201
Ott, Brian 1200, 3503, 3610, 4103, 5302
Owen, Jillian A. Tullis 3408
Owen, A. Susan 2400, 3103, 3507, 4510, 4610, 5303, 5403

Park-Fuller, Linda M. 2103, 2203, 4613
Parker, Denae 3103
Parker, Lea Jane 4403
Parker, Richard 4205
Parry, Marcy 2105
Patten, Neil 3412, 5307
Patton, Tracey Owens 4408, 4508, 5108
Payne-Mulliken, Susan 3103
Pawloski, Donna R. 5102
Paynton, Scott 3105, 5301
Pearce, Barnett 2101, 2201, 4102
Pearce, Kimberly 2101, 2201, 4102
Pearson, Kyre 4503
Peeples, Jennifer A. 3410
Pendoley, Andrew L. 4110
Perales, Teresa 5106
Perez, Kimberlee 4113, 4511
Perry, Chad 4105, 5408
Perse, Elizabeth M. 4412
Perucci, Tony 4413
Petrass, Jessica 3412
Petronio, Sandra 4702, 350
Petrunia, Matthew D. 3510, 4105, 4504, 5401
Pfister, Raven A. 4512, 5309
Phillips, Kendall R. 5407
Picarelli, Randi 3101
Pieratt, Christina 5309
Pilling, Brian 5406
Pitts, Maggie 4212
Pippin, Eileen 5304, 4502
Poeppelman, Timi Ross 3408
Popa, Clara L. 4506
Pugh, Jacqueline A. 3105
Putnam, Miram 5304
Pym, Anne 5403

Quander, Caitlyn 5304
Quigley, Tracey 3410, 4110, 5307

Rahn, Philip 3611
Ransom, Leah 4203
Rasmussen, Karen 4210
Rath, Sandra Kellogg 4213
Ray, Eileen Berlin 3605, 4505
Razzouk, Nabil 5405
Reed, Cynthia 4611, 5308
Reeder, Heidi 2107, 3513, 3613
Reese, Melanie 2207
Reinard, John C. 4405
Renegar, Valerie 3403, 3510, 4609
Reser, Erin 3607
Reyes, G. Mitchell 4609, 5407
Reynolds, Rodney A. 4405
Rhee, Yunna 4605
Rich, Craig 3112, 4112
Rich, Marc D. 4109
Richard, Elizabeth 4105, 4206, 5405
Richards, Andrea Ann 3404
Richardson, Brian 3106
Riforgiate, Sarah 4206
Riley, Patricia 4506
Ritchie, Donald 3609
Rivera, Kendra D. 4505, 4604
Rivera-Servera, Ramon 4505
Roberts, Jennifer 5105
Robertson, Eric J 2102, 4203
Robertson, Stephen R. 3102
Robertson, Steven 4507
Robinson, M. J. 5409
Rockler, Naomi 4204
Rodriguez, Jose I. 4109
Rogers, L. Edna 3612
Rogers, Richard 3411, 3510
Rogness, Kate Zittlow 5307
Rohrer, Elyse 3412
Rose, Nancy Oft 1200, 4602
Rossetto, Kelly 3612
Rowe, Aimee Carrillo 4208, 4511
Rowe, Desiree D. 4513
Roy, Abhik 4510, 4610
Rubin, Alan M. 4412
Rubin, Rebecca B. 4412
Ruggerio, Alena Amato 3608
Ruggill, Judd Ethan 4404

Russell, Nicholas 4507, 5305

Salem, Philip 4406

Sanlo, Ronni 5106

Sanprie, Virginia 4609

Sawantdesai, Darshan 4406

Schliesman, Terence 3609

Schuetz, Janice 3511, 4210

Schulz, David 5407

Schuster, Kate 3502, 3602

Schutten, Julie Kalil 3407, 3607, 5307

Schuwerk, Tara J. 2102

Scileppi, Patricia A. 4501

Scudder, Joseph 5405

Scott, Clifton 4605

Segrin, Chris 4512

Seibold, David R. 4412, 5101

Seibert, Saralinda 4512

Seiter, John S. 2206

Sekimoto, Sachi 3109, 4108

Senda-Cook, Samantha 3409, 3503, 5104

Serewicz, Mary Claire Morr 3612, 4612

Sewell, Kaci 5309

Shapiro, Elayne 4406

Sherbolm, John C. 3109

Sherwood, Ken 4207

Sharf, Barbara F. 3505, 4505

Sharp, Jr., Harry 4609

Shineman, Kirt 4613

Shirono, Itsuo 5408

Shockley-Zalabak, Pamela 3406

Short, Brant 3610, 4510, 4610

Shugart, Helene A. 4408, 4508

Shuler, Sherianne 5102

Simmons, Donna 5405

Simpson, Jennifer Lyn 3608, 4506, 4606

Sims-Fletcher, Suzan 5306

Sink, Elizabeth 3407, 3608

Slauta, Kristine 4505

Smith, Christina 3410

Smith, Craig R. 3610

Smith, Donna A. 2105

Smith, Heather 3501

Smith, Ryan 4607

Smith, Sandi W. 3505

Snyder-Yuly, Julie 3107, 3407
Sorrells, Kathryn 2202, 4211
Soto, Jennifer 3409
Soukup, Charles 4204
Souza, Tasha 4409, 4509, 5406
Sowards, Stacey 3107, 3511, 4209
Spangler, Matthew 3113, 3513, 3613, 4413,
Spano, Shawn 2101, 2201, 4102
Sparks, Lisa 3605
Spitzberg, Brian H. 3612
Sprague, Jo 3108, 4409, 4509
Sproule, Michael 3610, 4510, 4610
Staller, Mark 4401
Stark, Jenny 3513, 3613
Staton, Ann 3509, 4409, 4509, 5406
Steepleton, Lisa 5105
Stefani, Lisa A. 5408
Stein, Kevin 4609
Stewart, Jessie 4208
Stewart, Karen A. 4211
Stockton, Bob 4202
Stone Anne M. 3412
Stone, Sarah E. 4108
Suarez-Almazor, Maria 3505
Suter, Elizabeth A. 3607
Sutowski, Teresa 4502
Swade, Rosemary 4501

Tafoya, Melissa 3605, 5309
Tankei, Sachiko 3113
Tashea, Jason 5107
Taylor, Bryan 3606, 5302
Taylor, Juandalynn 3106
Taylor, Matt 1200
Taylor, Sarah 3410
Taylor, Toniesha L. 5304
Teng, Loretta Ya-Wen 3601
Thimsen, A. Freya 3503
Thomas, Catherine 5407
Thornock, Roana 4501
Thorson, Andrea D. 4607
Thurman, Paul D. 4204
Tidgewell, Karin D. 3112, 4609, 5309
Tilley, Patti 4612
Todd, Anne Marie 3503, 4510, 4610

Toller, Paige W. 3607
Tracy, Sarah 3106, 3506, 4206, 4408, 4508
Trapp, Robert 3706
Travers, Shaun 5106
Trehewey, Angela 1102, 3606,4206, 4408, 4508, 4605
Trujillo, Nick 3507
Tuman, Joseph 3606

Umphrey, Laura R. 3109
Upadhyaya, Bhavana 3512

Valencia, Kelley 5105
Van Horn, Tasha 4501
Van Leuven, Nancy 3608
Vargas, Ana Marie 3611
Velasco, Lauren Popell 4502
von Friederichs-Fitzwater, Marlene M. 4106
Von Till, Beth 4409, 4509

Wahba, Jodi 4612
Walker, Juanie 5405
Walker, Kandi L. 3105
Walsh, Michaela 4511
Wander, Philip 2400, 3410, 4510, 4610, 5303
Warda, Christine M. 3513, 3613
Ware, Kimberly 4613
Warren, John T. 3109, 3411, 3508, 4109, 4409, 4509
Watt, Sarah E. Stone 5402
Wellman, Heather 3505
Wells, Lynn 4702
Wenner, Lawrence 5102
West, James T. 4510, 4610
West, Terry 4205
Whalen, Shawn 4107
Wickersham, Jeffery A. 3109
Wilcox, Kathy 3609
Williams, Jade 3605, 4212
Williams, Karen 4409, 4509
Willink, Kate 5408
Wilson, Jason 5309
Winslow, Luke 4107
Wheeler, Sandra P. 3408, 3513, 3613
Whitchurch, Marina 2205, 4502
White, Shayler K. 5309
Whitehead, Kevin 3404

Wiemann, Mary 4501
Wilmot, William 4702
Wingard, Leah 5401
Wilson, Mary Elizabeth 4605
Witmer, Diane 5105
Womack, Melinda 2104, 2204, 4501
Wong (Lau), Kathleen 2106
Wood, Andrew 3603, 4510, 4610
Woyski, Nicole 3412
Wulff, Don 3509, 4409, 4509

Yang, Ping 3111, 4611
Yeo, Eun-ho 4411
Yin, Jing 3512
Young, Stacy L. 4112
Younghans, Colleen 3612
Yoshikawa, Misato 3111
Youra, Paula 3410
Yun, Kimo Ah 3507, 4106

Zakahi, Walter 1102, 1200
Zaytseva, Olga 5402
Zeuschner, Bud 3513, 3613, 4501
Zimmerman, Amber 4505
Zingsheim, Jason 3104, 4403
Zoffel, Nicholas A. 3513, 3613, 4111
Zuckerman, David 3111, 4611
Zukic, Naidi 5102

Notes

Notes